

The survey was carried out by the following ASBESTOS CONSULTANTS TO THE ENVIRONMENT LTD representatives



LEAD SURVEYOR: Tracy Lewis
SURVEYOR(S):

ASBESTOS SURVEY REPORT

SURVEY REFERENCE NO: **WS3318**

Parade Chambers
ITV West / Parade Chambers
10 Parade Street
Penzance
Cornwall
TR18 4BU

CLIENT		CLIENT CONTACT
Luton Insulation Services 14 Langdon Place, Prince Rock Plymouth Devon PL4 9QH Phone: 07855 848861 Fax No: 01752 257324		Steve Wood TYPE 2 Survey Standard sampling, identification and assessment survey (Sampling survey)
SURVEY DATE(S)		SURVEY REPORT ISSUE DATE
From: 26/01/2005	To: 26/01/2005	31/01/2005

SURVEY REPORT PREPARED BY:

Chris Griffin

SURVEY REPORT REVIEWED BY:

Tracy Lewis

POSITION:

Regional Manager

Total Number of Pages to Report: 16

ASBESTOS CONSULTANTS TO THE ENVIRONMENT LIMITED	
<i>Head Office</i> 195 Church Road, Benfleet, Essex SS7 4PN Tel: 01268 566822 Fax: 01268 755977	<i>Regional Office</i> Borough Park, Romney Avenue, Lockleaze, Bristol BS7 9ST Tel: 0117 9527609 Fax: 0117 9520947

Client Name:	Luton Insulation Services	Parade Chambers, 10 Parade Street, Penzance, Cornwall TR18 4BU	Issue Date:	31/1/2005
Survey Ref. No:	WS3318		Page:	3 of 16

SUMMARY OF FINDINGS

LIST OF ASBESTOS CONTAINING MATERIALS IDENTIFIED

Low, Very Low & Minor: Implement A Management Plan.

Inspection No	Building Name/No	Floor/Level	Area/room	Element/Component	Material Description	Required Action
5	Parade Chambers	Ground Floor	Kitchen & Passageway	Sink damper Pad	Bitumen Pad	Inspect at Intervals & Update Register



Refurbishment Survey

Survey Reference Number: L-27741

Survey Date: 26 June 2023

Client Specified Areas

10 Parade Street
Penzance
Cornwall
TR18 4BU



Report Authorised by

Name: Amy Bulpin

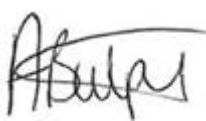
Signed: 

Disclaimer

This document is not to be used by a third party without express permission of Allium Environmental Ltd. No liability to anyone else is accepted. Should you not act upon specific reasonable advice contained within this report, Allium Environmental Ltd will accept no responsibility for the consequences.

This inspection report shall not be reproduced except in full, without the approval of the inspection body and the client.

Allium Environmental Ltd wish to advise our client(s) that no obligation (actual, assumed or otherwise) may be placed upon the client, for further work related to the recommendation from this report.

Please note Allium Environmental Ltd cannot be held responsible for the way in which the client may interpret or act upon the results of the report. This report must be read in its entirety including any appendices. Allium Environmental Ltd accepts no responsibility for sub-division of this report.

No responsibility can be taken for any misinterpretation of this report by third parties.

Table of Contents

Section 1.0: Executive Summary	4
Section 2.0: Introduction	5
Section 2.1: Survey Scope	5
Section 2.2: Limitations.....	6
Section 2.3: Details.....	7
Section 2.4: Survey Type	7
Section 3.0: Survey Method	8
Section 4.0: General Comments	9
Section 5.0: Terminology	11
Section 5.1: Material Assessment Score Algorithm & Risk rating.....	12
Section 5.2: Recommended Actions Explained.....	13
Section 6.0: Survey Findings & Room Construction.....	14
Appendix 1: Floor Plans	27
Appendix 2: Certificate of Bulk Sample Analysis.....	29

Section 1.0: Executive Summary

An Asbestos Refurbishment Survey was carried out in accordance with in-house asbestos surveying procedures and HSE guidance documentation *HSG 264: Asbestos: The Survey Guide* to the client specified areas at 10 Parade Street.

The Survey was carried out by Allium Environmental Ltd on behalf of Atelier; Helen Brooks on 26 June 2023.

The purpose of this survey was to locate as far as reasonably practicable the presence and extent of all suspected Asbestos Containing Materials (ACMs) in the building survey area which could be damaged or disturbed during planned refurbishment activities.

During the survey 4 samples were taken for analysis.

A Refurbishment Survey aims to locate all ACMs within the survey area. There is no requirement to assess the condition or 'Priority' information for management purposes. This is because it is presumed that all ACMs found will be removed as part of the planned refurbishment works. However, should any material remain in situ or if the related works are not undertaken then all ACMs identified should be re-assessed and managed in accordance with the recommended action set out in HSG 264 or CAR 2012. To manage the risk from ACMs, it is the Duty Holder's responsibility to keep and maintain an up-to-date record of the location, condition, maintenance and removal of all ACMs on the premises. If there is a risk of exposure due to the condition or location of the ACMs then they should be repaired, encapsulated and labelled, or removed. It is the responsibility of the Duty Holder to maintain ACMs in a good state of repair and regularly monitor the condition; the Duty Holder should inform anyone who is liable to disturb the ACMs about their location and condition.

Item No.	Building Name	Room No. & Name	Asbestos Containing Product	Recommended Action	Risk
5	10 Parade Street	008 WC	Bitumen Adhesive - Floor	Remove if affected by proposed refurbishment works	Very Low
6	10 Parade Street	007 Kitchen	Bitumen Adhesive - Floor	Remove if affected by proposed refurbishment works	Very Low
3	10 Parade Street	007 Kitchen	Sink Pad - Plant/Equipment	Remove if affected by proposed refurbishment works	Very Low

Inaccessible areas encountered during the time of the survey, for which no information was obtained, along with areas where access was limited:

- None

Section 2.0: Introduction

Allium Environmental Ltd was instructed by Helen Brooks of Atelier; Helen Brooks to undertake an Asbestos Refurbishment Survey to ascertain the presence of any Asbestos Containing Materials (ACMs) within: 10 Parade Street.

The site consists of:

- Circa 1900's semi-detached building with stone and block walls and a pitched and flat roof.

The survey was carried out on 26 June 2023 by Matthew Roberts of Allium Environmental Ltd.

Section 2.1: Survey Scope

The scope of the survey as defined by Atelier; Helen Brooks is to carry out a Refurbishment Survey to the client specified areas within 10 Parade Street:

- Areas included in the survey:
 - All areas as identified within the client supplied plans only within 10 Parade Street were included in the survey.
- Agreed areas of exclusion from the survey scope:
 - All other areas of 10 Parade Street were excluded from the survey.

Section 2.2: Limitations

During the course of the survey all reasonable efforts were made to identify the presence of Asbestos Containing Materials within the surveyed areas. However, Asbestos Containing Materials (ACMs) are sometimes concealed within the fabric of a building or sealed building voids, and so it is not always possible to regard the findings of a survey as being definitive. Therefore, it must always remain a possibility that further Asbestos Containing Materials may be found during any alterations, refurbishment or demolition works. Asbestos Containing Materials (ACMs) may be hidden within the fabric of a building and may not be visible until the building is dismantled; it is therefore recommended that a complete review of the Asbestos register is undertaken before commencement of any works. Where areas have been identified as inaccessible within the report, it indicates that the area specified was not accessible to the surveyor at the time of the inspection either because such areas were locked despite requests for access to be arranged, or to gain entry would require an unreasonable degree of dismantling to the structure of the building. The client is therefore advised to the possibility of there being Asbestos Containing Materials in such areas.

HSE guidance: HSG 264: Asbestos: the survey guide states it is now recognised that even with 'complete' access demolition surveys, all ACMs may not be identified and this only becomes apparent during demolition itself. Therefore in buildings that are occupied, due to be re-occupied or due to extenuating circumstances, following the completion of the survey it may be required to undertake additional inspections or sampling prior to/during proposed refurbishment works to account for all hidden Asbestos Containing Materials (ACMs). Where this is likely a provision may need to be made to allow for a possible revisit, this may include inaccessible areas that will be listed in this report.

- Inaccessible areas encountered during the survey:
 - None
- Agreed Variations or Deviations from the standard HSG 264 method:
 - Intrusions were kept to a minimum due to continued occupation of the property.

Section 2.3: Details

Site Address:

- 10 Parade Street, Penzance, Cornwall, TR18 4BU

Client Name & Address:

- Atelier; Helen Brooks, Chi An Vre, 4 Higher Gwavas Road, Penzance, Cornwall, TR18 5NZ

Client Contact:

- Helen Brooks

Survey Start Date:

- 26 June 2023

Survey Completion Date:

- 26 June 2023

Survey Conducted by:

- Matthew Roberts

Assisted by:

- N/A

Report Produced:

- 08 July 2023

Section 2.4: Survey Type

The nature of the survey is a Refurbishment Asbestos Survey as detailed in HSE publication: *HSG 264 Asbestos: The Survey Guide*. HSE guidance publication *HSG 264: Asbestos: The Survey Guide* describes a Refurbishment survey as a fully intrusive survey. A full sampling programme is undertaken to identify possible ACMs and estimates of volume and surface area made. A Refurbishment survey is required for all work which disturbs the fabric of the building in areas where the management survey has not been intrusive.

This report presents the findings of the survey and analysis reports of any bulk samples taken.

Section 3.0: Survey Method

Allium Environmental Ltd conducts Refurbishment surveys in accordance with our in-house Asbestos Surveying procedures and HSE guidance publication *HSG 264: Asbestos: The Survey Guide*. While the survey is fully intrusive, disruptive and non-destructive, it may involve penetrating all parts of the building structure, using aggressive inspection techniques to lift carpets and tiles, break through walls, ceilings cladding and partitions, and open up floors.

A Refurbishment survey uses a combination of visual inspection and bulk sampling to confirm the presence of Asbestos. Any area(s) inaccessible at the time of the survey must be presumed to contain Asbestos, and any inaccessible area(s) must have access restricted, and should be inspected prior to access or the commencement of any works.

Any samples collected during the survey will be analysed in-house to ISO/IEC 17025 for the identification of Asbestos fibres in bulk samples, and in accordance with HSE guidance note: *HSG 248: The Analysts' guide for sampling analysis and clearance procedures and best practice* or subcontracted to an approved independent laboratory, which is also UKAS accredited to ISO/IEC 17025 for the identification of Asbestos fibres in bulk samples, and in accordance with HSE guidance note: *HSG 248: The Analysts' guide for sampling analysis and clearance procedures and best practice*. Where applicable and where samples are sub-contracted this will be clearly displayed on the bulk sample test report and within the survey report. Completed Fibre Identification Report for all samples taken can be found in Appendix 2. (Representative samples were also taken of any materials that may be mistaken for potential ACMs). Sampling location stickers, bearing the individual samples unique identification number, have been applied to all sample points where practicable, for future reference.

Products that are very unlikely to contain Asbestos were not sampled (e.g. wallpaper, plasterboard, chipboard, wood etc.).

An item record is completed for each suspect sample taken; for materials strongly presumed to contain Asbestos (i.e. materials visually similar to positively identified ACMs); for areas presumed to contain Asbestos (i.e. areas where no access could be gained at the time of the survey; and non-accessed items of (electrical) equipment and plant).

Each item record contains a colour photograph, individual material assessment scores (as prescribed under HSG 264), management recommendations and general observations / comments (where appropriate).

The item records are combined together to form a site-specific Asbestos Register.

Section 4.0: General Comments

This report relates to the situation on the day(s) of the inspection and cannot take into account subsequent changes in circumstances. Samples were taken of any materials historically known or presumed to contain Asbestos. This report contains findings based upon visual inspection and results of laboratory analysis

All figures and measurements quoted in the Asbestos Register detailing the extent of ACMs are estimates, based upon visual inspection on the day of the survey and should be used as a guide. It is the responsibility of contractors quoting for Asbestos Removal Works to take their own measurements to determine the exact extent of Asbestos to be removed. Unless otherwise stated pipework insulation and heating plant was not inspected in their entirety. Representative samples were taken at random intervals where suspect material was observed. The scope of the works did not permit complete exposure and assessment of all pipework and heating plant.

No responsibility can be taken for any misinterpretation of this report by third parties.

A limited inspection of pipework concealed by overlying non-Asbestos insulation has been conducted. Inspection of pipework has been restricted primarily to insulation visible. The presence of Asbestos debris to pipework, which is not readily visible or would require the full removal and replacement of overlying insulation, has therefore not been investigated.

No responsibility will be accepted for the presence of Asbestos in voids (under floor, or behind wall or ceiling) or pipework ducts other than those opened up during the survey.

The survey is limited to those areas accessed at the time of the survey.

We have not reported on concealed spaces, which may exist within the fabric of the building, and where the extent and presence of these is not evident, due to inaccessibility or insufficient knowledge of the structure at the time of the survey.

Due to the nature and variety of Asbestos used in building construction and the complex nature of some buildings, especially where modified over the years, it is possible that some ACMs may not have been identified in the survey. Where refurbishment is to follow a refurbishment Survey, it would be prudent in any contract to allow a contingency sum to provide for such possibility.

Section 4.0: General Comments (Continued)

Certain 'Artex' type textured coatings and decorative plasters may contain very small quantities of Asbestos. In situ, these coatings are often composed of different batches of product, or may have been repaired / patched at different times. It is therefore possible that any 'Artex' samples taken may not be representative of the entire coating. Recent research suggests that in some cases, the fibres may have diameters below 0.1 μm . These may not be visible by the optical microscopy method described in HSE guidance publication HSG 248: Asbestos: The Analysts' Guide for Sampling, Analysis and Clearance Procedures.

At the time of the survey no access was gained to materials and/or void areas located above, behind or attached to suspect Asbestos Containing Materials sampled or presumed throughout the site. To do so would have required surveyors to break through suspect ACMs, such as textured coating and insulating board, potentially contaminating themselves and the work area with Asbestos. Therefore, it is recommended that site operatives are made aware of this survey limitation, and instructed to exercise caution when breaking through materials and/or areas located above, behind or attached to suspect ACMs that have been found to contain Asbestos following laboratory analysis.

Section 5.0: Terminology

Asbestos – A term used for the fibrous form of several naturally occurring silicate minerals, used primarily because of its low thermal conductivity, high tensile strength, resistance to chemical attack, flexibility and incombustibility. *The Control of Asbestos Regulations 2012* defines and regulates asbestos as the fibrous forms of the following minerals or any mixture containing them. “Asbestos” means the following fibrous silicates;

Chrysotile (White Asbestos)

Crocidolite (Blue Asbestos)

Fibrous Grunerite - commonly known as *Amosite* (Brown Asbestos)

Fibrous Tremolite

Fibrous Anthophyllite

Fibrous Actinolite

ACM(s) - Asbestos Containing Material(s). Any material, substance or product that contains or has been made with Asbestos.

SPTCA - Strongly Presumed To Contain Asbestos.

PTCA - Presumed To Contain Asbestos.

NAD - No Asbestos Detected.

AD - Asbestos Detected.

Section 5.1: Material Assessment Score Algorithm & Risk rating

Sample Variable	Score	Example of Scores
Product Type (including debris from product)	1	Asbestos-Reinforce Composite (Plastic, Resin, Mastic, Roofing Felts, Vinyl Floor Tiles, Semi-Rigid Paints or Decorative Finishes, Asbestos Cement)
	2	Asbestos Insulating Board (AIB), Millboards, Other Low-Density Insulating Boards, Asbestos Textile, Gasket, Ropes and Woven Textile, Asbestos Paper and Felt
	3	Thermal Insulation (e.g. Pipe and Boiler Lagging), Sprayed Asbestos, Loose Asbestos, Asbestos Mattresses and Packing.
Extent of damage/deterioration	0	Good condition: no visible damage
	1	Low damage: a few scratches or surface marks, broken edges on board, tiles etc.
	2	Medium damage: significant breakage of materials or several small areas where material has been damaged revealing loose fibres.
	3	High damage or delamination of materials, Sprays and Thermal Insulation. Visible Asbestos debris
Surface treatment	0	Composite materials containing Asbestos: Reinforced Plastic, Resins, Vinyl Tiles.
	1	Enclosed Sprays and Lagging, AIB (with exposed face painted or encapsulated), Asbestos Cement Sheets etc.
	2	Unsealed AIB, or encapsulated Lagging and Sprays.
	3	Unsealed Lagging and Sprays.
Asbestos type	1	Chrysotile
	2	Amphibole (Amosite) Asbestos excluding Crocidolite
	3	Crocidolite

Potential to release Asbestos Fibres

- Materials with an assessment score of 10 or more are deemed to have a high risk and potential to release fibres, if subject to minor disturbance, e.g. walking in the vicinity of the material.
- Materials with an assessment score between; 7-9 are deemed to have a medium risk and potential to release fibres.
- Materials with an assessment score between; 5-6 are deemed to have a low risk and potential to release fibres.
- Materials with an assessment score of 4 or less are deemed to have a very low risk and potential to release fibres.

Section 5.2: Recommended Actions Explained

Monitor Condition - This material can stay in situ and be managed accordingly. Monitor condition regularly and record condition.

Label - Label the ACM with approved warning signs

Encapsulate - Use suitable encapsulating material to seal surface. Work with this material to be carried out in accordance with HSE Publication: *The Control of Asbestos Regulations 2012*.

Repair - This material requires repair. Work with this material to be carried out in accordance with HSE Publication: *The Control of Asbestos Regulations 2012*.

Restrict Access - Restrict access to area and communicate with employees, contractors and others to keep area free from personnel. Work with this material to be carried out in accordance with HSE Publication: *The Control of Asbestos Regulations 2012*.

Protect/Enclose - Use suitable material to protect / enclose ACM to minimise risk of impact damage.

Remove if Affected - If this material is likely to be disturbed by/during the proposed refurbishment works then material will need to be removed prior to work commencing. Work with this material to be carried out in accordance with HSE Publication: *The Control of Asbestos Regulations 2012*.

Remove - This material requires removal. Work with this material to be carried out in accordance with HSE Publication: *The Control of Asbestos Regulations 2012*.

No Access/Exercise Caution - Surveyors were unable to obtain access to material, item, room, area or building to conduct inspection for potential ACMs. Therefore, the area is assumed to contain Asbestos and the Duty Holder should exercise caution.

Please Note:

- Allium Environmental Ltd cannot be held responsible for the way in which the client may interpret or act upon the results of this report.
- Please refer to HSE Publication: *The Control of Asbestos Regulation 2012* prior to undertaking any remedial works on ACMs.
- In some instances more than one recommendation may be used.

Section 6.0: Survey Findings & Room Construction

Please note

- Where areas were inspected and no ACMs were identified or presumed an entry has been placed into the report findings stating “No Asbestos Detected” within the respective area.

Room/Area Name & No: 001 - Hall

Floor: Ground Floor

Building: 10 Parade Street

Room Construction / Description			
Ceiling	N/A	Riser/Boxing	N/A
Firebreak	N/A	Voids	N/A
Walls	Brick, Stone	Pipework	N/A
Doors	Timber	Plant/Equipment	N/A
Windows/Sills	N/A	Staircases	N/A
Floor	Carpet, Timber	Other	N/A
Under Floor Ducts	N/A	Comments	

Positive Survey Findings - None Identified

No Access Areas - None Identified

Negative Survey Findings - Not Applicable

Room/Area Name & No: 002 - Teaching & multi-function room

Floor: Ground Floor

Building: 10 Parade Street

Room Construction / Description			
Ceiling	Plasterboard, Wallpaper	Riser/Boxing	N/A
Firebreak	N/A	Voids	N/A
Walls	Brick, Plasterboard, Stone, Timber, Wallpaper	Pipework	N/A
Doors	N/A	Plant/Equipment	N/A
Windows/Sills	Timber	Staircases	N/A
Floor	Carpet, Timber	Other	N/A
Under Floor Ducts	N/A	Comments	

Positive Survey Findings - None Identified

No Access Areas - None Identified

Negative Survey Findings - Not Applicable

Room/Area Name & No: 003 - Hallway

Floor: Ground Floor

Building: 10 Parade Street

Room Construction / Description			
Ceiling	Lath and Plaster, Modern Suspended Ceiling Tiles, Timber	Riser/Boxing	N/A
Firebreak	N/A	Voids	N/A
Walls	Brick, Plasterboard, Plastic, Stone, Timber, Wallpaper	Pipework	N/A
Doors	Timber	Plant/Equipment	N/A
Windows/Sills	Timber	Staircases	N/A
Floor	Carpet, Timber	Other	N/A
Under Floor Ducts	N/A	Comments	

Positive Survey Findings - None Identified

No Access Areas - None Identified

Negative Survey Findings - Not Applicable

Room/Area Name & No: 004 - Small groups space

Floor: Ground Floor

Building: 10 Parade Street

Room Construction / Description			
Ceiling	Foam Panels, Lath and Plaster, Timber	Riser/Boxing	N/A
Firebreak	N/A	Voids	N/A
Walls	Brick, Stone, Timber	Pipework	N/A
Doors	Timber	Plant/Equipment	N/A
Windows/Sills	N/A	Staircases	N/A
Floor	Carpet, Timber	Other	N/A
Under Floor Ducts	N/A	Comments	

Positive Survey Findings - None Identified

No Access Areas - None Identified

Negative Survey Findings - Not Applicable

Room/Area Name & No: 005 - Teaching & multi-function room

Floor: Ground Floor

Building: 10 Parade Street

Room Construction / Description			
Ceiling	Lath and Plaster, Modern Suspended Ceiling Tiles	Riser/Boxing	N/A
Firebreak	N/A	Voids	N/A
Walls	Brick, Lath and Plaster, Plastic, Stone, Timber	Pipework	N/A
Doors	Timber	Plant/Equipment	Modern Consumer Unit
Windows/Sills	Timber	Staircases	N/A
Floor	Carpet, Timber	Other	N/A
Under Floor Ducts	N/A	Comments	

Positive Survey Findings - None Identified

No Access Areas - None Identified

Negative Survey Findings - Not Applicable

Room/Area Name & No: 006 - Cupboard

Floor: Ground Floor

Building: 10 Parade Street

Room Construction / Description			
Ceiling	Plasterboard	Riser/Boxing	N/A
Firebreak	N/A	Voids	N/A
Walls	Brick, Plasterboard & Ceramic Tiles, Stone	Pipework	Metal & Plastic
Doors	Timber	Plant/Equipment	Sink Pad
Windows/Sills	N/A	Staircases	N/A
Floor	Modern Floor Sheets & Timber	Other	N/A
Under Floor Ducts	N/A	Comments	

Positive Survey Findings - None Identified

No Access Areas - None Identified

Negative Survey Findings

Reference	1	Product Type (A)	N/A	
Sample No	27741/MR/001	Condition (B)	N/A	
Description	Sink Pad - Plant/Equipment	Surface Treatment (C)	N/A	
Accessibility	Low	Asbestos Type (D)	N/A	
Risk Rating	N/A	Material Score (A+B+C+D)	N/A	
Extent	2no.	Identification	NAD	
Recommendation	No Action			
Comments				

Room/Area Name & No: 007 - Kitchen

Floor: Ground Floor

Building: 10 Parade Street

Room Construction / Description			
Ceiling	Textured Coating, Plasterboard	Riser/Boxing	No Asbestos Detected Within Boxing, Timber
Firebreak	N/A	Voids	N/A
Walls	Block, Plasterboard, Stone, Wallpaper	Pipework	Metal & Plastic
Doors	Timber, Timber Packers	Plant/Equipment	Sink Pad
Windows/Sills	Timber	Staircases	Carpet, Concrete
Floor	Bitumen Adhesive, Modern Floor Sheets & Concrete	Other	N/A
Under Floor Ducts	N/A	Comments	Textured coating to plasterboard.

Positive Survey Findings

Reference	6	Product Type (A)	1	
Sample No	Visually Similar to 27741/MR/004	Condition (B)	1	
Description	Bitumen Adhesive - Floor	Surface Treatment (C)	0	
Accessibility	Low	Asbestos Type (D)	1	
Risk Rating	Very Low	Material Score (A+B+C+D)	3	
Extent	5m²	Identification	SPTCA	
Recommendation	Remove if affected by proposed refurbishment works – See section 5.2			
Comments	Bitumen adhesive to concrete floor below the modern vinyl flooring and self-levelling compound.			

Reference	3	Product Type (A)	1
Sample No	27741/MR/003	Condition (B)	1
Description	Sink Pad - Plant/Equipment	Surface Treatment (C)	0
Accessibility	Low	Asbestos Type (D)	1
Risk Rating	Very Low	Material Score (A+B+C+D)	3
Extent	2no.	Identification	AD
Recommendation	Remove if affected by proposed refurbishment works – See section 5.2		
Comments			



No Access Areas - None Identified

Negative Survey Findings

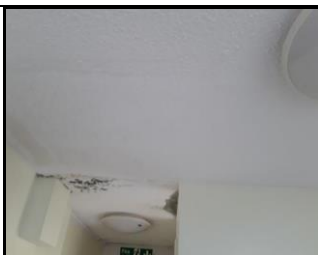
Reference	2	Product Type (A)	N/A	
Sample No	27741/MR/002	Condition (B)	N/A	
Description	Textured Coating - Ceiling	Surface Treatment (C)	N/A	
Accessibility	Low	Asbestos Type (D)	N/A	
Risk Rating	N/A	Material Score (A+B+C+D)	N/A	
Extent	5m²	Identification	NAD	
Recommendation	No Action			
Comments	Textured coating to plasterboard. Composite sample			

Room/Area Name & No: 008 - WC

Floor: Ground Floor

Building: 10 Parade Street

Room Construction / Description			
Ceiling	Textured Coating, Plasterboard	Riser/Boxing	N/A
Firebreak	N/A	Voids	N/A
Walls	Block & Ceramic Tiles	Pipework	Metal & Plastic
Doors	Timber, Timber Packers	Plant/Equipment	Plastic Cistern
Windows/Sills	UPVC & Ceramic Tiles	Staircases	N/A
Floor	Bitumen Adhesive, Modern Floor Sheets & Concrete	Other	N/A
Under Floor Ducts	N/A	Comments	

Positive Survey Findings

Reference	5	Product Type (A)	1	
Sample No	27741/MR/004	Condition (B)	1	
Description	Bitumen Adhesive - Floor	Surface Treatment (C)	0	
Accessibility	Low	Asbestos Type (D)	1	
Risk Rating	Very Low	Material Score (A+B+C+D)	3	
Extent	3m²	Identification	AD	
Recommendation	Remove if affected by proposed refurbishment works – See section 5.2			
Comments	Bitumen adhesive to concrete floor below the modern vinyl flooring and self-levelling compound.			

No Access Areas - None Identified

Negative Survey Findings

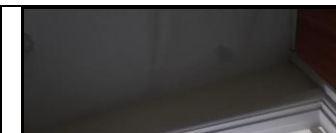
Reference	4	Product Type (A)	N/A	
Sample No	Composite 27741/MR/002	Condition (B)	N/A	
Description	Textured Coating - Ceiling	Surface Treatment (C)	N/A	
Accessibility	Low	Asbestos Type (D)	N/A	
Risk Rating	N/A	Material Score (A+B+C+D)	N/A	
Extent	3m²	Identification	NAD	
Recommendation	No Action			
Comments	Textured coating to plasterboard.			

Room/Area Name & No: 101 - Assembly Recital Room

Floor: First Floor

Building: 10 Parade Street

Room Construction / Description			
Ceiling	Lath and Plaster	Riser/Boxing	N/A
Firebreak	N/A	Voids	N/A
Walls	Stone	Pipework	N/A
Doors	N/A	Plant/Equipment	N/A
Windows/Sills	Timber	Staircases	N/A
Floor	N/A	Other	N/A
Under Floor Ducts	N/A	Comments	

Positive Survey Findings - None Identified

No Access Areas - None Identified

Negative Survey Findings - Not Applicable

Room/Area Name & No: 102 - Kitchen

Floor: First Floor

Building: 10 Parade Street

Room Construction / Description			
Ceiling	Lath and Plaster	Riser/Boxing	N/A
Firebreak	N/A	Voids	N/A
Walls	Stone	Pipework	N/A
Doors	N/A	Plant/Equipment	N/A
Windows/Sills	Timber	Staircases	N/A
Floor	N/A	Other	N/A
Under Floor Ducts	N/A	Comments	

Positive Survey Findings - None Identified

No Access Areas - None Identified

Negative Survey Findings - Not Applicable

Room/Area Name & No: 103 - Music therapy

Floor: First Floor

Building: 10 Parade Street

Room Construction / Description			
Ceiling	Lath and Plaster	Riser/Boxing	N/A
Firebreak	N/A	Voids	N/A
Walls	Stone	Pipework	N/A
Doors	N/A	Plant/Equipment	N/A
Windows/Sills	Timber & Metal	Staircases	N/A
Floor	N/A	Other	N/A
Under Floor Ducts	N/A	Comments	

Positive Survey Findings - None Identified

No Access Areas - None Identified

Negative Survey Findings - Not Applicable

Room/Area Name & No: Main Building

Floor: External

Building: 10 Parade Street

Room Construction / Description			
Walls	Brick, Stone	Ducts/Pipe Runs	N/A
Cladding	N/A	Ground	Brick
Roof	N/A	Windows/Sills	Natural Slate Tiles, UPVC
Rainwater Goods	Plastic	Soffit Fascia's	UPVC & Timber
Soil Stacks	N/A	Staircases	N/A
Flues/Cowls	N/A	Other	N/A
Plant/Equipment	N/A	Comments	
Doors	Timber, Timber Door Header		

Positive Survey Findings - None Identified

No Access Areas - None Identified

Negative Survey Findings - Not Applicable



Site:	10 Parade Street Penzance Cornwall TR18 4BU
Building:	Circa 1900's semi-detached building with stone and block walls and a pitched and flat roof.
Floor Level / Area:	Ground Floor
Ref No & Plan No:	L-27741 Page 1 of 2

KEY

Positive ACMs / items	
Non Asbestos / Negative ACMs	
No Access / Limited Access	
Areas excluded from the survey	

Please note:
Where provided floor plans should be regarded as sketch-plans and for identification purposes only. They are intended to provide a visual appreciation of the buildings surveyed, showing locations of suspected ACMs, areas of no access and where samples were taken.

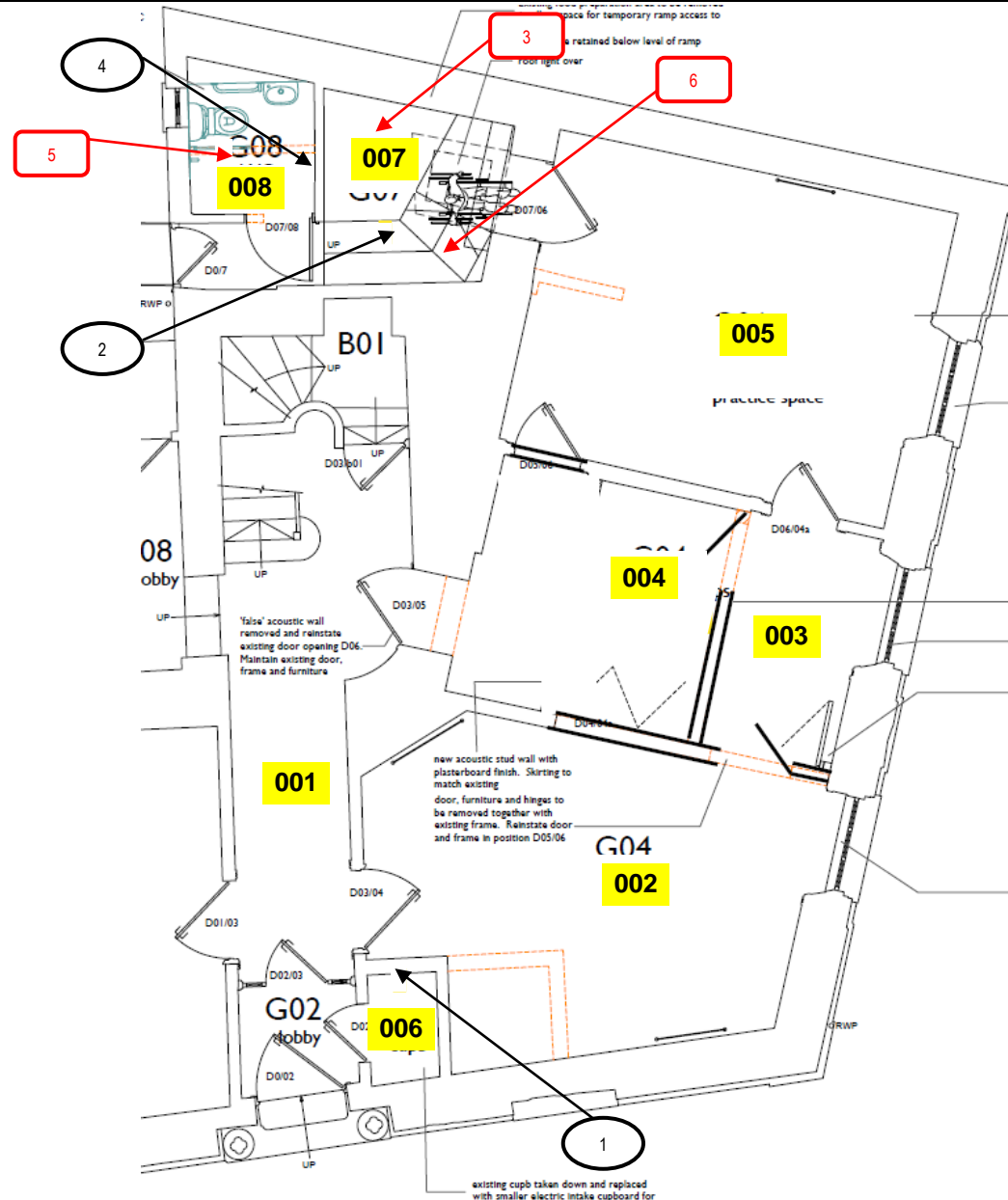

• THIS PLAN SHOULD BE READ IN CONJUNCTION WITH THE MAIN BODY OF THE REPORT AND INDIVIDUAL ITEM RECORDS



Site:	10 Parade Street Penzance Cornwall TR18 4BU
Building:	Circa 1900's semi-detached building with stone and block walls and a pitched and flat roof.
Floor Level / Area:	First Floor
Ref No & Plan No:	L-27741 Page 2 of 2

KEY

Positive ACMs /items	
Non Asbestos / Negative ACMs	
No Access / Limited Access	
Areas excluded from the survey	

Please note:
Where provided floor plans should be
regarded as sketch-plans and for
identification purposes only. They are
intended to provide a visual appreciation of
the buildings surveyed, showing locations of
suspected ACMs, areas of no access and
where samples were taken.

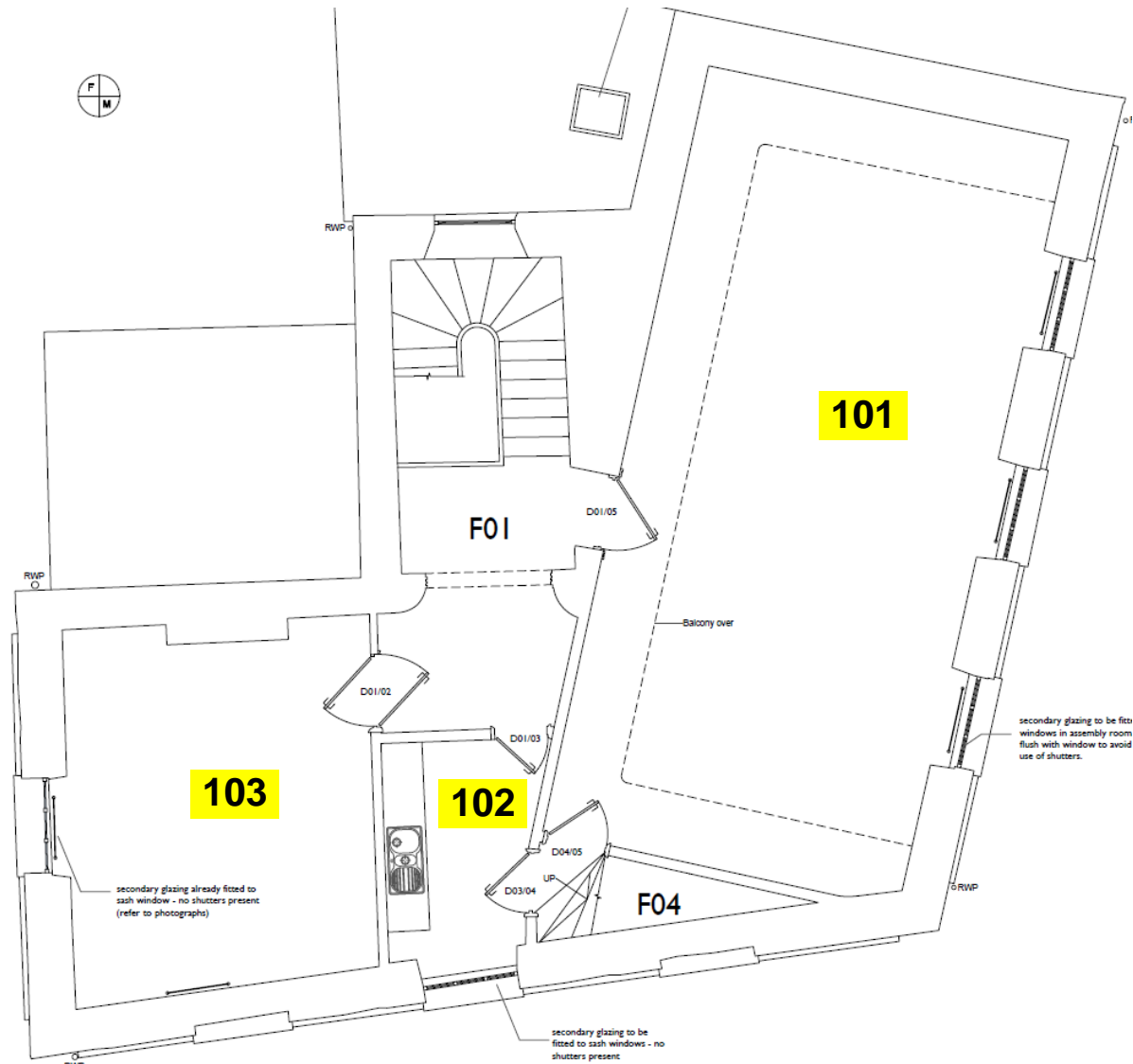

• THIS PLAN SHOULD BE READ IN CONJUNCTION WITH THE MAIN BODY OF THE REPORT AND INDIVIDUAL ITEM RECORDS

Appendix 2: Certificate of Bulk Sample Analysis



Allium Environmental Ltd.
Baldhu House, Wheal Jane Earth
Science Park, Baldhu, Truro TR3 6EH
Tel: 01872 276375
Email: enquiries@allium.uk.net Web: www.allium.uk.net



BULK ANALYSIS TEST REPORT



Report Number:	L-27741	Issue No:	1	Date Reported:	08/07/23	Page 1 of 1
Comments:						
Client:	Atelier; Helen Brooks					
Client Address:	Chi An Vre, 4 Higher Gwavas Road, Penzance, Cornwall, TR18 5NZ					
Site Address/Location:	10 Parade Street, Penzance, Cornwall, TR18 4BU					
Date Sampled:	26/06/23	Sampled By:	Matthew Roberts			
Date Samples Received:	29/06/23	Client Order No.:	Invoice Prior	No. of Samples:	4	
Date Analysed:	03/07/23	Analysed by:	Victoria Berry			

Analysis of samples was carried out in accordance with the documented 'in-house' procedures and methods based upon HSE Guidance Document HSG 248 Appendix 2. Comments, opinions and interpretations herein are outside the scope of UKAS accreditation. This report may not be reproduced except in full, without written approval of the laboratory.

ANALYSIS RESULTS

Lab Sample Ref. No.	Client Ref.	Sample Type	Sample Details/location/description	Asbestos Type (s)
001		Sink Pad	Ground Floor, 006 Cupboard, Internal/Plant/Equipment - Sink Pad	No Asbestos Detected
002		Textured Coating	Ground Floor, 007 Kitchen, Internal/Ceiling - Textured Coating	No Asbestos Detected
003		Sink Pad	Ground Floor, 007 Kitchen, Internal/Plant/Equipment - Sink Pad	Chrysotile
004		Bitumen Adhesive	Ground Floor, 008 WC, Internal/Floor - Bitumen Adhesive	Chrysotile

- Materials have been referred to as Asbestos Insulating Board or Asbestos Cement based upon their asbestos content and visual appearance alone.
- Where samples have not been taken by Allium Environmental Ltd the results apply to the sample as received. It can only report analysis results. No responsibility can be taken for any consequences arising from the client's sampling strategy or procedures, for the acts or omissions of others, or the use of these results in subsequent reports.
- Samples marked \$ in this report have been subcontracted to a UKAS accredited laboratory.
- Quantification of the amount of asbestos is not permitted, if 1 or 2 fibres are observed and identified as asbestos, the term 'trace asbestos identified' will be reported.

Additional Comments:	Analyst:	Victoria Berry
	Analysts Signature:	
	Approved by:	Hadyn Veale
	Authorised Signature:	
E N D O F R E P O R T		

- Sample(s) were examined for the presence of 6 types of asbestos fibres: Crocidolite (blue), Amosite (brown), Chrysotile (white), Anthophyllite, Actinolite and Tremolite.
- Where samples have been taken by Allium Environmental Ltd this has been to the in-house surveying/sampling procedure AL003, a copy of which is available on request.