

- a. This drawing has been prepared as the clients design intent only. The detailed design and specification of the works is to be carried out by a main contractor on a design and build contract basis. The main contractor is to allow for everything required to provide a suitable resurfaced car park surface with new underground and above ground drainage.
- b. Detailed design proposals are to be provided to the client for approval.
- c. Any areas disturbed by the main works are to be made good.
- d. A CCTV survey and some repairs were recently carried out to the underground drainage system. Reference should be made to this report which identifies the underground drainage run connections.
- e. The building is to remain partly in use during the works and therefore it is envisaged that the works will be carried out in two stages so that access to the community centre can be maintained and it can continue to operate. The intention is that the first stage of works will immediately follow the second stage of works and that the contract will be continuous. This is subject to the main contractors programming and design of the works. Works programme and stages of work to be agreed with client.
- f. The Principal Contractor will also be the Principal Designer of the works under the Construction Design and Management Regulations 2015 and will be required to carry out all of their duties.
- g. The main contractor is responsible for obtaining any statutory approvals they deem to be required

1. Car park to be have the existing tarmac/dam wearing course mechanically stripped back, with a new asphalt wearing course applied to maintain the originally designed levels and falls, without ponding.
2. Existing sunken areas in tarmac/dam surface to entire existing car park to be assessed and locally built up to ensure level surfaces are provided to the original intended falls, without any ponding.
3. New white thermoplastic markings to be applied over.
4. All manhole covers to be replaced with new recessed heavy duty ductile iron covers and frames. Recessed covers to have surrounds installed to match surrounding finish.
5. All existing recessed RWP/drainage gullies (G1 to G9) with concrete surrounds around the perimeter of the building are to be replaced with new gullies installed flush with the car park surface, provided with a direct RWP connection via a collar. Rodding and cleaning provision to be provided to all connections. Allow for adaption of RWP's to provide appropriate final connections.
6. Electrical cabling, conduits, cabling and final connections all to be installed by Suffolk Town Council Sub-contractor. Underground ducting to be provided by main contractor as shown and noted, subject to final design with sub-contractor.

Car parking spaces
Car parking spaces to match older standards as currently marked of 2.4m wide x 4.8m deep. Where spaces are opposite each other provide a minimum 6m between to allow manoeuvring. 1.2m hatched areas to side and rear of disabled parking bays. Where spaces are laid end to end they are to be 2.5m wide x 6m long

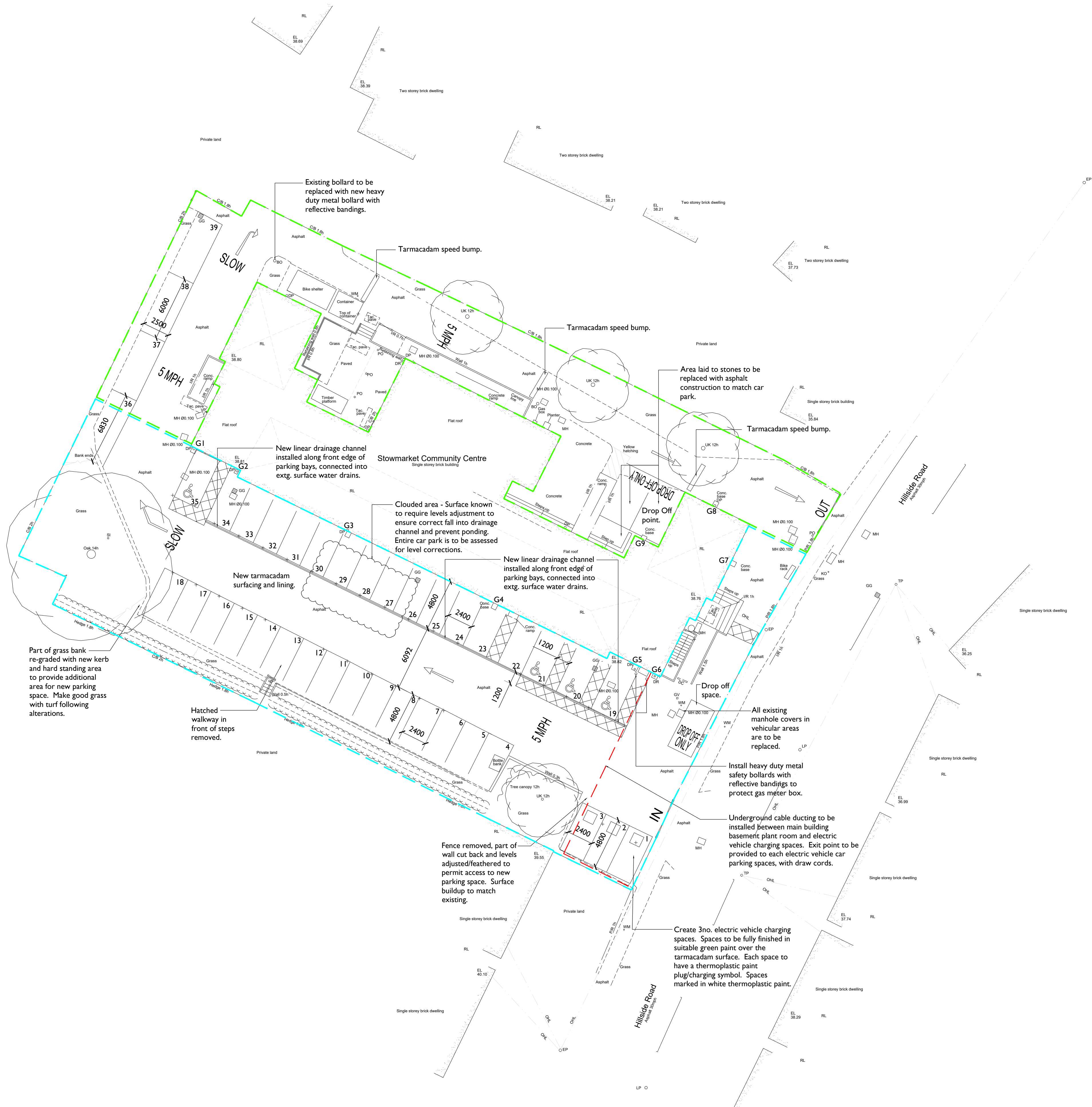

Notes: 20/09/2021 10:26:22

Drawings are based on survey data and may not accurately represent what is physically present.





Do not scale from this drawing. All dimensions are to be verified on site before proceeding with the work.

All dimensions are in millimeters unless noted otherwise.

Purcell shall be notified in writing of any discrepancies.

Key Plan
not to scale

KEY:

-  Works Area 1
-  Works Area 2
-  New underground cable ducting.
-  Thermoplastic markings
-  Thermoplastic text

This drawing is based on an existing topographical survey carried out by Survey Solutions, drawing 351691 PLS-01, dated 02-08-2021. This drawing should be read alongside the existing topographical survey drawing.

P01	13/08/2021	SN	SN	-
P02	19/08/2021	SN	SN	-
P02	19/08/2021	SN	SN	-
P03	13/09/2021	SN	SN	-
P03	20/09/2021	SN	SN	-
REV	DATE	BY	CHK	DESCRIPTION

CLIENT	 PURCELL
Stowmarket Town Council	
PROJECT	
Stowmarket Community Centre	
JOB NUMBER	
241410	
TITLE	
Proposed Site Plan	

SIZE	SCALE	LAST REVISED	DRAWN	CHECKED
A1L		20/09/2021	SN	SN
REV	SUITABILITY/REASON FOR ISSUE			
P03	S2 - For Information			
DRAWING NAME				
241410-PUR-00-ZZ-DR-A-2000				

