

TYPICAL SECTION THROUGH AREAS A & B  
nts

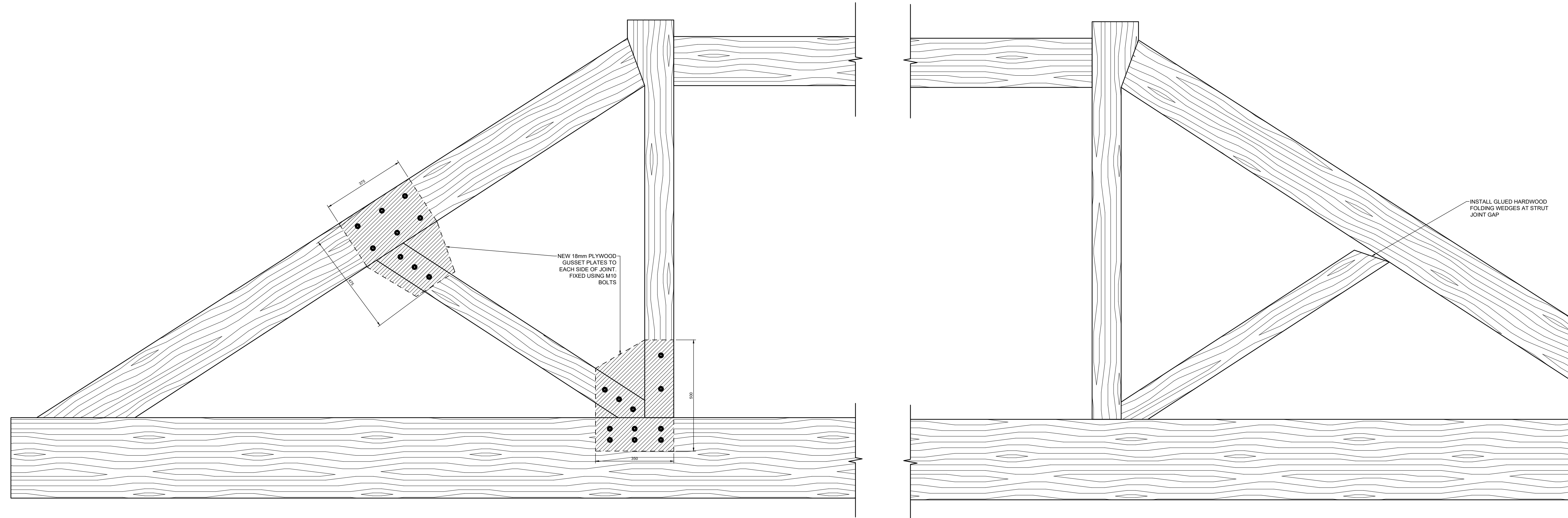

DETAIL 1: TRUSS C1 - STRUT REPAIR  
scale 1:5@A1

DETAIL 2: TRUSS C1 - JOINT GAP REPAIR  
scale 1:5@A1

- GENERAL NOTES
- THIS DRAWING IS TO BE READ IN CONJUNCTION WITH ALL RELEVANT ARCHITECTS, ENGINEERS AND SPECIALIST DRAWINGS AND SPECIFICATIONS
  - DO NOT SCALE FROM THIS DRAWING IN EITHER PAPER OR DIGITAL FORM. USE WRITTEN DIMENSIONS ONLY.

- STRUCTURAL REPAIR NOTES
- THE CONTRACTOR IS RESPONSIBLE FOR THE DESIGN AND INSTALLATION OF TEMPORARY WORKS. THEIR PROPOSALS MUST BE SUBMITTED TO THE STRUCTURAL ENGINEER SUFFICIENTLY IN ADVANCE OF THE WORKS STARTING TO PERMIT COMMENT. UNDER NO CIRCUMSTANCES SHOULD ANY STRUCTURAL ALTERATIONS BE CARRIED OUT PRIOR TO THE STRUCTURAL ENGINEER COMMENTING ON THE CONTRACTORS TEMPORARY WORKS PROPOSALS.
  - REFER TO DRAWING DR-S-1000 FOR REPAIR LOCATIONS ON PLAN.
  - NEW PLYWOOD GUSSET PLATES ARE TO BE CUT FROM 18mm THK. WBP. ALL NEW BOLTS TO BE GRADE 8.8.
  - USE PACKERS AS NEEDED TO ENSURE GOOD CONTACT BETWEEN THE GUSSET PLATES AND ALL TRUSS MEMBERS.
  - INSTALL HARDFOLDING WEDGES TO JOINT GAP. ENSURE TIGHT FIT AND GLUE IN POSITION USING D4 RATED WOOD ADHESIVE.

NOT FOR CONSTRUCTION

T1	23.12.21	TENDER ISSUE	SW	SW
Rev	Date	Description	Drawn	Check

**conisbee** | Consulting Structural Engineers  
Consulting Civil Engineers  
London • Cambridge • Norwich  
1-5 Offord St London N1 1DH  
Telephone 020 7700 6666  
www.conisbee.co.uk

Drawing Status	TENDER
Project	HORNIMAN MUSEUM SCC BUILDING, GREENWICH
Title	CEILING REPAIR WORKS TRUSS C1 - STRUT REPAIR
Drawing No	210572.CON.X.RE.DR.S.4001
Date	DEC 2021
Scale	AS SHOWN
Drawn	SW
Engineer	SW
Project No	210572
Revision	T1