

Downham Market Town Council

15 Paradise Road, Downham Market, Norfolk PE38 9HS

Tel: (01366) 387770

E-Mail: info@downhammarkettc.co.uk

Town Clerk: Mrs J M Markwell

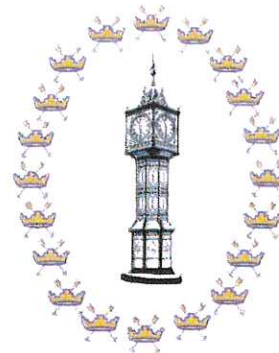

Proposed refurbishment of W.C. facilities at Downham Market Town Hall,
Downham Market, Norfolk

The proposed works shall include the refurbishment of existing "Male",
"Female" and "Disabled" toilet facilities

Ceilings – repair as necessary ; 2 coats white emulsion – "Dulux" or "Crown"
oil-based/eggshell finish

Walls – Remove tiles, and wallpaper ("disabled access" w.c.), make good as
required and finish with 2 coats emulsion – "Dulux" or "Crown" oil
based/eggshell finish - colours to be agreed with Downham Market Town
Council. Wall surface incorporating chimney breast within "Female" toilets to
be feature wall of contrasting colour. Supply and fix full length mirror to face of
existing chimney breast. Supply and install "worktop" with lockable cupboard
under to LHS of chimney breast to match replacement wash hand basin unit
Supply and fix mirrors above wash hand basin areas – to female w.c. 2400
mm. wide x 600mm high, to male w.c. 1500mm. wide x 600mm high

Toilet cubicles – sand down and prepare existing doors and frames – finish
with 2 coats undercoat and one coat gloss finish – "Dulux" or "Crown" paint
Replace all door handles and locks, to be agreed with Downham Market Town
Council – allow P.C. sum of £20.00/door + fitting. Box in existing pipework
using exterior quality ply to toilet cubicles and make good – screw fixed
construction to enable access for future maintenance

Downham Market Town Council

15 Paradise Road, Downham Market, Norfolk PE38 9HS

Tel: (01366) 387770

E-Mail: info@downhammarkettc.co.uk

Town Clerk: Mrs J M Markwell

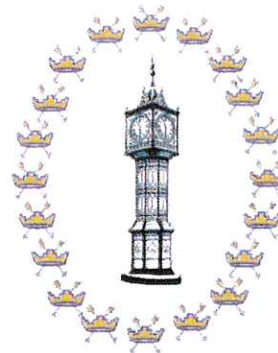

Remove and dispose of existing W.C.s and replace with WC pans and separate cisterns – water supply and waste as existing

Remove and dispose of existing 5 no. urinals and privacy screens, and replace with 4 no. urinals – 1 no. urinal at lower level than others for use by children. Water supply and waste as existing

Wash hand basins – Remove and dispose of existing WHBs – replace with “inset” basins within 450mm deep counter top – 3 no. basins to “Female” and 2 no. basins to “Male”, to be agreed with the Town Council. Hot and cold water supplies and waste as existing. 300mm. high splashback to be of the same material as the “worktop” counter. Supply and fix paper towel dispensers and soap dispensers (at a rate of one soap dispenser/ wash hand basin) to both “Female” and “Male” areas. Create set back lockable cupboards below “worktop” to enable access to pipework for future maintenance.

Sand down and prepare existing window frames in “Female” toilets – finish with 2 coats undercoat and 1 coat gloss finish – “Dulux” or “Crown” paint

Remove existing I.C. access and replace and make good with 550mm dia. cover and frame complete with air tight seal and screw down cover – finish with “Altro” or equivalent floor covering as specified below

Floor – supply and lay self levelling floor compound over existing tiled floor, supply and lay “Altro” or equivalent floor finish with 150mm upstand to all walls – to be agreed with the Town Council. Maintain access to I.C.

Supply and install mechanical extract ventilators – 1 no. to “Female” toilet and 1 no. to “Male” toilet, to outside atmosphere, capable of 30 litres per second each, linked to sensor to primary entrance doors – in “female” toilets mechanical vent to also be light sensitive.

Downham Market Town Council

15 Paradise Road, Downham Market, Norfolk PE38 9HS

Tel: (01366) 387770

E-Mail: info@downhammarkettc.co.uk

Town Clerk: Mrs J M Markwell

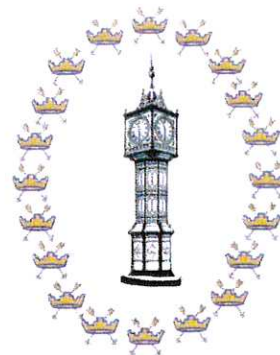

Remove and dispose of existing strip lighting. In "Female" toilet replace with 2 no. pendant lights to match those in existing Town Hall entrance foyer and 1 no. circular light fitting to lobby In "Male" toilet – total 3 ceiling mounted, circular light fittings to be agreed with Downham Market Town Council

NOTE – All electrical work to be carried out by suitably competent person who shall issue to Downham Market Town Council, a notice confirming compliance with Part B – Building Regs.

Replace primary entrance doors to male, female and "disabled" w.c. with doors to match those existing within the entrance foyer. Ditto to door furniture

Space heating – replace existing radiators with thermostatically controlled radiators – set aside existing radiators

Remove and dispose of all waste material from site

Provide and maintain site security in accordance with current HSE requirements

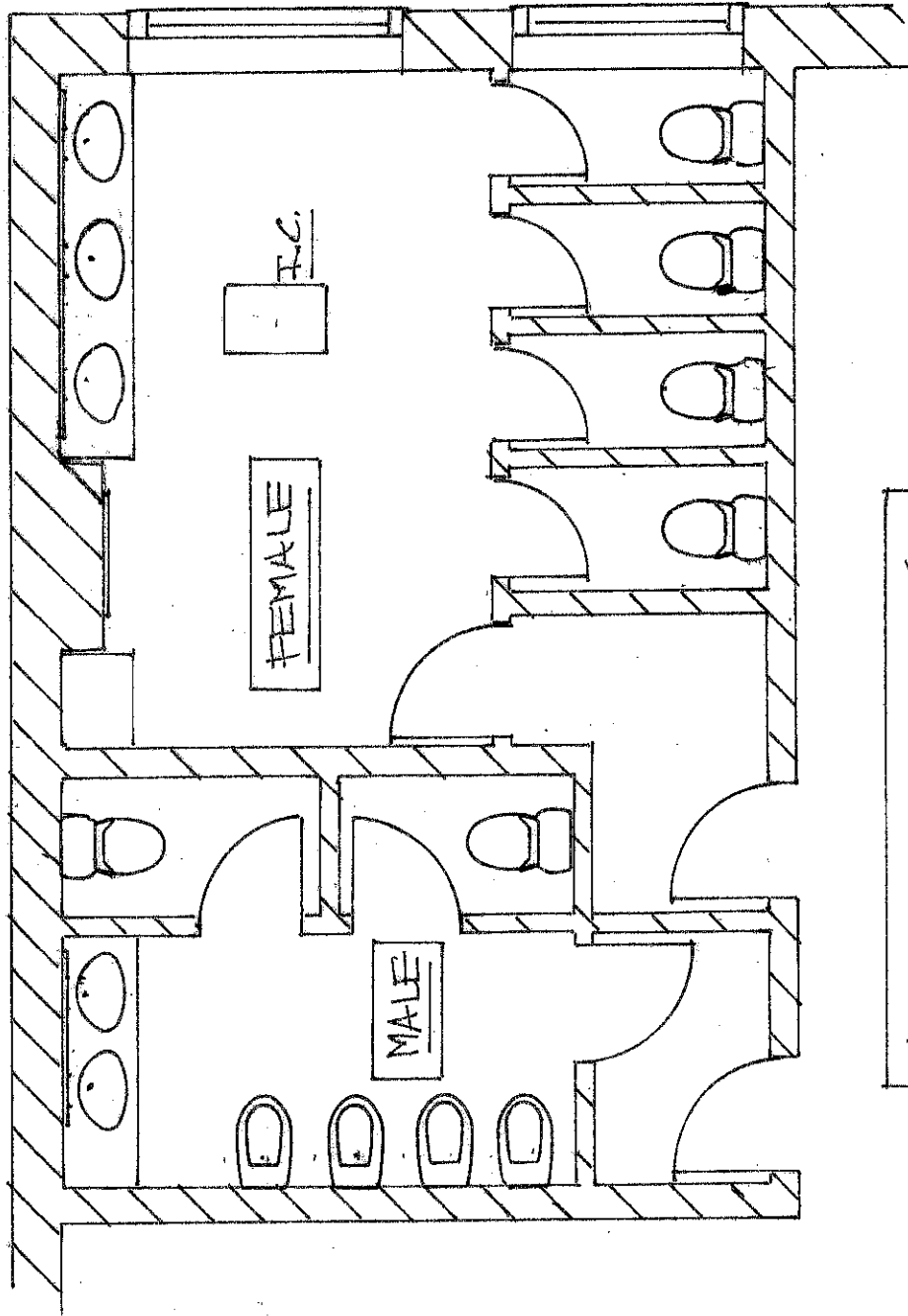

FLOOR PLAN 1:50

FLOOR TO CEILING - 3.350