

Toilet Block Plan - Proposed

1 : 25

Wall Types Key



Existing wall - construction to be surveyed

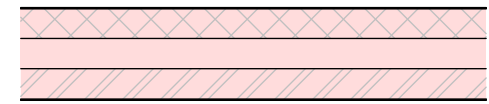

EW01
102.5mm Facing brick
50mm Cavity
120mm Mineral wool insulation
100mm concrete blockwork



IW01
15mm plasterboard
70mm metal stud
15mm plasterboard



IW02
15mm plasterboard on
Timber frame to form plumbing void boxing



IW03
12.5mm plasterboard on furrings

Notes

Do not scale from this document, unless for the purposes of planning applications where a scale bar is provided. Refer to figured dimensions only. All dimensions to be verified on site prior to construction. Report all discrepancies or ambiguities to the Document Originator immediately. This document is to be read in conjunction with relevant documents, drawings and standards.

P02	09-09-24	Revised layout to reflect latest design changes	JM	JO
P01	05-07-24	Issued for client sign off	JM	JO

Rev	Date	Notes	Dm	Chk'd
-----	------	-------	----	-------

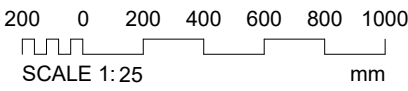

Document Originator

AWW

London 106 Weston Street, SE1 3QB 020 7160 6000
Plymouth East Quay House, PL4 0HX 01752 261 262
Bristol pivot + mark, 48-52 Baldwin Street, BS1 1QB 0117 923 2535

RIBA Chartered Practice www.aww-uk.com

Client
Petersfield Town Council

AWW Project Number 4726 Project Stage RIBA Stage 2

Project Title
Petersfield Heath Welfare Facilities

Title
Plan - Refurbishment - Proposed

Scale @ A1 1 : 25 Document Status S2 - For Information

Project	Origin	Volume	Level	Type	Role	Number	Rev
4781	AWW	RE	XX	DR	A	20001	P02