

LOCATION PLAN  
NOT TO SCALE

- NOTES
- 1. DIMENSIONS ARE IN METRES (m) UNLESS OTHERWISE STATED.
  - 2. THIS DRAWING SHOULD NOT BE SCALED.
  - 3. THIS DRAWING IS FOR INFORMATION ONLY.
  - 4. STRUCTURES INFORMATION HAS BEEN PROVIDED FOR STRUCTURES THAT ARE LIKELY TO BE AFFECTED BY THE PROPOSED WORKS.

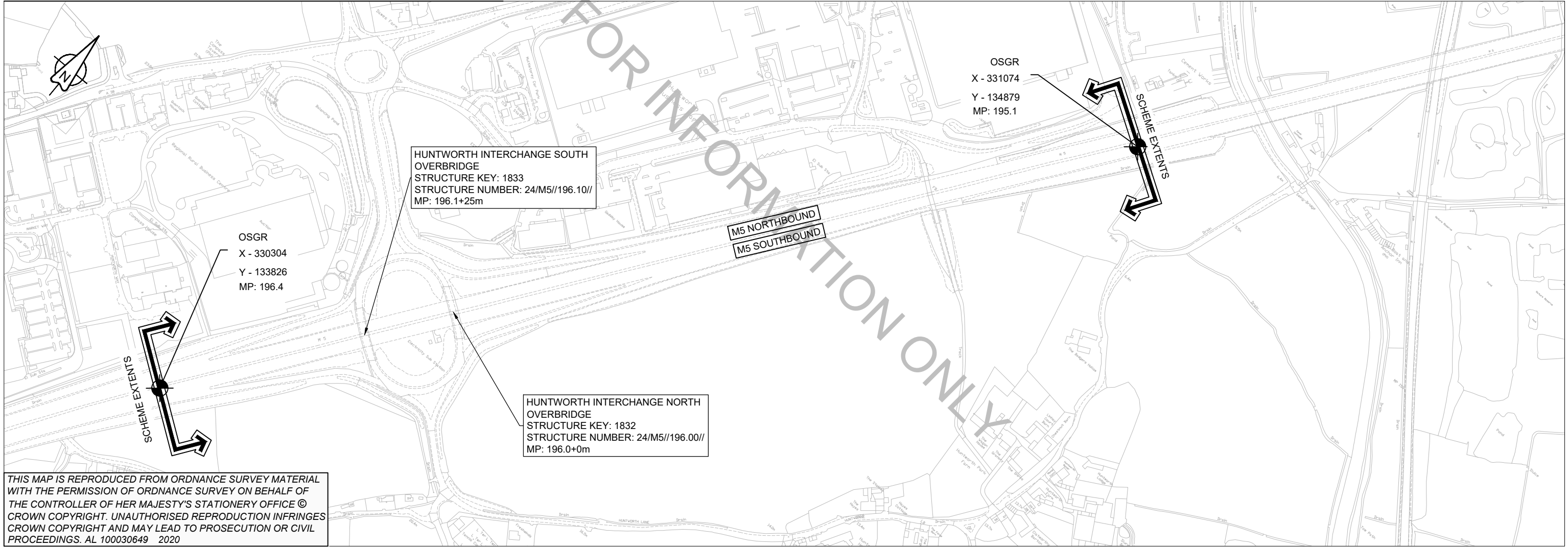

THIS MAP IS REPRODUCED FROM ORDNANCE SURVEY MATERIAL WITH THE PERMISSION OF ORDNANCE SURVEY ON BEHALF OF THE CONTROLLER OF HER MAJESTY'S STATIONERY OFFICE © CROWN COPYRIGHT. UNAUTHORISED REPRODUCTION INFRINGES CROWN COPYRIGHT AND MAY LEAD TO PROSECUTION OR CIVIL PROCEEDINGS. AL 100030649 2020

CLIENT

AGENT

SCHEME NAME		570131D PRIORITY VRS VM DEVELOPMENT BATCH 1			
DRAWING TITLE		619 SITE 16 - M5 J23-J24 BD MP 195.1-196 VRS CENTRAL RESERVATION			
		LOCATION PLAN			
DRAWN : CW		SCALE : 1:5000		DRAWING STATUS	
DESIGN : CW		DIMENSIONS : AS STATED		WORK IN PROGRESS	
CHKD : SR		ORIG DWG SIZE: A3		PRELIMINARY DRAWING	
APPD : SR		COPYRIGHT© KIER		EXTERNAL ISSUE	✓
DATE : 30/09/2020				AS-BUILT	
SUITABILITY: S2		FOR INFORMATION			

C1	ISSUED FOR CONSTRUCTION.	LAH	SR	10/02/2021
P1	FOR INFORMATION	SR	SR	30/09/2020
REV	DETAILS	CHKD	APPD	DATE

DRAWING NUMBER			SCHEME REFERENCE No.	
PROJECT	ORIGINATOR	VOLUME	1040304	
HE570131D	KIER	HGN	REVISION	
M5_J24_CR	DR	CH	C 1	
LOCATION	TYPE	ROLE	NUMBER	







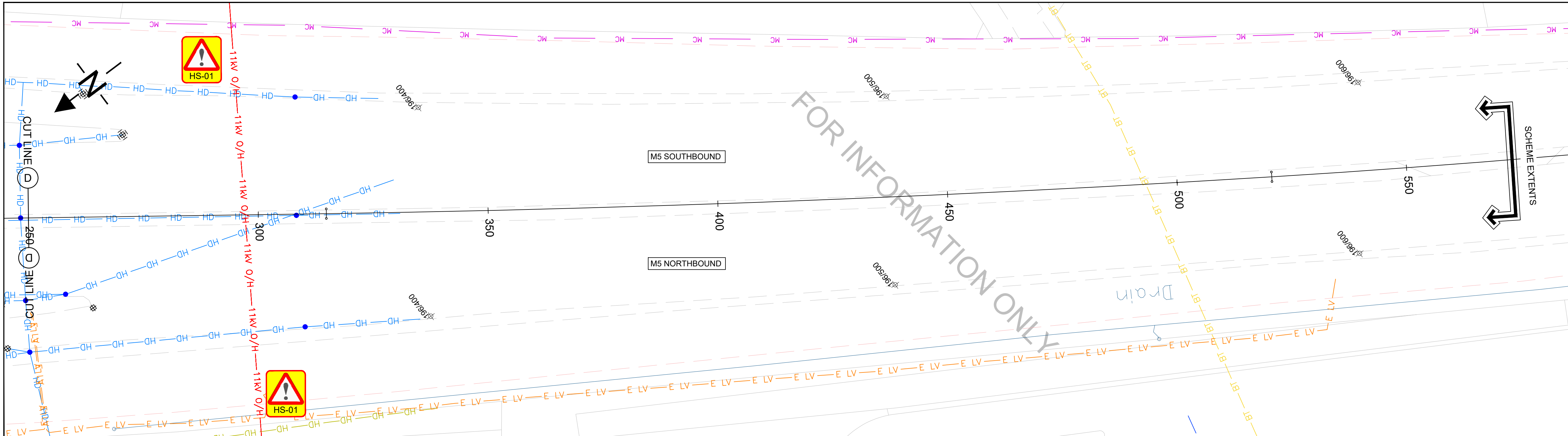
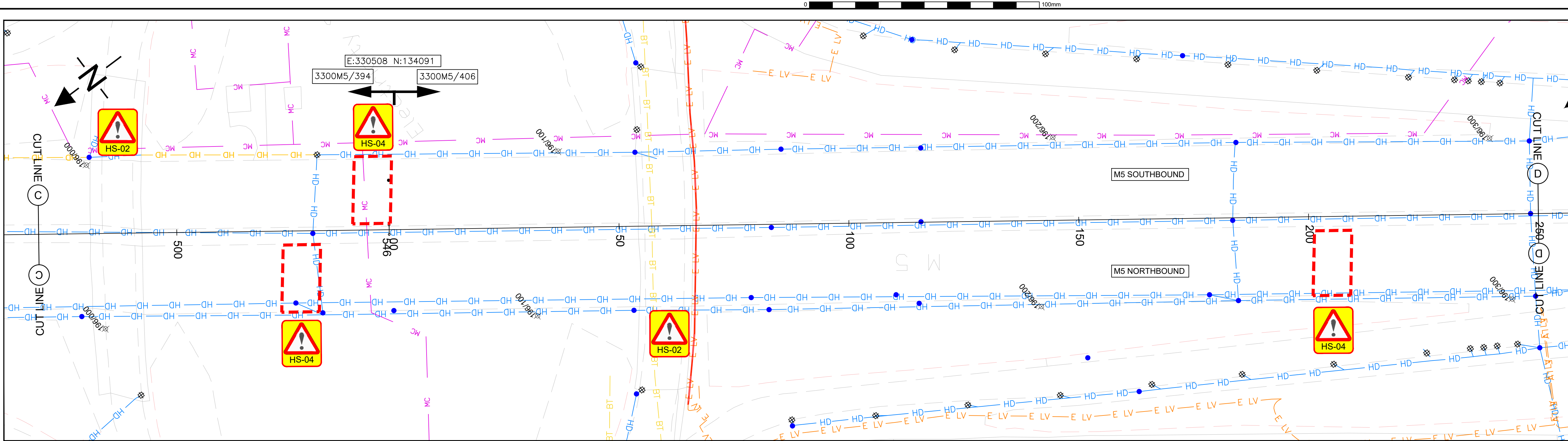

## RESIDUAL DESIGN HAZARDS

THE FOLLOWING HAS BEEN COLLECTED FROM THE PRE-CONSTRUCTION INFORMATION AND HIGHLIGHTS KNOWN RESIDUAL HAZARDS.

KEY	HS-#	= HEALTH AND SAFETY RISK REFERENCE NUMBER
	E-#	= ENVIRONMENT RISK REFERENCE NUMBER

PLEASE DELETE / AMEND THIS TEXT TO SUIT (EXAMPLE ENTRY BELOW)

HS-01 - EXISTING OVERHEAD ELECTRICITY CABLES  
HS-02 - EXISTING OVERHEAD STRUCTURES  
HS-03 - UNDERBRIDGE STRUCTURES  
HS-04 - TRAFFIC LOOPS  
HS-05 - STATUTORY UNDERTAKERS (UNDERGROUND)  
HS-06 - GANTRY  
HS-07 - EXISTING CULVERT  
HS-08 - POTENTIAL ASBESTOS CONTAMINATED MATERIALS (ACM)  
E-01 - INVASIVE SPECIES  
E-02 - PROTECTED SPECIES  
E-03 - DITCHES/WATERCOURSE

## NOTES

- THIS DRAWING IS TO BE READ IN CONJUNCTION WITH ALL OTHER DRAWINGS WITHIN THE SERIES.
- LOCATION OF STATUTORY UNDERTAKERS SERVICES ARE INDICATIVE ONLY. NO GUARANTEE IS GIVEN TO ITS ACCURACY. FOR CONSTRUCTION PURPOSES REFER TO STATUTORY UNDERTAKERS PLANS IN THE DESIGN INFORMATION PACK.
- MARKER POSTS ARE SHOWN FOR INDICATIVE PURPOSE ONLY. CHAINAGES SHOWN ON THIS DRAWING HAVE BEEN SET OUT AT LEAST EVERY 50m ALONG THE CHART SECTIONS INDICATED THROUGHOUT THE EXTENTS OF THE WORKS.
- THE OVERHEAD CABLES HAVE BEEN IDENTIFIED ON THE SCHEME DRAWINGS, HOWEVER INFORMATION REGARDING SAFE WORKING HEIGHTS IN ACCORDANCE WITH GS6 HAS NOT BEEN INDICATED. PRIOR TO THE COMMENCEMENT OF WORKS ON SITE, OVERHEAD CABLE HEIGHTS TO BE CONFIRMED AND RECORDED BY WAY OF SIGNATURE AND DATE BY A TRAINED AND COMPETENT PERSON.
- HADDMS DATA SHOWS THE DEPTH TO INVERT OF THE HIGHWAY DRAINAGE PIPE ALONG THE CENTRAL RESERVATION TO BE 2m.

## KEY

BT	BT	BRITISH TELECOM - UNDERGROUND
HD	HD	HIGHWAY DRAIN
HD	HD	HIGHWAY DITCH
SW	SW	SURFACE WATER DRAIN
E LV	E LV	ELECTRICITY LV - UNDERGROUND
11kV O/H	11kV O/H	ELECTRICITY 11kV - OVERHEAD
MC	MC	MOTORWAY COMMUNICATIONS
●	●	MANHOLE
●	●	GULLY

C1	ISSUED FOR CONSTRUCTION.	LAH	SR	10/02/2021
P1	FOR INFORMATION	SR	SR	30/09/2020
REV	DETAILS	CHKD	APPD	DATE

DRAWN : MRH	DRAWING STATUS
DESIGN : MRH	WORK IN PROGRESS
CHKD : SR	PRELIMINARY DRAWING
APPD : SR	EXTERNAL ISSUE
DATE : 30/09/2020	AS-BUILT
SUITABILITY : S2	FOR INFORMATION

CLIENT



AGENT



SCHEME NAME

570131D PRIORITY VRS VM  
DEVELOPMENT BATCH 1

DRAWING TITLE

619 SITE 16 - M5 J23-J24 BD  
MP 195.1-196  
CENTRAL RESERVATION  
STATUTORY UNDERTAKERS PLAN  
SHEET 2 OF 2

ORIG DRAWING SIZE :	A1	DIMENSIONS :	m
COPYRIGHT © KIER		SCALE :	1:500

DRAWING NUMBER	PROJECT	ORIGINATOR	VOLUME	SCHEME REFERENCE No.
HE570131D -	KIER	HGN		1040304
M5_J24_CR	- DR	- CH	- 010005	REVISION
LOCATION	TYPE	ROLE	NUMBER	C 1

THIS MAP IS REPRODUCED FROM ORDNANCE SURVEY MATERIAL WITH THE PERMISSION OF ORDNANCE SURVEY ON BEHALF OF THE CONTROLLER OF HER MAJESTY'S STATIONERY OFFICE © CROWN COPYRIGHT. UNAUTHORISED REPRODUCTION INFRINGES CROWN COPYRIGHT AND MAY LEAD TO PROSECUTION OR CIVIL PROCEEDINGS. AL 100030649 2020

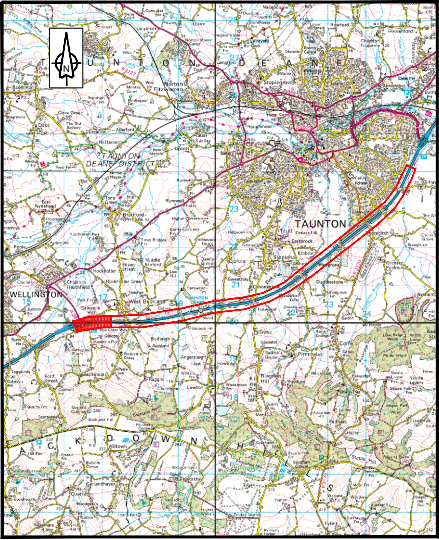
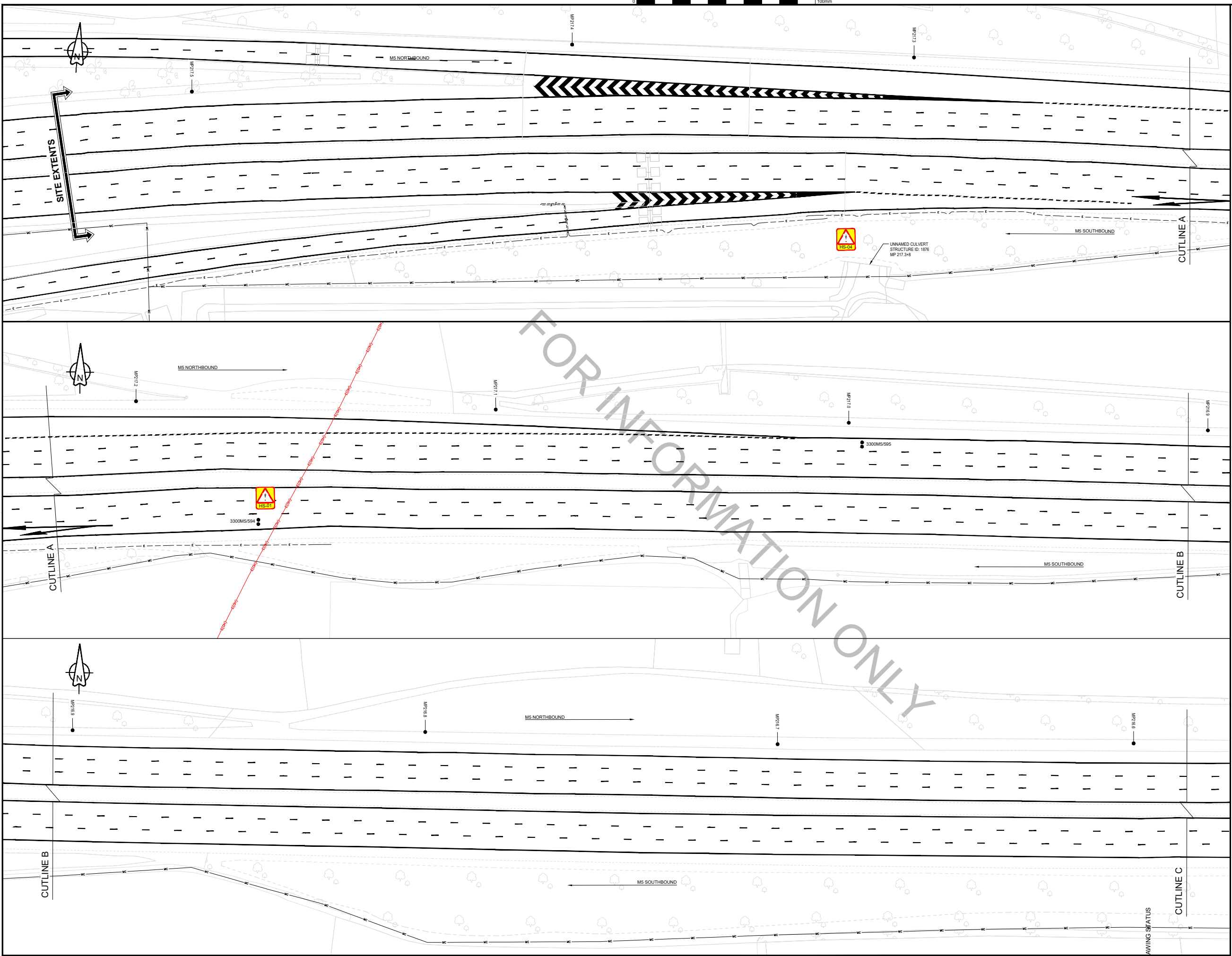

**RESIDUAL DESIGN HAZARDS**

THE FOLLOWING HAS BEEN COLLECTED FROM THE PRE-CONSTRUCTION INFORMATION AND HIGHLIGHTS KNOWN RESIDUAL HAZARDS.

**KEY**

HS-# = HEALTH AND SAFETY RISK REFERENCE NUMBER  
E-# = ENVIRONMENT RISK REFERENCE NUMBER

HS-01 - OVERHEAD ELECTRICITY CABLES  
HS-02 - GAS PIPELINE  
HS-03 - OVERBRIDGE  
HS-04 - WATERCOURSE  
HS-05 - UNDERBRIDGE  
HS-06 - GANTRY

- NOTES**
- THIS IS A C.A.D. DRAWING AND SHOULD NOT BE AMENDED BY HAND.
  - DO NOT SCALE FROM THIS DRAWING. USE STATED DIMENSIONS ONLY. ALL DIMENSIONS ARE IN METRES UNLESS OTHERWISE STATED.
  - THIS DRAWING SHOULD BE PRINTED AND READ IN COLOUR ONLY.
  - THE UTILITIES INDICATED ON THIS DRAWING HAS BEEN PREPARED FOR INFORMATION ONLY AND IS NOT TO BE USED FOR CONSTRUCTION SITE INVESTIGATION OR LOCATING SERVICES.
  - THE LOCATION OF ALL SERVICES MUST BE CONFIRMED WITH THE RELEVANT SERVICE PROVIDER PRIOR TO UNDERTAKING ANY WORKS.
  - KIER TAKES NO RESPONSIBILITY FOR THE ACCURACY OR COMPLETENESS OF THE INFORMATION SHOWN ON THIS DRAWING, WHICH HAS BEEN COMPILED FROM PLANS PROVIDED BY THE UTILITY COMPANIES.

**STATS KEY**

TELEPHONE UNDERGROUND  
ELECTRICITY OVERHEAD  
ELECTRICITY UNDERGROUND  
MOTORWAY COMMS  
MARKER NODES  
TRAFFIC LOOPS  
OSGR COORDINATES

THIS MAP IS REPRODUCED FROM ORDNANCE SURVEY MATERIAL WITH THE PERMISSION OF ORDNANCE SURVEY ON BEHALF OF THE CONTROLLER OF HER MAJESTY'S STATIONERY OFFICE © CROWN COPYRIGHT. UNAUTHORISED REPRODUCTION INFRINGES CROWN COPYRIGHT AND MAY LEAD TO PROSECUTION OR CIVIL PROCEEDINGS. AL 100030649 2021



CLIENT  
AGENT  
SCHEME NAME  
DRAWING TITLE

570131D VRS GATEWAY 1A STUDY 2020-2021  
SCHEME 607 M5 J25 TO J26 MP 207.5-217.5  
STATUTORY UNDERTAKERS  
(SHEET 1 OF 11)

DRAWN : SB	SCALE : 1:500	WORK IN PROGRESS
DESIGN : SB	DIMENSIONS : m	PRELIMINARY DRAWING
CHKD : SC	ORIG DWG SIZE: A1	EXTERNAL ISSUE
APPD : SR	COPYRIGHT © KIER	AS-BUILT
DATE : 28/01/21		
SUITABILITY: S2	FOR INFORMATION	

P2	SCHEME SCOPE REDUCTION	GR	MRO	29/06/2021
P1	FIRST ISSUE	SC	SR	28/01/2021
REV	DETAILS	CHKD	APPD	DATE
DRAWING NUMBER				SCHEME REFERENCE No.
PROJECT   ORIGINATOR   VOLUME				570131
HE570131 - KIER - HRR				
M5_207.5_217.5 - DE - CH - 0000-01				REVISION
LOCATION   TYPE   ROLE   NUMBER				P2



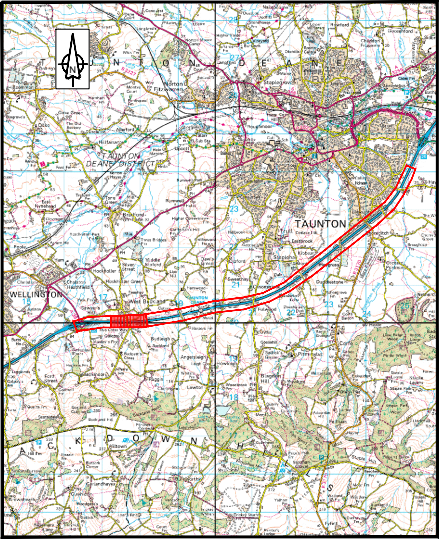
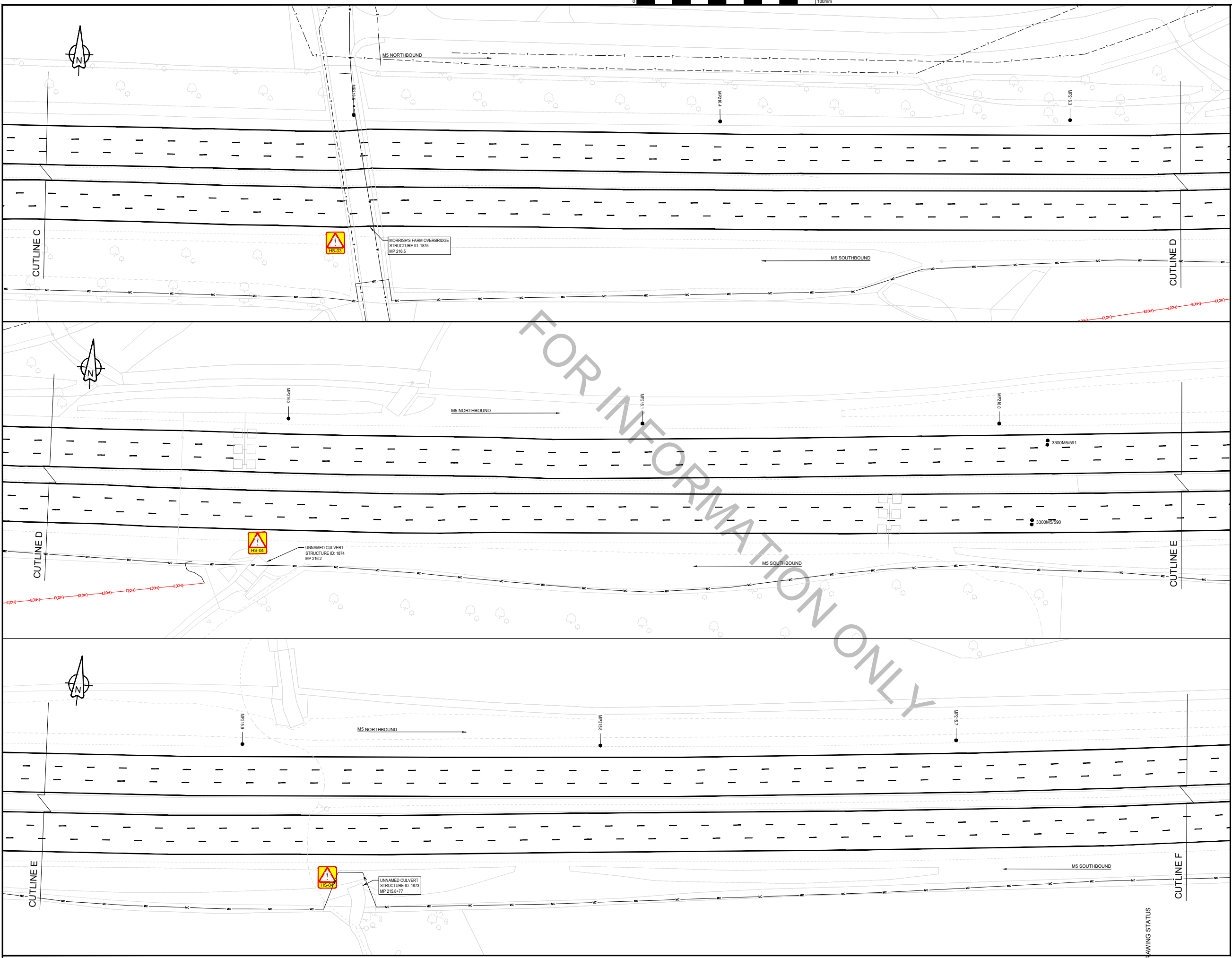

LOCATION PLAN  
1:250,000

**RESIDUAL DESIGN HAZARDS**

THE FOLLOWING HAS BEEN COLLECTED FROM THE PRE-CONSTRUCTION INFORMATION AND HIGHLIGHTS KNOWN RESIDUAL HAZARDS.

**KEY**

HS-# = HEALTH AND SAFETY RISK REFERENCE NUMBER  
E-# = ENVIRONMENT RISK REFERENCE NUMBER

- HS-01 - OVERHEAD ELECTRICITY CABLES**  
**HS-02 - GAS PIPELINE**  
**HS-03 - OVERBRIDGE**  
**HS-04 - WATERCOURSE**  
**HS-05 - UNDERBRIDGE**  
**HS-06 - GANTRY**

- NOTES**
1. THIS IS A C.A.D. DRAWING AND SHOULD NOT BE AMENDED BY HAND.
  2. DO NOT SCALE FROM THIS DRAWING. USE STATED DIMENSIONS ONLY. ALL DIMENSIONS ARE IN METRES UNLESS OTHERWISE STATED.
  3. THIS DRAWING SHOULD BE PRINTED AND READ IN COLOUR ONLY.
  4. THE UTILITIES INDICATED ON THIS DRAWING HAS BEEN PREPARED FOR INFORMATION ONLY AND IS NOT TO BE USED FOR CONSTRUCTION SITE INVESTIGATION OR LOCATING SERVICES.
  5. KIER TAKES NO RESPONSIBILITY FOR THE ACCURACY OR COMPLETENESS OF THE INFORMATION SHOWN ON THIS DRAWING, WHICH HAS BEEN COMPILED FROM PLANS PROVIDED BY THE UTILITY COMPANIES.
  6. THE LOCATION OF ALL SERVICES MUST BE CONFIRMED WITH THE RELEVANT SERVICE PROVIDER PRIOR TO UNDERTAKING ANY WORKS.

- STATS KEY**
- TELEPHONE UNDERGROUND ---
- WATER SUPPLIES ---
- MOTORWAY COMMS ---
- ELECTRICITY OVERHEAD ---
- MARKER NODES ●
- TRAFFIC LOOPS [Symbol]

THIS MAP IS REPRODUCED FROM ORDNANCE SURVEY MATERIAL WITH THE PERMISSION OF ORDNANCE SURVEY ON BEHALF OF THE CONTROLLER OF HER MAJESTY'S STATIONERY OFFICE © CROWN COPYRIGHT. UNAUTHORISED REPRODUCTION INFRINGES CROWN COPYRIGHT AND MAY LEAD TO PROSECUTION OR CIVIL PROCEEDINGS. AL 100030649 2021



CLIENT  
AGENT  
SCHEME NAME  
DRAWING TITLE

570131D VRS GATEWAY 1A STUDY 2020-2021  
SCHEME 607 M5 J25 TO J26 MP 207.5-217.5  
STATUTORY UNDERTAKERS  
(SHEET 2 OF 11)

DRAWN : SB	SCALE : 1:500	DRAWING STATUS
DESIGN : SB	DIMENSIONS : m	WORK IN PROGRESS
CHKD : SC	ORIG DWG SIZE: A1	PRELIMINARY DRAWING ✓
APPD : SR	COPYRIGHT © KIER	EXTERNAL ISSUE
DATE : 28/01/21		AS-BUILT
SUITABILITY: S2	FOR INFORMATION	

P2	SCHEME SCOPE REDUCTION	GR	MRO	29/06/2021
P1	FIRST ISSUE	SC	SR	28/01/2021
REV	DETAILS	CHKD	APPD	DATE
DRAWING NUMBER				
PROJECT	ORIGINATOR	VOLUME	SCHEME REFERENCE No.	
HE570131	KIER	HRR	570131	
M5_207.5_217.5	DE	CH	0000-02	REVISION
LOCATION	TYPE	ROLE	NUMBER	P2

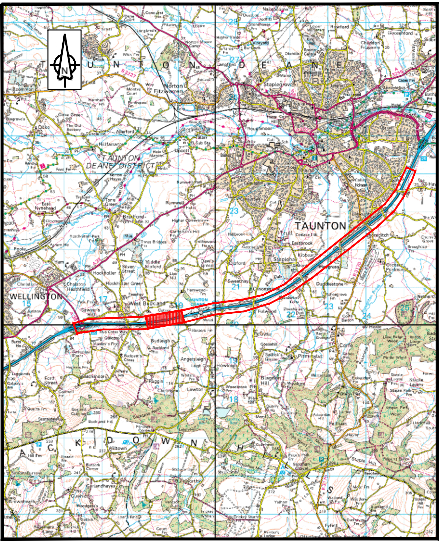
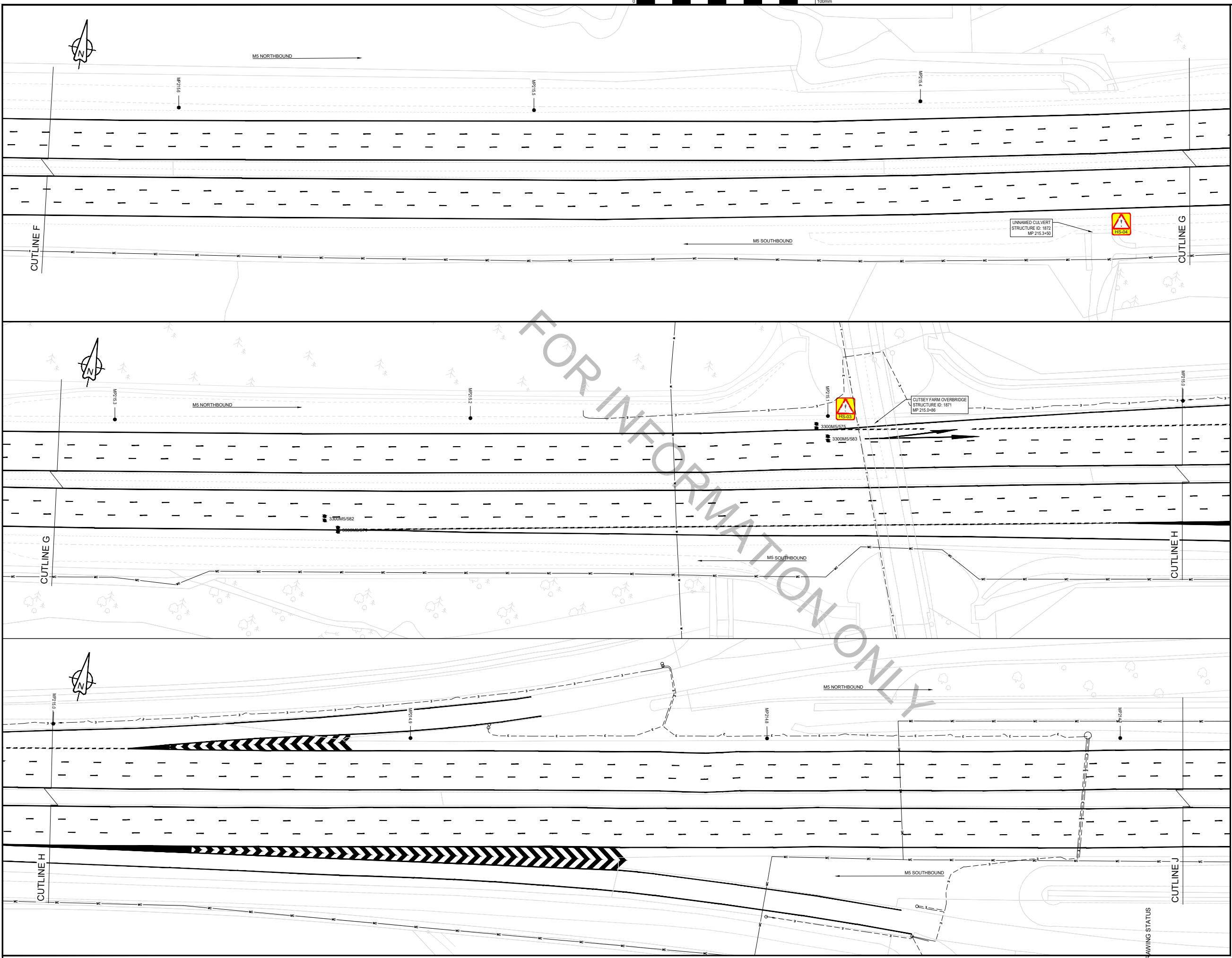

LOCATION PLAN  
1:250,000

RESIDUAL DESIGN HAZARDS

THE FOLLOWING HAS BEEN COLLECTED FROM THE PRE-CONSTRUCTION INFORMATION AND HIGHLIGHTS KNOWN RESIDUAL HAZARDS.

KEY HS-# = HEALTH AND SAFETY RISK REFERENCE NUMBER  
E-# = ENVIRONMENT RISK REFERENCE NUMBER

HS-01 - OVERHEAD ELECTRICITY CABLES  
HS-02 - GAS PIPELINE  
HS-03 - OVERBRIDGE  
HS-04 - WATERCOURSE  
HS-05 - UNDERBRIDGE  
HS-06 - GANTRY

NOTES

1. THIS IS A C.A.D. DRAWING AND SHOULD NOT BE AMENDED BY HAND.
2. DO NOT SCALE FROM THIS DRAWING. USE STATED DIMENSIONS ONLY. ALL DIMENSIONS ARE IN METRES UNLESS OTHERWISE STATED.
3. THIS DRAWING SHOULD BE PRINTED AND READ IN COLOUR ONLY.
4. THE UTILITIES INDICATED ON THIS DRAWING HAS BEEN PREPARED FOR INFORMATION ONLY AND IS NOT TO BE USED FOR CONSTRUCTION SITE INVESTIGATION OR LOCATING SERVICES.
5. THE LOCATION OF ALL SERVICES MUST BE CONFIRMED WITH THE RELEVANT SERVICE PROVIDER PRIOR TO UNDERTAKING ANY WORKS.
6. KIER TAKES NO RESPONSIBILITY FOR THE ACCURACY OR COMPLETENESS OF THE INFORMATION SHOWN ON THIS DRAWING, WHICH HAS BEEN COMPILED FROM PLANS PROVIDED BY THE UTILITY COMPANIES.

STATS KEY

TELEPHONE UNDERGROUND   
ELECTRICITY UNDERGROUND   
MOTORWAY COMMS   
MARKER NODES   
TRAFFIC LOOPS

THIS MAP IS REPRODUCED FROM ORDNANCE SURVEY MATERIAL WITH THE PERMISSION OF ORDNANCE SURVEY ON BEHALF OF THE CONTROLLER OF HER MAJESTY'S STATIONERY OFFICE © CROWN COPYRIGHT. UNAUTHORISED REPRODUCTION INFRINGES CROWN COPYRIGHT AND MAY LEAD TO PROSECUTION OR CIVIL PROCEEDINGS. AL 100030649 2021

P2	SCHEME SCOPE REDUCTION	GR	MRO	29/06/2021
P1	FIRST ISSUE	SC	SR	28/01/2021
REV	DETAILS	CHKD	APPD	DATE
DRAWING NUMBER				
PROJECT		ORIGINATOR	VOLUME	SCHEME REFERENCE No.
HE570131		KIER	HRR	570131
M5_207.5_217.5 - DE - CH - 0000-03		REVISION		P2
LOCATION	TYPE	ROLE	NUMBER	



SCHEME NAME  
570131D VRS GATEWAY 1A STUDY 2020-2021  
SCHEME 607 M5 J25 TO J26 MP 207.5-217.5  
STATUTORY UNDERTAKERS  
(SHEET 3 OF 11)

DRAWN : SB	SCALE : 1:500	DRAWING STATUS
DESIGN : SB	DIMENSIONS : m	WORK IN PROGRESS
CHKD : SC	ORIG DWG SIZE : A1	PRELIMINARY DRAWING ✓
APPD : SR	COPYRIGHT © KIER	EXTERNAL ISSUE
DATE : 28/01/21		AS-BUILT
SUITABILITY : S2	FOR INFORMATION	



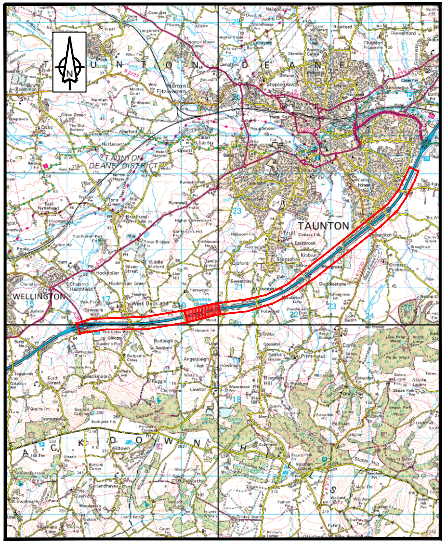

LOCATION PLAN  
1:250,000

RESIDUAL DESIGN HAZARDS

THE FOLLOWING HAS BEEN COLLECTED FROM THE PRE-CONSTRUCTION INFORMATION AND HIGHLIGHTS KNOWN RESIDUAL HAZARDS.







KEY  HS-# = HEALTH AND SAFETY RISK REFERENCE NUMBER  
E-# = ENVIRONMENT RISK REFERENCE NUMBER

- HS-01 - OVERHEAD ELECTRICITY CABLES  
HS-02 - GAS PIPELINE  
HS-03 - OVERBRIDGE  
HS-04 - WATERCOURSE  
HS-05 - UNDERBRIDGE  
HS-06 - GANTRY

NOTES

1. THIS IS A C.A.D. DRAWING AND SHOULD NOT BE AMENDED BY HAND.
2. DO NOT SCALE FROM THIS DRAWING. USE STATED DIMENSIONS ONLY. ALL DIMENSIONS ARE IN METRES UNLESS OTHERWISE STATED.
3. THIS DRAWING SHOULD BE PRINTED AND READ IN COLOUR ONLY.
4. THE UTILITIES INDICATED ON THIS DRAWING HAS BEEN PREPARED FOR INFORMATION ONLY AND IS NOT TO BE USED FOR CONSTRUCTION/SITE INVESTIGATION OR LOCATING SERVICES.
5. THE LOCATION OF ALL SERVICES MUST BE CONFIRMED WITH THE RELEVANT SERVICE PROVIDER PRIOR TO UNDERTAKING ANY WORKS.
6. KIER TAKES NO RESPONSIBILITY FOR THE ACCURACY OR COMPLETENESS OF THE INFORMATION SHOWN ON THIS DRAWING, WHICH HAS BEEN COMPILED FROM PLANS PROVIDED BY THE UTILITY COMPANIES.

STATS KEY

- TELEPHONE UNDERGROUND   
ELECTRICITY UNDERGROUND   
WATER SUPPLIES   
MOTORWAY COMMS   
MARKER NODES   
TRAFFIC LOOPS 

THIS MAP IS REPRODUCED FROM ORDNANCE SURVEY MATERIAL WITH THE PERMISSION OF ORDNANCE SURVEY ON BEHALF OF THE CONTROLLER OF HER MAJESTY'S STATIONERY OFFICE © CROWN COPYRIGHT. UNAUTHORISED REPRODUCTION INFRINGES CROWN COPYRIGHT AND MAY LEAD TO PROSECUTION OR CIVIL PROCEEDINGS. AL 100030649 2021

P2	SCHEME SCOPE REDUCTION	GR	MRO	29/06/2021
P1	FIRST ISSUE	SC	SR	28/01/2021
REV	DETAILS	CHKD	APPD	DATE
DRAWING NUMBER				SCHEME REFERENCE No.
PROJECT   ORIGINATOR   VOLUME				570131
HE570131 - KIER - HRR				REVISION
M5_207.5_217.5 - DE - CH - 0000-04				P2
LOCATION	TYPE	ROLE	NUMBER	

CLIENT



AGENT



SCHEME NAME

570131D VRS GATEWAY 1A STUDY 2020-2021  
SCHEME 607 M5 J25 TO J26 MP 207.5-217.5  
STATUTORY UNDERTAKERS  
(SHEET 4 OF 11)

DRAWING TITLE

DRAWN : SB

DESIGN : SB

CHKD : SC

APPD : SR

DATE : 28/01/21

SUITABILITY: S2

SCALE : 1:500

DIMENSIONS : m

ORIG DWG SIZE: A1

COPYRIGHT © KIER

FOR INFORMATION

DRAWING STATUS

WORK IN PROGRESS

PRELIMINARY DRAWING

EXTERNAL ISSUE

AS-BUILT

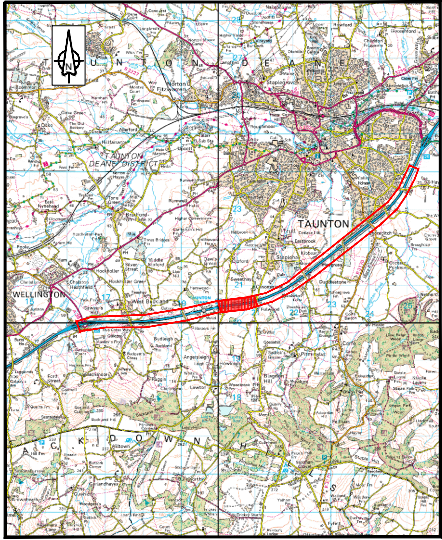
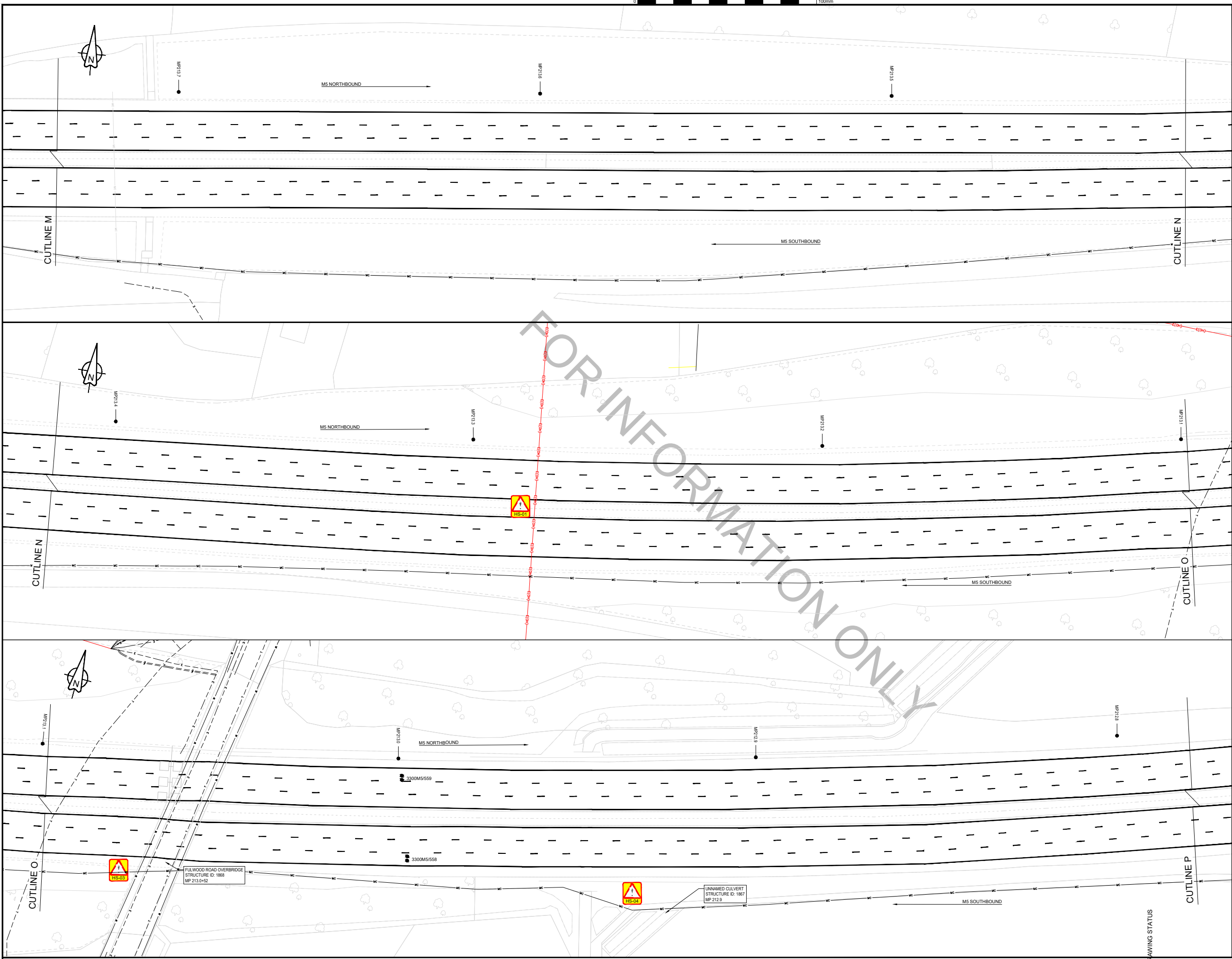

LOCATION PLAN  
1:250,000

RESIDUAL DESIGN HAZARDS

THE FOLLOWING HAS BEEN COLLECTED FROM THE PRE-CONSTRUCTION INFORMATION AND HIGHLIGHTS KNOWN RESIDUAL HAZARDS.







KEY  HS-# = HEALTH AND SAFETY RISK REFERENCE NUMBER  
E-# = ENVIRONMENT RISK REFERENCE NUMBER

HS-01 - OVERHEAD ELECTRICITY CABLES  
HS-02 - GAS PIPELINE  
HS-03 - OVERBRIDGE  
HS-04 - WATERCOURSE  
HS-05 - UNDERBRIDGE  
HS-06 - GANTRY

NOTES

1. THIS IS A C.A.D. DRAWING AND SHOULD NOT BE AMENDED BY HAND.
2. DO NOT SCALE FROM THIS DRAWING: USE STATED DIMENSIONS ONLY. ALL DIMENSIONS ARE IN METRES UNLESS OTHERWISE STATED.
3. THIS DRAWING SHOULD BE PRINTED AND READ IN COLOUR ONLY.
4. THE UTILITIES INDICATED ON THIS DRAWING HAS BEEN PREPARED FOR INFORMATION ONLY AND IS NOT TO BE USED FOR CONSTRUCTION SITE INVESTIGATION OR LOCATING SERVICES.
5. THE LOCATION OF ALL SERVICES MUST BE CONFIRMED WITH THE RELEVANT SERVICE PROVIDER PRIOR TO UNDERTAKING ANY WORKS.
6. KIER TAKES NO RESPONSIBILITY FOR THE ACCURACY OR COMPLETENESS OF THE INFORMATION SHOWN ON THIS DRAWING, WHICH HAS BEEN COMPILED FROM PLANS PROVIDED BY THE UTILITY COMPANIES.

STATS KEY

TELEPHONE UNDERGROUND   
ELECTRICITY OVERHEAD   
ELECTRICITY UNDERGROUND   
WATER SUPPLIES   
MOTORWAY COMMS   
MARKER NODES   
TRAFFIC LOOPS 

THIS MAP IS REPRODUCED FROM ORDNANCE SURVEY MATERIAL WITH THE PERMISSION OF ORDNANCE SURVEY ON BEHALF OF THE CONTROLLER OF HER MAJESTY'S STATIONERY OFFICE © CROWN COPYRIGHT. UNAUTHORISED REPRODUCTION INFRINGES CROWN COPYRIGHT AND MAY LEAD TO PROSECUTION OR CIVIL PROCEEDINGS. AL 100030649 2021

P2	SCHEME SCOPE REDUCTION	GR	MRO	29/06/2021
P1	FIRST ISSUE	SC	SR	28/01/2021
REV	DETAILS	CHKD	APPD	DATE
DRAWING NUMBER				SCHEME REFERENCE No.
PROJECT   ORIGINATOR   VOLUME				570131
HE570131 - KIER - HRR				REVISION
M5_207.5_217.5 - DE - CH - 0000-05				P2
LOCATION	TYPE	ROLE	NUMBER	



SCHEME NAME  
570131D VRS GATEWAY 1A STUDY 2020-2021  
SCHEME 607 M5 J25 TO J26 MP 207.5-217.5  
DRAWING TITLE  
STATUTORY UNDERTAKERS  
(SHEET 5 OF 11)

DRAWN : SB	SCALE : 1:500	DRAWING STATUS
DESIGN : SB	DIMENSIONS : m	WORK IN PROGRESS
CHKD : SC	ORIG DWG SIZE: A1	PRELIMINARY DRAWING ✓
APPD : SR	COPYRIGHT © KIER	EXTERNAL ISSUE
DATE : 28/01/21		AS-BUILT
SUITABILITY: S2	FOR INFORMATION	