

SECTION A

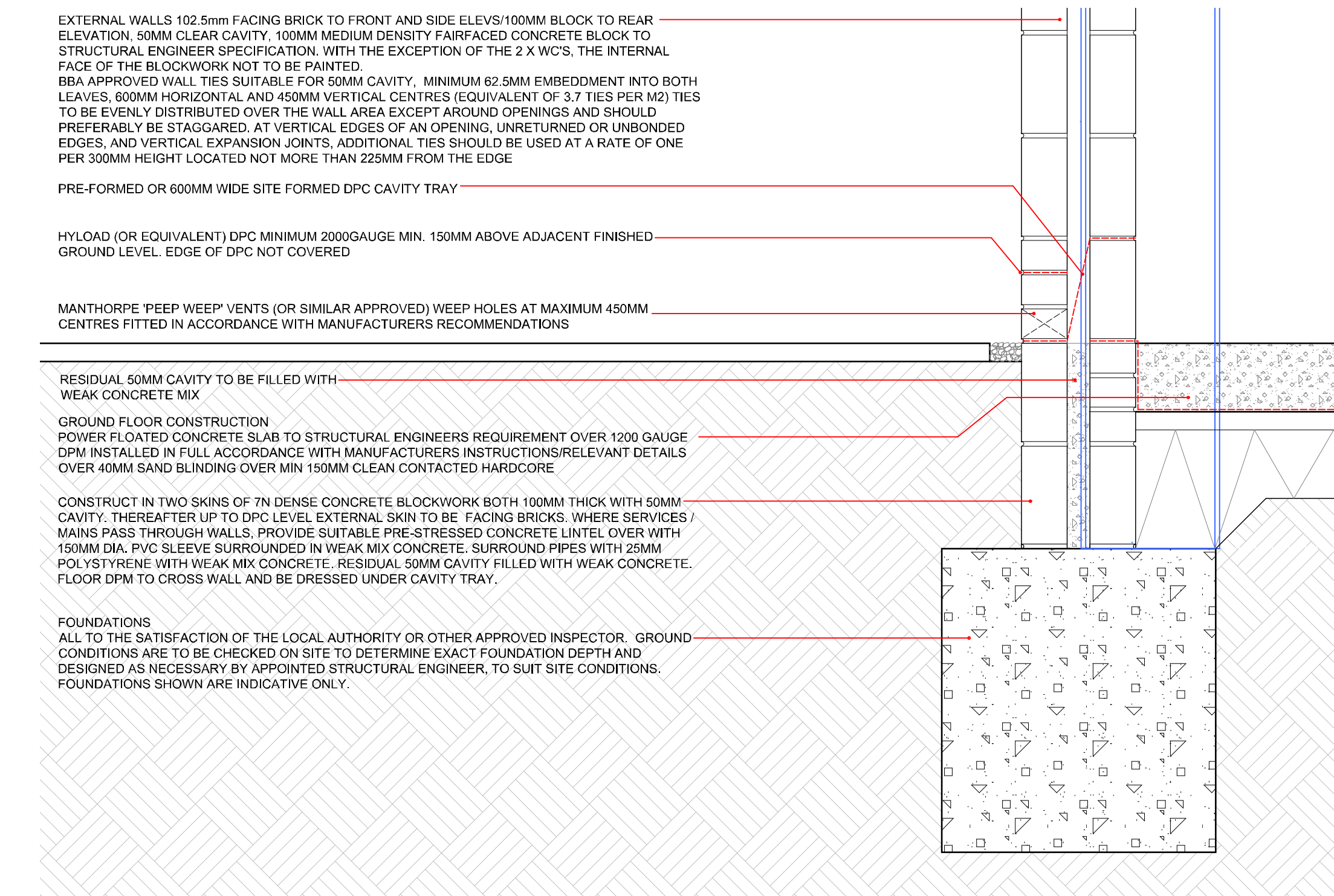

DETAIL 1

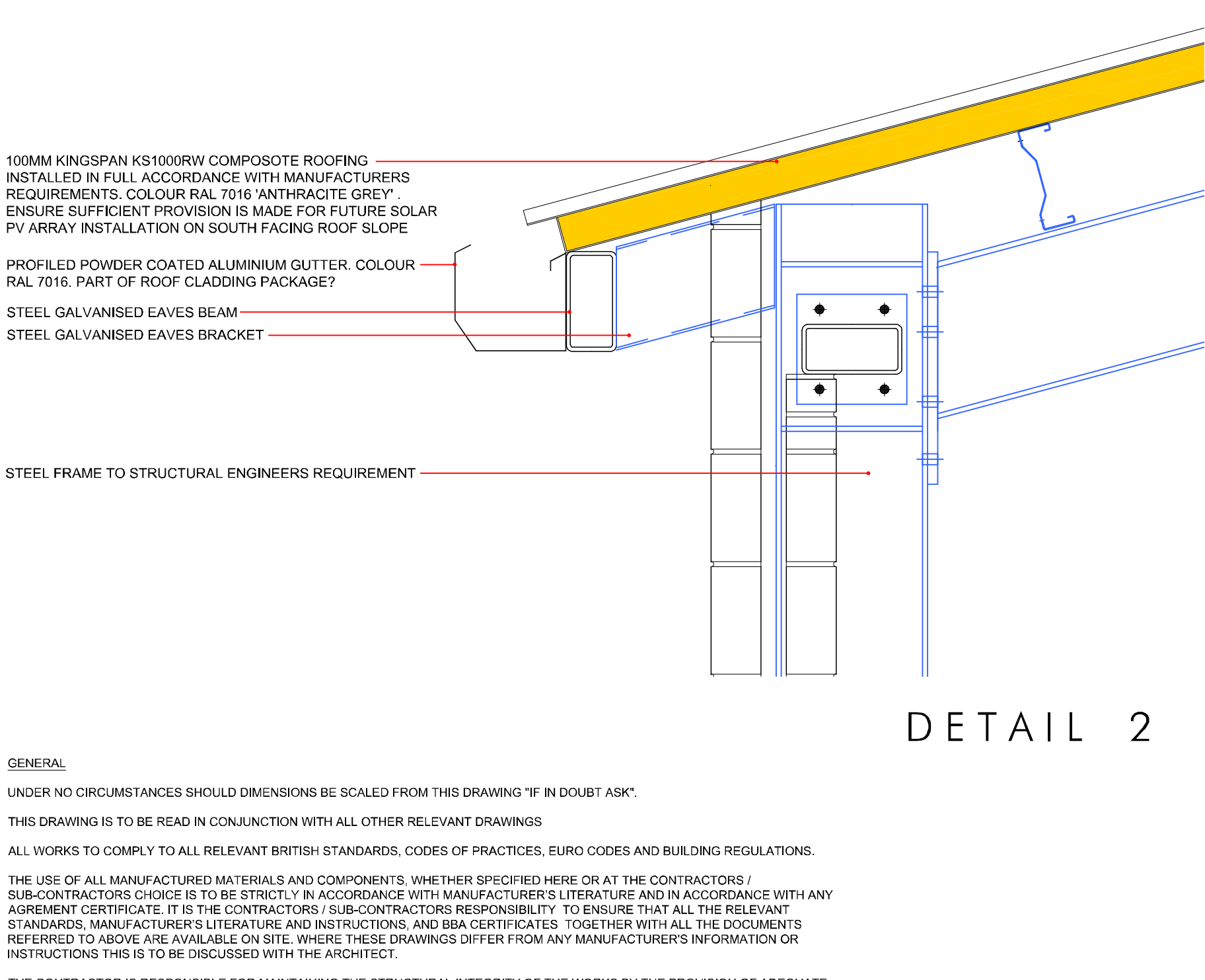

DETAIL 2

GENERAL

UNDER NO CIRCUMSTANCES SHOULD DIMENSIONS BE SCALED FROM THIS DRAWING "IF IN DOUBT ASK".

THIS DRAWING IS TO BE READ IN CONJUNCTION WITH ALL OTHER RELEVANT DRAWINGS

ALL WORKS TO COMPLY TO ALL RELEVANT BRITISH STANDARDS, CODES OF PRACTICES, EURO CODES AND BUILDING REGULATIONS.

THE USE OF ALL MANUFACTURED MATERIALS AND COMPONENTS, WHETHER SPECIFIED HERE OR AT THE CONTRACTORS / SUB-CONTRACTORS CHOICE IS TO BE STRICTLY IN ACCORDANCE WITH MANUFACTURER'S LITERATURE AND IN ACCORDANCE WITH ANY AGREEMENT CERTIFICATE. IT IS THE CONTRACTORS / SUB-CONTRACTORS RESPONSIBILITY TO ENSURE THAT ALL THE RELEVANT STANDARDS, MANUFACTURER'S LITERATURE AND INSTRUCTIONS, AND BBA CERTIFICATES, TOGETHER WITH ALL THE DOCUMENTS REFERRED TO ABOVE ARE AVAILABLE ON SITE, WHERE THESE DRAWINGS DIFFER FROM ANY MANUFACTURER'S INFORMATION OR INSTRUCTIONS THIS IS TO BE DISCUSSED WITH THE ARCHITECT.

THE CONTRACTOR IS RESPONSIBLE FOR MAINTAINING THE STRUCTURAL INTEGRITY OF THE WORKS BY THE PROVISION OF ADEQUATE TEMPORARY WORKS.

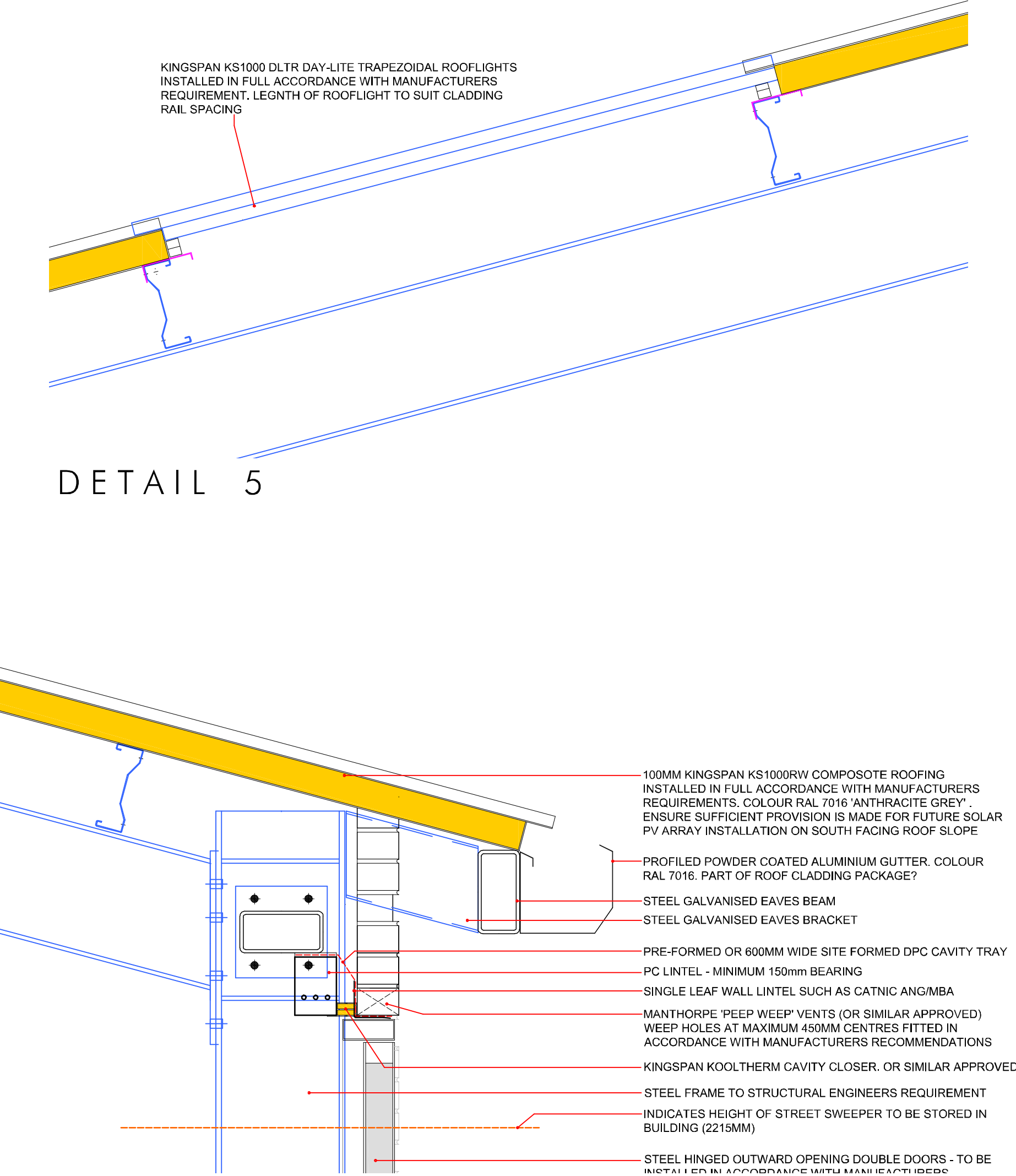

DETAIL 3

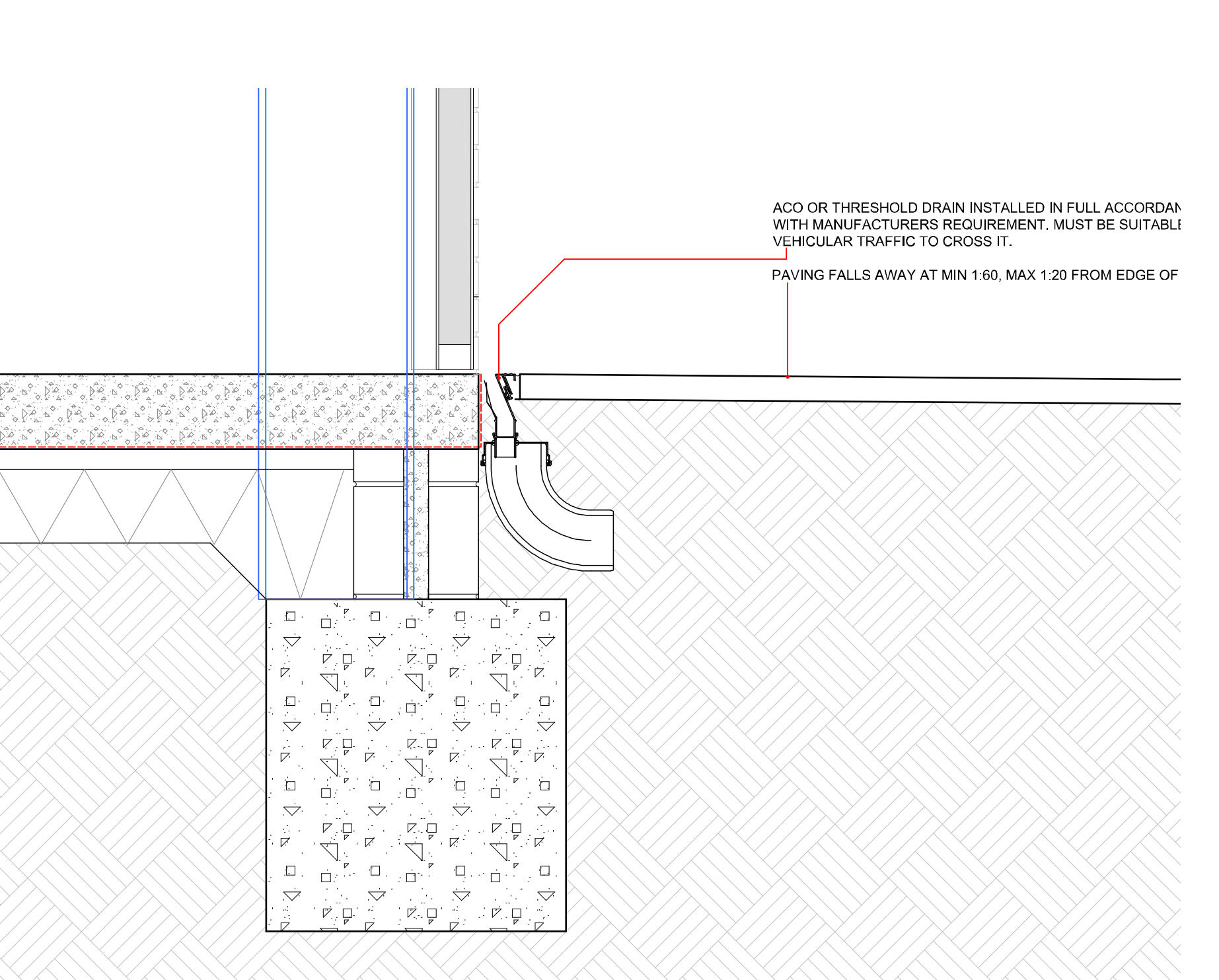

DETAIL 4

Trowbridge Town Council

Town park storage building

mc

30-07-2019

1:50 @A1

Sections 1

W3-1804-TENDER.dwg

TENDER ISSUE DRAWING

PKA

ARCHITECTS

PKA Architects Ltd
Featherbrook, Whitley Road, Potters, Devizes, Wiltshire. SN10 5TD
tel 01380-725688 email: perez@pka-architects.com www.pka-architects.com

RIBA CHARTERED PRACTICE

30-07-2019

RIBA

Chartered Practice

This drawing is the Copyright of PKA Architects Ltd
Registered in England and Wales No 8603583
Do not rely on scaled Dimensions. If in doubt - ASK
All dimensions to be checked on site by contractor
OS copyright licence: NI00010276

Green

REGISTER

OF CONSTRUCTION PROFESSIONALS

wh

dh

REVISIONS

X:\Projects\Current Projects\1804-TTC storage building and park\08-Tender\1804-TENDER.dwg

Monday, 4 November, 2019

PRELIMINARY DRAWING

SUBJECT TO ENGINEERS CALCULATIONS AND DETAILS
AND BUILDING REGULATION APPROVAL
DO NOT USE ON SITE