

Construction notes

Foundations:

Under external walls - Concrete foundations to be 600mm x 225mm C30 concrete strip to BS 5328 1997. (see dotted lines on plan) All at a depth to local authority approval upon site inspection but a minimum 600mm to 50mm below finished ground level or alternatively they shall be taken down below the invert of any adjacent drains within 1.0m of the excavations. Assured ground condition - shilleted.

Radon protection:

Radon sump to be constructed as shown (see detail section B-B). Three courses of brickwork with vertical honey comb mortar, capped with a 600mm x 600mm paving slab. 110mm dia. vent pipe to exit the Radon sump to the rear of property (as indicated on the plan) and open pipe-work to be capped. A mechanical fan may be added at a later date if necessary. Radon sump outlet to be labeled 'Radon Sump Outlet'

Rain water goods:

100mm uPVC guttering into 65mm down pipes (to roddable gullies) to 100mm PVC pipes and fitting into existing system. Soak-aways to be 5M from any buildings or roads.

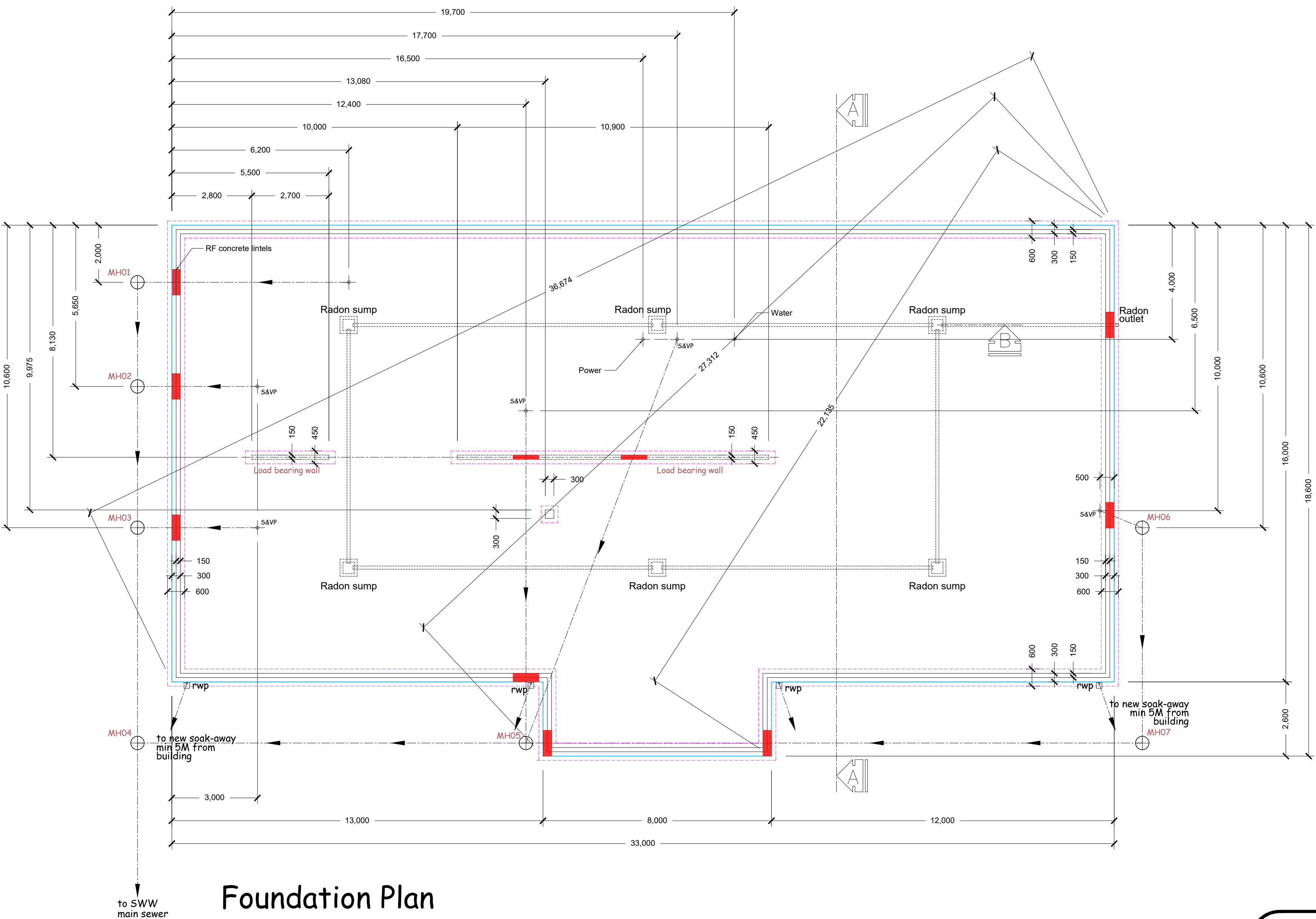

Foundation Plan

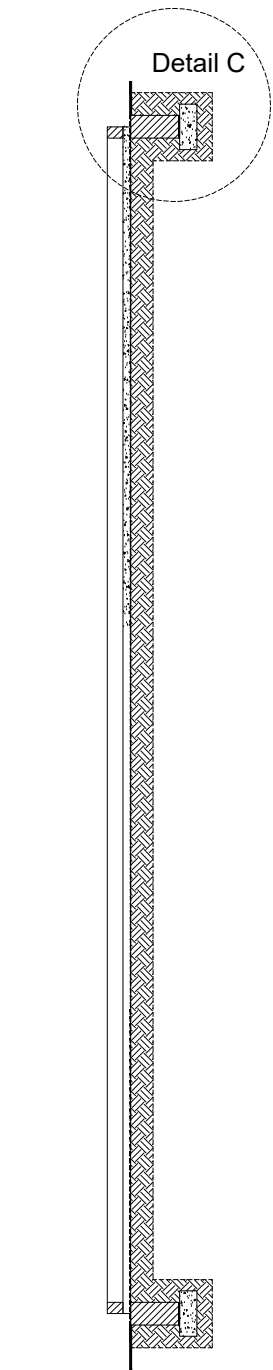

Section A-A

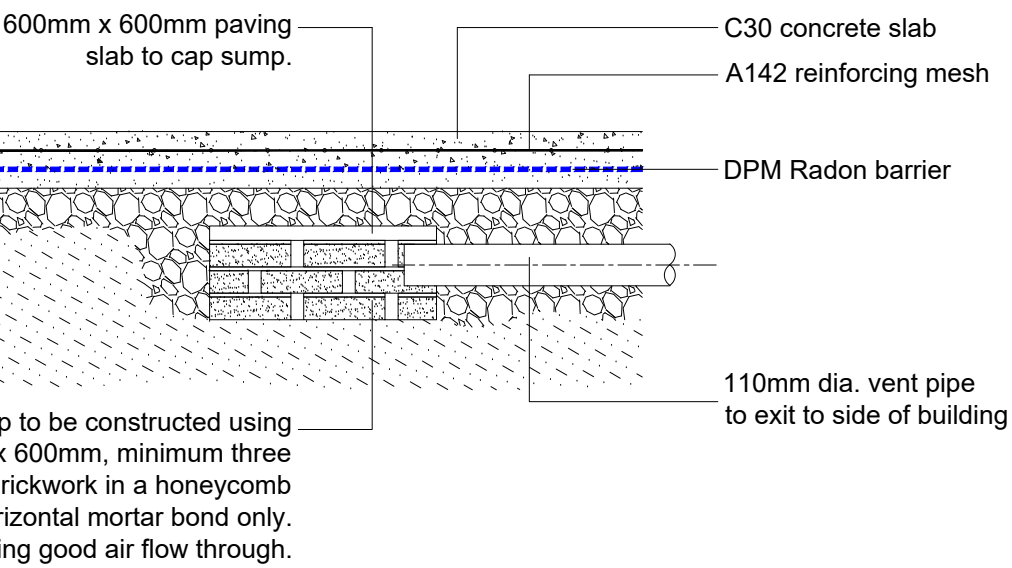

Detail B (scale 1:20)

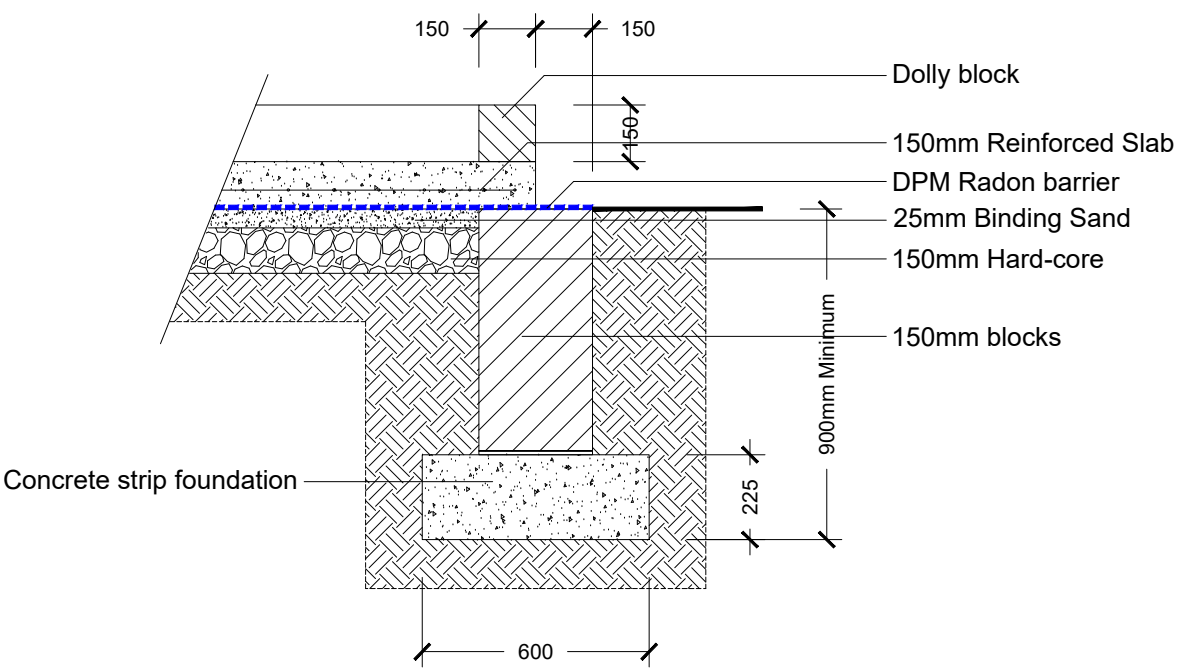

Detail C (scale 1:20)

Preliminary drawing
awaiting Building
Control final approval

SITE TITLE:

ST MINVER COMMUNITY HUB
TREWINT PLAYING FIELDS,
TREWINT LANE,
ST MINVER
PL27 6LT

THIS DRAWING IS FOR THE PURPOSES OF TOWN PLANNING AND BUILDING
REGULATIONS APPLICATION ONLY. DIMENSIONS ARE NOT TO BE SCALED FROM
THIS DRAWING.

DRAWING TITLE:

BUILDING REGULATIONS - SHEET 2

CLIENT NAME:

ST MINVER COMMUNITY HUB

DRAWN

J MURCH

DATE

18.09.2023

SCALE

1:100

SHEET SIZE A1

dpc

Architectural Services
Building solutions in Cornwall

2 Wassail Close, Bodmin, Cornwall PL31 2GG Tel:- 07759 397 499

DRAWING NO

2005 - 12

REVISION NO

- B