

NOT FOR CONSTRUCTION  
TARGET PRICE ONLY

- Notes:
- All Traffic Management will be set out in accordance with the requirements of the Traffic Signs Manual Chapter 8 2020.
  - On carriageways of 50mph and above all initial tapers and stepped tapers will be highlighted at all times with Backlit sequentially flashing lights. On carriageways below 50mph Backlit sequentially flashing lights may be omitted subject to risk assessment.
  - Any sign reference Numbers used in this drawing refer to either the diagram numbers contained within the Traffic Signs Regulations and General Directions 2016 (TSRGD 2016); or when used as a sign authorised under Schedule 13 part 9 of these regulations, a diagram from Schedule 12 of the 2002 Regulations (TSRGD 2002).
  - All Diversion signing will be fully installed before any closure is brought into effect.
  - All sign frames will be secured with sand bags.
  - Exact locations of signs are to be determined on site and will be positioned as to not obstruct any other sign, footpath or visibility.
  - Sign Diagram 7001-3. Will be installed prior to the installation and removal of roadworks.
  - The Inner Boundary of the safety zone is omitted for Clarity but is to be marked with barrier in accordance with TSM Chapter 8 at the appropriate distance for the speed of carriageway.
  - Overhead cables/structures to be protected to GS6 within works. Overhead cables/structures marked on this drawing should be supplemented by an on-site check to ensure all hazards are identified.

- Key:
- Traffic sign
  - TSRGD Sign Reference Number
  - Cone or Road Marking Detail
  - Traffic Cone Line
  - Pedestrian Barrier
  - To Be Arranged

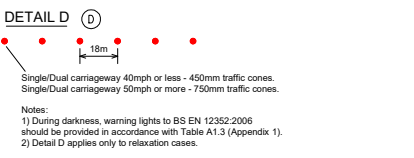

Overhead Electric Cables - To be protected to GS6 within works area.

H&S Toolkit 0371 (Residual Risk Cone Key)		
Hazard	Cone Colour	Notes
Works Access	Green with White or magenta Sleeves	Cones to be placed at each side of works access point inside of traffic delineation cone line.
Overhead Cables	Blue with yellow HV hazard sleeve	Cones spaced at 3 metre centres inside of traffic delineation cone line, marking extent of risk zone.
Overhead Structure	Blue with white sleeve	Cones spaced at 3 metre centres inside of traffic delineation cone line, for extent of overhead hazard.
No Stopping	Yellow with white sleeve	Cones spaced at 9 metre centres inside of traffic delineation cone line, for extent of no stopping zone.

Project  
**A21 Powdermill Lane  
210375**

Drawing  
**Lane 1 Northbound  
Closure**

Drawing No.  
**HE606471-AONE-TTM-A21 PWDRMILL-SK-CH-0106**

Drawing Scale: NTS Plot Scale:  
**Do Not Scale From This Drawing** Sheet size A3

© Crown copyright and database rights 2013  
Ordnance Survey 100030649

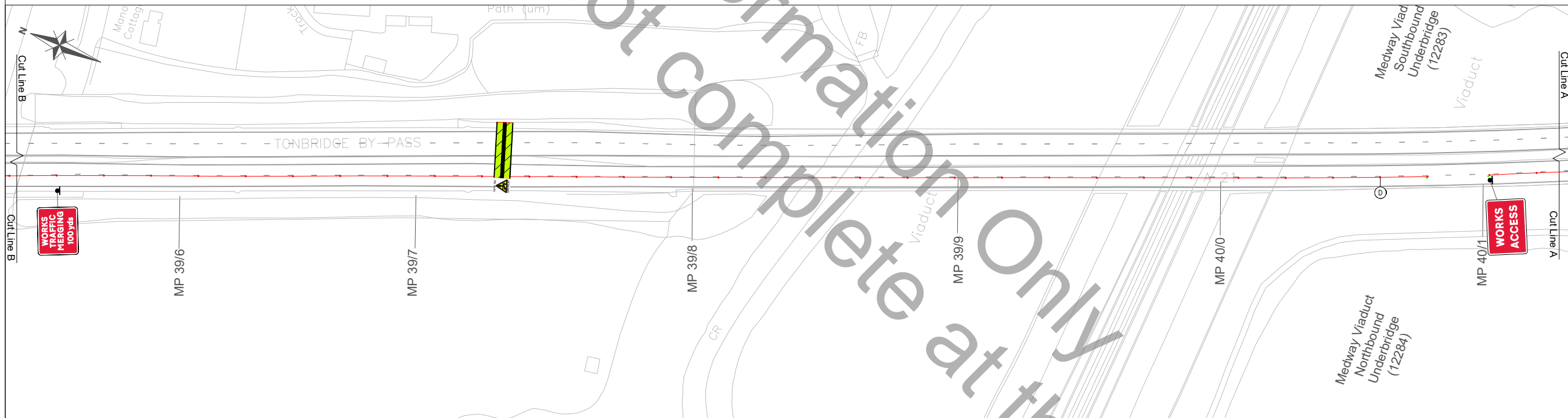
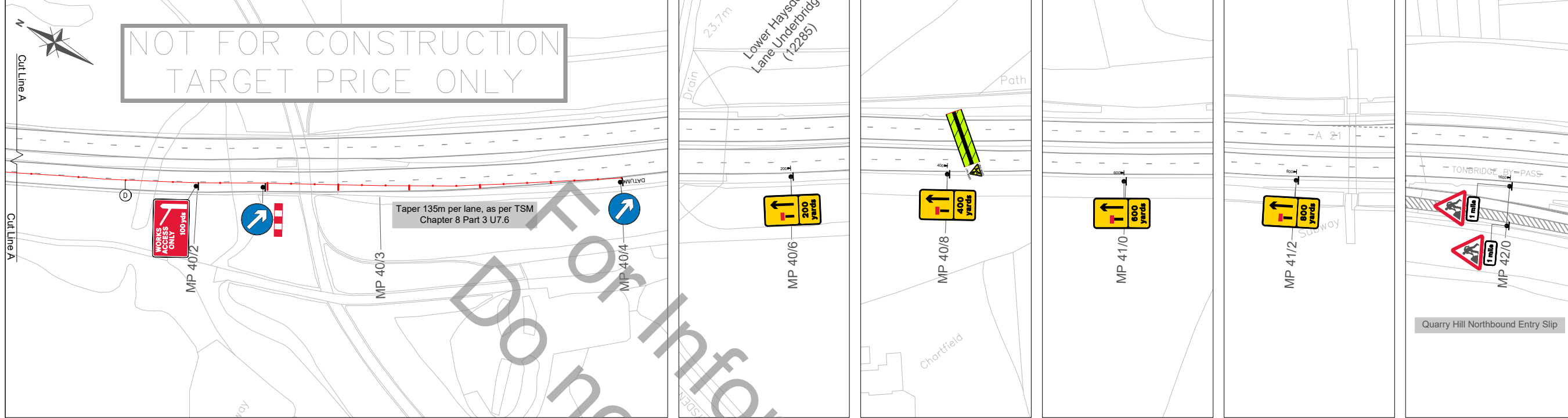

Qty: 1 Ref: 7202.1 Temporary lane availability		Qty: 2 Ref: 572 Distance over which hazard or prohibition extends	
Qty: 1 Ref: 7202.1 Temporary lane availability		Qty: 2 Ref: 610 Keep right	
Qty: 1 Ref: 7202.1 Temporary lane availability		Qty: 1 Ref: 645 End panel	
Qty: 1 Ref: 7301 Works access		Qty: 3 Ref: 7001 Road works ahead	
Qty: 1 Ref: 7302 Works exit		Qty: 1 Ref: 7105 Lane closure barrier	
Qty: 1 Ref: 7306 Route for works traffic ahead access only direction left		Qty: 1 Ref: 7202.1 Temporary lane availability	
Qty: 1 Ref: 7307 Warning of works traffic merging ahead			

