

NOTES

All dimensions must be checked on site and only scaled from this drawing for planning purposes only

REV D

THIS DRAWING IS TO BE READ IN CONJUNCTION WITH THE STRUCTURAL CALCULATIONS PROVIDED BY BAYLISS CONSULTING REFERENCE '6000 - JUNE 2023' & THE ASSOCIATED MARK-UP DRAWINGS & WITH THE CCTV DRAIN INSPECTION REPORT PROVIDED BY AQUALET REFERENCE '01/06/23 - EG' & WITH THE FULL SPECIFICATION NOTE - STRUCTURAL DETAILS PROVIDED BY BAYLISS CONSULTING SUPERSEDES THOSE OF MAKING PLANS ARCHITECTURE

ACCORDING TO THE THE CCTV DRAIN INSPECTION REPORT PROVIDED BY AQUALET REFERENCE '01/06/23 - EG' SOME PARTS OF THE DRAINS NEED TO BE REPLACED AS A MATTER OF URGENCY

D	JUN 2023	AMENDED FOR BUILDING CONTROL
C	MAY 2022	AMENDED SCHEME
B	OCT 2021	AMENDED SCHEME
A	APR 2021	CAR PARKING ADDED
Date		Revisions

© copyright

Client

WILLINGTON PARISH COUNCIL

Location

SPORTS PAVILION  
TWYFORD ROAD  
WILLINGTON  
DERBYSHIRE  
DE65 6BN

Proposal

PROPOSED EXTENSION / ALTERATIONS  
FOR FUNCTION ROOM, TOILETS,  
CHANGING ROOMS, GOAL POSTS  
& GAS BOTTLES STORAGE &  
KITCHEN TO SPORTS PAVILION

Drawing Title

EXISTING & PROPOSED  
BLOCK PLANS

Scale

1:200

Date	OCT 2020	Drawn by	MRP
------	----------	----------	-----

Org No.	J3133-02	Revision	D
---------	----------	----------	---



MAKING PLANS  
architecture

Ivy Lodge, Twyford Road, Willington, Derby, DE65 6DE  
T/F 01283 703160 E info@makingplans-architecture.co.uk  
W www.makingplans-architecture.co.uk

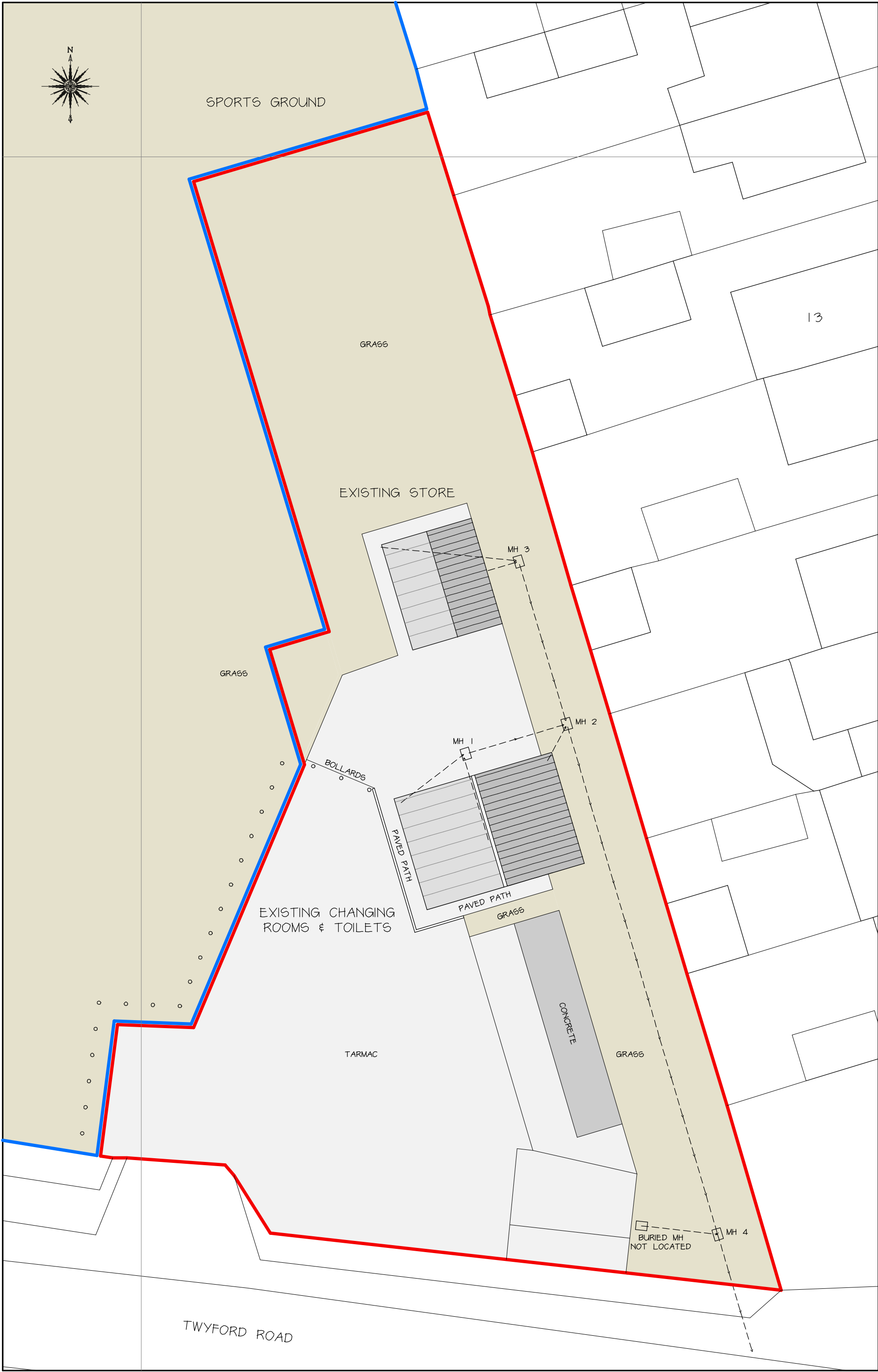

EXISTING BLOCK PLAN  
1:200

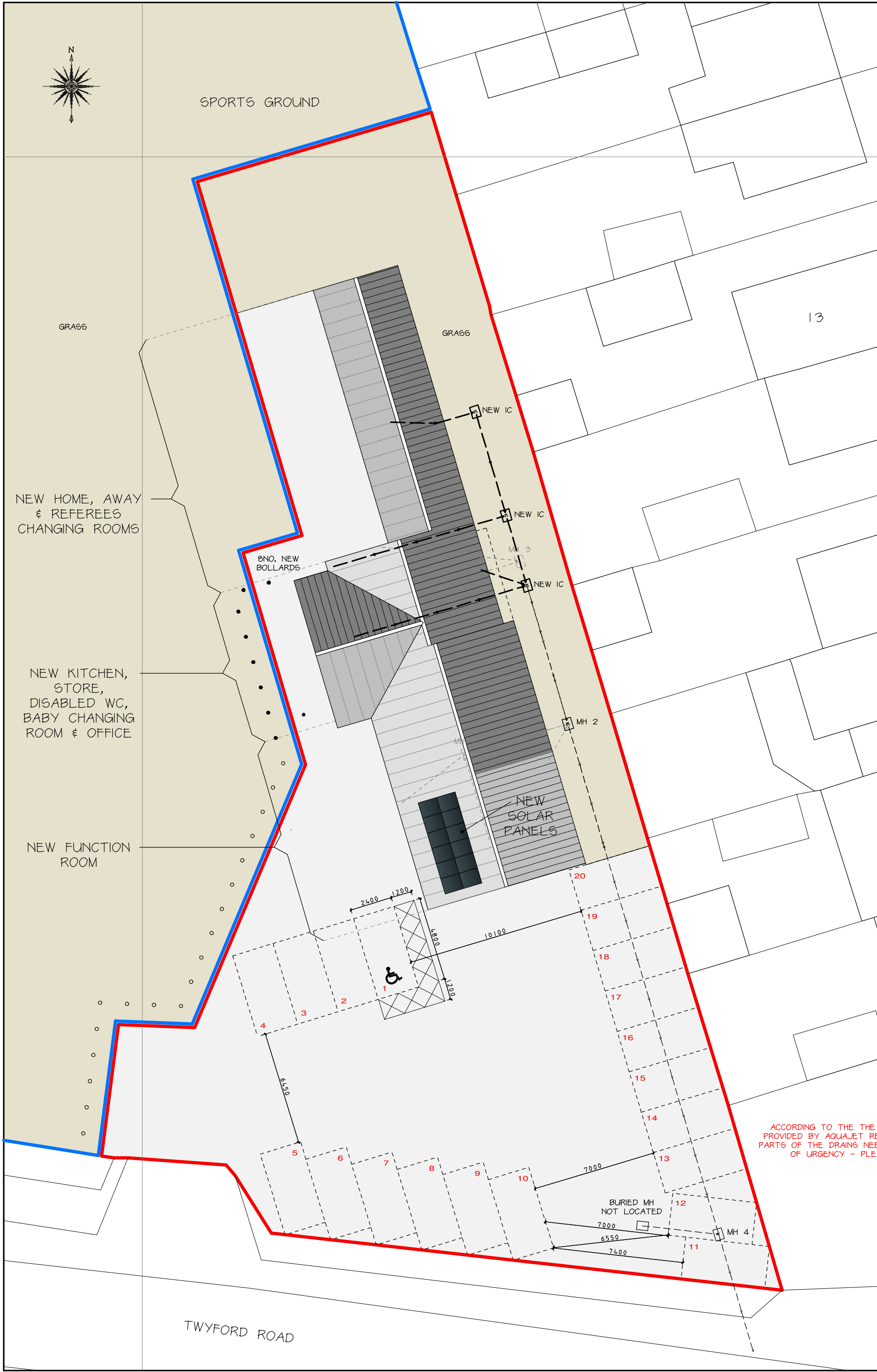

PROPOSED BLOCK PLAN  
1:200

