

Single External Door

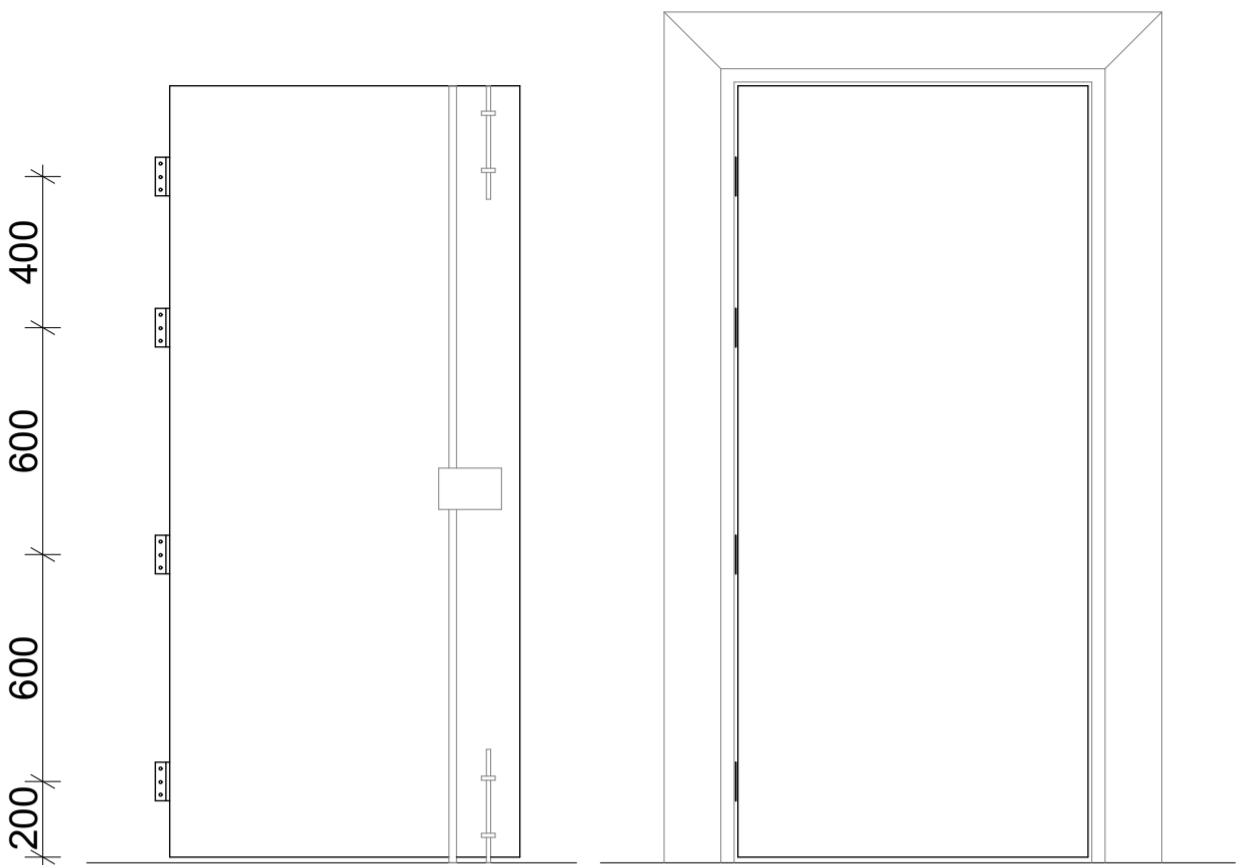

DOOR ELEVATIONS

GENERAL

All doors to be fully site measured prior to installation.

Installation for each door must happen in the same day.
At no time whilst the works are being undertaken will the contractor move away from site and leave the doors unmonitored.

The contractor to take internal and external photos of the doors and surrounds prior to the start of the works.

The contractor to allow for full mastic sealing around all frames prior to the installation of the architraves.

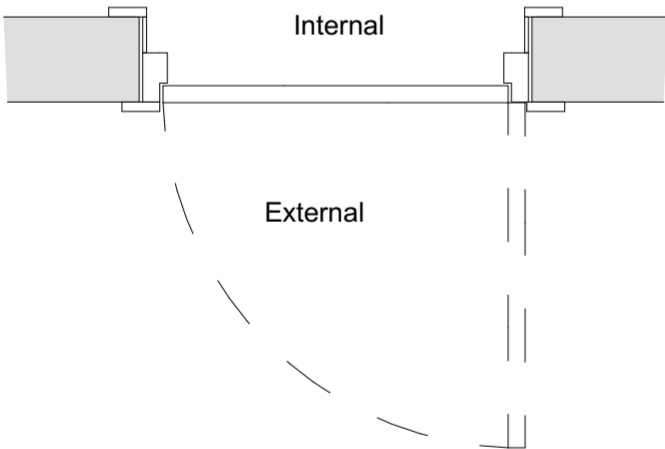

DOOR DETAILS

Size = 926 x 2040 mm (exact sizes to be site measured)

Door to be solid core - Veneer faced with a solid not part solid core, minimum 30 minute fire resistance capability.

Door to have a weather bar externally and low level cill detail to prevent trip hazzard.

The external face of the door is to have a full width and height 3mm thick galvanised steel panel screw fixed at maximum 200mm centres to all edges. countersunk screws. The entire door is to be suitably primed and painted 2 coats gloss, colour to be confirmed.

FRAME DETAILS

Hardwood framed with formed stops, not planted stops. frames to be suitable for the doors being installed and be finished to match the doors.

Frames to be suitably anchored into the side masonry at minimum 4 points each side.

IRONMONGERY DETAILS

All ironmongery to comply with relevant British and european standards.

4 Number butt hinges minimum 200mm long.

2 number 300mm long bolts per leaf top and bottom into suitable sockets.

Push plate with panic bars to the leading door. latch to be Fire rated for timber and steel doors. Silver finish RAL 9022. Tested to EN1125 : 2008 - 37681322AA. CE Marked 1121 AAA019 09. Certifire CF 389. Push latch to have external key override facility.

FRAME AND ARCHITRAVE DETAILS

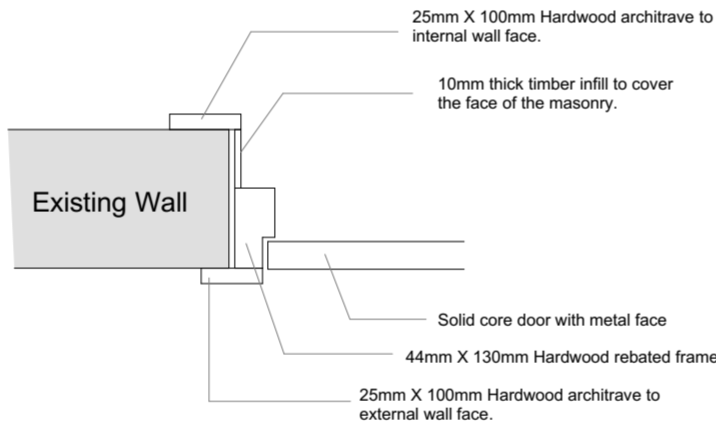

Double External Door

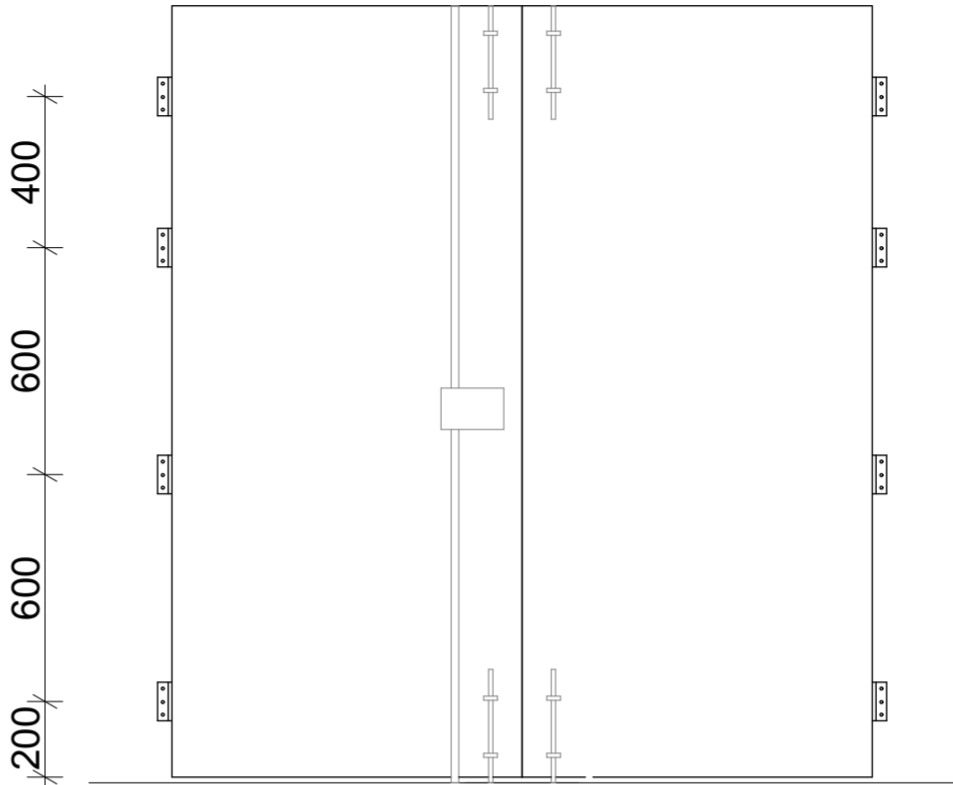

DOOR ELEVATIONS

GENERAL

All doors to be fully site measured prior to installation.

Installation for each door must happen in the same day.
At no time whilst the works are being undertaken will the contractor move away from site and leave the doors unmonitored.

The contractor to take internal and external photos of the doors and surrounds prior to the start of the works.

The contractor to allow for full mastic sealing around all frames prior to the installation of the architraves.

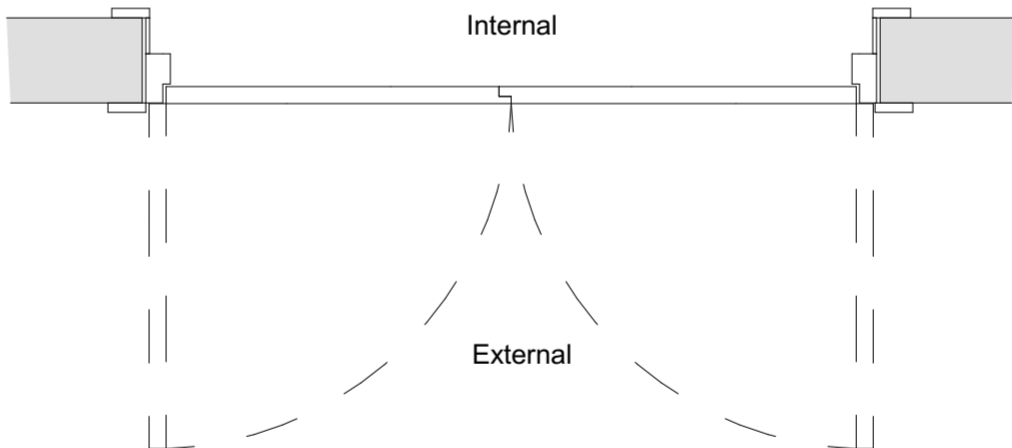

DOOR DETAILS

Size = 1826 x 2040 mm (exact sizes to be site measured)

Door to have rebated style.
Door to be solid core - Veneer faced with a solid not part solid core, minimum 30 minute fire resistance capability.

Door to have a weather bar externally and low level cill detail to prevent trip hazzard.

The external face of the door is to have a full width and height 3mm thick galvanised steel panel screw fixed at maximum 200mm centres to all edges. countersunk screws. The entire door is to be suitably primed and painted 2 coats gloss, colour to be confirmed.

FRAME DETAILS

Hardwood framed with formed stops, not planted stops. frames to be suitable for the doors being installed and be finished to match the doors.

Frames to be suitably anchored into the side masonry at minimum 4 points each side. Including top.

IRONMONGERY DETAILS

All ironmongery to comply with relevant British and european standards.

8 Number butt hinges minimum 200mm long.

4 number 300mm long bolts per leaf top and bottom into suitable sockets.

Push plate with panic bars to the leading door. latch to be Fire rated for timber and steel doors. Silver finish RAL 9022. Tested to EN1125 : 2008 - 37681322AA. CE Marked 1121 AAA019 09. Certifire CF 389. Push latch to have external key override facility.

FRAME AND ARCHITRAVE DETAILS

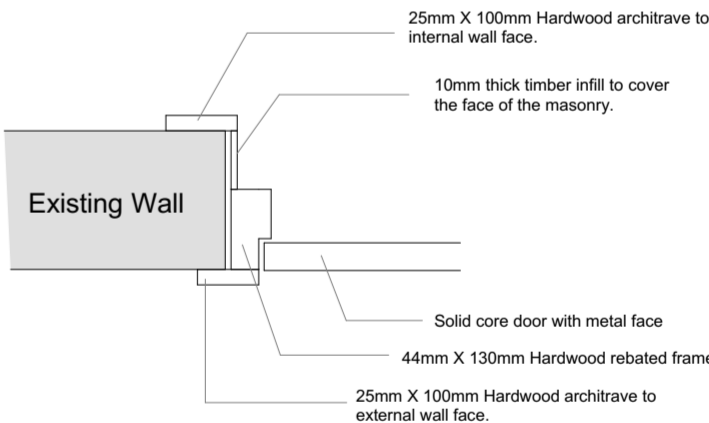

Notes:-

Contractor to allow for the full removal of the existing door and frame.
Allow for removal from site to a suitable tip.
Allow for the provision of 3 number keys per door, 2 for the tenant 1 for the client.
Contractor to allow for the full making good of the door opening surround prior to works being undertaken. Photographs must be passed over to the project manager of all stages.

<div>BERESFORD HOUSE 1 NEWTOWN STREET LEICESTER LE1 6WH TEL: 0116 254 7868 FAX: 0116 255 7293 EMAIL: enquiries@gwh.co.uk www.gwh.co.uk</div> <div>Gordon White & Hood Ltd Registered In England No.4088022</div>	Project CORBY FIRE DOOR PROJECT	
	Client CORBY BOROUGH COUNCIL	
	Drawing Title DOOR DETAILS	
<div>Revisions.</div> <div><div>APPROVAL</div><div>PRELIMINARY</div><div>INFORMATION</div><div>FOR CONSTRUCTION</div></div>	Drawing By PJT	Checked By
	Date July 2019	Scale 1:100 @ A2
	Drawing Number #Pln / 01	Revision