

Lighting to changing rooms and WCs: Ceiling mounted, IP65 rated, 2700K LED. PIR activated. Minimum 150 Lux.

Lighting to communal space: Ceiling mounted, IP44 rated, 2700K LED, switch activated. Minimum 150 Lux.

For layout of luminaires see Reflected Ceiling Plan.

All cabling routed within galvanised steel conduit, surface mounted on blockwork walls.

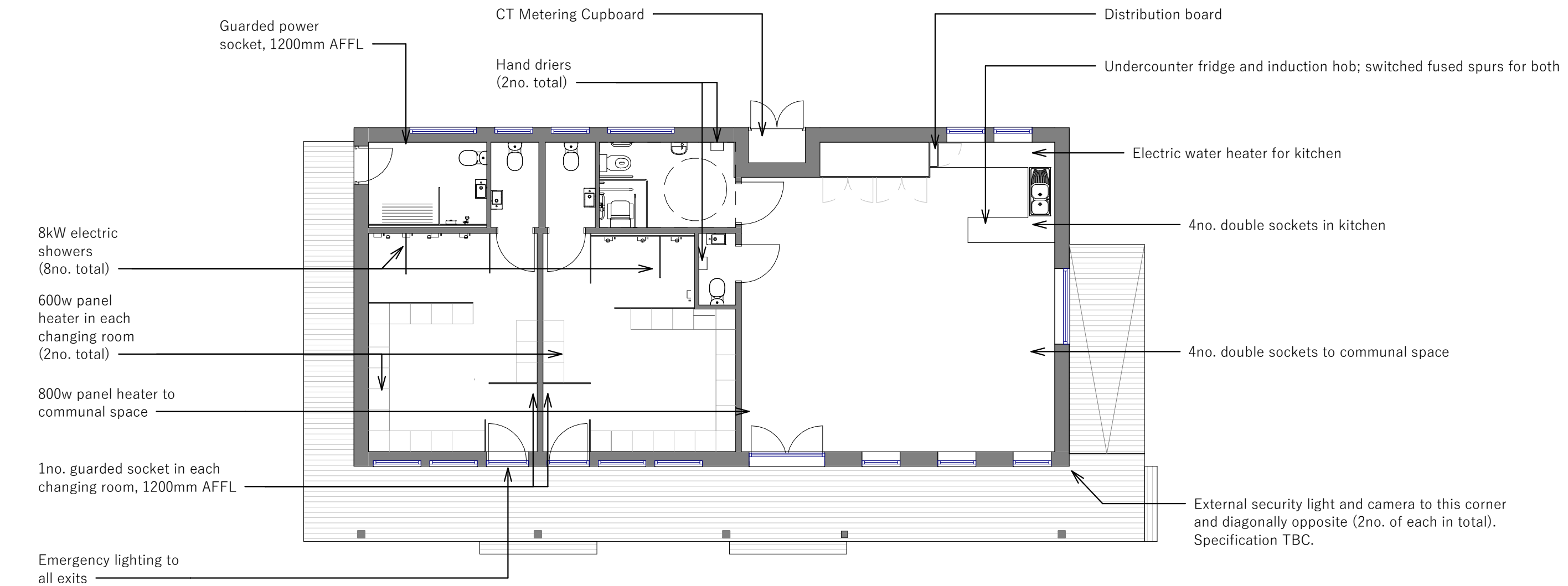

- Notes:
- Do not scale from this drawing
  - Do not reproduce any part of this drawing without prior written consent.

Information here is intended as a performance requirement only. The Contractor is responsible for the final specification of all mechanical and electrical items.