

LOCATION OF PROPOSED SKEELINGS

- NOTES:
- 1. DO NOT SCALE
 - 2. DRAWINGS TO BE READ IN CONJUNCTION WITH ALL SERVICES AND STRUCTURAL ENGINEERS DRAWINGS & SPECIFICATIONS.
 - 3. © COPYRIGHT. DRAWINGS NOT TO BE REPRODUCED OR USED WITHOUT PRIOR WRITTEN CONSENT.

REF	DATE	REVISION	DRAWN	CHECKED
SCALE	DATE	DRAWN BY	CHECKED BY	
1:50@A3	10/2022	HW	ES	
DRAWING				

Osney Lock

Ground Floor Plan - Skeelings Plan

PROJECT
Refurbishment

CLIENT
Environment Agency

RIDGE

BEAUMONT HOUSE
59 HIGH STREET
THEALE
READING, RG7 5AL
TEL: 0118 932 3088
FAX: 01993 815002
www.ridge.co.uk
Also at Oxford, Bristol, London and Leicester

DRG NO	REV
5014850 / 033_A002	

FILE REFERENCE:

XREF FILE REFERENCE:

- NOTES:
- 1. DO NOT SCALE
 - 2. DRAWINGS TO BE READ IN CONJUNCTION WITH ALL SERVICES AND STRUCTURAL ENGINEERS DRAWINGS & SPECIFICATIONS.
 - 3. © COPYRIGHT. DRAWINGS NOT TO BE REPRODUCED OR USED WITHOUT PRIOR WRITTEN CONSENT.

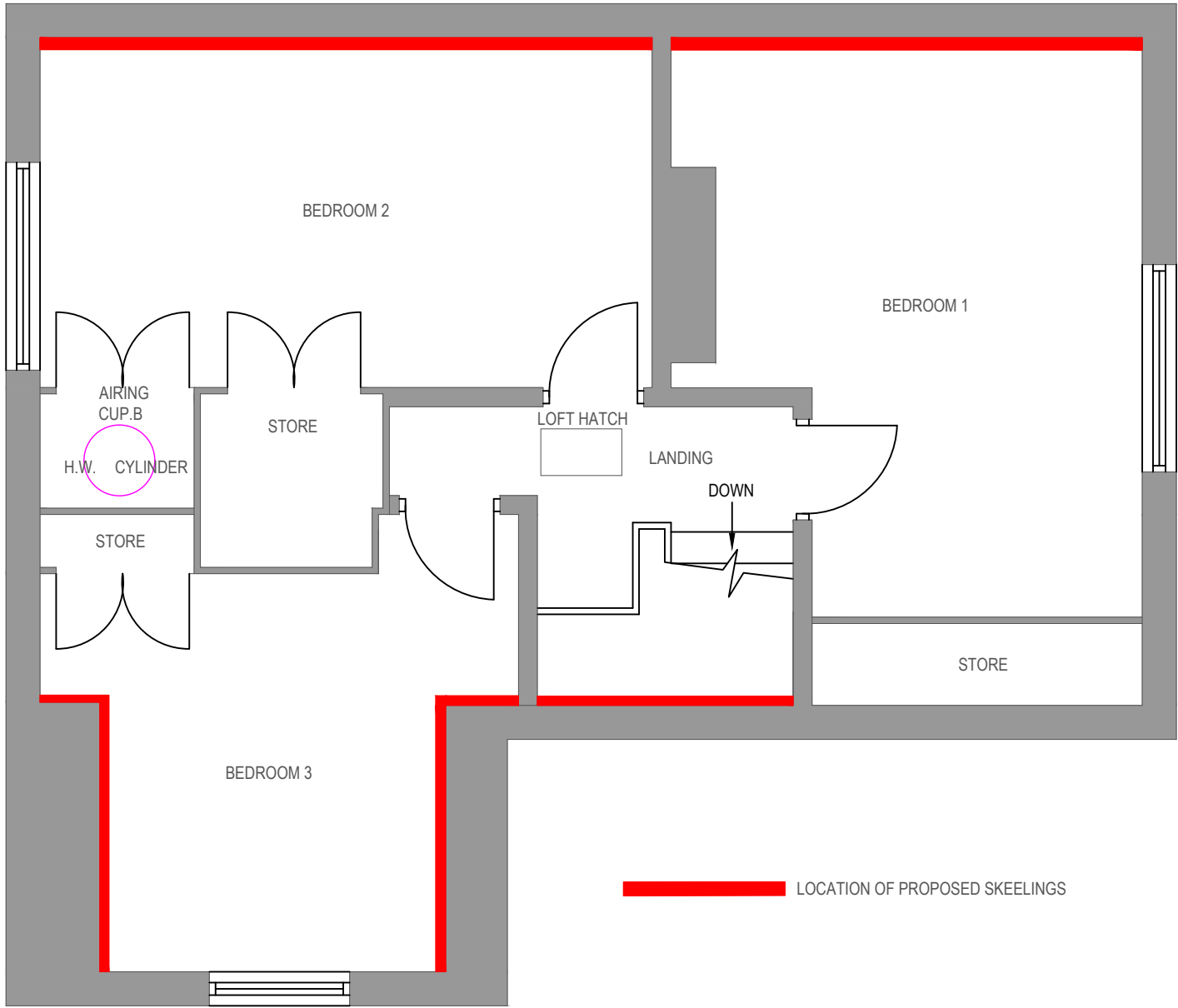

REF	DATE	REVISION	DRAWN	CHECKED
SCALE	DATE	DRAWN BY	CHECKED BY	
1:50@A3	10/2022	HW	ES	

DRAWING
Osney Lock

First Floor Plan - Skeelings Plan

PROJECT
Refurbishment

CLIENT
Environment Agency

RIDGE
BEAUMONT HOUSE TEL: 0118 932 3088
59 HIGH STREET FAX: 01993 815002
THEALE
READING, RG7 5AL www.ridge.co.uk
Also at Oxford, Bristol, London and Leicester

DRG NO	REV
5014850 / 033_A003	

FILE REFERENCE:

XREF FILE REFERENCE: