

5 BLOTTS BARN, BROOKS ROAD, RAUNDS, NORTHANTS, NN9 6NS  
01933 551389 :: [info@blueprintdesign.org.uk](mailto:info@blueprintdesign.org.uk)

TITLE	Alterations to Peace Memorial Park Huntingdon Road, Thrapston, NN14 4NF		
DETAIL	Existing Site Plan / Topographical Survey		
SCALE	1:200	SHEET:	A1
DRAWN	RW	CHECKED	KLG
DATE	November 2019	ISSUE	PRELIMINARY
CONTRACTORS MUST CHECK ALL DIMENSIONS ON SITE. ONLY REQUIRED DIMENSIONS ARE TO BE WORKED FROM DISCREPANCIES MUST BE REPORTED TO LANDROD BEFORE PROCEEDING WITH ANY DRAWING OR CONSTRUCTION			

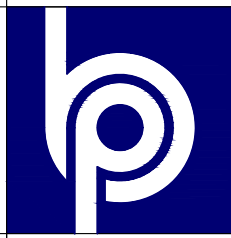



Proposed Site Plan  
Scale 1:200



Existing brick wall to be rendered in buff colour to match adjacent natural stone wall. To be finished with Parex Bio-Graffiti Protection coating (or similar). Existing stepped tarmac entrance path to be re-graded to continuous slope so that steps are removed. Hand rail to entrance path to be prepared and painted black. (Total length of hand rail is 8.2m).

New raised planter to constructed from double skin block-work, to be rendered in buff colour to match adjacent natural stone wall. To be finished with Parex Bio-Graffiti Protection coating (or similar). Planter (approx 26m<sup>2</sup>) to filled with a well mixed combination of compost and topsoil and contain a mixture of shrubs and flowers to give all round colour and interest.

Existing hedge planting behind railings to be cut back where appropriate to reduce depth and height. New laurel hedging to be planted to fill gaps in existing hedge to create more uniformity. Railings to be prepared and painted black. (Total length of railings is 73.5m). Area of shrub bed behind existing hedge (approx 85m<sup>2</sup>) to be seeded with hard wearing grass seed to reduce depth of bed.

Existing stone wall to be reduced by 0.5m to create 1.5m wide entrance to new path. Existing concrete barrier and litter bin to also be removed and replaced by new litter bin, new dog waste bin and new metal barrier painted black.

New 1.5m wide pathway to be created, to slope at approximately 1:15 gradient up to 4m long level platform in front of Rose Garden. Adjacent ground to be excavated and built up where required to achieve the gradient and to create a level surface across the width of the path. Option costs required for pathway to be constructed from:  
-Tar & Chip  
-Resin Bound Gravel

Rose Garden with raised rose beds and water feature (see dwg no: 19-123-05 for further details). Mixture of low level shrubs to be planted to rear and sides. Mature dense/prickly evergreen hedging to be planted behind the top of the rear wall to create a natural barrier.

New 1.5m wide pathways to be created, to slope down at approximately 1:15 gradient either side of 2m long level platform. Adjacent ground to be excavated and built up where required to achieve the gradient and to create a level surface across the width of the path. Option costs required for pathway to be constructed from:  
-Tar & Chip  
-Resin Bound Gravel

Tree to be removed (already in poor condition) to accommodate new pathway.

Poppy Meeting Place with seating area and water feature (see dwg no: 19-123-04 for further details). Mixture of low level shrubs to be planted to sides. Mature dense/prickly evergreen hedging to be planted behind the top of the rear wall to create a natural barrier.

New 1.5m wide pathways to be created, to slope down at approximately 1:15 gradient either side of 2m long level platform. Adjacent ground to be excavated and built up where required to achieve the gradient and to create a level surface across the width of the path. Option costs required for pathway to be constructed from:  
-Tar & Chip  
-Resin Bound Gravel

New 1.5m wide pathway to be created, to slope down to 3m long level platform in front of Sensory Garden. N.B: Slope will have to be steeper than 1:12 gradient and so may be unsuitable for unassisted wheelchair users. Adjacent ground to be excavated and built up where required to achieve the gradient and to create a level surface across the width of the path. Option costs required for pathway to be constructed from:  
-Tar & Chip  
-Resin Bound Gravel  
Mixture of low level shrubs to be planted to sides of level platform.

Sensory Garden with seating area, raised beds and water feature (see dwg no: 19-123-03 for further details).

New 1.5m wide pathway to be created, to slope down at approximately 1:15 gradient to 3m long level platform in front of Sensory Garden. Adjacent ground to be excavated and built up where required to achieve the gradient and to create a level surface across the width of the path. Option costs required for pathway to be constructed from:  
-Tar & Chip  
-Resin Bound Gravel

Slate stepping stones to be laid between Entrance path and Sensory Garden path on suitable mortar mix.

New 1.5m wide pathways to be created, from Entrance path to Sensory Garden path, to rear of Sensory Garden & to slope up alongside western boundary path. Paths to follow existing topography  
Yew (or similar more cost effective evergreen hedging) to be planted either side of path leading from Entrance to Sensory Garden path. Option costs required for pathways to be constructed from:  
-Tar and Chip  
-Resin Bound Gravel

N.B: Total area of new paths to be created is 290m<sup>2</sup>  
Levels of paths and hard landscaped areas are shown, please see Topographical Survey for surrounding site levels.

PRELIMINARY  
ISSUE

**blueprint**  
Architectural Design Ltd.

TITLE	Alterations to Peace Memorial Park Huntingdon Road, Thrapston, NN14 4NF Proposed Site Plan		
DETAIL			
SCALE	1:200	SHEET	A1
DRAWN	RW	CHECKED	KLG
DATE	February 2020	ISSUE	PRELIMINARY
19-123-02			

5 BLOTTIS BARN, BROOKS ROAD, RAUNDS, NORTHANTS, NN9 6NS  
01933 551389 - info@blueprintdesign.org.uk



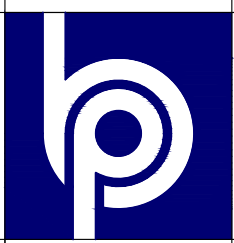

3D Visualisation  
NTS



3D Visualisation  
NTS

PRELIMINARY  
ISSUE



5 BLOTT'S BARN, BROOKS ROAD, RAUNDS, NORTHANTS, NN9 6NS  
01933 551389 :: info@blueprintdesign.org.uk

TITLE	Alterations to Peace Memorial Park Huntingdon Road, Thrapston, NN14 4NF			
DETAIL	3D Visualisations			
SCALE	NTS	SHEET:	A1	19-123-03
DRAWN	RW	CHECKED	RLG	
DATE	February 2020	ISSUE	PRELIMINARY	
CONTENTS MUST BE CHECKED ALL DIMENSIONS IN THIS DRAWING ARE TO BE WORKED FROM DISCREPANCIES MAY BE REPORTED TO BLUEPRINT BEFORE PROCEEDING TO THIS DRAWING IS COPYRIGHT				



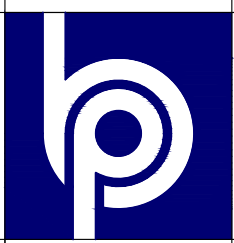

3D Visualisation  
NTS

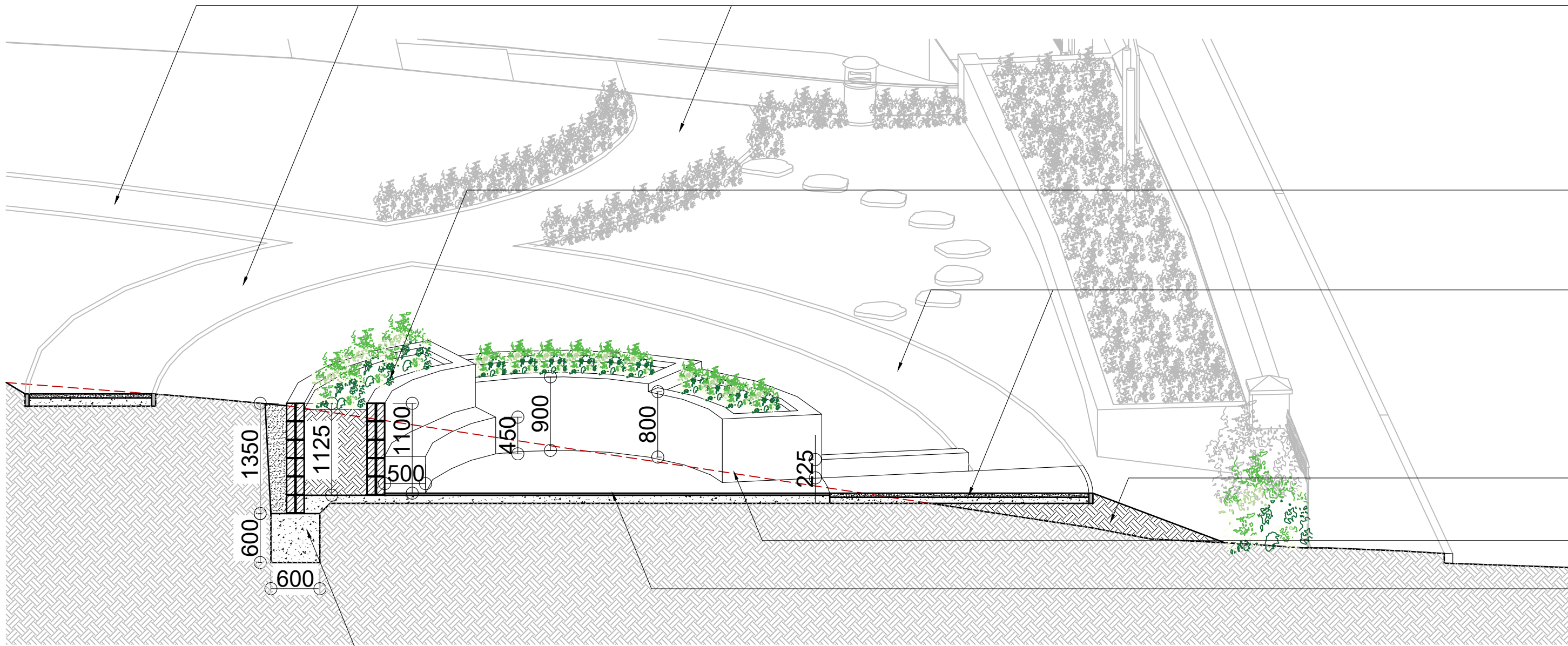

Proposed Section A-A  
Scale 1:50

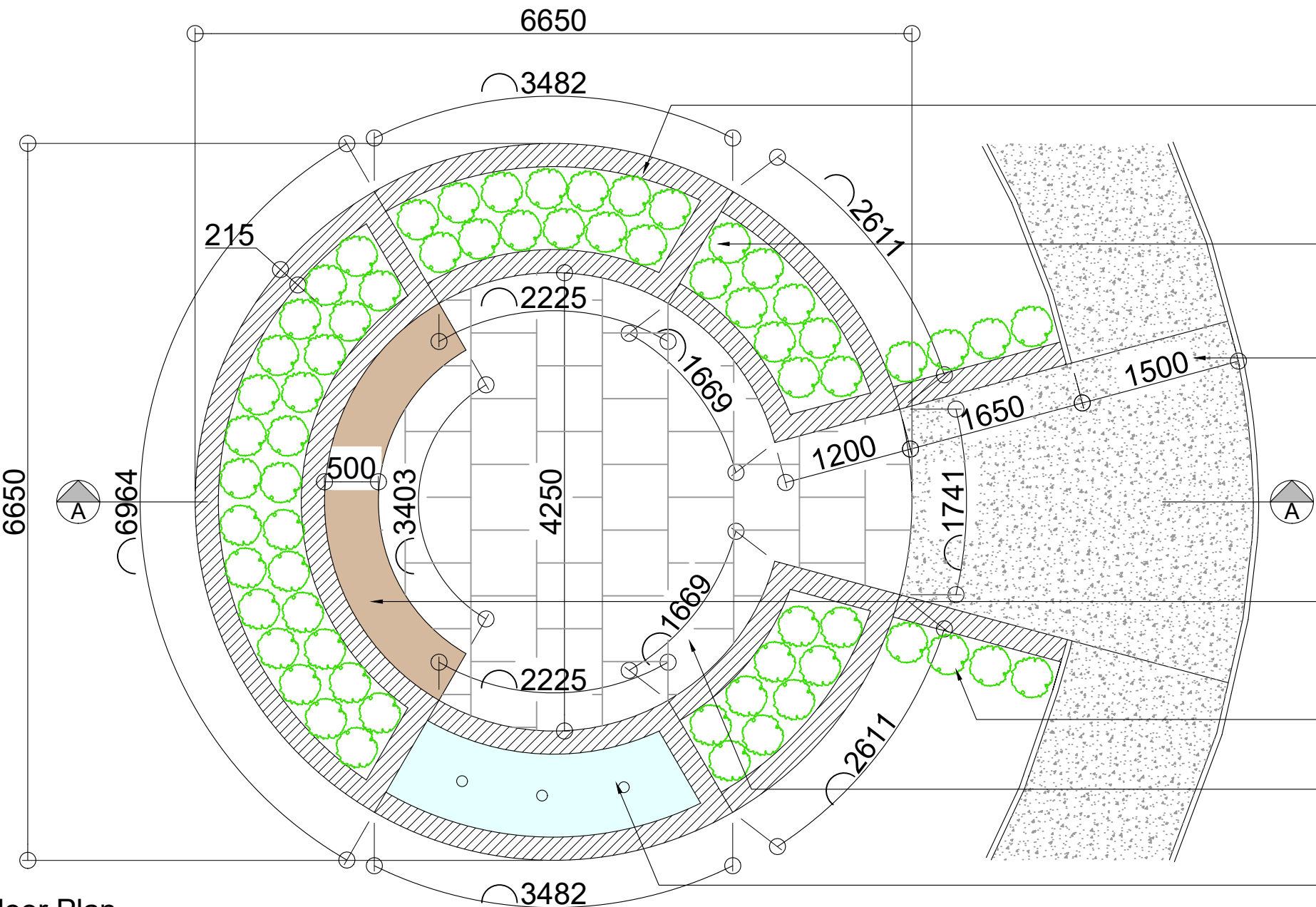

Proposed Floor Plan  
Scale 1:50

New 1.5m wide pathways to be created, from Entrance path to Sensory Garden path, to rear of Sensory Garden & to slope up alongside western boundary path. Paths to follow existing topography  
Yew (or similar more cost effective evergreen hedging) to be planted either side of path leading from Entrance to Sensory Garden path.  
Option costs required for pathways to be constructed from:  
-Tar & Chip  
-Resin Bound Gravel

New sensory garden to be constructed from double skin block-work (TBC by Structural Engineer, Stepoc blocks filled with concrete and reinforcing bar may be required for retaining walls). To be rendered in white and finished with Parex Bio-Graffiti Protection coating (or similar).

New 1.5m wide pathway to be created, to slope down at approximately 1:15 gradient to 3m long level platform in front of Sensory Garden.  
Adjacent ground to be excavated and built up where required to achieve the gradient and to create a level surface across the width of the path.  
Option costs required for pathway to be constructed from:  
-Tar & Chip  
-Resin Bound Gravel  
Details of sub-base and sub-grade dependant on final finish of pathway.

Hatching indicates adjacent ground to be built up to create a level surface across the width of the platform/path.

Red dashed line indicates existing ground level which needs to be excavated.

15m<sup>2</sup> Marshalls Sawn Sandstone Smooth Grey Multi Paving Slab 600 X 300 X 22 mm, or similar, (fall of 1 in 80 towards path), on mortar bed, on 100mm concrete slab

New concrete foundations to retaining wall to be 1:3:6 concrete (c25 mix) trench fill 600mm wide 600mm deep. (TBC by Structural Engineer, a raft foundation may be required).

New sensory garden to be constructed from double skin block-work (TBC by Structural Engineer, Stepoc blocks filled with concrete and reinforcing bar may be required for retaining walls). To be rendered in white and finished with Parex Bio-Graffiti Protection coating (or similar).

Planters to be filled with a well mixed combination of compost and topsoil and contain a mixture of shrubs / flowers / grasses to give all round colour and interest- specifically for a sensory garden.

New 1.5m wide pathway to be created, to slope down at approximately 1:15 gradient to 3m long level platform in front of Sensory Garden.  
Adjacent ground to be excavated and built up where required to achieve the gradient and to create a level surface across the width of the path.  
Option costs required for pathway to be constructed from:  
-Tar & Chip  
-Resin Bound Gravel  
Details of sub-base and sub-grade dependant on final finish of pathway.

Bench seating to be constructed from block-work, to be rendered in white and be finished with Parex Bio-Graffiti Protection coating (or similar). Bench top to be treated timber.

Mixture of low level shrubs to be planted to sides of level platform.

15m<sup>2</sup> Marshalls Sawn Sandstone Smooth Grey Multi Paving Slab 600 X 300 X 22 mm, or similar, (fall of 1 in 80 towards path), on mortar bed, on 100mm concrete slab

Area to be tanked to create water feature- Adequate pump and filter system to be installed. To be activated by a button and a timer. Electrics to be installed for the water feature.

PRELIMINARY  
ISSUE

**blueprint**  
Architectural Design Ltd.

5 BLOTT'S BARN, BROOKS ROAD, RAUNDS, NORTHANTS, NN9 6NS  
01933 551389 :: info@blueprintdesign.org.uk

TITLE	Alterations to Peace Memorial Park Huntingdon Road, Thrapston, NN14 4NF		
DETAIL	Sensory Garden Proposed Floor Plan, Section & 3D Visual		
SCALE	1:50	SHEET	A1
DRAWN	RV	CHECKED	RLG
DATE	February 2020	ISSUE	PRELIMINARY
			19-123-04

CONTRACTORS MUST CHECK ALL DIMENSIONS ON SITE. ONLY FIGURED DIMENSIONS ARE TO BE WORKED FROM. DISCREPANCIES MUST BE REPORTED TO BLUEPRINT BEFORE PROCEEDING. © THIS DRAWING IS COPYRIGHT.



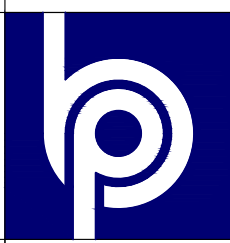

3D Visualisation  
NTS

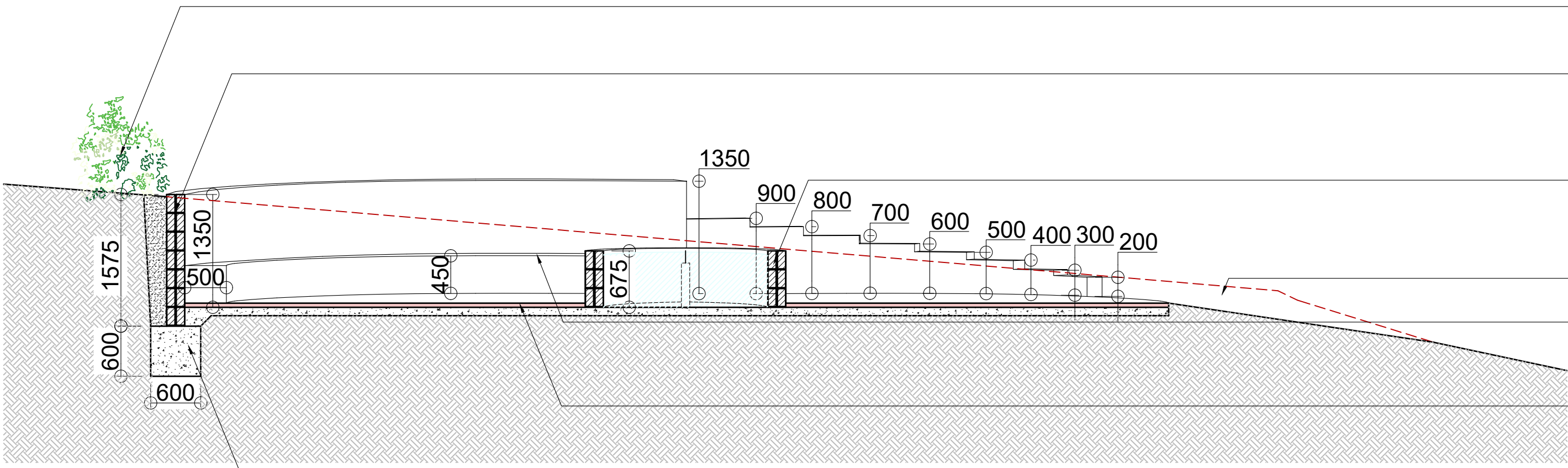

Section B-B  
Scale 1:50

- Mature dense/prickly evergreen hedging to be planted behind the top of the rear wall to create a natural barrier.
- New Poppy Meeting Place to be constructed from double skin block-work (TBC by Structural Engineer, Stepoc blocks filled with concrete and reinforcing bar may be required for retaining walls). To be rendered in grey and finished with Parex Bio-Graffiti Protection coating (or similar).
- Central water feature to be constructed from double skin block-work, to be rendered in dark grey. To be finished with Parex Bio-Graffiti Protection coating (or similar). Area to be tanked with adequate pump and filter system to be installed. To be activated by a day / night timer. Electrics to be installed for the water feature.
- Red dashed line indicates existing ground level which needs to be excavated.
- Bench seating to be constructed from block-work, to be rendered in grey and be finished with Parex Bio-Graffiti Protection coating (or similar). Bench top to be stone/slate.
- 80m<sup>2</sup> Marshalls Standard Concrete Block Paving Red 200mm x 100mm x 50mm, or similar, (fall of 1 in 80 towards path), on mortar bed, on 100mm concrete slab
- New concrete foundations to retaining wall to be 1:3:6 concrete (c25 mix) trench fill 600mm wide 600mm deep. (TBC by Structural Engineer, a raft foundation may be required).

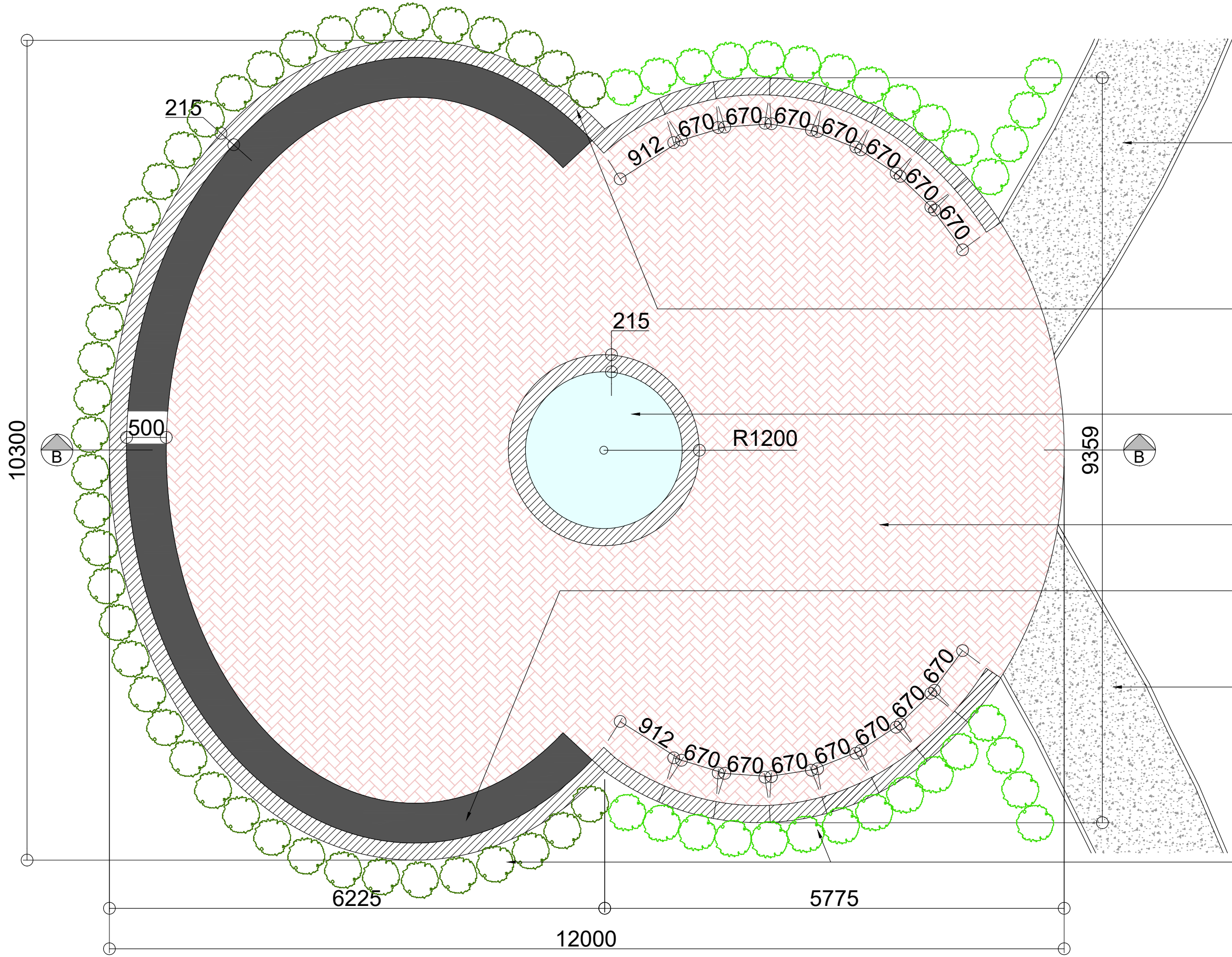

Floor Plan  
Scale 1:50

- New 1.5m wide pathways to be created, to slope down at approximately 1:15 gradient either side of 2m long level platform. Adjacent ground to be excavated and built up where required to achieve the gradient and to create a level surface across the width of the path. Option costs required for pathway to be constructed from:  
-Tar & Chip  
-Resin Bound Gravel
- New Poppy Meeting Place to be constructed from double skin block-work (TBC by Structural Engineer, Stepoc blocks filled with concrete and reinforcing bar may be required for retaining walls). To be rendered in grey and finished with Parex Bio-Graffiti Protection coating (or similar).
- Central water feature to be constructed from double skin block-work, to be rendered in black / dark grey. To be finished with Parex Bio-Graffiti Protection coating (or similar). Area to be tanked with adequate pump and filter system to be installed. To be activated by a day / night timer. Electrics to be installed for the water feature.
- 80m<sup>2</sup> Marshalls Standard Concrete Block Paving Red 200mm x 100mm x 50mm, or similar, (fall of 1 in 80 towards path), on mortar bed, on 100mm concrete slab
- Bench seating to be constructed from block-work, to be rendered in grey and be finished with Parex Bio-Graffiti Protection coating (or similar). Bench top to be stone/slate.
- New 1.5m wide pathways to be created, to slope down at approximately 1:15 gradient either side of 2m long level platform. Adjacent ground to be excavated and built up where required to achieve the gradient and to create a level surface across the width of the path. Option costs required for pathway to be constructed from:  
-Tar & Chip  
-Resin Bound Gravel
- Mature dense/prickly evergreen hedging to be planted behind the top of the rear wall to create a natural barrier. Mixture of low level shrubs to be planted to sides.

PRELIMINARY  
ISSUE

**blueprint**  
Architectural Design Ltd.

5 BLOTT'S BARN, BROOKS ROAD, RAUNDS, NORTHANTS, NN9 6NS  
01933 551389 :: info@blueprintdesign.org.uk

TITLE	Alterations to Peace Memorial Park Huntingdon Road, Thrapston, NN14 4NF		
DETAIL	Poppy Meeting Place Proposed Floor Plan, Section & 3D Visual		
SCALE	1:50	SHEET:	A1
DRAWN	RW	CHECKED	KL.G
DATE	February 2020	ISSUE	PRELIMINARY
			19-123-05
CONTRACTORS MUST CHECK ALL DIMENSIONS ON SITE. ONLY PLOTTED DIMENSIONS ARE TO BE WORKED FROM (DISCREPANCIES ARE NOT ALLOWED) FOR THIS DRAWING BEFORE PROCEEDING. © THIS DRAWING IS COPYRIGHT.			





3D Visualisation  
NTS

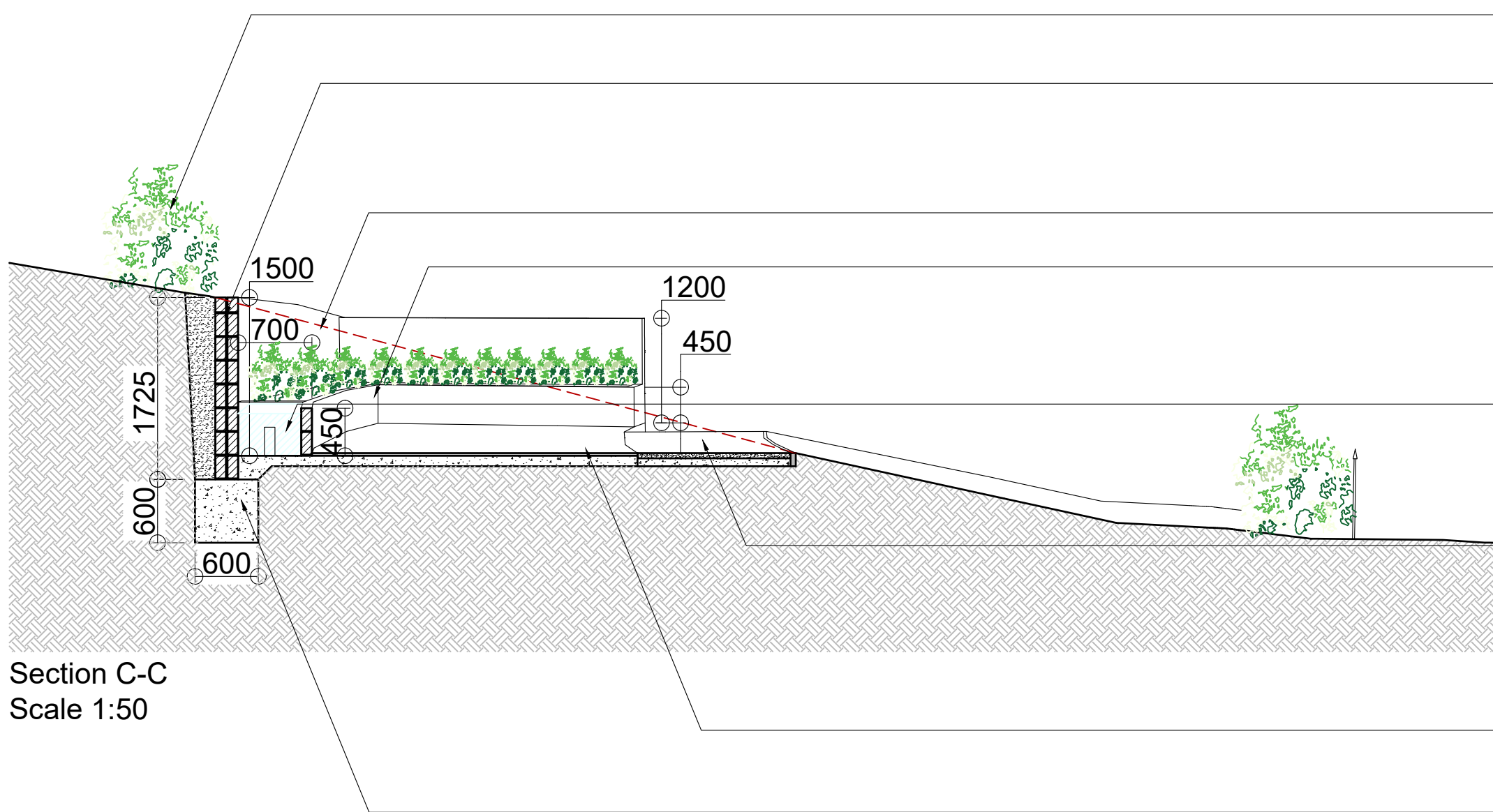

Section C-C  
Scale 1:50

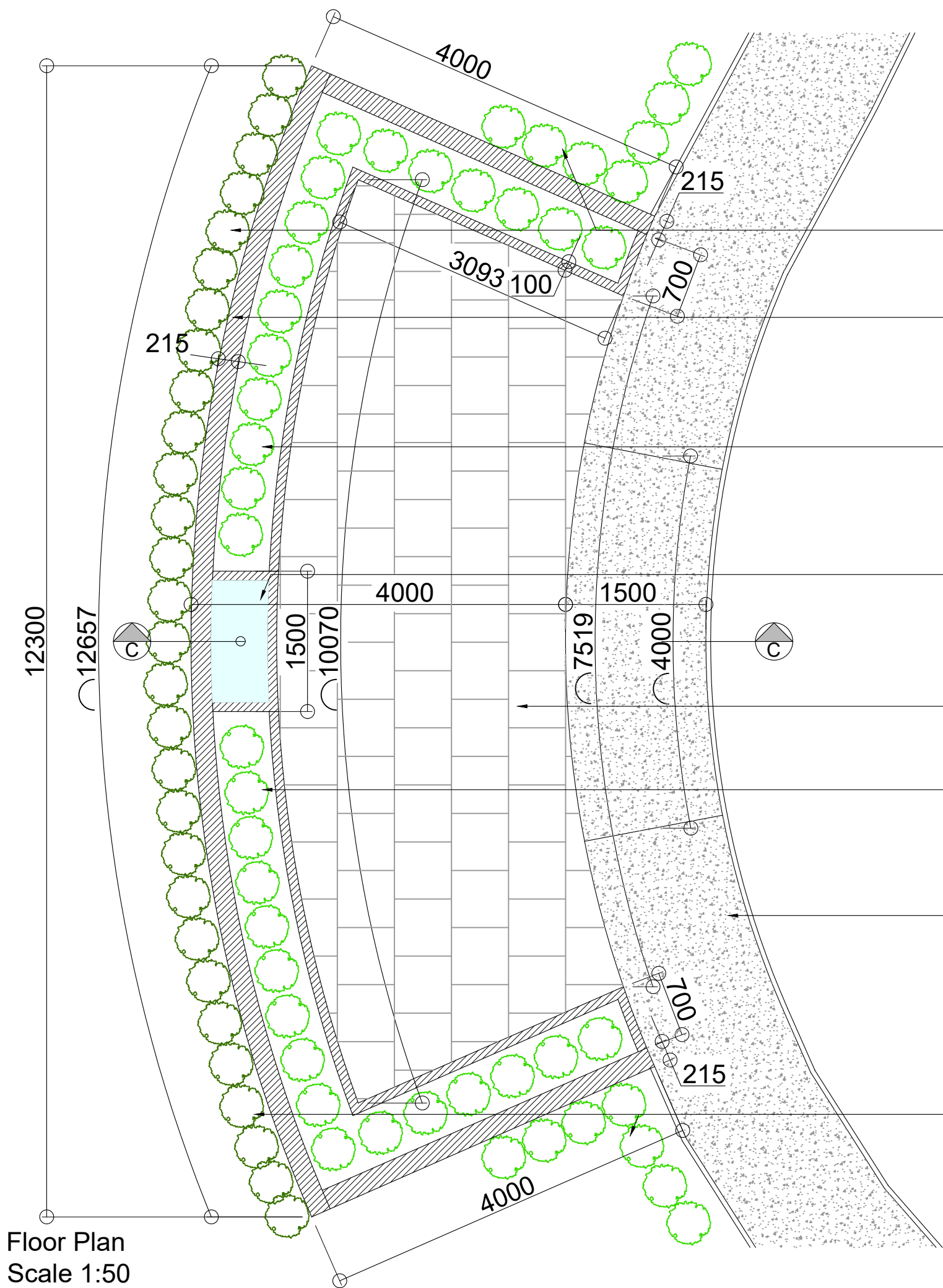

Floor Plan  
Scale 1:50

- Mature dense/prickly evergreen hedging to be planted behind the top of the rear wall to create a natural barrier.
- New Rose Garden to be constructed from double skin block-work (TBC by Structural Engineer, Stepoc blocks filled with concrete and reinforcing bar may be required for retaining walls). To be rendered in grey and finished with Parex Bio-Graffiti Protection coating (or similar).
- Red dashed line indicates existing ground level which needs to be excavated.
- Planters to be constructed from single skin block-work, to be rendered in grey. To be finished with Parex Bio-Graffiti Protection coating (or similar). To be filled with a well mixed combination of compost and topsoil and contain a mixture of rose bushes, a combination of 2 colours.
- Water feature to be constructed from single skin block-work, to be rendered in grey. To be finished with Parex Bio-Graffiti Protection coating (or similar). Area to be tanked with adequate pump and filter system to be installed. To be activated by a day / night timer. Electrics to be installed for the water feature.
- New 1.5m wide pathway to be created, to slope at approximately 1:15 gradient up to 4m long level platform in front of Rose Garden. Adjacent ground to be excavated and built up where required to achieve the gradient and to create a level surface across the width of the path. Option costs required for pathway to be constructed from:  
-Tar & Chip, Resin Bound Gravel
- 28m<sup>2</sup> Marshalls Heritage Old Yorkstone Paving Slabs 600 X 600 X 38 mm, or similar, (fall of 1 in 80 towards path), on mortar bed, on 100mm concrete slab
- New concrete foundations to retaining wall to be 1:3:6 concrete (c25 mix) trench fill 600mm wide 600mm deep. (TBC by Structural Engineer, a raft foundation may be required).
- Mature dense/prickly evergreen hedging to be planted behind the top of the rear wall to create a natural barrier.
- New Rose Garden to be constructed from double skin block-work (TBC by Structural Engineer, Stepoc blocks filled with concrete and reinforcing bar may be required for retaining walls). To be rendered in grey and finished with Parex Bio-Graffiti Protection coating (or similar).
- Planters to be constructed from single skin block-work, to be rendered in grey. To be finished with Parex Bio-Graffiti Protection coating (or similar). To be filled with a well mixed combination of compost and topsoil and contain a mixture of rose bushes, a combination of 2 colours.
- Water feature to be constructed from single skin block-work, to be rendered in grey. To be finished with Parex Bio-Graffiti Protection coating (or similar). Area to be tanked with adequate pump and filter system to be installed. To be activated by a day / night timer. Electrics to be installed for the water feature.
- 28m<sup>2</sup> Marshalls Heritage Old Yorkstone Paving Slabs 600 X 600 X 38 mm, or similar, (fall of 1 in 80 towards path), on mortar bed, on 100mm concrete slab
- Planters to be constructed from single skin block-work, to be rendered in grey. To be finished with Parex Bio-Graffiti Protection coating (or similar). To be filled with a well mixed combination of compost and topsoil and contain a mixture of rose bushes, a combination of 2 colours.
- New 1.5m wide pathways to be created, to slope down at approximately 1:15 gradient either side of 2m long level platform. Adjacent ground to be excavated and built up where required to achieve the gradient and to create a level surface across the width of the path. Option costs required for pathway to be constructed from:  
-Tar & Chip  
-Resin Bound Gravel
- Mature dense/prickly evergreen hedging to be planted behind the top of the rear wall to create a natural barrier. Mixture of low level shrubs to be planted to sides.