

# VE Rest Area Layout

New dividing full height partition to soffit underside from timber and 12mm plasterboard each side to form 30 minute compartment. Interior to be insulated. Electrical conduits to be run internally at construction. Separating stud nibs to be of same construction and fixing to brace main dividing partition. Contractor to install timber wall plate at window end with closer detail to glass to be agreed.

Retail Storage

All loose furniture and fittings to be supplied by Museum.

Changing rooms to be constructed from stud off floor to 2.4m plasterboard each side and braced off existing stud and new dividing wall. Doors to be 850 and 1.0m respectively. Each changing room to have full height mirror fixing.

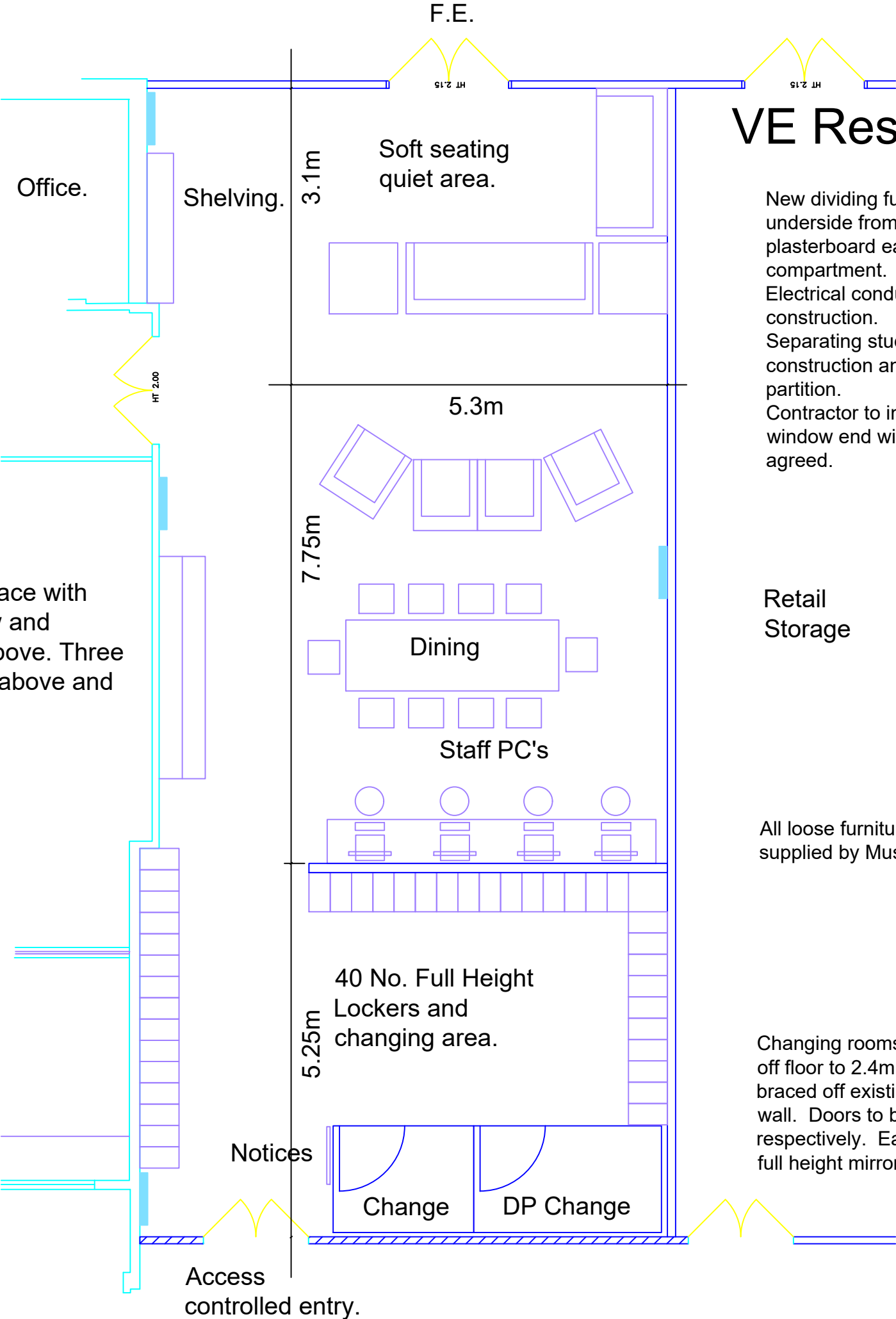

Worktop surface with fridges below and cupboards above. Three twin sockets above and two below.