

Phase 1 Works

Not to Scale

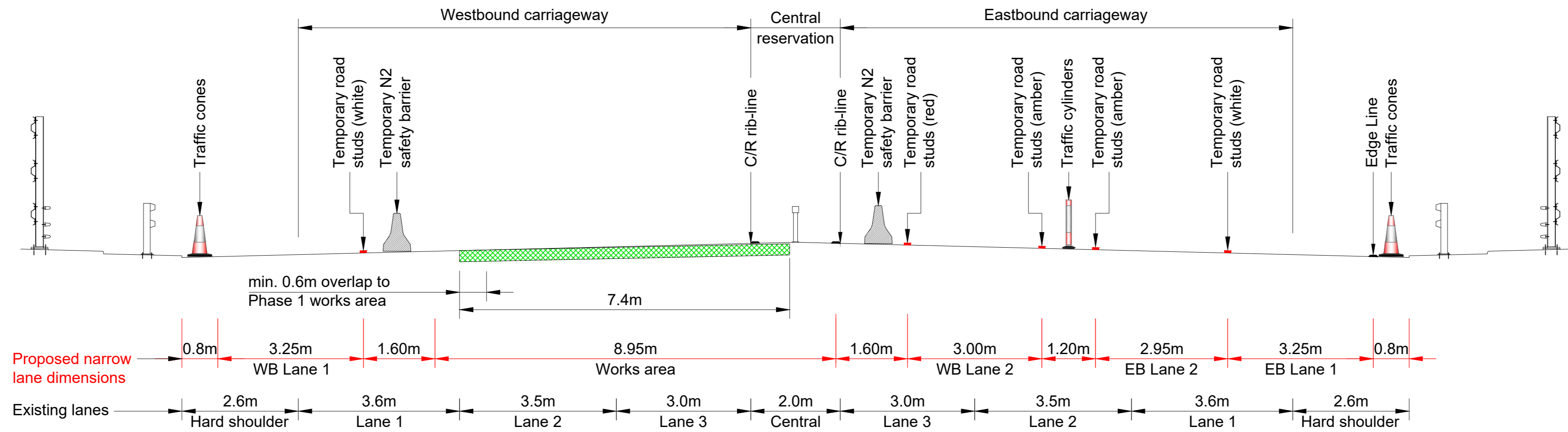

Phase 2 Works

Not to Scale

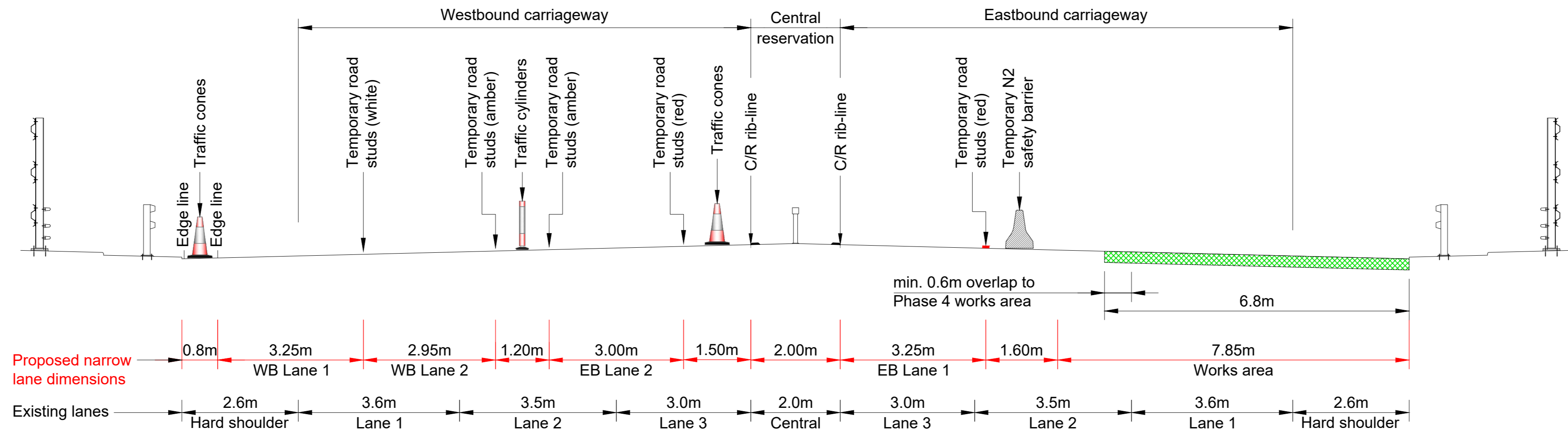

Phase 3 Works

Not to Scale

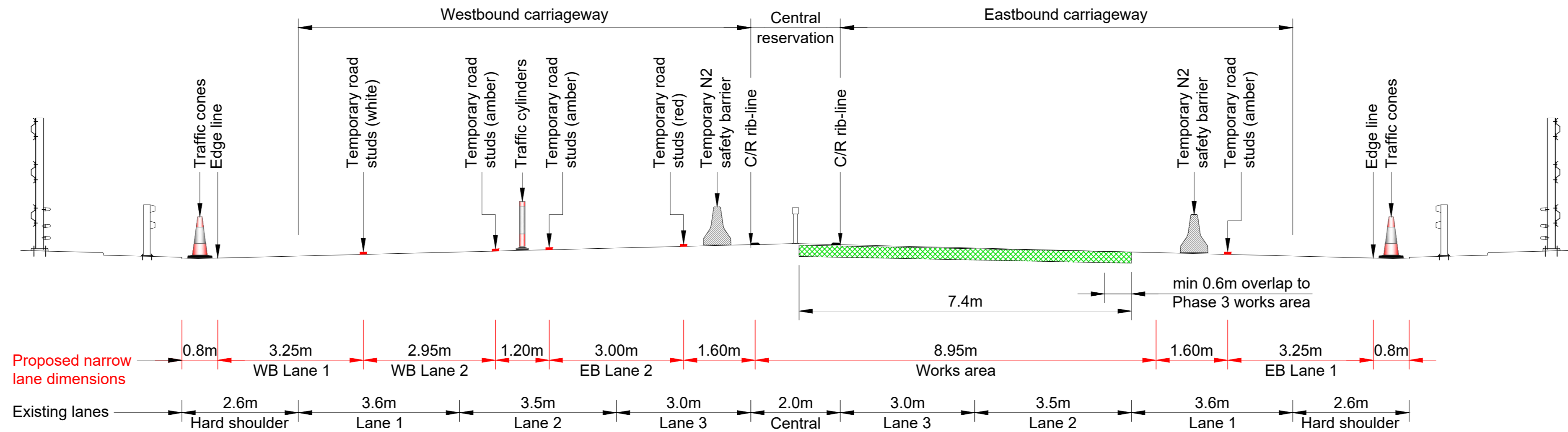

Phase 4 Works

Not to Scale

NOTES

- Do not scale from this drawing.
- All dimensions are in millimeters unless otherwise stated.
- Dimensions are taken from record drawings and have not been confirmed by measurement.
- The central barrier is to be replaced along the full length of the structure and the full carriageway is to be resurfaced.
- Phasing: The works are expected to be separated into the following phases:
 - Westbound Lane 1 and Hard Shoulder
 - Westbound Lane 2 and Lane 3
 - Eastbound Lane 1 and Hard Shoulder
 - Eastbound Lane 2 and Lane 3

KEY:

- Works Area (indicative only)
- Traffic Cone - 1m
- Traffic Cylinder
- White Line
- White Line Ribbed
- Road Stud (white)
- Road Stud (amber)
- Road Stud (red)

RESIDUAL DESIGN HAZARDS

(The following information has been collected from Preconstruction Information and the Amey CDM Hazard Management Process).
Residual Design Hazards:
HS-01 - Striking existing utilities
HS-02 - Temporary instability of bridge as a result of concrete removal
HS-03 - Risk of Injury from protruding reinforcement
HS-04 - RA1 Procedure limitations
HS-05 - Reduction in deck thickness due to hydro demolition
HS-06 - Depth of deck when breaking out concrete
HS-07 - Trafficking of the deck following treatment

P01	For Tender	AD	RN	MB	25.03.24
Rev	Revision details	Drwn	Chkd	Appd	Date
Designed: Amey		Date: 25.03.2024			
Drawn: Martin Holder		Date: 25.03.2024			
Checked: Santosh Pandey		Date: 25.03.2024			
Approved: Mark Broome		Date: 25.03.2024			

Copyright in this design © Amey

Amey

www.amey.co.uk



Project Name
M4 Prince of Wales Bridge
Resurfacing Strategy

Drawing Title
Prince of Wales Bridge
Cable Stay Bridge - Proposed
Phasing of Traffic Management

Original Drawing Size : A1	Scale : As Shown
Dimensions : Metres	

Drawing Status For Tender	Suitability S2
------------------------------	-------------------

Drawing No SBIM-POW-TO824-DWG-0006	Rev P01
---------------------------------------	------------