

Notes

1. Dimensions - the contractor shall be responsible for the verification of all dimensions both on these plans and on site.

2. Existing services - all services shown on this plan are indicative and the contractor shall be responsible for verifying both the horizontal and vertical alignment of all underground and overhead services.

3. Drawing Issue - only drawings issued as PDF's or hardcopy will be deemed to be a controlled copy. All other forms of media including, dwg and dxf will be considered uncontrolled copies. The owner of these drawings will not accept any liability for an error arising from using such uncontrolled media.

4. Copyright - this drawing at its design is the property of Icarus Consulting Limited and has been compiled for the sole use of the client stated below. This drawing or design may not be copied or distributed in any form without the prior written consent of the owner.

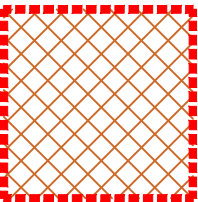

Extent of
Earthworks

EARTH WORKS SPECIFICATION

1. All existing services must be identified, protected or lowered as appropriate.

2. All earthworks are to be carried out in accordance with S600 Earthworks of the Specification for Highways Works, MCDHW.

3. Formation level to be approximately 480mm below finished pavement level. Approximate area of excavation 702m²

5. Where possible all existing topsoil is to remain on site for re-use.

6. All exposed formation is to be protected from the elements as soon as possible.

7. The Contractor is to arrange CBR testing of the formation level to confirm the design CBR value.

Revision History

Revision Number	Date	Revision Details
001	16.03.18	Changes to earthworks following comments from planners.

Icarus Consulting
Limited

North Lodge
Putteridge Park
Luton
Beds
LU2 8LF
01582 931769
www.icarus-consulting.com

Clients Name

POTTON TOWN COUNCIL

Project Title	Drawing Status
Brook End Car Park	Tender
Drawing Title	Drawn By
Earthworks	ML
Drawing No:	Date
201709-PTC-C-600	19.03.18
Revision	Project Status
001	Tender

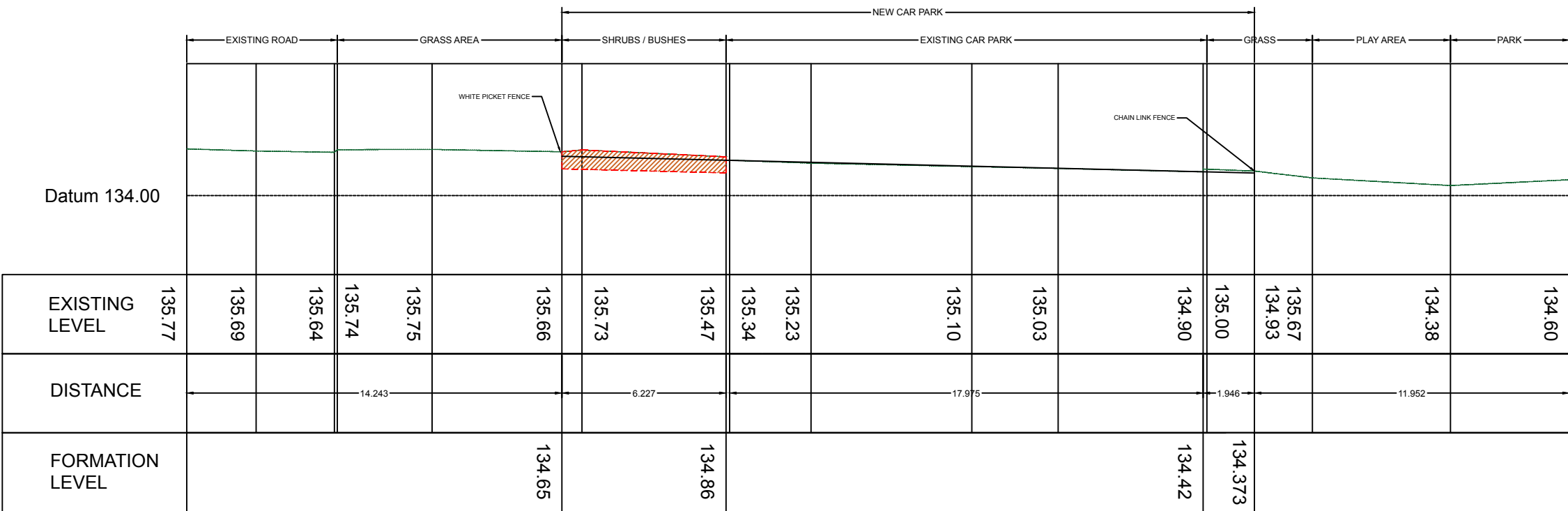

SECTION A-A

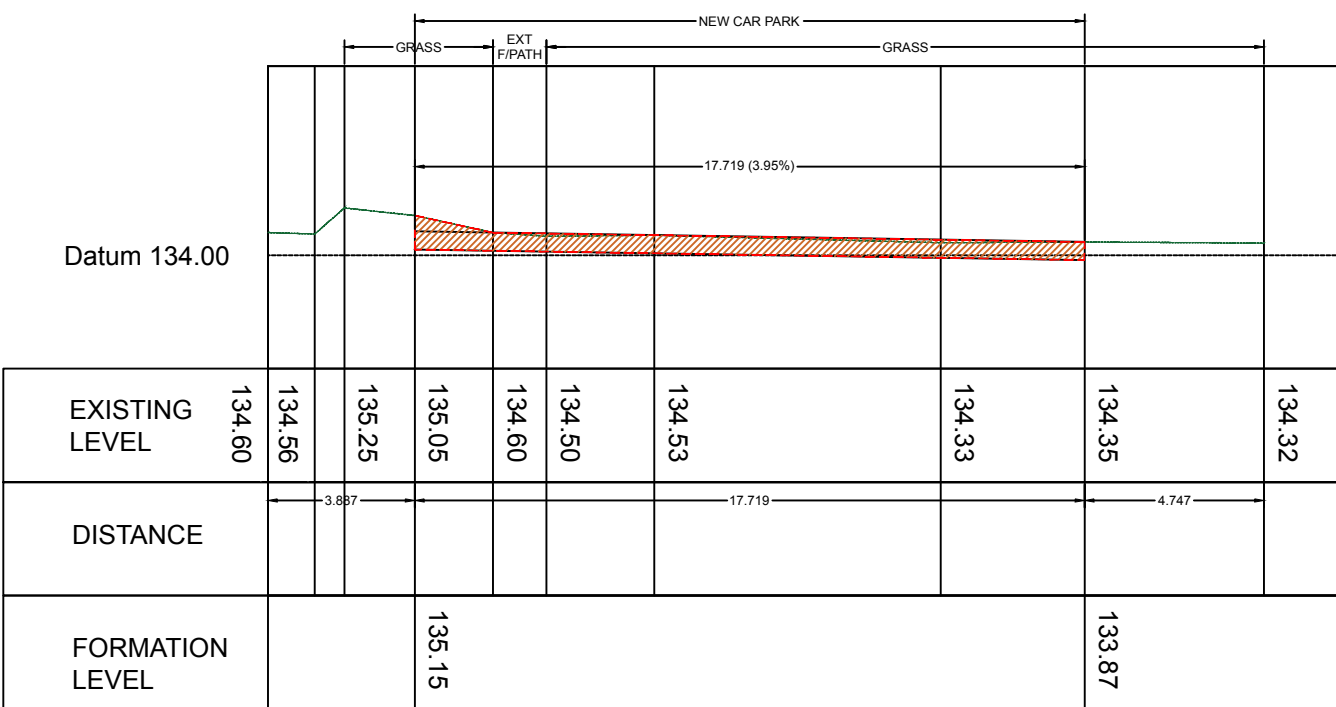

SECTION B-B

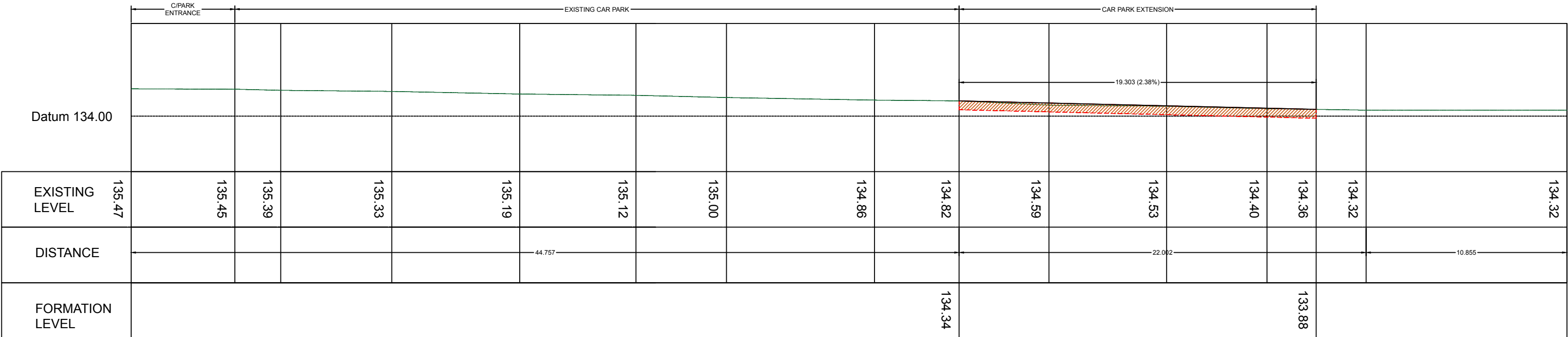

SECTION C-C