

Women WC Lobby

- Carefully remove and retain for reuse existing door stoppers (2no).
- Note. Existing door stoppers are to be reinstalled in same location.
- Remove existing vinyl flooring.
  - Carefully remove and retain for reuse existing smoke detector, emergency light, and light + motion sensor.
- Note. Electrics to be made safe. To be reinstalled in same location.
- Remove ceiling tiles.
- Note. Existing T24 suspended metal grid to be retained in place. New ceiling tiles are to be installed.

Disabled WC:

- Remove existing vinyl flooring.
  - Carefully remove and retain for reuse existing smoke detector, ceiling mounted vent, emergency light, and light + motion sensor.
- Note. Electrics to be made safe. To be reinstalled in same location.
- Remove ceiling tiles.
- Note. Existing T24 suspended metal grid to be retained in place. New ceiling tiles are to be installed.
- Remove alarm pull cord and alarm reset, incl wall mounted electrical conduit.
- Note. Electrics to be made safe.
- New alarm reset with chased wiring is to be installed.
- Remove radiator.
- Note. Associated wall mounted pipes to be retained in place and protected against damage while works carried out.
- New LST wet radiator is to be installed.
- Remove toilet and basin, and temporarily cap drainage.
  - Remove tile splashback.
  - Remove mirror.
  - Remove boxing under basin.
  - Remove vertical grab rails (2no) and hinged support rail.
  - Remove toilet paper dispenser.
  - Remove soap dispenser.
  - Carefully remove and retain for reuse existing automatic hand dryer, and remove wall mounted electrical conduit.
- Note. Electrics to be made safe.
- Existing automatic hand dryer is to be reinstalled in same location.
- Carefully remove and retain for reuse existing wall mounted air freshener dispenser.
- Note. Existing air freshener is to be reinstalled in same location.
- Carefully remove and retain for reuse existing wall mounted baby change station.
- Note. Existing baby change unit is to be reinstalled in same location.

Men WC Lobby

- Carefully remove and retain for reuse existing door stoppers (2no).
- Note. Existing door stoppers are to be reinstalled in same location.
- Remove existing vinyl flooring.
  - Carefully remove and retain for reuse existing smoke detector, emergency light, and light + motion sensor.
- Note. Electrics to be made safe. To be reinstalled in same location.
- Remove ceiling tiles.
- Note. Existing T24 suspended metal grid to be retained in place. New ceiling tiles are to be installed.

Women WC

- Remove existing vinyl flooring.
  - Carefully remove and retain for reuse existing smoke detector, ceiling mounted vent, emergency lights (2no), and lights (5no) + motion sensor.
- Note. Electrics to be made safe. To be reinstalled in same location.
- Remove ceiling tiles.
- Note. Existing T24 suspended metal grid to be retained in place. New ceiling tiles are to be installed.
- Carefully remove and retain for reuse existing wall mounted air freshener dispenser.
- Note. Existing air freshener is to be reinstalled in same location.
- Remove radiator.
- Note. Associated wall mounted pipes to be retained in place and protected against damage while works carried out.
- New LST wet radiator is to be installed.
- Remove basins (3no).
  - Remove mirrors (2no).
  - Remove soap dispensers (2no).
  - Carefully remove and retain for reuse existing automatic hand dryer, and remove wall mounted electrical conduit.
- Note. Electrics to be made safe.
- Existing automatic hand dryer is to be reinstalled in same location.
- Remove basin countertop.
  - Remove tile splashback.
  - Remove toilets (3no) incl. concealed cisterns.
  - Remove toilet paper dispensers (3no).
  - Fully remove toilet cubicles.
- Note. New cubicles and decorative duct panelling with shadow gaps is to be installed as per cubicle specialist design.

Men WC

- Remove existing vinyl flooring.
  - Carefully remove and retain for reuse existing smoke detector, ceiling mounted vents (2no), emergency lights (2no), and lights (5no) + motion sensors (2no).
- Note. Electrics to be made safe. To be reinstalled in same location.
- Remove ceiling tiles.
- Note. Existing T24 suspended metal grid to be retained in place. New ceiling tiles are to be installed.
- Carefully remove and retain for reuse existing wall mounted air freshener dispenser.
- Note. Existing air freshener is to be reinstalled in same location.
- Remove radiator.
- Note. Associated wall mounted pipes to be retained in place and protected against damage while works carried out. New LST wet radiator is to be installed.
- Remove urinals (3no) incl. concealed cisterns.
  - Remove existing panelling behind urinals incl. access / decorative panels, ply lining and studwork.
- Note. New duct panelling with shadow gaps is to be installed as per cubicle specialist design.
- Remove basins (3no).
  - Remove shaver socket.
- Note. Electrics to be made safe.
- New shaver socket is to be installed in same location.
- Carefully remove and retain for reuse existing automatic hand dryer, and remove wall mounted electrical conduit.
- Note. Electrics to be made safe.
- Existing automatic hand dryer is to be reinstalled in same location.
- Remove mirrors (3no).
  - Remove soap dispensers (2no).
  - Remove basin countertop.
  - Remove tile splashback.
  - Remove toilet.
  - Remove toilet paper dispenser.
  - Fully remove toilet cubicle and existing panelling behind toilet, incl. access / decorative panels, ply lining and studwork.
- Note. New cubicle and duct panelling with shadow gaps is to be installed as per cubicle specialist design.

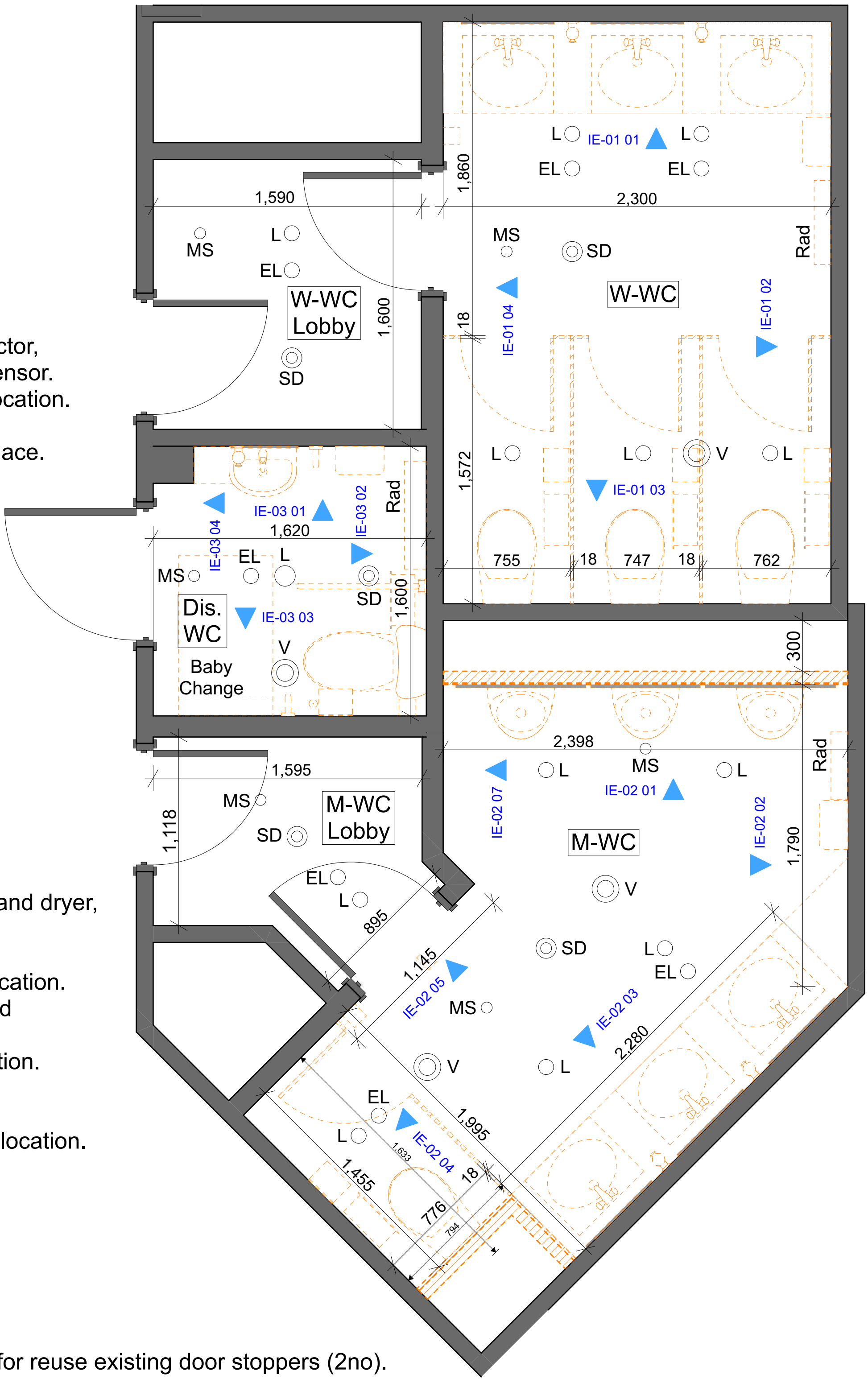

Rev ID	Change ID	Change Name	Date
02	Ch-03	Tender	23/01/2025
01	Ch-02	Tender Issue Draft (WIP)	23/01/2025
Project			
Crowborough Community Centre Pine Grove TN6 1FE			
Layout Title			
Demolition Plan			
Client			
Crowborough Town Council			
Purpose of Issue			Original Scale
Tender			A1
Mackellar Schwerdt Architects LLP			
Lyell House Daveys Lane, Lewes, East Sussex BN7 2BG			
Email: info@mackellarschwerdt.co.uk			
Tel: 01273 480608			
NOTES			
This drawing is Copyright © and shall not be reproduced nor used for any other purpose without the written permission of the Architects.			
Do not scale this drawing.			
The Contractor is responsible for checking all dimensions on site. Report any discrepancies, errors or omissions to the Architects immediately.			
The Contractor shall ensure that all goods, materials and workmanship conform with current British Agrement Certificates, British Standards and Building Regulations, and ensure that all works are executed in full compliance with all current Codes of Practice and Regulations in respect of Health & Safety.			
This office is licensed to reproduce Ordnance Survey maps onto drawings but anyone doing so must ensure that this use is acknowledged by displaying the following on all copies of all paper maps: © Crown copyright. All rights reserved. Licence number AR 100006739			
Drawing Number			
Project	Status	Number	Revision
9213	T	015	02