

1 PLAN
SCALE 1:500

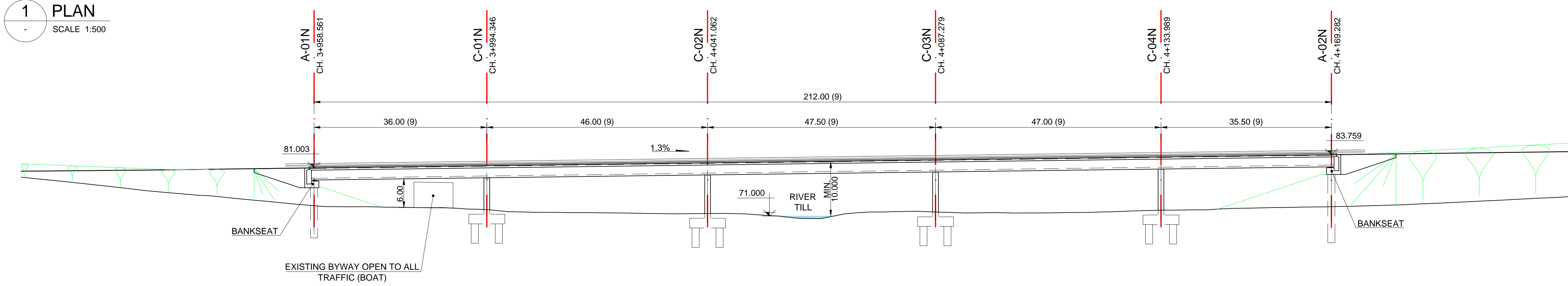

A EASTBOUND ELEVATION
SCALE 1:500

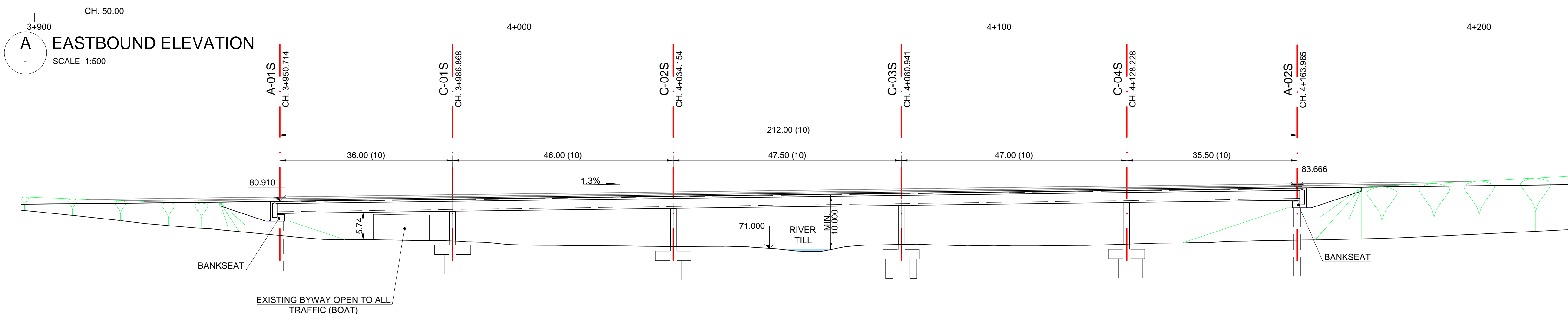

B WESTBOUND ELEVATION
SCALE 1:500

Reproduced by permission of Ordnance Survey on behalf of HMSO. © Crown copyright and database right 2019. All rights reserved. Ordnance Survey Licence number 100030649.

- NOTES:
- ALL DIMENSIONS ARE IN METRES UNLESS NOTED OTHERWISE.
 - THESE PROPOSALS DO NOT INCLUDE ANY LONGITUDINAL, LATERAL OR VERTICAL DEVIATIONS (WITHIN THE LIMITS OF DEVIATION) FROM THE CENTRELINES, LEVELS OR EXTENTS IN VOLUME 2.7 (ENGINEERING SECTION DRAWINGS (PLANS AND PROFILES)) AND VOLUME 2.8 (ENGINEERING SECTION DRAWINGS (CROSS SECTIONS)) OF THE DCO.
 - 80 MSA (MIN) ROAD PAVEMENT WITH THIN SURFACING COURSE SYSTEM (ROAD/TYRE NOISE LEVEL 3) IN ACCORDANCE WITH SCOPE 10.1.2, 10.1.3 AND TABLE 10.1
 - FENCING AND GATES TO BE PROVIDED IN ACCORDANCE WITH THE ACCOMMODATION WORKS SCHEDULE (REF HE551506-AMW-HAW-SW_GN_000_Z-SH-CH-1000) AND VOLUME 2 PART 2 CLAUSE 4.3.5
 - ALL PROW SURFACING TO BE SELECTED IN ACCORDANCE WITH THE OVERALL DESIGN VISION REFLECTING LOCAL CHARACTER AND MATERIALS SUBJECT TO CONSULTATION IN ACCORDANCE WITH THE SCOPE
 - EXCEPT FOR FIGURED DIMENSIONS, THE DESIGN SHOWN IN THIS DRAWING IS INDICATIVE AND WILL BE ADJUSTED IN SUBSEQUENT STAGES OF DEVELOPMENT.
 - THE DIMENSIONS OF THE FOUNDATIONS SHOWN IN THIS DRAWING ARE ILLUSTRATIVE AND SHALL BE DESIGNED AT A SUBSEQUENT SUBMISSION. THE LOCATIONS OF THE PIERS AND FOUNDATIONS WILL BE A MINIMUM 8 M OUTSIDE OF THE BOUNDARY OF THE RIVER TILL SECTION OF THE RIVER AVON SPECIAL AREA OF CONSERVATION.
 - DECK AND PIER SECTIONS SHOWN IN THIS DRAWING ARE INDICATIVE. THIS DRAWING SHALL BE READ IN CONJUNCTION WITH CROSS SECTION DRAWINGS.
 - CHAINAGES SHOWN IN THIS DRAWING REFERRED TO THE CENTRAL AXIS BETWEEN DECKS (ALIGNMENT AXIS)
 - DRAINAGE STRATEGY: ACCORDING TO THE OEMP AND TECHNICAL REQUIREMENTS, WATER WILL BE COLLECTED IN THE LOWER SIDE OF THE DECK BY MEANS OF BRIDGE DECK UNITS AND DRIVEN TO THE A-01N AND A-01S ABUTMENTS WHERE WILL BE DISCHARGED TO THE GENERAL DRAINAGE SYSTEM.
 - DISTANCES REFERRED TO THE EASTBOUND STRUCTURE AXIS.
 - DISTANCES REFERRED TO THE WESTBOUND STRUCTURE AXIS.

- LEGEND:
- ORDER LIMITS
 - PROPOSED PERMANENT FENCELINE (SEE NOTE 4 ABOVE)
 - WATERCOURSE
 - PROPOSED BYWAY OPEN TO ALL TRAFFIC
 - PROPOSED CARRIAGEWAY
 - PROPOSED EARTHWORKS (EMBANKMENT)
 - EXISTING CONTOUR
 - AREA RETURNED TO AGRICULTURE
 - RETAINED VEGETATION
 - PROPOSED WOODLAND
 - OPEN CHALK GRASSLANDS
 - PROPOSED NATIVE HEDGEROW WITH TREES
 - EXISTING RETAINED HEDGEROW

Rev	Rev. Date	Purpose of revision	Drawn	Checked	Rev'd	Appr'd
P02	08/02/21	FOR QUALITY SUBMISSION - 09 FEB 2021	MP	AF	JC	AF
P03	22/03/21	FOR QUALITY SUBMISSION - 23 MAR 2021	MP	MP	MP	PB
P04	19/05/21	FOR QUALITY SUBMISSION - 20 APR 2021	MP	MP	MP	PB
P05	20/05/21	FOR QUALITY SUBMISSION - 20 MAY 2021	MP	MP	MP	PB

Client

highways
england

Project

A303
Amesbury to Berwick Down

Drawing title

RIVER TILL VIADUCT
GENERAL ARRANGEMENT

Drawing status

S4 - SUITABLE FOR STAGED APPROVAL

State Code	Preliminary
Project Stage	PCF Stage 5
Scale	1:500
Jacobs No.	HE551506
Client no.	HE551506

DO NOT SCALE	Rev	P05
--------------	-----	-----

Drawing number

HE551506 - BGR - SBR -

Location

Z1BR00Z

Type

-DR-

Role

S

Number

-0001

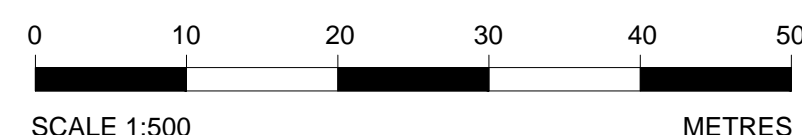

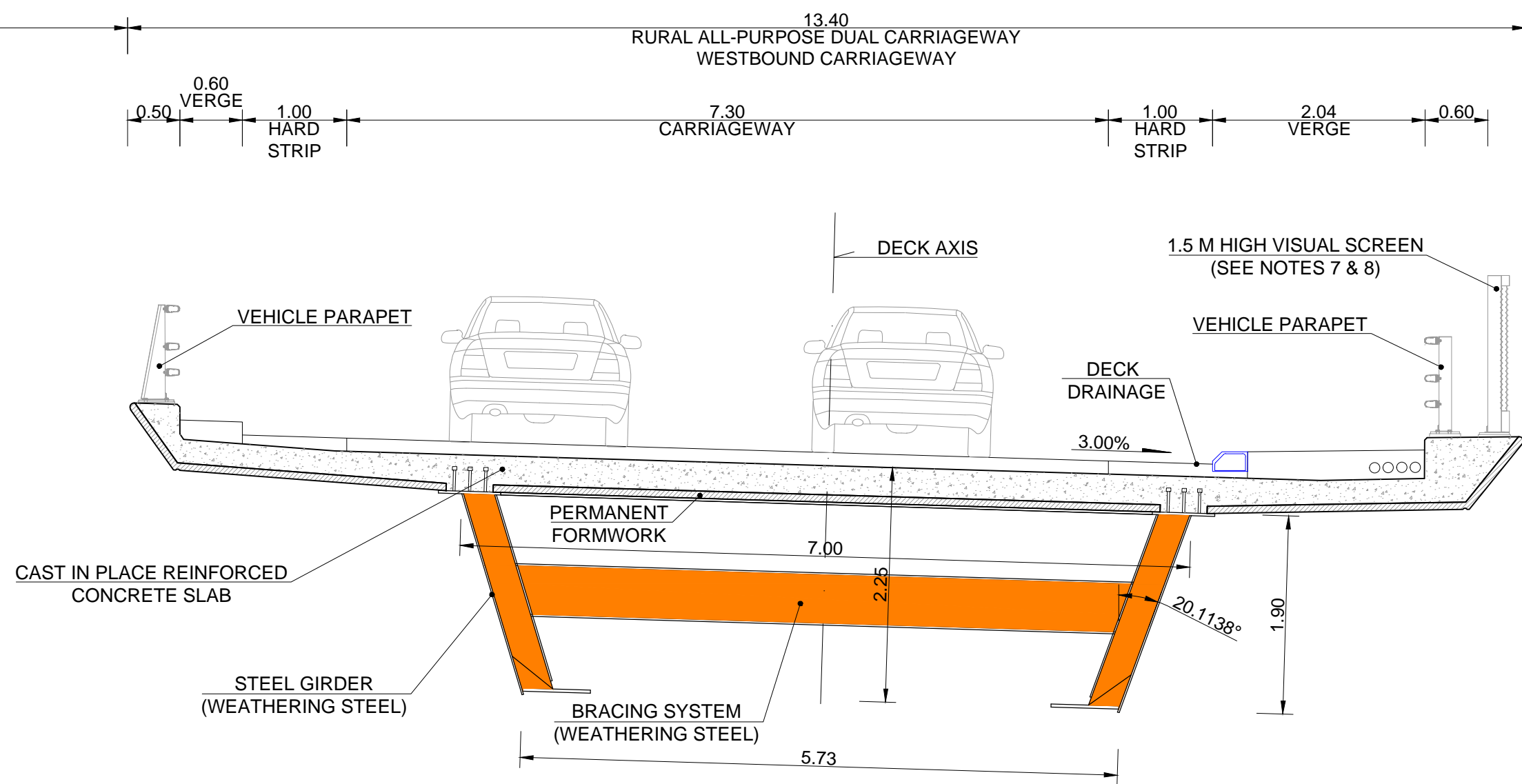
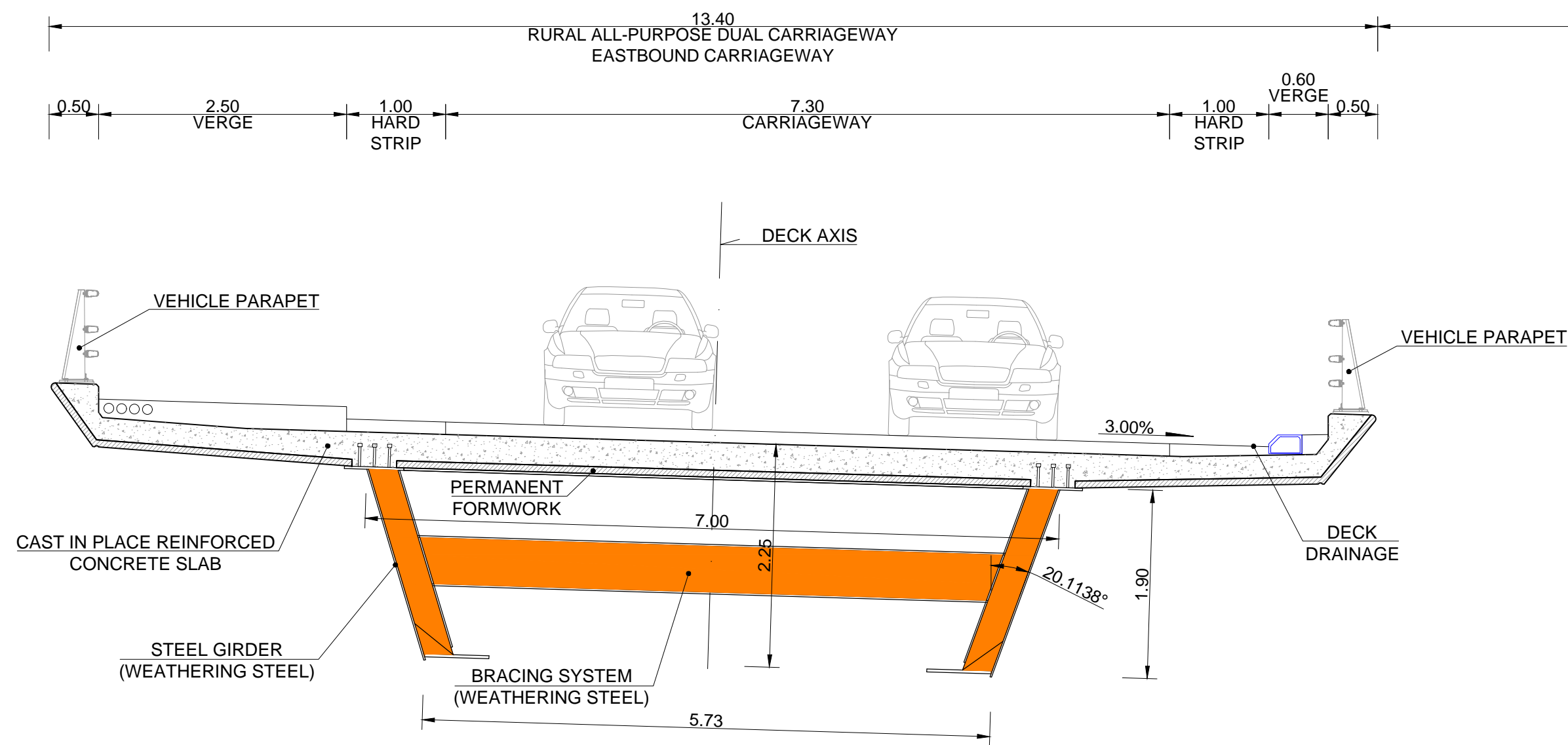

3 COMPOSITE STEEL-CONCRETE TWIN TILTED I GIRDERS
(INTERMEDIATE SECTION WITH BRACING)
SCALE 1:50

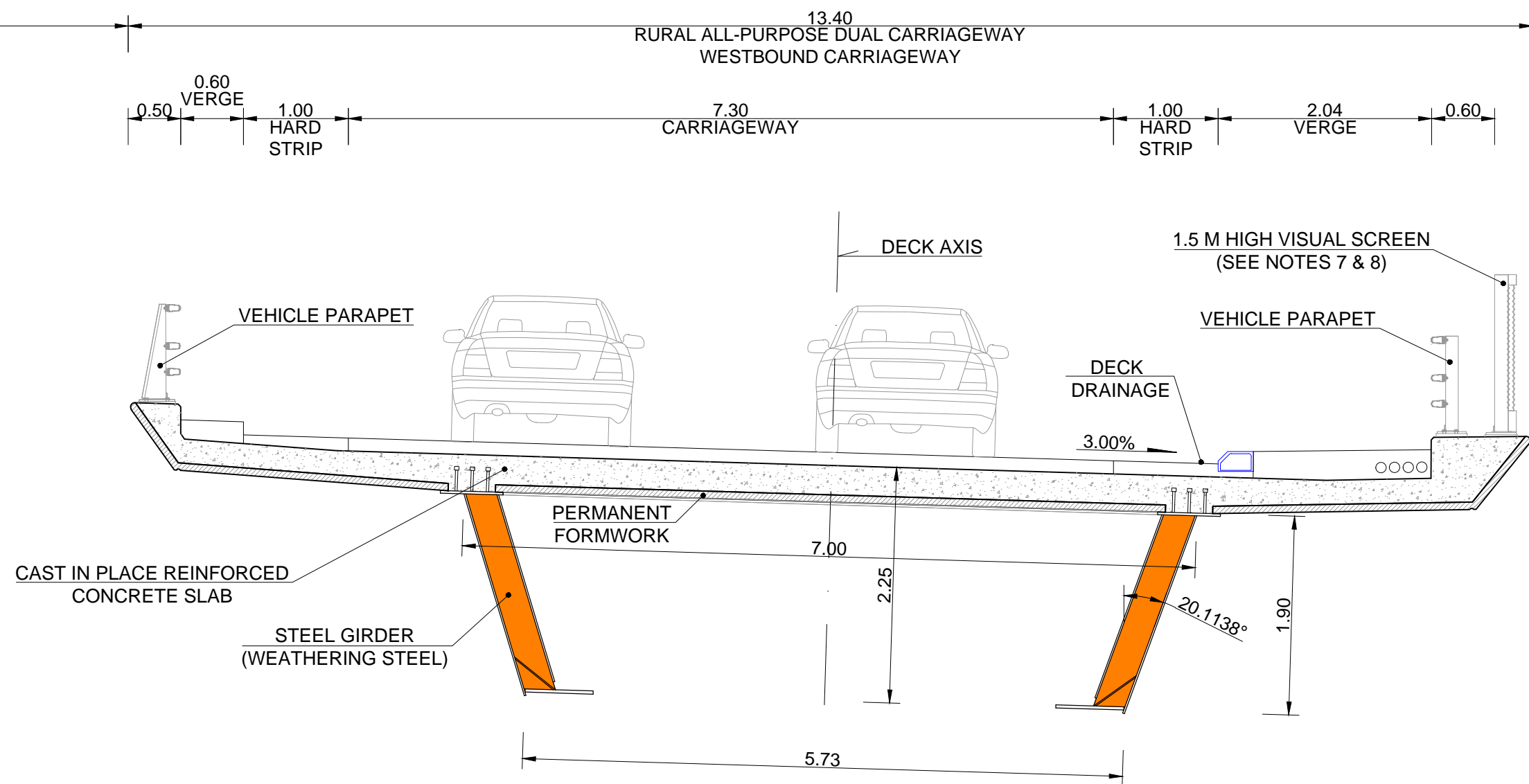
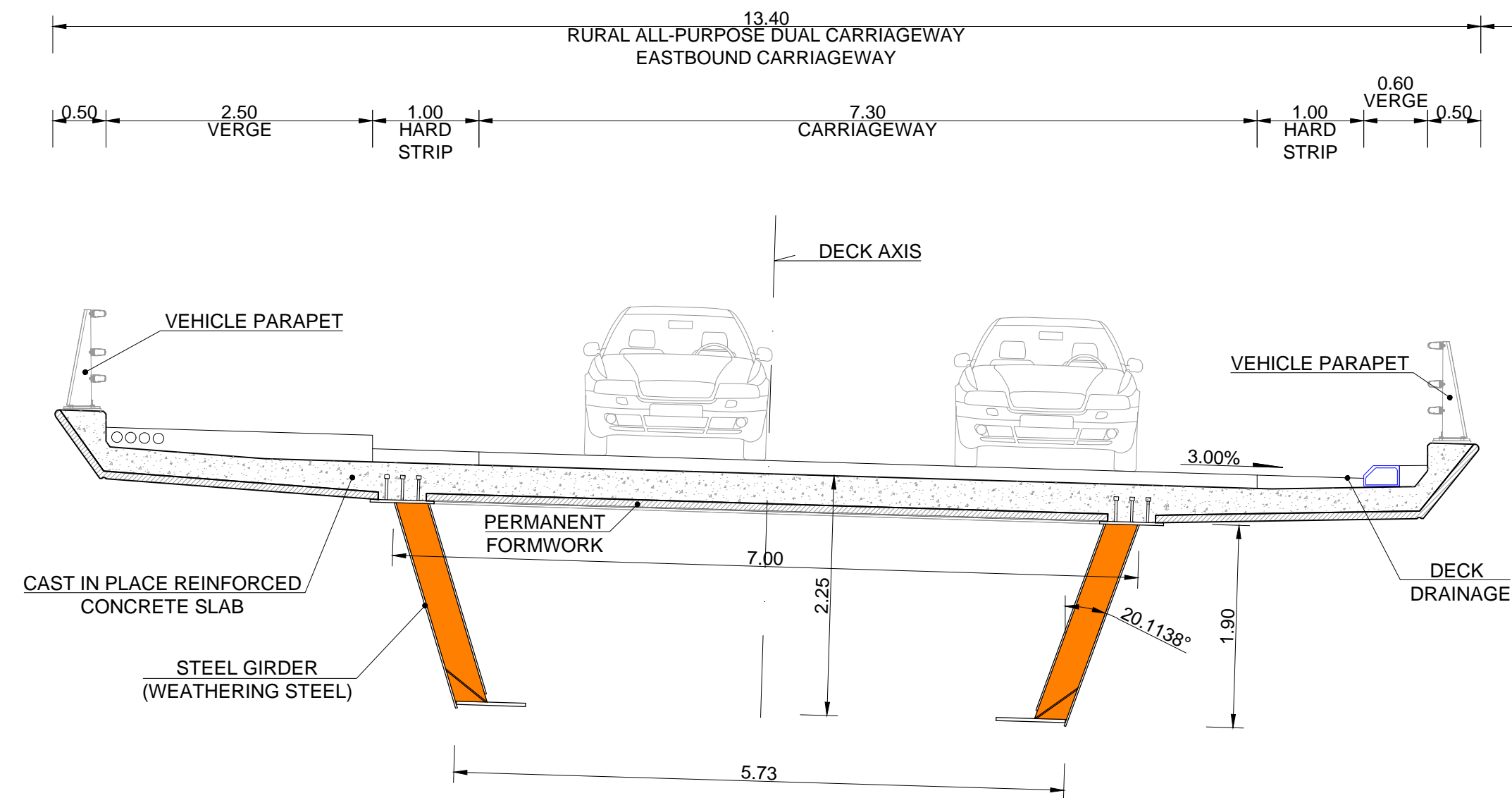

3 COMPOSITE STEEL-CONCRETE TWIN TILTED I GIRDERS
(INTERMEDIATE SECTION WITHOUT BRACING)
SCALE 1:50

- NOTES:
- ALL DIMENSIONS ARE IN METRES UNLESS NOTED OTHERWISE.
 - EXCEPT FOR FIGURED DIMENSIONS, THE DESIGN SHOWN IN THIS DRAWING IS INDICATIVE AND WILL BE ADJUSTED IN SUBSEQUENT STAGES OF DEVELOPMENT.
 - THE DIMENSIONS OF THE FOUNDATIONS SHOWN IN THIS DRAWING ARE ILLUSTRATIVE AND SHALL BE DESIGNED AT A SUBSEQUENT SUBMISSION. THE LOCATIONS OF THE PIERS AND FOUNDATIONS WILL BE A MINIMUM 8 M OUTSIDE OF THE BOUNDARY OF THE RIVER TILL SECTION OF THE RIVER AVON SPECIAL AREA OF CONSERVATION.
 - DECK AND PIER SECTIONS SHOWN IN THIS DRAWING ARE INDICATIVE. THIS DRAWING SHALL BE READ IN CONJUNCTION WITH CROSS SECTION DRAWINGS.
 - CHAINAGES SHOWN IN THIS DRAWING REFERRED TO THE CENTRAL AXIS BETWEEN DECKS (ALIGNMENT AXIS)
 - DRAINAGE STRATEGY: ACCORDING TO THE OEMP AND TECHNICAL REQUIREMENTS, WATER WILL BE COLLECTED IN THE LOWER SIDE OF THE DECK BY MEANS OF BRIDGE DECK UNITS AND DRIVEN TO THE A-01N AND A-01S ABUTMENTS WHERE WILL BE DISCHARGED TO THE GENERAL DRAINAGE SYSTEM.
 - THE ATTACHMENT OF THE VISUAL SCREEN TO THE DECK SHALL BE THROUGH DEDICATED POSTS INDEPENDENT OF THE VEHICULAR PARAPET. POSTS OF VEHICULAR PARAPET AND VISUAL SCREEN KEEP ALIGNED PARALLEL TO THE EDGE OF THE DECK AND INSTALLED ALTERNATIVELY.
 - FOR DETAILS SEE MATERIALS PALETTE IN DRAWING HE551506-BGR-SGN-Z1BRT00Z-DR-S-0004

Rev	Rev. Date	Purpose of revision	Drawn	Checked	Rev'd	Appr'd
P02	08/02/21	FOR QUALITY SUBMISSION - 09 FEB 2021	MP	JC	JC	AF
P03	22/03/21	FOR QUALITY SUBMISSION - 23 MAR 2021	MP	MP	MP	PB

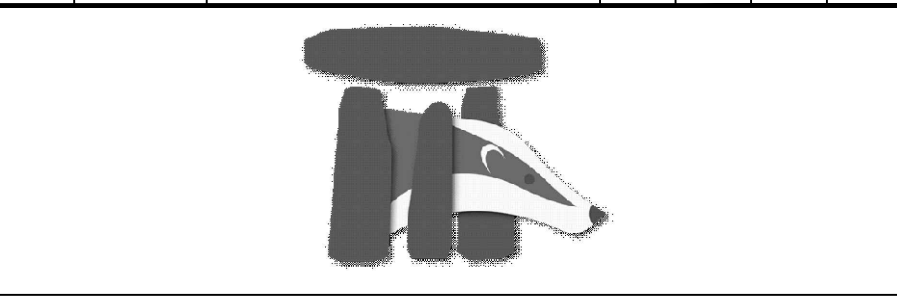

Client
highways
england

Project
A303
Amesbury to Berwick Down

Drawing title
RIVER TILL VIADUCT
DECK CROSS SECTION
TWIN STEEL GIRDERS

Drawing status
S4 - Suitable for Stage Approval

State Code	Preliminary
Project Stage	PCF Stage 5
Scale	1:50
Jacobs No.	HE551506
Client no.	HE551506

Drawing number
HE551506 - BGR - SBR -
Z1BRT00Z

Originator
BGR

Volume
SBR

DO NOT SCALE

Rev
P03

Location
Z1BRT00Z

Type
DR

Role
S

Number
-0002



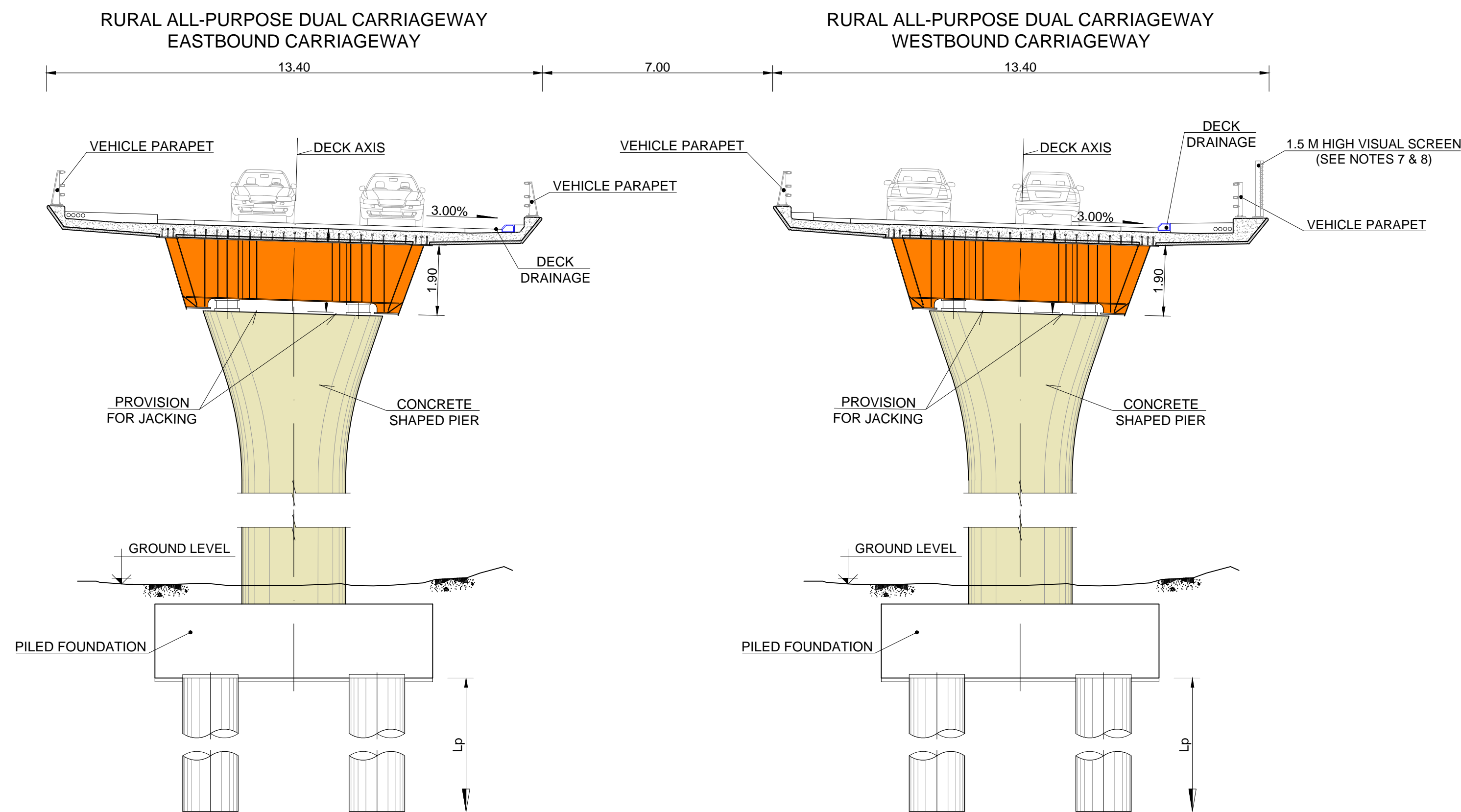

A PIER FRONT VIEW
SCALE 1:100

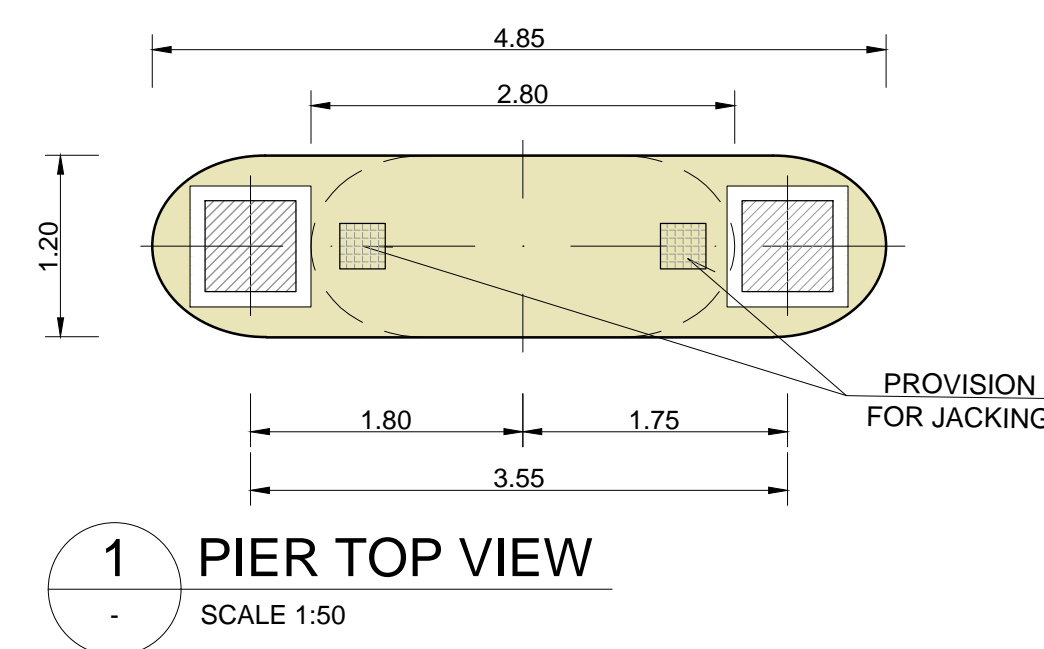

1 PIER TOP VIEW
SCALE 1:50

SUPPORT	Lp (m)
A-01, A-02 (N & S)	38.2
C-01 TO C-04 (N & S)	29.0

NOTE:
PILE DIAMETER ESTIMATED: 1.50m
PILE LENGTHS ESTIMATED ACCORDING TO AVAILABLE
GEOTECHNICAL INFORMATION. THESE DATA TO BE
CONFIRM DURING LATER DESIGN STAGES

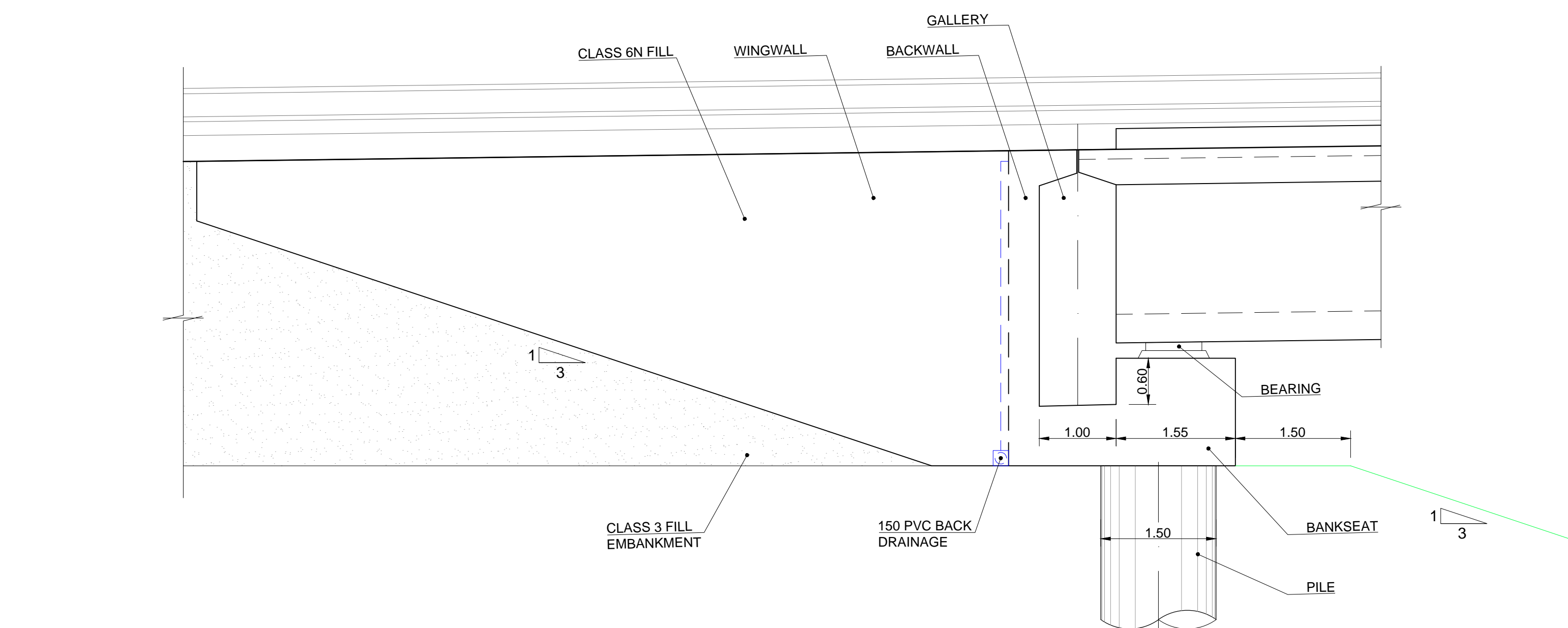

2 ABUTMENT ELEVATION VIEW
SCALE 1:50

LEGEND

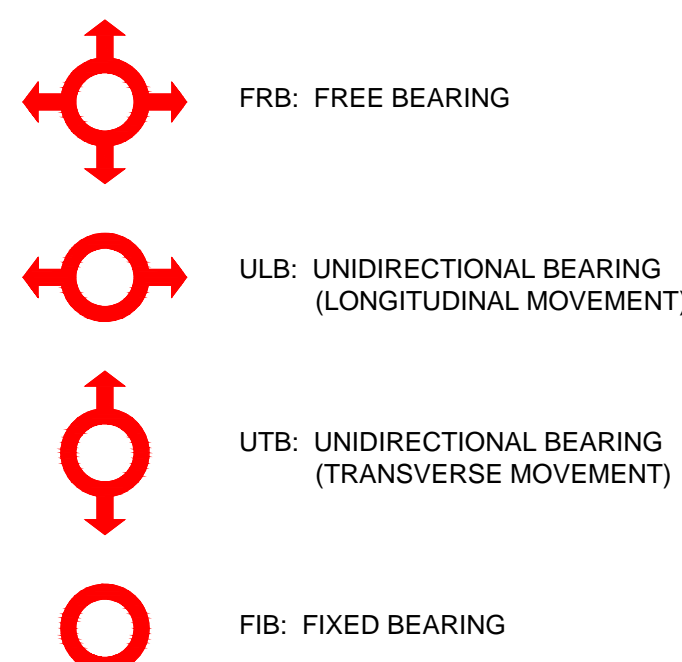

Reproduced by permission of Ordnance Survey on behalf of HMSO. ©
Crown copyright and database right 2019. All rights reserved. Ordnance
Survey Licence number 100030649.

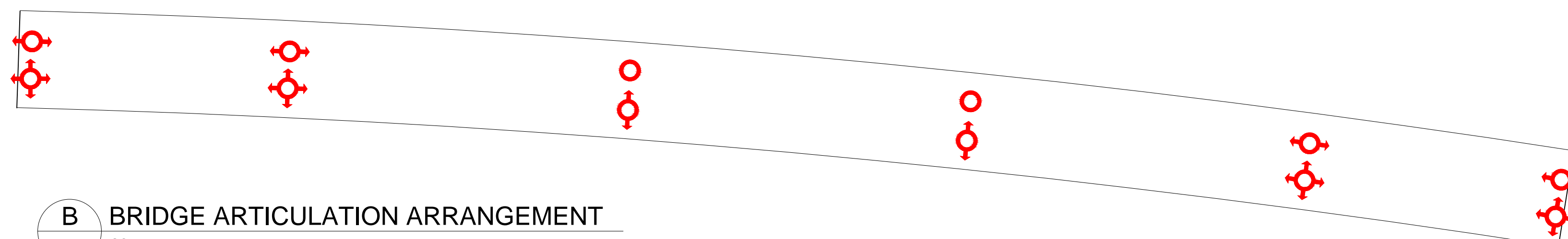

B BRIDGE ARTICULATION ARRANGEMENT
SCALE 1:500

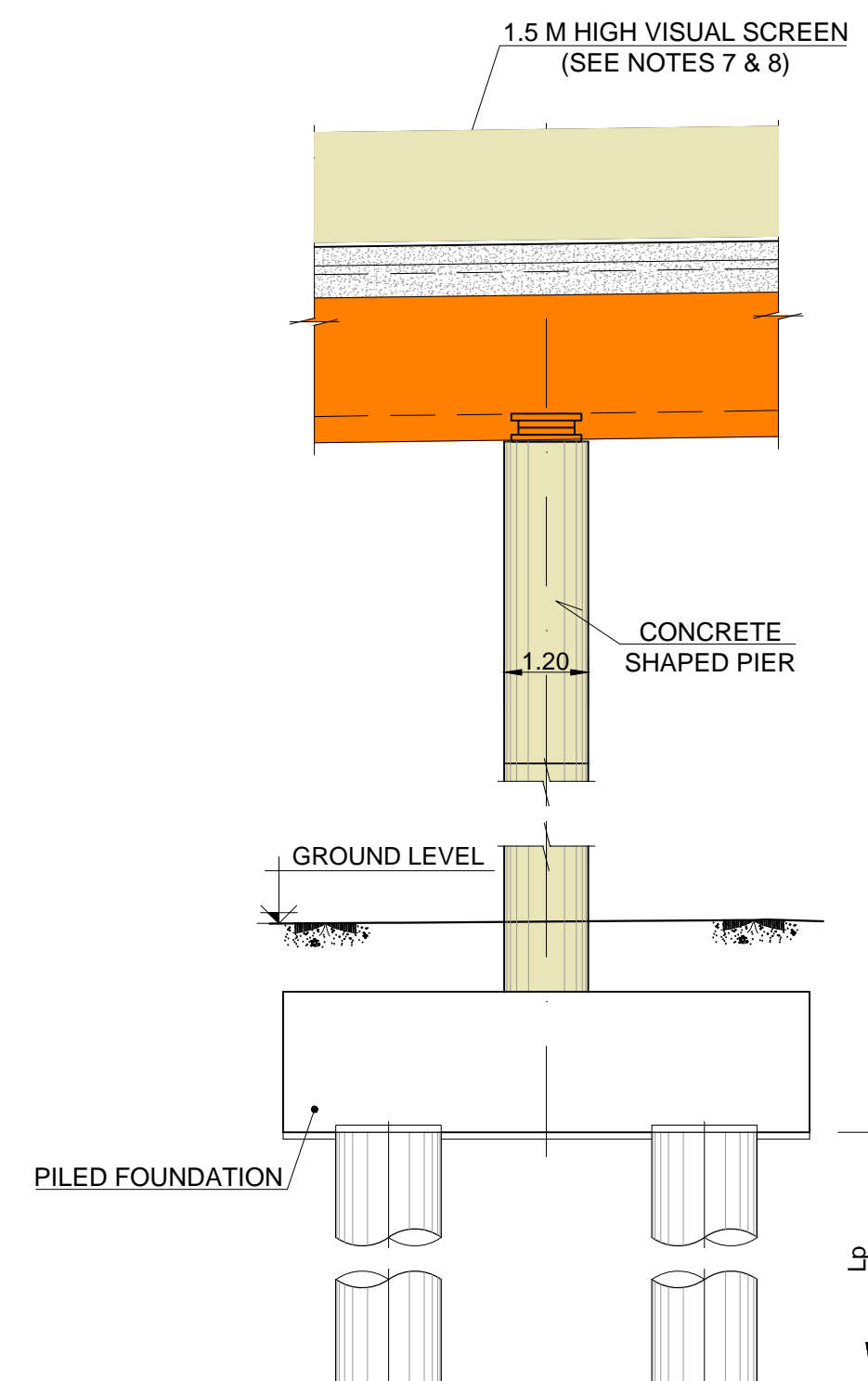

B PIER LATERAL VIEW
SCALE 1:100

NOTES:

- ALL DIMENSIONS ARE IN METRES UNLESS NOTED OTHERWISE.
- EXCEPT FOR FIGURED DIMENSIONS, THE DESIGN SHOWN IN THIS DRAWING IS INDICATIVE AND WILL BE ADJUSTED IN SUBSEQUENT STAGES OF DEVELOPMENT.
- THE DIMENSIONS OF THE FOUNDATIONS SHOWN IN THIS DRAWING ARE ILLUSTRATIVE AND SHALL BE DESIGNED AT A SUBSEQUENT SUBMISSION. THE LOCATIONS OF THE PIERS AND FOUNDATIONS WILL BE A MINIMUM 8 M OUTSIDE OF THE BOUNDARY OF THE RIVER TILL SECTION OF THE RIVER AVON SPECIAL AREA OF CONSERVATION.
- DECK AND PIER SECTIONS SHOWN IN THIS DRAWING ARE INDICATIVE. THIS DRAWING SHALL BE READ IN CONJUNCTION WITH CROSS SECTION DRAWINGS.
- CHAINAGES SHOWN IN THIS DRAWING REFERRED TO THE CENTRAL AXIS BETWEEN DECKS (ALIGNMENT AXIS)
- DRAINAGE STRATEGY: ACCORDING TO THE OEMP AND TECHNICAL REQUIREMENTS, WATER WILL BE COLLECTED IN THE LOWER SIDE OF THE DECK BY MEANS OF BRIDGE DECK UNITS AND DRIVEN TO THE A-01N AND A-01S ABUTMENTS WHERE WILL BE DISCHARGED TO THE GENERAL DRAINAGE SYSTEM.
- THE ATTACHMENT OF THE VISUAL SCREEN TO THE DECK SHALL BE THROUGH DEDICATED POSTS INDEPENDENT OF THE VEHICULAR PARAPET. POSTS OF VEHICULAR PARAPET AND VISUAL SCREEN KEEP ALIGNED PARALLEL TO THE EDGE OF THE DECK AND INSTALLED ALTERNATIVELY.
- FOR DETAILS SEE MATERIALS PALETTE IN DRAWING HE551506-BGR-SGN-Z1BRT00Z-DR-S-0004
- ABUTMENTS TO BE PROVIDED WITH GALLERIES.
- EARTHWORKS GRADIENTS ACCORDING TO VOLUME 2 PART 2 CLAUSE 9.1.10.

P02	08/02/21	FOR QUALITY SUBMISSION - 09 FEB 2021	MP	JC	JC	AF
P03	22/03/21	FOR QUALITY SUBMISSION - 23 MAR 2021	MP	MP	MP	PB
P03	15/04/21	FOR QUALITY SUBMISSION - 23 MAR 2021	MP	MP	MP	PB
P04	19/05/21	FOR QUALITY SUBMISSION - 20 APR 2021	MP	MP	MP	PB
P05	20/05/21	FOR QUALITY SUBMISSION - 20 MAY 2021	MP	MP	MP	PB
Rev	Rev. Date	Purpose of revision	Drawn	Checked	Rev'd	Appr'd

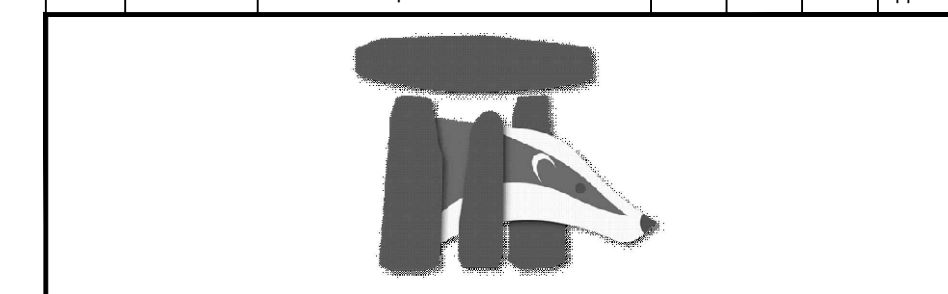

Client
**highways
england**

Project
A303
Amesbury to Berwick Down

Drawing title
**RIVER TILL VIADUCT
PIER VIEWS**

Drawing status
S4 - SUITABLE FOR STAGED APPROVAL

State Code	Preliminary
Project Stage	PCF Stage 5
Scale	AS SHOWN
Jacobs No.	HE551506
Client no.	HE551506
Drawing number	PN
Originator	BGR
Volume	SBR
Location	Z1BRT00Z
Type	DR
Role	S
Number	-0003

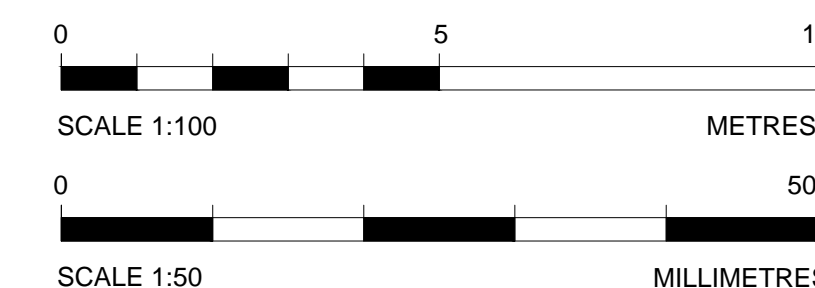

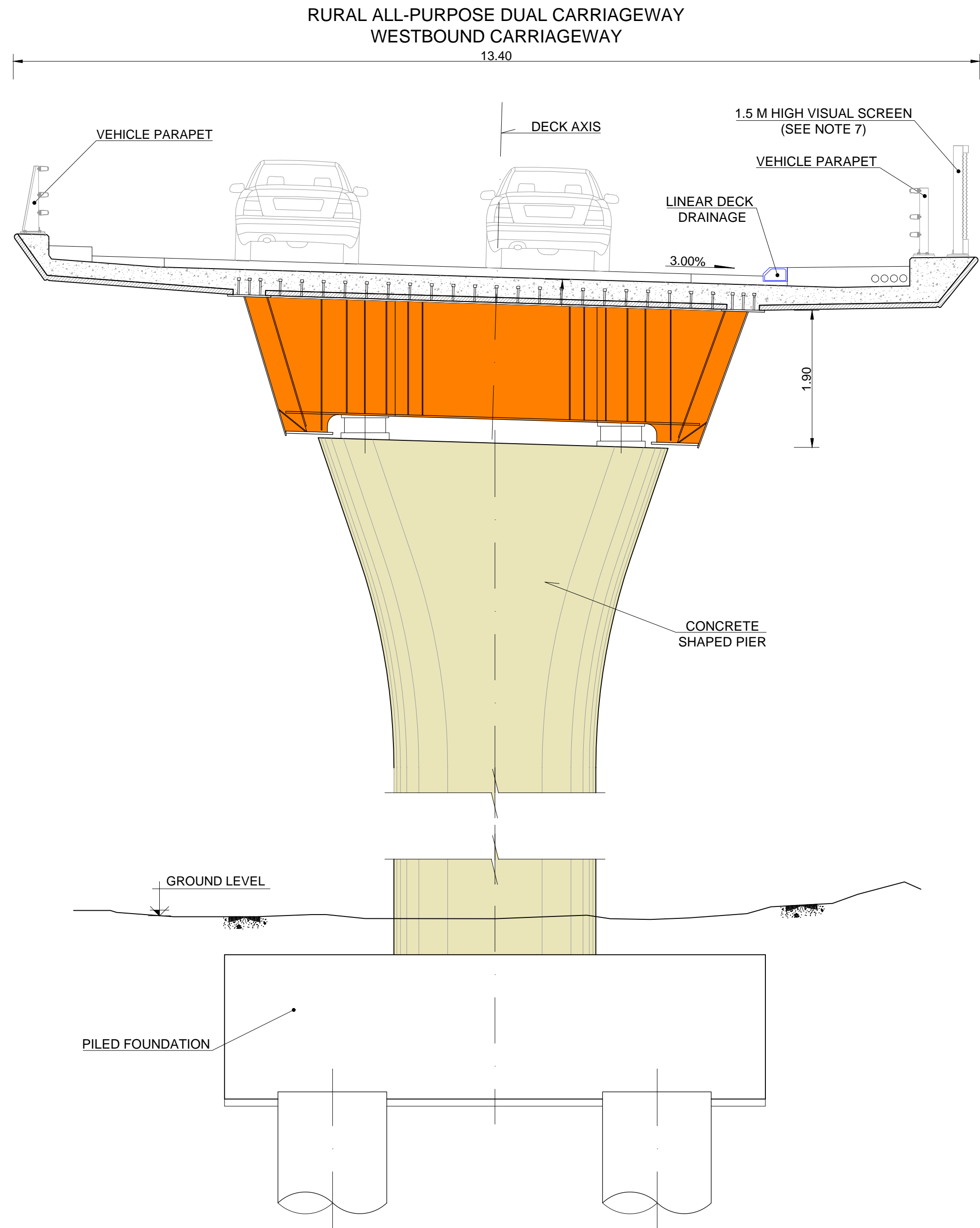

A PIER FRONT VIEW
SCALE 1:50

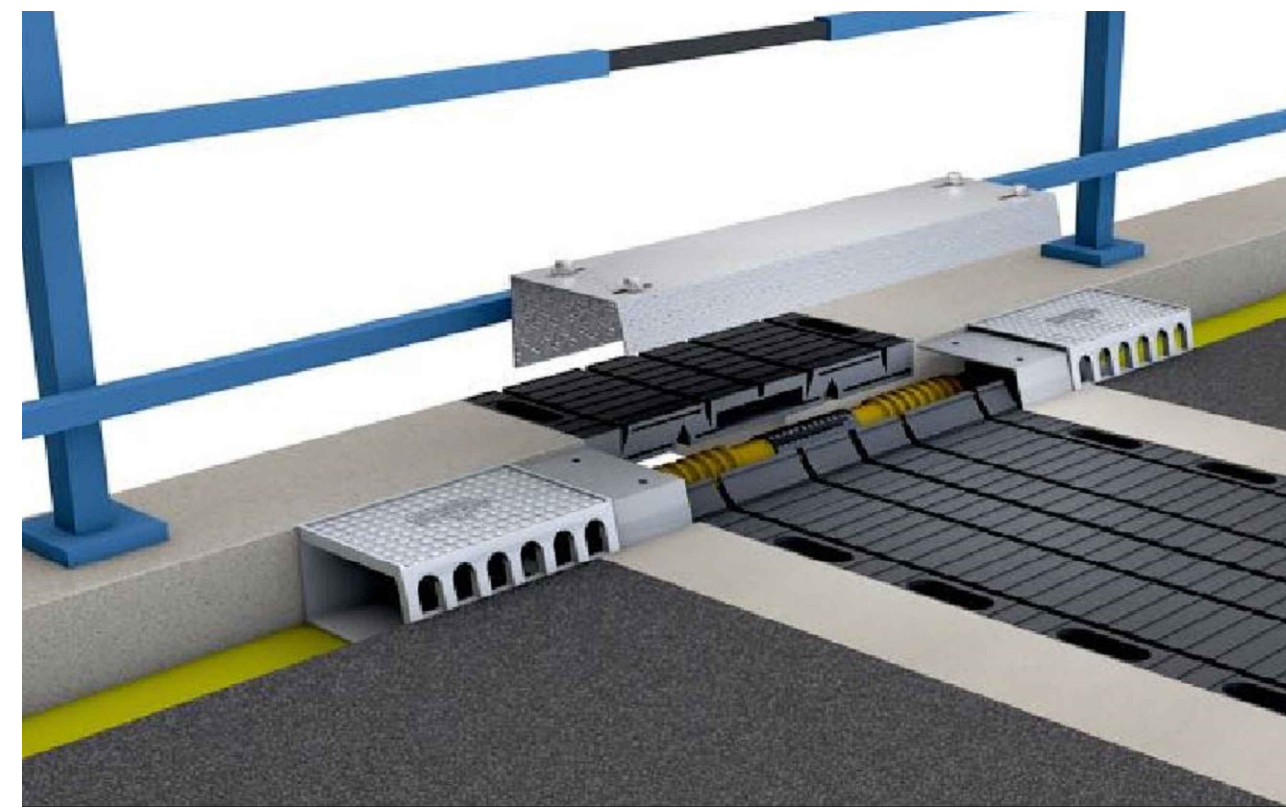

5 DRAINAGE JOINT DETAIL
NTS

Reproduced by permission of Ordnance Survey on behalf of HMSO. ©
Crown copyright and database right 2019. All rights reserved. Ordnance
Survey Licence number 100030649.

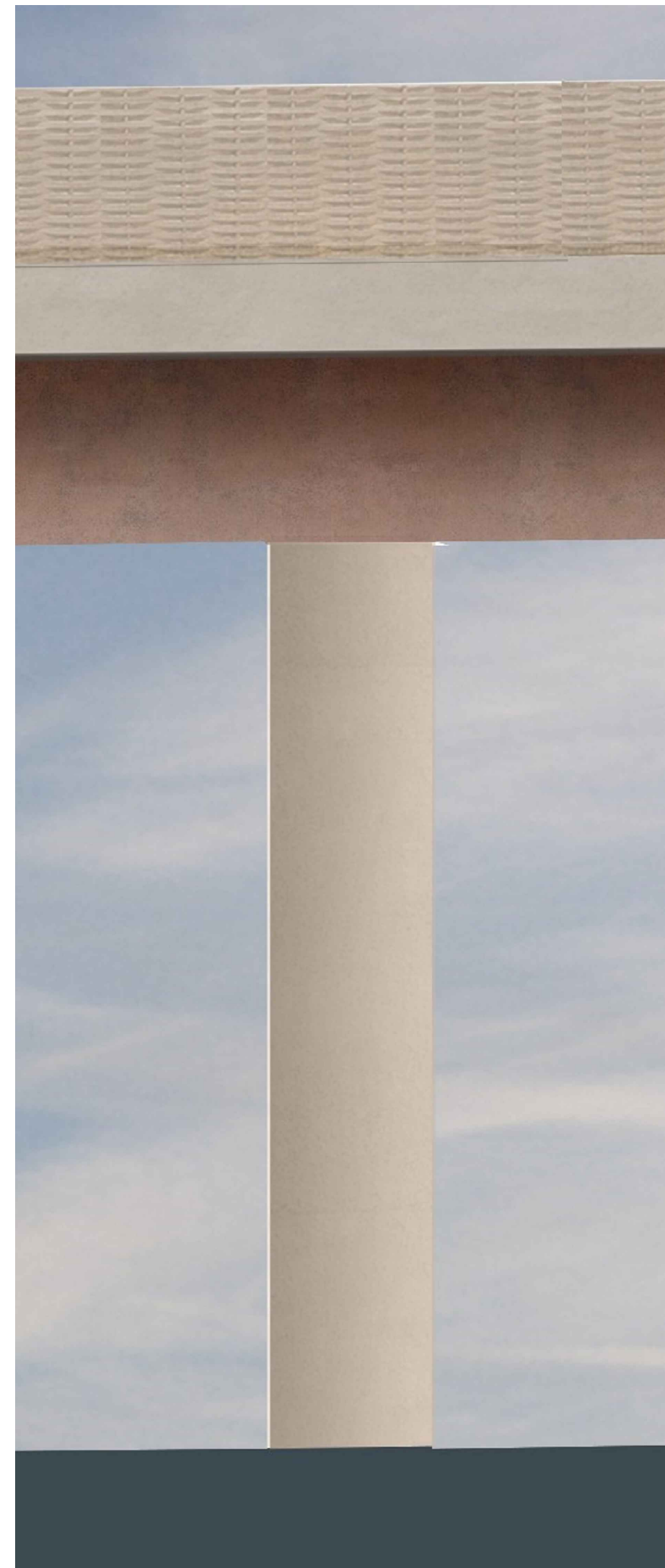

B WEATHERING STEEL & VISUAL SCREEN
(DECK & BARRIER CLADDING)
NTS



4 DRIP PLATES DETAILS
NTS



Materials Palette



Visual Screen to South elevation
Abstraction of woven pattern in GRC. Woven pattern
to both faces. This concept will be developed at the
next design stage to achieve a more naturalistic,
less consistent visual quality (TQ2A3.2)

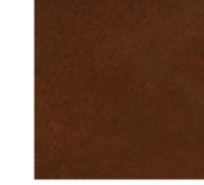

Twin Girders
Weathered steel, bespoke colour.



Edge Treatment
Concrete, smooth finish, warm colour.



Concrete Piers
Concrete, smooth finish, warm colour.

1 MATERIALS PALETTE
NTS

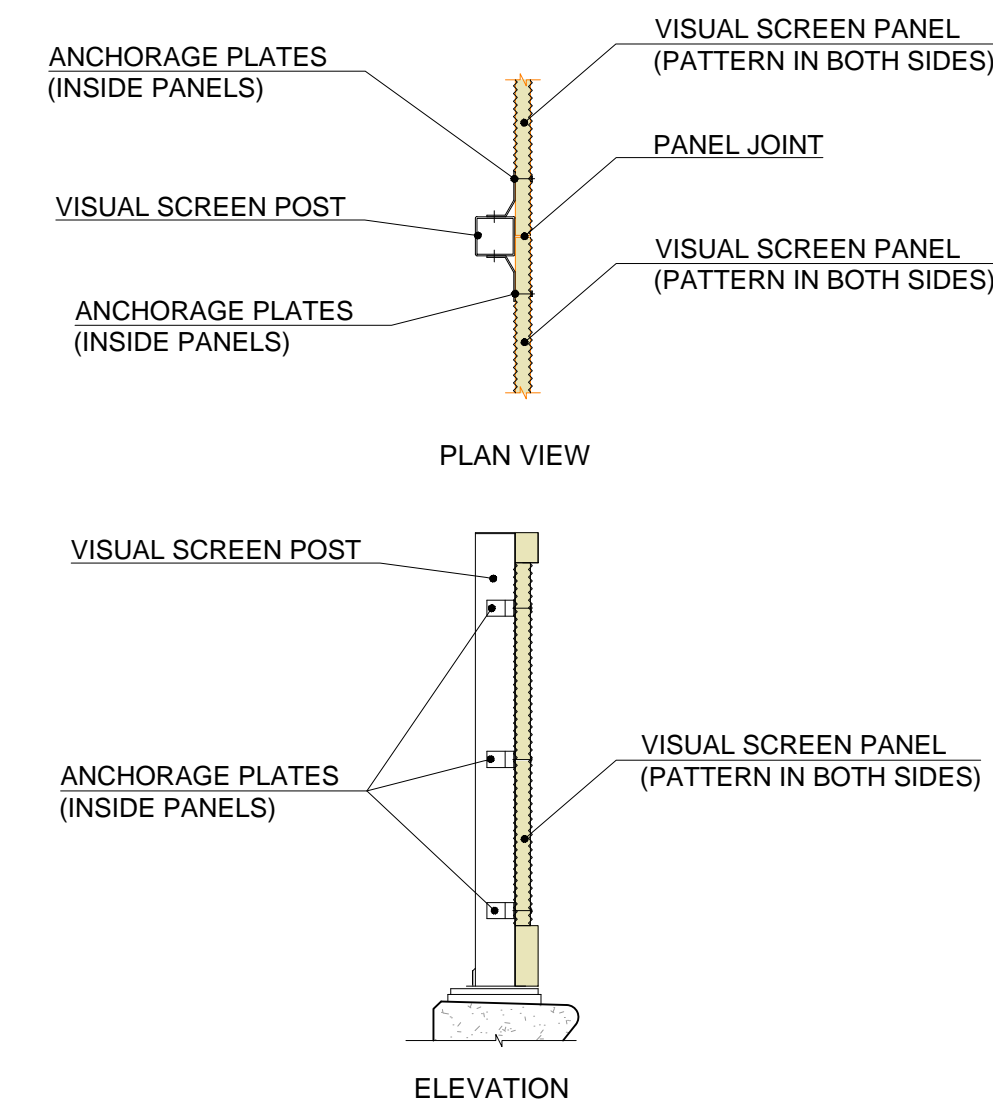

2 VISUAL SCREEN ATTACHMENT
DETAILS
SCALE 1:25

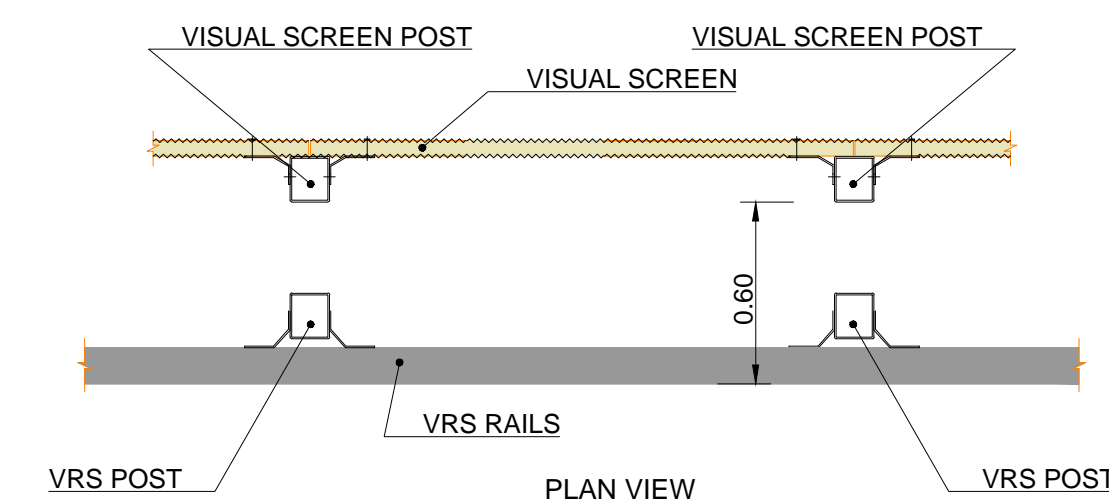

3 BARRIER ARRANGEMENT
SCALE 1:50



- NOTES:**
- ALL DIMENSIONS ARE IN METRES UNLESS NOTED OTHERWISE.
 - EXCEPT FOR FIGURED DIMENSIONS, THE DESIGN SHOWN IN THIS DRAWING IS INDICATIVE AND WILL BE ADJUSTED IN SUBSEQUENT STAGES OF DEVELOPMENT.
 - THE DIMENSIONS OF THE FOUNDATIONS SHOWN IN THIS DRAWING ARE ILLUSTRATIVE AND SHALL BE DESIGNED AT A SUBSEQUENT SUBMISSION. THE LOCATIONS OF THE PIERS AND FOUNDATIONS WILL BE A MINIMUM 8 M OUTSIDE OF THE BOUNDARY OF THE RIVER TILL SECTION OF THE RIVER AVON SPECIAL AREA OF CONSERVATION.
 - DECK AND PIER SECTIONS SHOWN IN THIS DRAWING ARE INDICATIVE. THIS DRAWING SHALL BE READ IN CONJUNCTION WITH CROSS SECTION DRAWINGS.
 - CHAINAGES SHOWN IN THIS DRAWING REFERRED TO THE CENTRAL AXIS BETWEEN DECKS (ALIGNMENT AXIS)
 - DRAINAGE STRATEGY: ACCORDING TO THE OEMP AND TECHNICAL REQUIREMENTS, WATER WILL BE COLLECTED IN THE LOWER SIDE OF THE DECK BY MEANS OF COLLECTORS AND DRIVEN TO THE A-01N AND A-01S ABUTMENTS WHERE WILL BE DISCHARGED TO THE PIPE DRAINAGE SYSTEM. COLLECTORS AND DISTANCE AMONG THEM TO BE CONFIRMED AT LATER DESIGN STAGES.
 - THE ATTACHMENT OF THE VISUAL SCREEN TO THE DECK SHALL BE THROUGH DEDICATED POSTS INDEPENDENT OF THE VEHICULAR PARAPET. POSTS OF VEHICULAR PARAPET AND VISUAL SCREEN KEEP ALIGNED PARALLEL TO THE EDGE OF THE DECK AND INSTALLED ALTERNATIVELY

P02	08/02/21	FOR QUALITY SUBMISSION - 09 FEB 2021	MP	JC	JC	AF	
P03	21/03/21	FOR QUALITY SUBMISSION - 23 MAR 2021	MP	MP	MP	PB	
Rev	Rev. Date	Purpose of revision	Drawn	Checked	Rev'd	Appr'd	

Client	highways england
Project	A303 Amesbury to Berwick Down
Drawing title	RIVER TILL VIADUCT DETAILS
Drawing status	S4 - Suitable for Stage Approval
State Code	Preliminary
Project Stage	PCF Stage 5
Scale	1:50
Jacobs No.	HE551506
Client no.	HE551506
Drawing number	HE551506 - BGR - SBR - Z1BRT00Z
Originator	BGR
Volume	SBR
Location	Z1BRT00Z
Type	-DR-
Role	S
Number	-0004