

- NOTES:
1. DENOTES MAGNETOMETER MIDAS DETECTOR.
 2. ELECTRICAL INTERFACES (EI) LOCATIONS ARE BASED ON THE PCF PRODUCT "APPLICATION FOR ROADSIDE ELECTRICITY CONNECTIONS (EXIT POINTS)". THESE LOCATIONS ARE SUBJECT TO WAYLEAVE AND DNO CAPACITY CONSTRAINTS AND MAY BE SUBJECT TO CHANGE.
 3. NRTS COMMUNICATIONS TRANSMISSION DESIGN TO BE CONDUCTED BY NRTS Co. THE POSITION AND CONFIGURATION OF THE TRANSMISSION CABINETS AT THE SCHEME EXTENTS ARE INDICATIVE.
 4. ERT WIRING TO BE INSTALLED BY NRTS Co.
 5. FTMS SITES ON APPROACH ROADS TO BE CONNECTED USING NRTS Co. 4G WIRELESS SERVICES.
 6. MS4's WILL ALSO BE USED TO SUPPORT TRAFFIC MANAGEMENT OPERATIONS.
 7. THE DUCT ROUTES SHOWN SHALL BE PROVIDED FOR THE INSTALLATION OF NRTS Co. LONGITUDINAL AND LOCAL FIBRE OPTIC CABLES TO ENABLE THE NRTS Co. ACCESS SWITCHES IN THE 600C CABINETS. WITH THE EXCEPTION OF ERT CIRCUITS, ALL LOCAL CABLES FROM THE NRTS NODES TO THE END DEVICES SHALL BE PROVIDED BY THE CONTRACTOR. AS THE SERVICE DELIVERY POINT FOR ERTS IS WITHIN THE TELEPHONE HOUSING, THESE DEVICES SHALL BE CONNECTED DIRECTLY BY NRTS Co.
 8. ITPD 1.2.2:

LOCATIONS	PROVISION FOR EA	MAINTENANCE HARDSTANDING
CH 1300 (EB & WB)	WIDENED VERGES	ADJACENT HARDSTANDING FOR ITS SITE
CH 2600 (EB & WB)	LAYBYS INCLUDES AS PART OF THE DESIGN	NO
CH 3600 (EB & WB)	WIDENED VERGES EAST OF B3083 UB	ADJACENT HARDSTANDING FOR ITS SITE
CH 4300/4400 (EB & WB)	WIDENED VERGES EAST OF RIVER TILL VIADUCT	ADJACENT HARDSTANDING FOR ITS SITE
CH 5750 (EB & WB)	WIDENED VERGES EAST OF GB3	ADJACENT HARDSTANDING FOR ITS SITE
CH 7100 (EB & WB)	RETAINED CUT WEST OF TUNNEL	PLACES OF RELATIVE SAFETY
CH 10500 (EB & WB)	RETAINED CUT EAST OF TUNNEL	PLACES OF RELATIVE SAFETY
CH 11000/10950 (EB & WB)	WIDENED VERGES WEST OF COUNTLESS SLIPS	NO

KEYPLAN

P03	24/03/21	DESIGN FOR PRICING	SB	RC	MC	MC
P04	08/04/21	FOR QUALITY SUBMISSION	SY	RC	DS	DS
P05	16/04/21	FOR QUALITY SUBMISSION	SB	RC	DS	DS
P06	17/05/21	FOR QUALITY SUBMISSION	SB	RC	DS	DS
P07	10/08/21	FOR QUALITY SUBMISSION	SB	RC	DS	DS
Rev	Rev. Date	Purpose of revision	Drawn	Checked	Rev'd	Appr'd

Client

Project

A303
Amesbury to Berwick Down

Drawing title

MOTORWAY COMMUNICATIONS
GEOGRAPHIC LAYOUTS

SHEET 10 OF 13

Drawing status

S4 - Suitable for Stage Approval

State Code

Preliminary

Project Stage

PCF Stage 5

Scale

1:2500

Jacobs No.

HE551506

Client no.

HE551506

Drawing number

HE551506 - BGR - HOS- SWGN000Z

Originator

PIN

Volume

-DR-TE-0010

DO NOT SCALE

Rev

P07

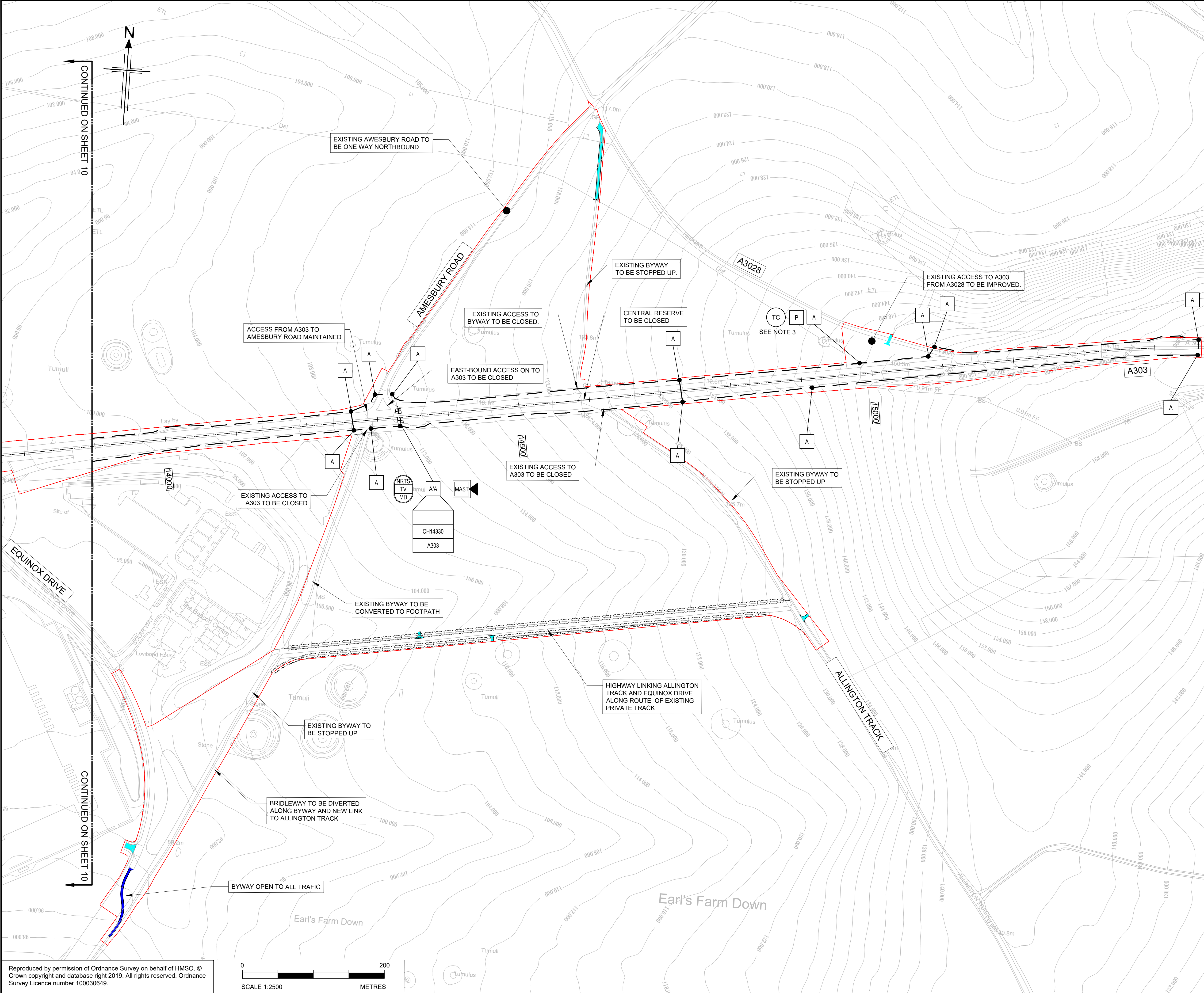

- NOTES:
1. DENOTES MAGNETOMETER MIDAS DETECTOR.
 2. ELECTRICAL INTERFACES (EI) LOCATIONS ARE BASED ON THE PCF PRODUCT "APPLICATION FOR ROADSIDE ELECTRICITY CONNECTIONS (EXIT POINTS)". THESE LOCATIONS ARE SUBJECT TO WAYLEAVE AND DNO CAPACITY CONSTRAINTS AND MAY BE SUBJECT TO CHANGE.
 3. NRTS COMMUNICATIONS TRANSMISSION DESIGN TO BE CONDUCTED BY NRTS Co. THE POSITION AND CONFIGURATION OF THE TRANSMISSION CABINETS AT THE SCHEME EXTENTS ARE INDICATIVE.
 4. ERT WIRING TO BE INSTALLED BY NRTS Co.
 5. FTMS SITES ON APPROACH ROADS TO BE CONNECTED USING NRTS Co. 4G WIRELESS SERVICES.
 6. THE DUCT ROUTES SHOWN SHALL BE PROVIDED FOR THE INSTALLATION OF NRTS Co. LONGITUDINAL AND LOCAL FIBRE OPTIC CABLES TO ENABLE THE NRTS Co. ACCESS SWITCHES IN THE 600C CABINETS. WITH THE EXCEPTION OF ERT CIRCUITS, ALL LOCAL CABLES FROM THE NRTS NODES TO THE END DEVICES SHALL BE PROVIDED BY THE CONTRACTOR. AS THE SERVICE DELIVERY POINT FOR ERTS IS WITHIN THE TELEPHONE HOUSING, THESE DEVICES SHALL BE CONNECTED DIRECTLY BY NRTS Co.
 7. ITPD 1.2.2:

LOCATIONS	PROVISION FOR EA	MAINTENANCE HARDSTANDING
CH 1300 (EB & WB)	WIDENED VERGES	ADJACENT HARDSTANDING FOR ITS SITE
CH 2600 (EB & WB)	LAYBYS INCLUDES AS PART OF THE DESIGN	NO
CH 3600 (EB & WB)	WIDENED VERGES EAST OF B3083 UB	ADJACENT HARDSTANDING FOR ITS SITE
CH 4300/4400 (EB & WB)	WIDENED VERGES EAST OF RIVER TILL VIADUCT	ADJACENT HARDSTANDING FOR ITS SITE
CH 5750 (EB & WB)	WIDENED VERGES EAST OF GB3	ADJACENT HARDSTANDING FOR ITS SITE
CH 7100 (EB & WB)	RETAINED CUT WEST OF TUNNEL	PLACES OF RELATIVE SAFETY
CH 10500 (EB & WB)	RETAINED CUT EAST OF TUNNEL	PLACES OF RELATIVE SAFETY
CH 11000/10950 (EB & WB)	WIDENED VERGES WEST OF COUNTNESS SLIPS	NO

KEYPLAN						
P02	15/02/21	FOR QUALITY SUBMISSION	SB	RC	MC	MC
P03	24/03/21	DESIGN FOR PRICING	SB	RC	MC	MC
P04	08/04/21	FOR QUALITY SUBMISSION	SY	RC	DS	DS
P04	17/05/21	FOR QUALITY SUBMISSION	SB	RC	DS	DS
P05	10/06/21	FOR QUALITY SUBMISSION	SB	RC	DS	DS
Rev	Rev. Date	Purpose of revision	Drawn	Checked	Rev'd	Appr'd

Client

Project

A303
Amesbury to Berwick Down

Drawing title

MOTORWAY COMMUNICATIONS
GEOGRAPHIC LAYOUTS

SHEET 11 OF 13

Drawing status

S4 - Suitable for Stage Approval

State Code

Preliminary

Project Stage

PCF Stage 5

Scale

1:2500

Jacobs No.

HE551506

Client no.

HE551506

Drawing number

HE551506 - BGR - HOS-

Originator

SWGN000Z

Volume

-DR-TE-0011

DO NOT SCALE

Rev

P05

Location

SWGN000Z

Type

DR

Role

TE

Number

0011

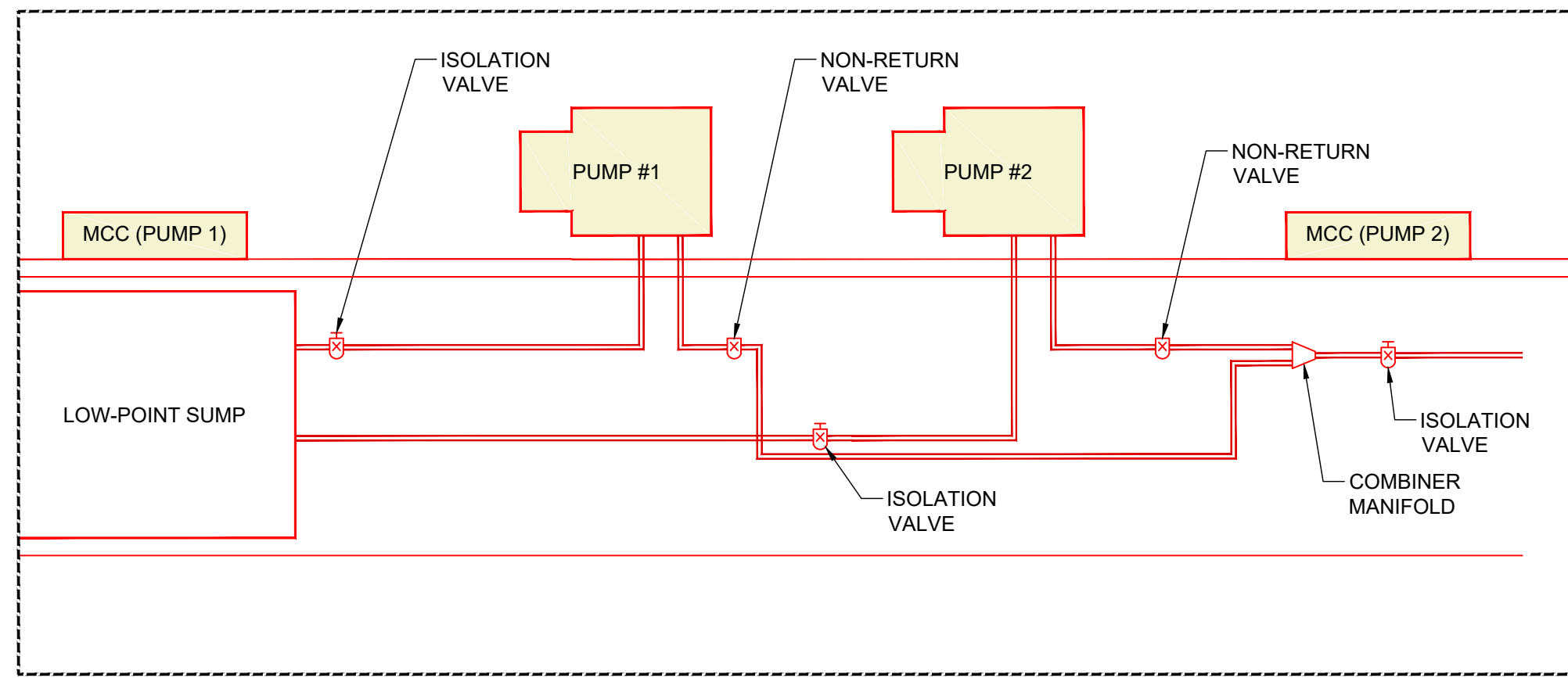

PLAN AT LOW-POINT SUMP AND PUMPS
SCALE N.T.S.

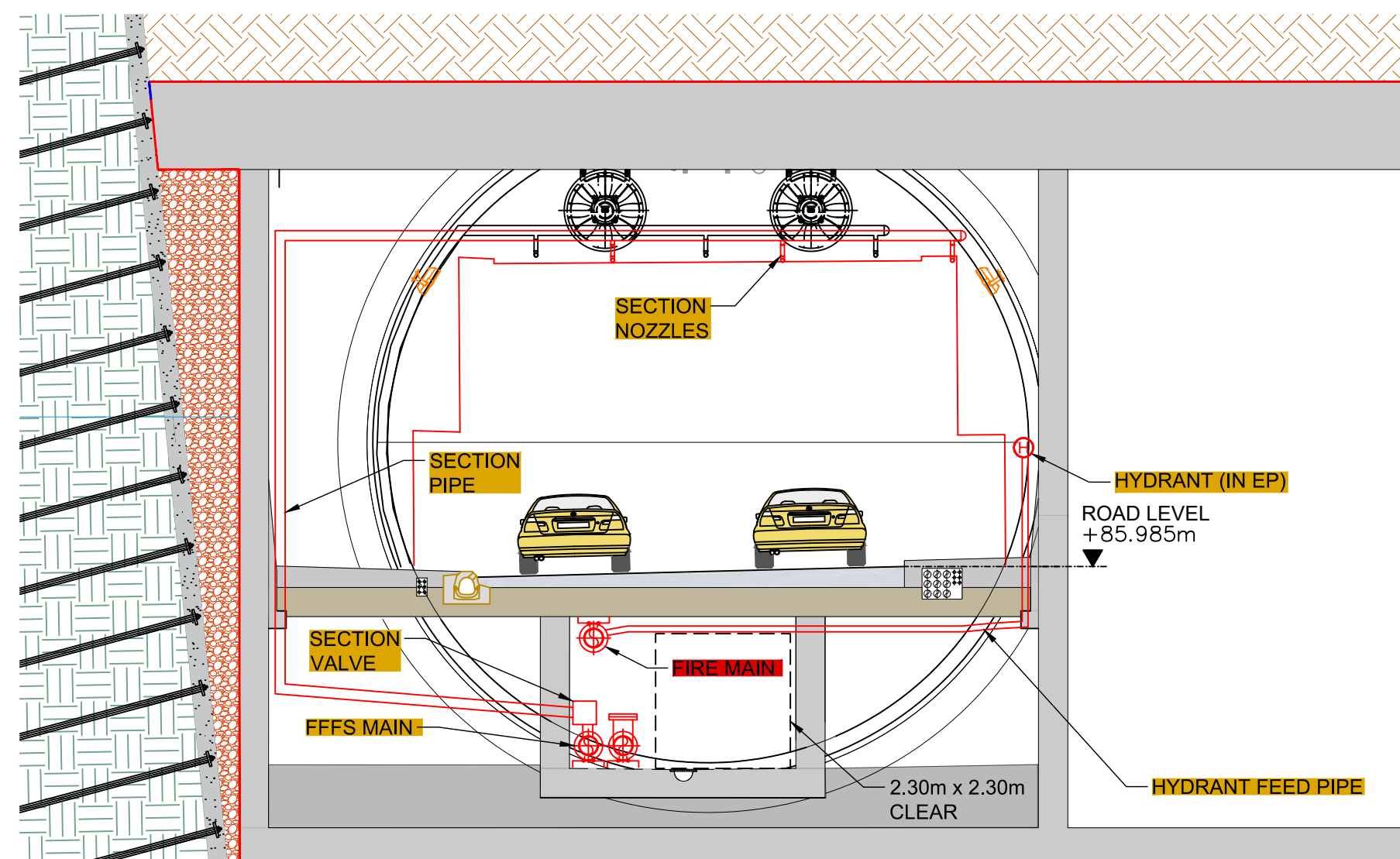

TYPICAL CROSS SECTION THROUGH
THE CUT AND COVER
SCALE 1:100

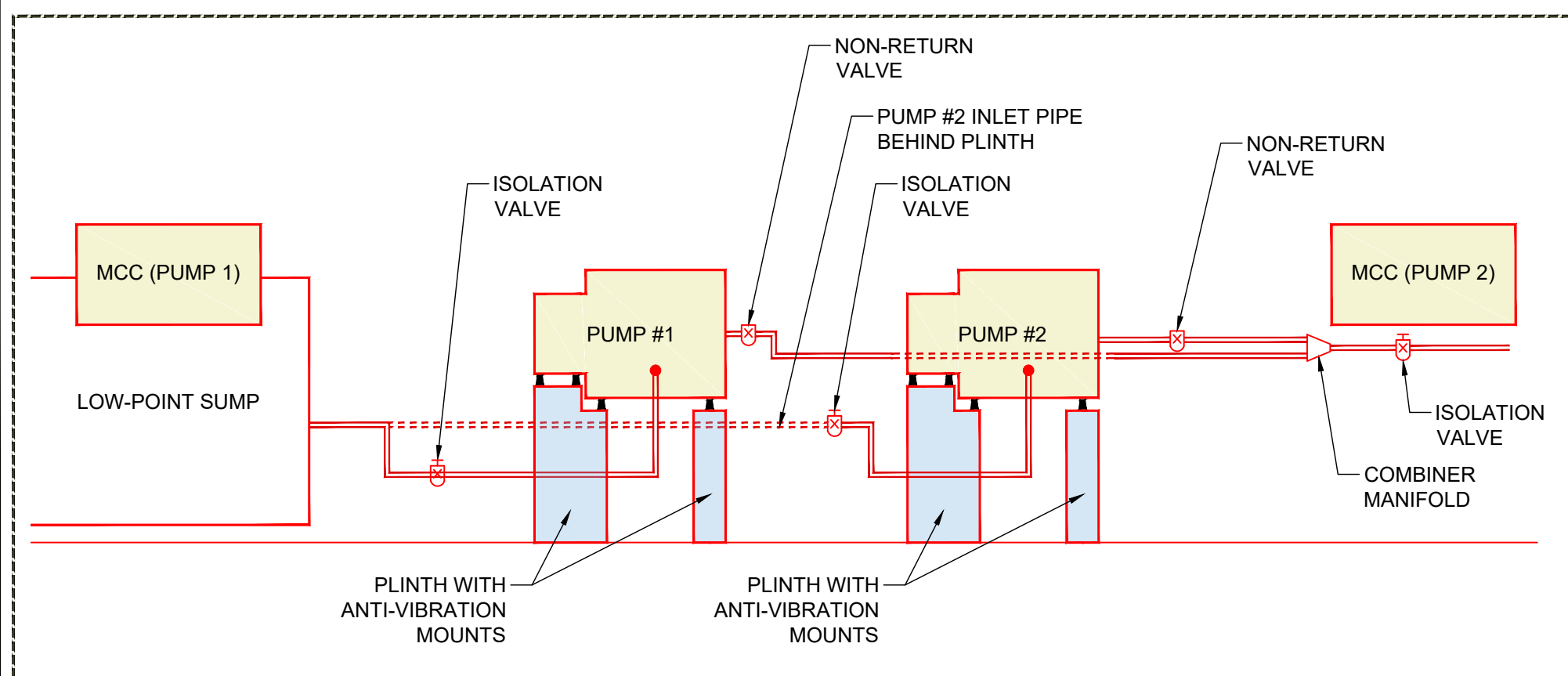
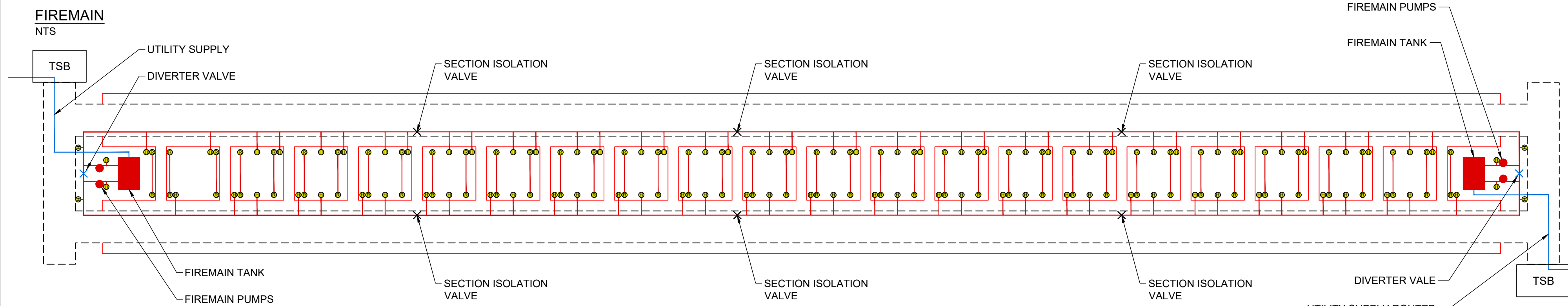
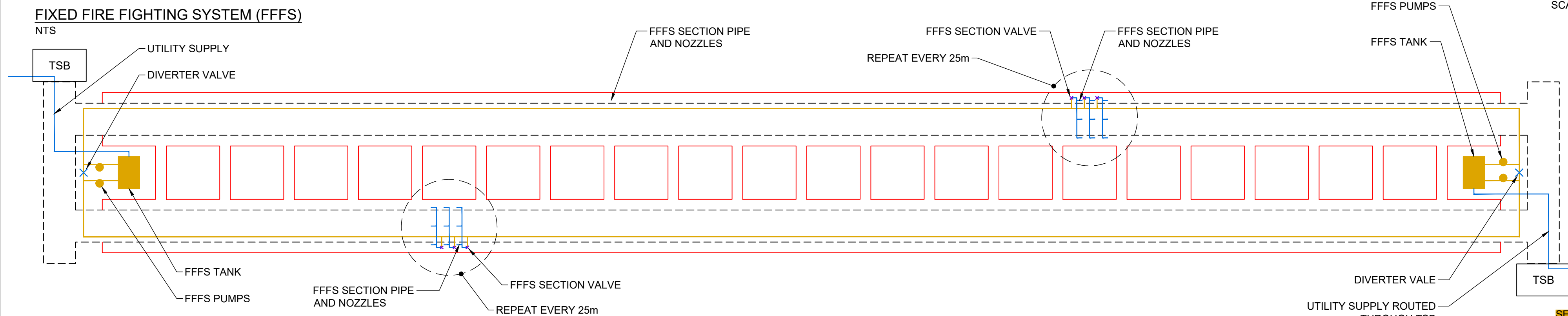

ELEVATION AT LOW-POINT SUMP AND PUMPS
SCALE N.T.S.

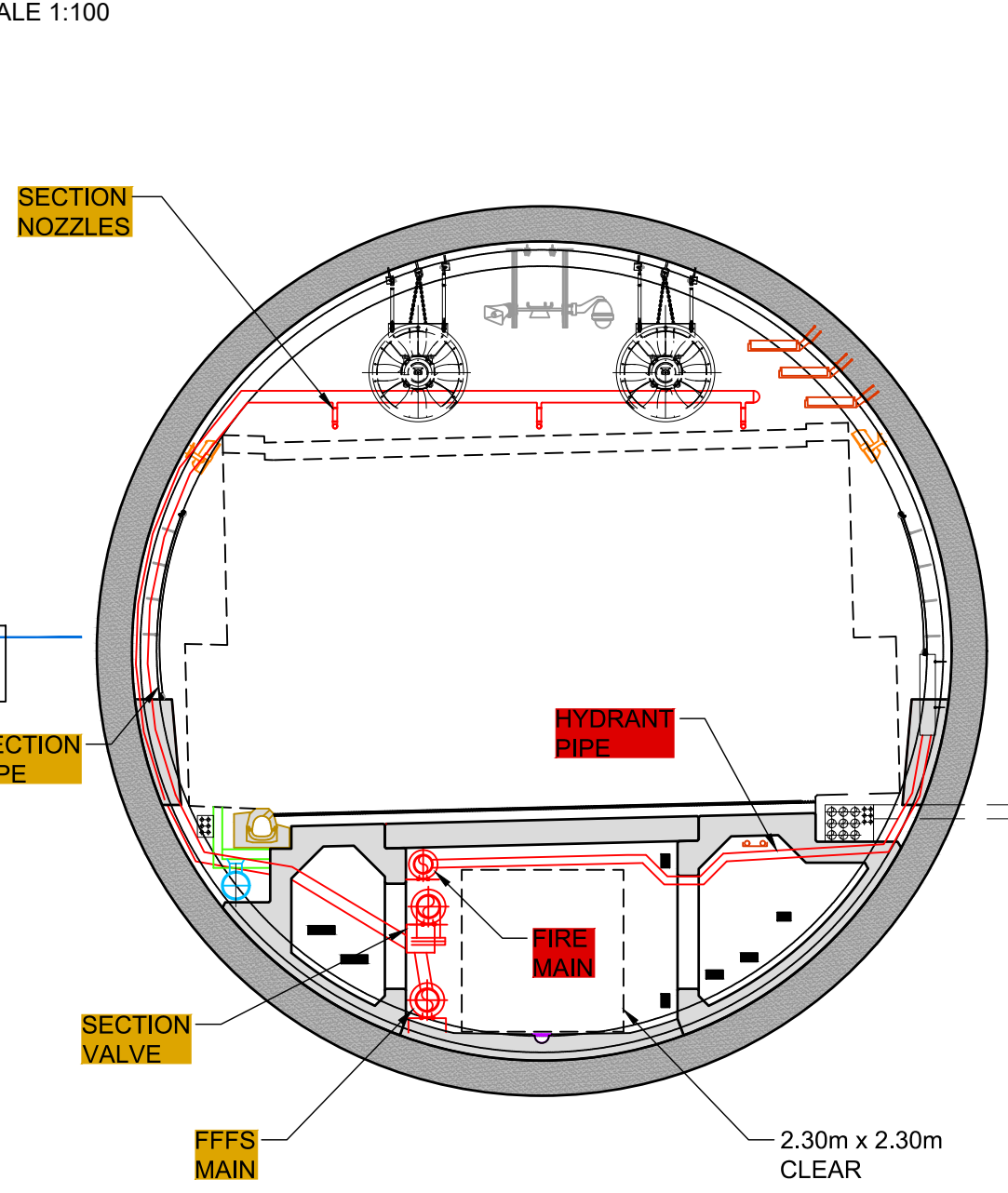
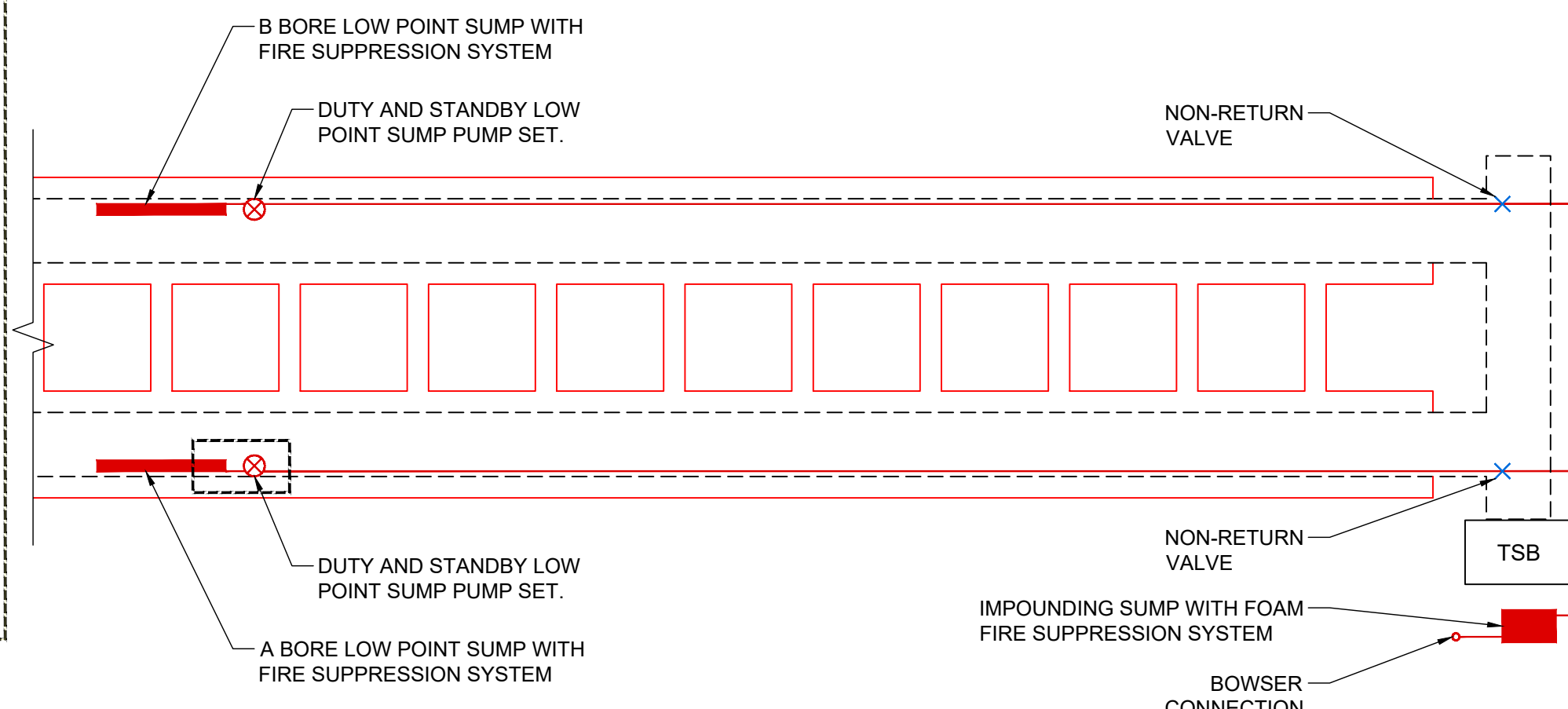

EASTBOUND TUBE SECTION CROSS TUNNEL
SCALE 1:100

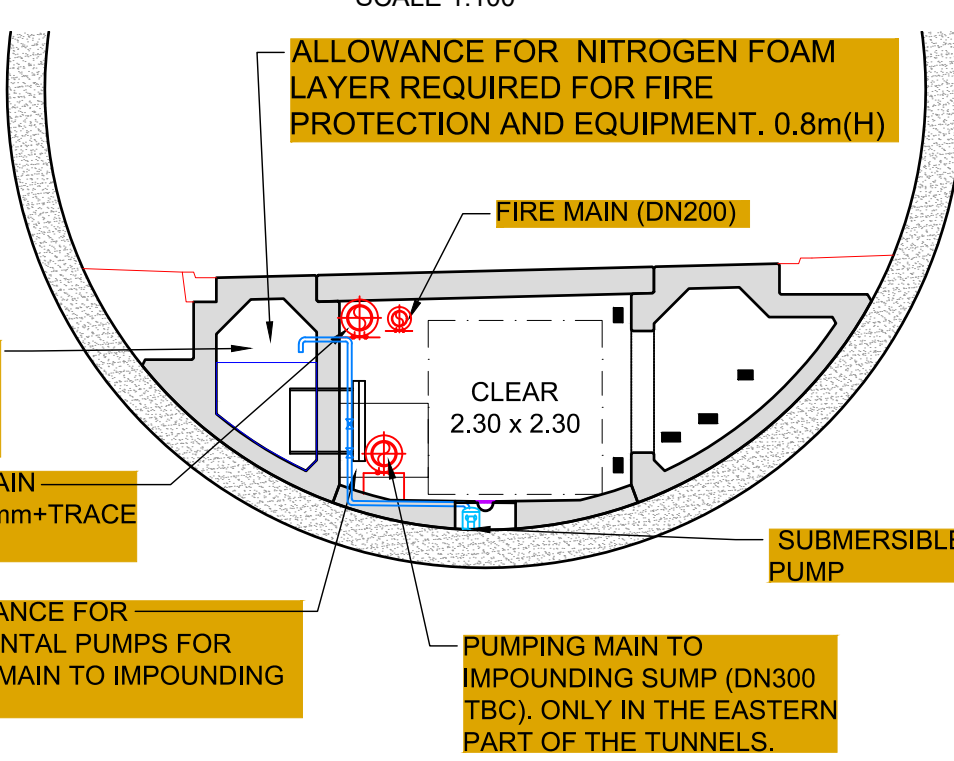

EASTBOUND TUBE SECTION CROSS TUNNEL
AT LOW POINT PUMP
SCALE 1:100

LEGEND

- DRY RISER WITH INLET ADJACENT TO HYDRANT OUTLET
- HYDRANT OUTLET
- FIRE MAIN SUPPLY
- UTILITY SUPPLY
- DRAINAGE SUPPLY

KEYPLAN

P02	25/02/21	FOR QUALITY SUBMISSION	SB	RC	DS	DS
P03	08/04/21	FOR QUALITY SUBMISSION	SY	RC	DS	DS
P04	17/05/21	FOR QUALITY SUBMISSION	SB	RC	DS	DS
P05	10/06/21	FOR QUALITY SUBMISSION	SB	RC	DS	DS
P06	18/06/21	FOR QUALITY SUBMISSION	SB	RC	DS	DS
Rev	Rev. Date	Purpose of revision	Drawn	Checked	Rev'd	Appr'd



Client
Project
A303
Amesbury to Berwick Down

Drawing title
**TECHNOLOGY SCHEMATIC
PUBLIC HEALTH AND
FIREFIGHTING**

Drawing status
S4 - SUITABLE FOR STAGED APPROVAL

State Code	Preliminary	DO NOT SCALE
Project Stage	PCF Stage 5	
Scale	AS SHOWN	
Jacobs No.	HE551506	Rev P06
Client no.	HE551506	

Drawing number
HE551506 - BGR - HOS-
SWGN000Z
Location
Type Role Number
-DR-TE-0101

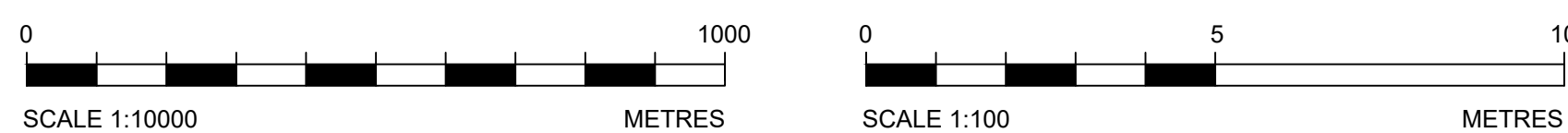

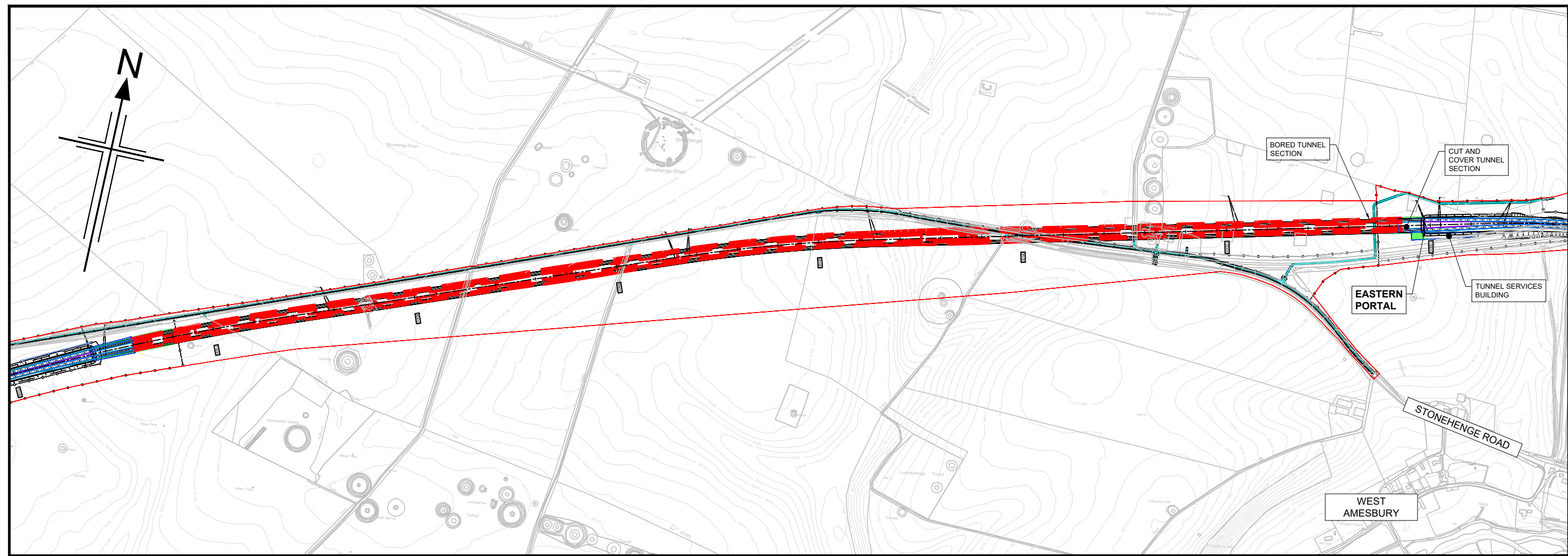

PLAN
SCALE 1:10000

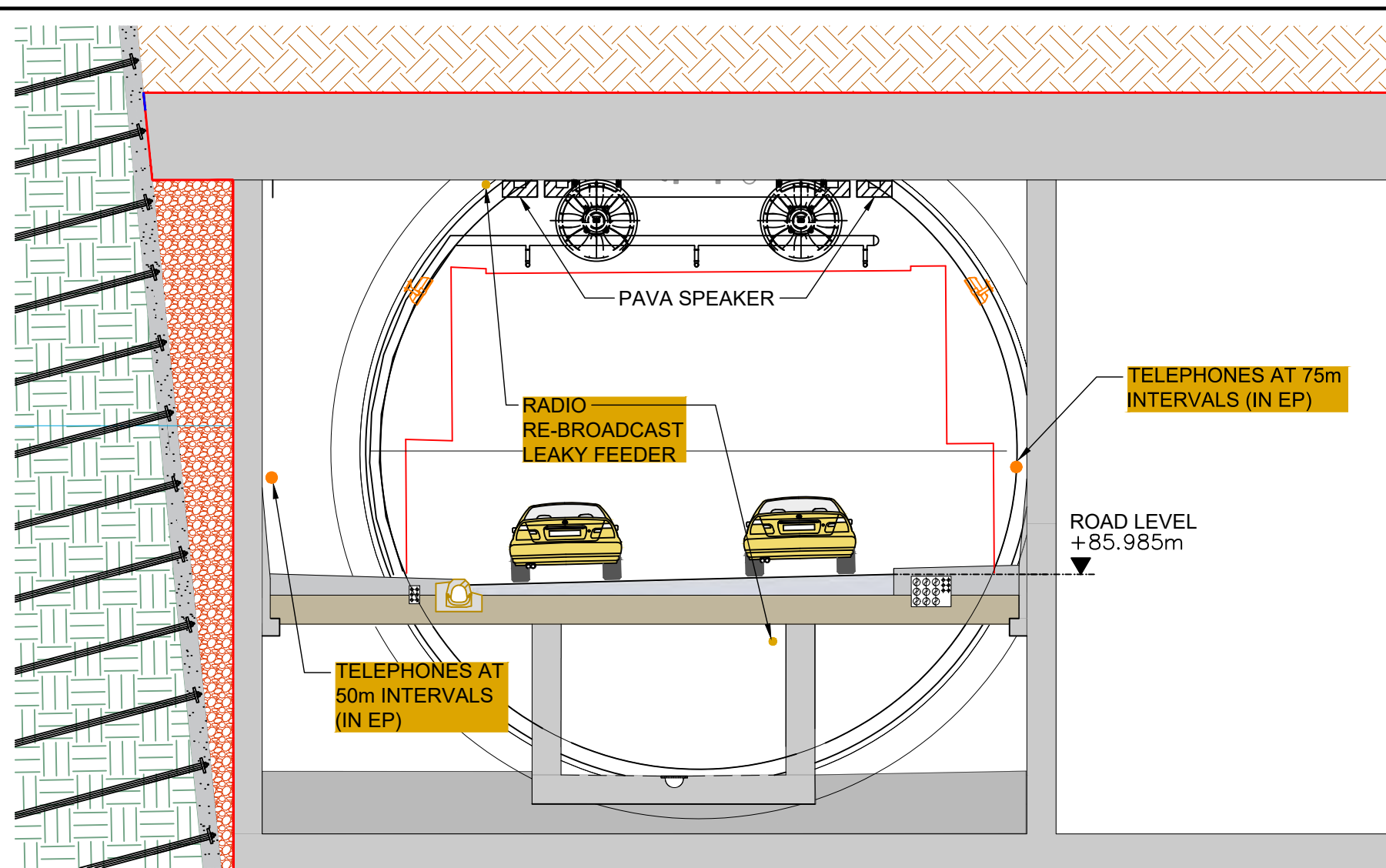

TYPICAL CROSS SECTION THROUGH
THE CUT AND COVER
SCALE 1:100

PUBLIC ADDRESS AND VOICE ALARM SYSTEM (PAVA)
NTS

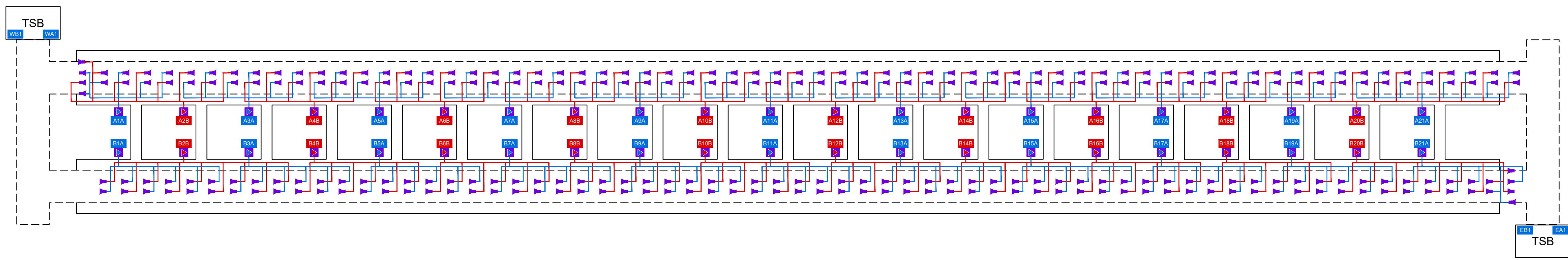

COMMUNICATIONS
(TQ2A1.3, TQ2A2.1, TQ2A3.1)
NTS

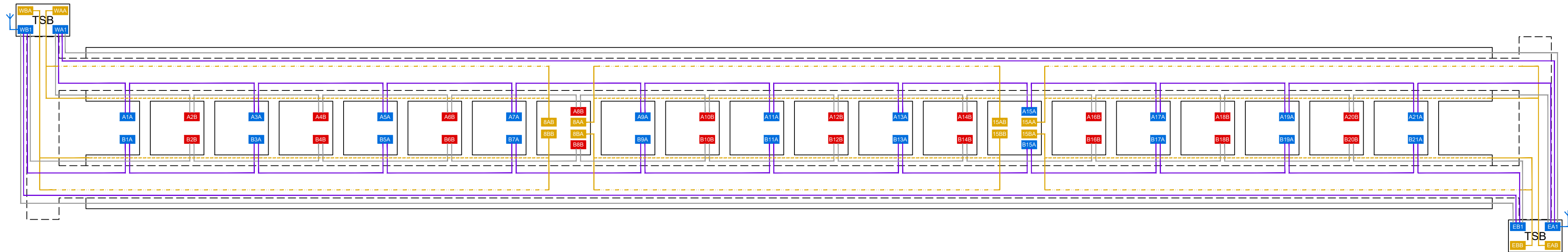

EMERGENCY TELEPHONES
NTS

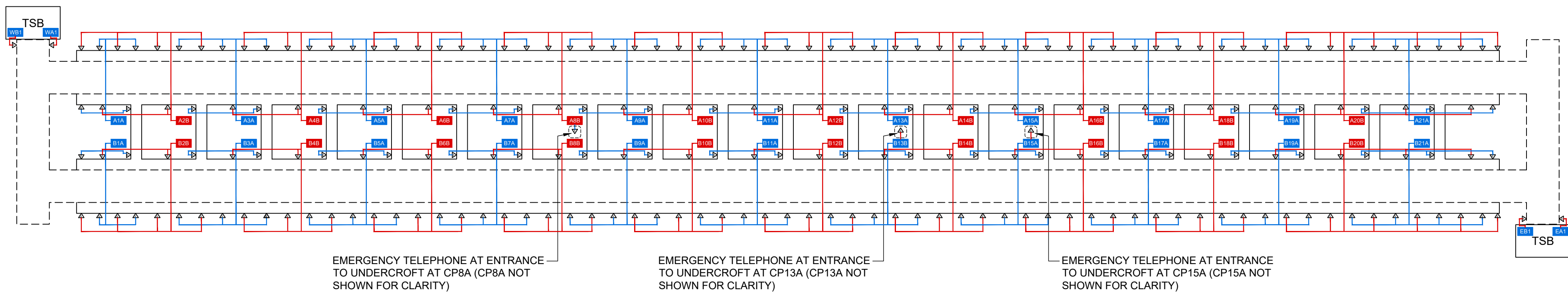

EMERGENCY TELEPHONE AT ENTRANCE
TO UNDERCROFT AT CP8A (CP8A NOT
SHOWN FOR CLARITY)

EMERGENCY TELEPHONE AT ENTRANCE
TO UNDERCROFT AT CP13A (CP13A NOT
SHOWN FOR CLARITY)

EMERGENCY TELEPHONE AT ENTRANCE
TO UNDERCROFT AT CP15A (CP15A NOT
SHOWN FOR CLARITY)

EASTBOUND TUBE SECTION CROSS TUNNEL
SCALE 1:100

LEGEND

- A BORE NRTS SERVICE DELIVERY POINT IN CROSS PASSAGE 1 ON COMMUNICATIONS RING A
- A BORE NRTS SERVICE DELIVERY POINT IN CROSS PASSAGE 2 ON COMMUNICATIONS RING B
- MULTI CHANNEL PAVA AMPLIFIER ON COMMUNICATIONS RING A
- MULTI CHANNEL PAVA AMPLIFIER ON COMMUNICATIONS RING B
- SPEAKERS
- RADIO REBROADCAST EQUIPMENT - CROSS PASSAGE 15, BORE A CIRCUIT B AND WEST TSB BORE B CIRCUIT B RESPECTIVELY
- RADIO REBROADCAST EQUIPMENT - NON RADIATING CABLE
- RADIO REBROADCAST EQUIPMENT - LEAKY FEEDER CABLE IN TUNNEL BORE (OVER VERGES)
- RADIO REBROADCAST EQUIPMENT - LEAKY FEEDER CABLE IN UNDERCROFT
- NRTS FIBRE OPTIC COMMUNICATIONS CABLE - RING A
- NRTS FIBRE OPTIC COMMUNICATIONS CABLE - RING B
- PROJECT FIELD CABLING CONNECTED TO NRTS RING A
- PROJECT FIELD CABLING CONNECTED TO NRTS RING B
- EMERGENCY TELEPHONE CONNECTED TO THE A RING
- EMERGENCY TELEPHONE CONNECTED TO THE B RING
- EXTERNAL ANTENNA ON TSB CARRYING TUNNEL INFORMATION RADIO BROADCASTS (ALSO CARRIED ON DAB RADIO REBROADCAST CABLES IN TUNNEL)

KEYPLAN

P03	08/04/21	FOR QUALITY SUBMISSION	SY	RC	DS	DS
P04	16/04/21	FOR QUALITY SUBMISSION	SB	RC	DS	DS
P05	17/05/21	FOR QUALITY SUBMISSION	SB	RC	DS	DS
P06	10/06/21	FOR QUALITY SUBMISSION	SB	RC	DS	DS
P07	18/06/21	FOR QUALITY SUBMISSION	SB	RC	DS	DS
Rev	Rev. Date	Purpose of revision	Drawn	Checked	Rev'd	Appr'd



Client

highways
england

Project

A303
Amesbury to Berwick Down

Drawing title

TECHNOLOGY SCHEMATIC
PUBLIC HEALTH AND
EMERGENCY COMMUNICATIONS

Drawing status

S4 - SUITABLE FOR STAGED APPROVAL

State Code	Preliminary	DO NOT SCALE
Project Stage	PCF Stage 5	
Scale	AS SHOWN	
Jacobs No.	HE551506	Rev P07
Client no.	HE551506	

Drawing number	PNJ	Originator	Volume
HE551506 -	BGR	-HOS-	
SWGN000Z		-DR-TE-0102	

