

PROPOSED WEST WING GLAZING PLAN 1  
- LEVEL 00

SCALE: 1 : 100

SCALE: 1 : 100

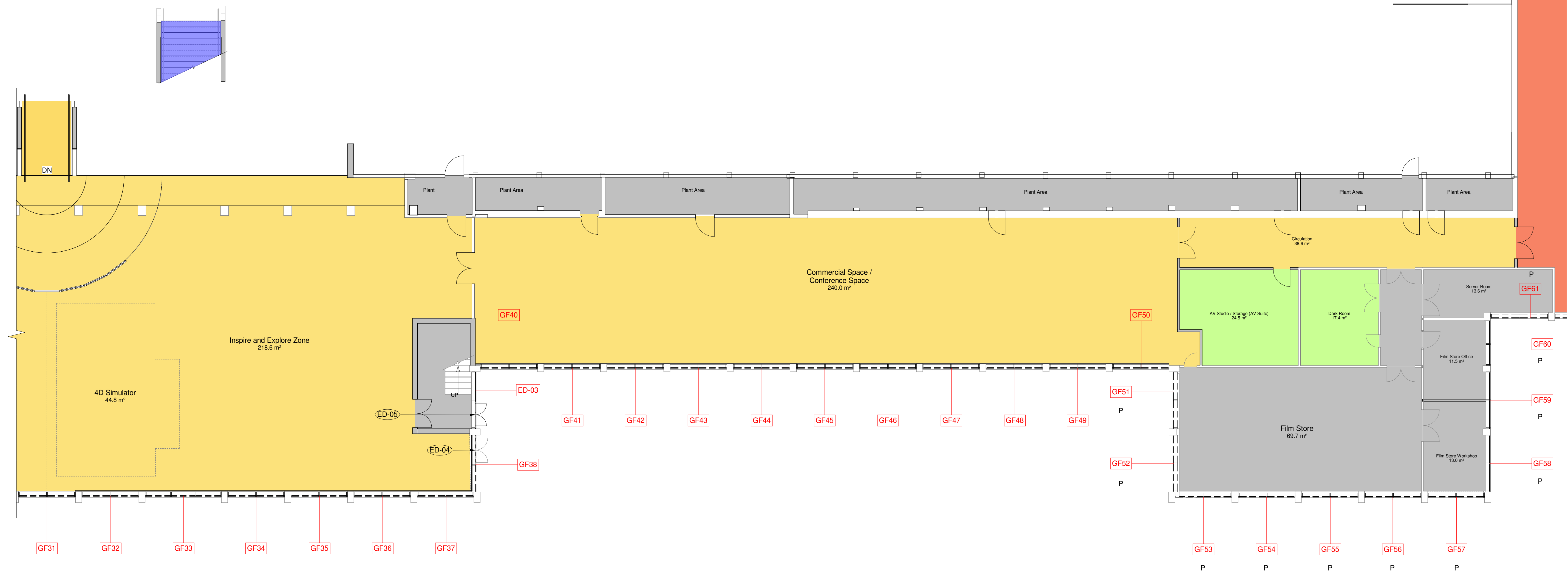

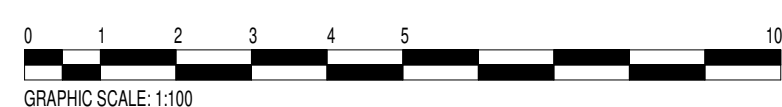



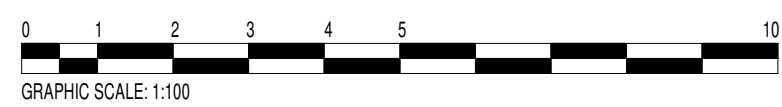







PROPOSED WEST WING GLAZING PLAN 2  
- LEVEL 00



SCALE: 1 : 100



**KEY TO USER AREAS AS PROPOSED WITH LATEST MASTERPLAN PROPOSALS**  
**(REQUIRED WORKS YET TO BE UNDERTAKEN)**

- |   |  |
|---|--|
|  | Areas remaining as existing / not in scope of works  |
|  | Conference and Multipurpose Space / Exhibition Space and Boardroom (Customer Hub 1 First Floor)                            |
|  | Dark Room and AV Studio / Storage (AV Suite)   |
|  | Dual Function Space (Access and Learning / Commercial)   |
|  | Historic Colonnade and Glazing   |
|  | Immersive Learning Zone (Access and Learning)  |
|  | Inspire Zone - VR and Experiences, Inspire & Explore Zone - Pay to Play and Commercial Space (Customer Hub 2 Ground Floor) |
|  | Inspiring Work Spaces (Office and Meeting Rooms - First and Second Floor)  |
|  | Main Entrance Lobby / Exhibition Space (Customer Hub 1 Ground Floor)   |
|  | Research Centre (Archive and Library), Art Collection and Photographic Collection  |
|  | Research Zone (Formal + Informal) and Multipurpose Space (Customer Hub 2 First Floor)                                      |
|  | Staff Rest Area (First Floor)  |
|  | Toilet Block 2 (Visitor and ILZ facilities) and Central Wing hangar storage  |

**PROPOSED GLAZING KEY**

- |     |   |  |
|-----|---|--|
| GF1 | <p>Proposed curtain walling bays with high security requirement.<br/>Recommended glazing requirements – 10mm Toughened glass outer pane and 11.5mm Laminated and 11mm clear glass inner pane.<br/>Glazing and system design values for U value/G value solar transmittance and light reflectance values are to be determined by glazing sub-contractor/M-E designer</p> |  <p>Proposed glazing (shown on elevations)</p>              |
| GF2 | <p>Proposed curtain walling bays with lower security requirement.<br/>Recommended glazing requirements – 8mm Toughened glass outer pane and 8.5mm Laminated and 8mm clear glass inner pane.<br/>Glazing and system design values for U value/G value solar transmittance and light reflectance values are to be determined by glazing sub-contractor/M-E designer</p>   |  <p>Proposed look-alike opaque glazing insulated panels</p> |

NOTES:

- All proposed glazing to have internal vertical louvre blinds
- Redecorate façade inclusive of scraping/sanding and x2 masonry paint coats to match existing - to areas of facade non-glazing elements
- Manifestation on glazing and glazed doors should be incorporated in accordance to Part K of the UK Building Regulations

### INDICATIVE WINDOW BLINDS SPEC

Indicative spec for internal window blinds to be fixed inside areas of new curtain wall glazing. Within tender allow for all areas glazed with clear / tinted glazing to include for fixing of new manually operated vertical blinds, after removal of existing. Blinds to be Waverley blinds VL-M mono chain controlled vertical blind system or equal approved. Blinds to be track fixed to head of opening reveal and to incorporate cord retainer fixed minimum 1500mm from top of curtain wall to be compliant with child safety requirements. Vertical slats between 90 fabric for reduction of solar glare. Slat width 89mm. Colour white or from standard colour range. Areas of high-level barrel-valuated glazing to include curved head track. All fixed in accordance with manufacturers requirements.

DATE	REVISION	REV	DRW	CHK
13.01.22	FIRST ISSUE	P01	PA	RP
27.01.22	ISSUED FOR PLANNING	P02	PA	RP

This drawing has been prepared solely for the use of  
RAF MUSEUM, HENDON and there are no  
representations of any kind made by NORR  
Consultants Limited to any party with whom NORR  
Consultants Limited has not entered into a contract

This drawing must not be used, reproduced or  
revised without written permission.

This drawing shall not be used for construction purposes until the "CONSTRUCTION" status appears under the Sheet Status.

Constructors must only work to figured dimensions which are to be checked on site. Do not scale from hard-copy drawings.

Keyplan

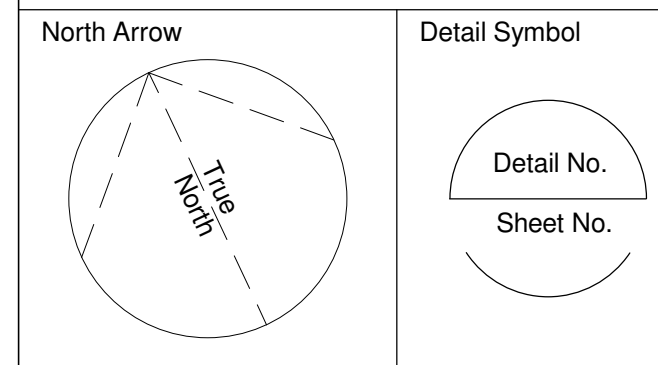

### Consultants

**NORR**  
NORR Consultants Limited.  
An Ingenium International Company

The Stanley Building,  
7 Pancras Square,  
London N1C 4AG England, UK  
[norr.com](http://norr.com)

Drawn RP	Date 13.01.2022
Checked PA	Date 13.01.2022

Scale  
As

indicated	
Client	RAF MUSEUM, HENDON

Project  
RAF MUSEUM HANGAR 3,4 + 5  
REPLACEMENT GLAZING PROJECT

Drawing Title

**LEVEL 00 - WEST WING PROPOSED  
GLAZING PLAN**

Sheet Status  
S4 - FOR APPROVAL

Project No.	IALN20-0048-02
-------------	----------------

Drawing No.	
-------------	--

RAF-NOR-01-00-DR-A-21-0012	P02
----------------------------	-----