

This drawing contains extracts from RECORD INFORMATION referenced from the below listed drawings:
Imperial War Museums:
IWM-AD-4-001 Rev A Floor Layout
Alan Baxter Associates:
1996 Historical structural alteration drawings:
C734/30/01 to C734/30/10

Fire stopping minimum requirements	
To include exposed existing & new penetrations	
rating	structure
30 minutes	existing studwork partitions
1 hour	new studwork partitions existing & new interior brickwork walls
2 hour	floor & ceiling slabs & external walls

denotes
new wall penetrations for ductwork,
transfers & grilles to incorporate linings
within brickwork zones to structural engineers
specification

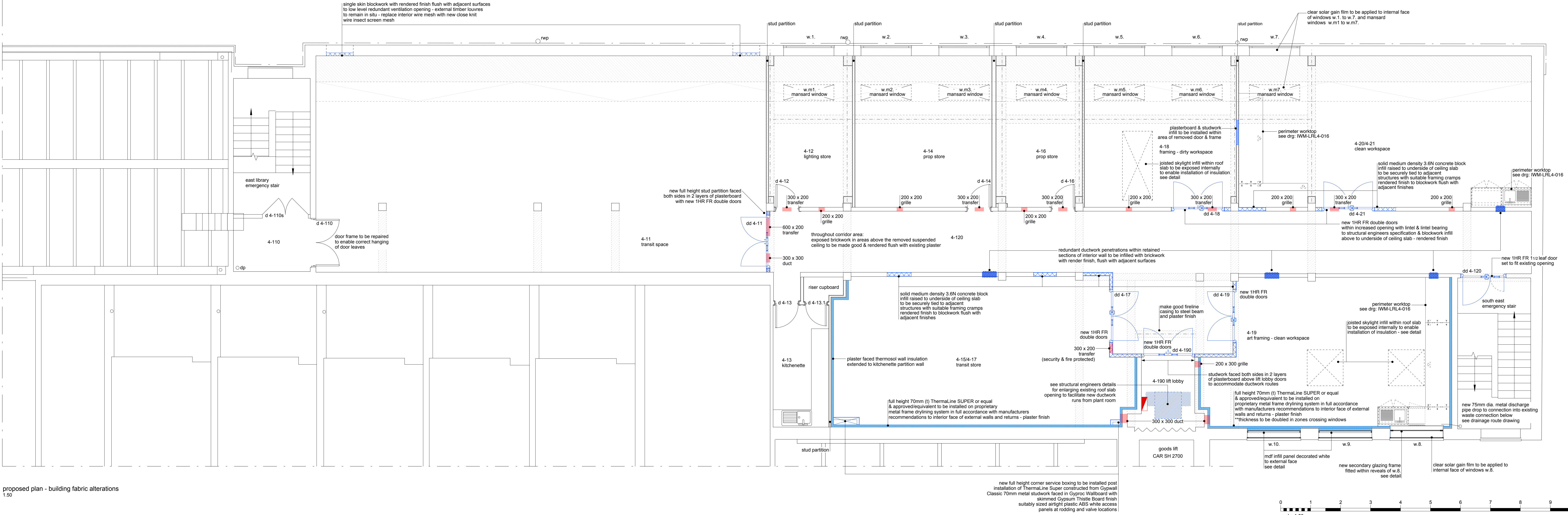

general details for 60 minute fire rated 1 1/2 leaf door dd 4-120
south east emergency stair

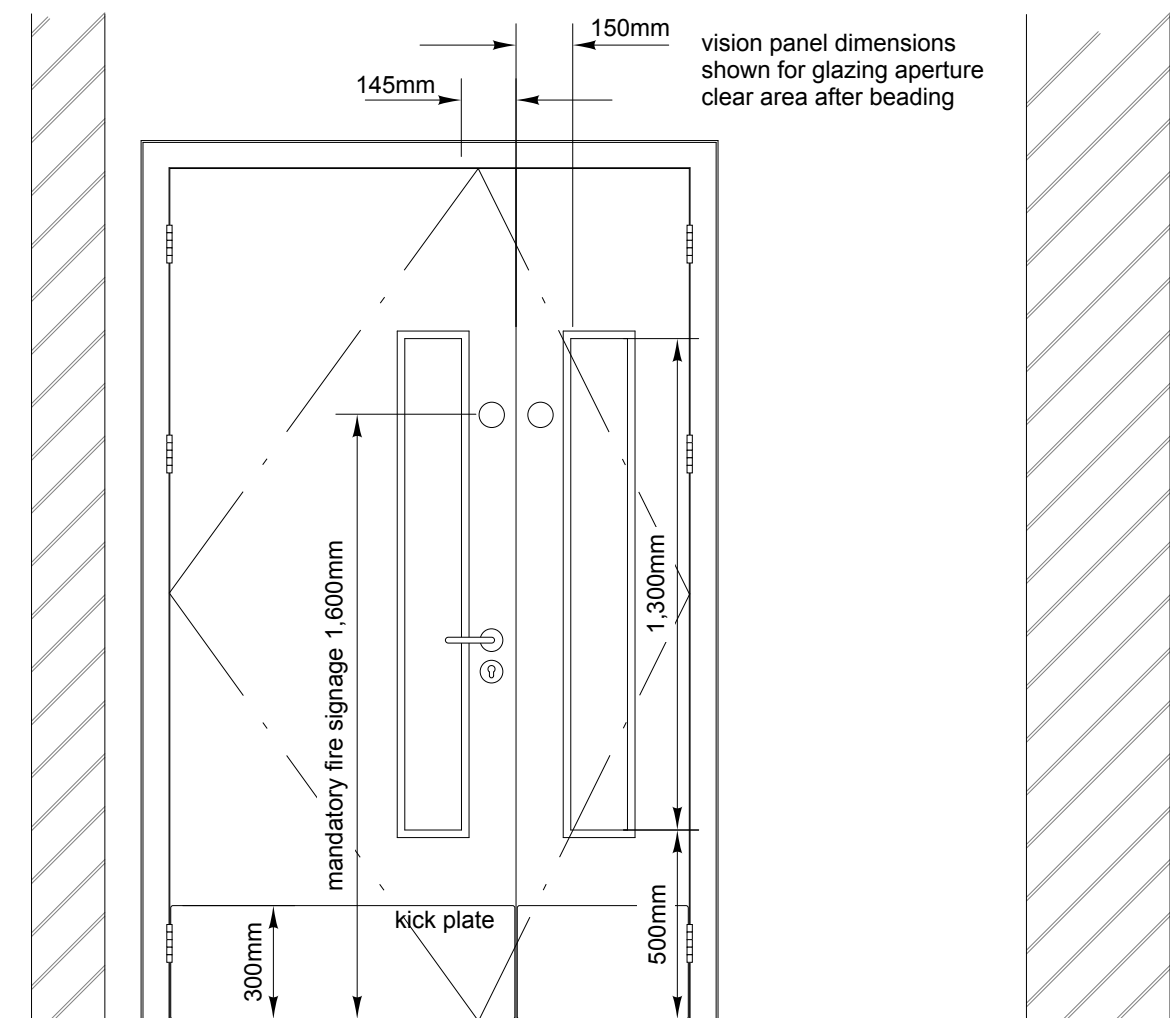

plan 1:20

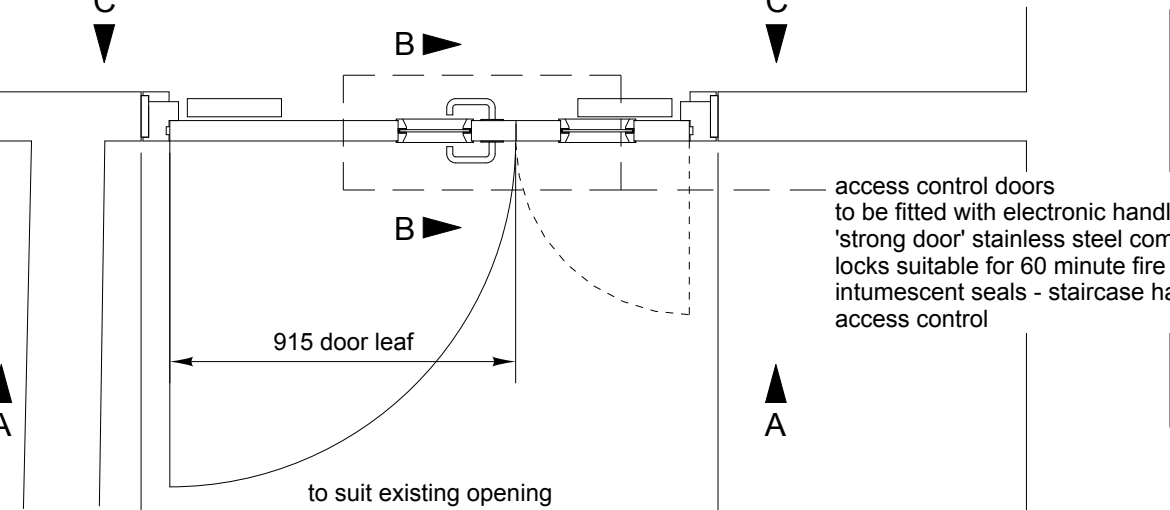

general details for 60 minute fire rated double doors
for areas 4-11, 4-17, 4-18, 4-19, 4-21 & 4-190

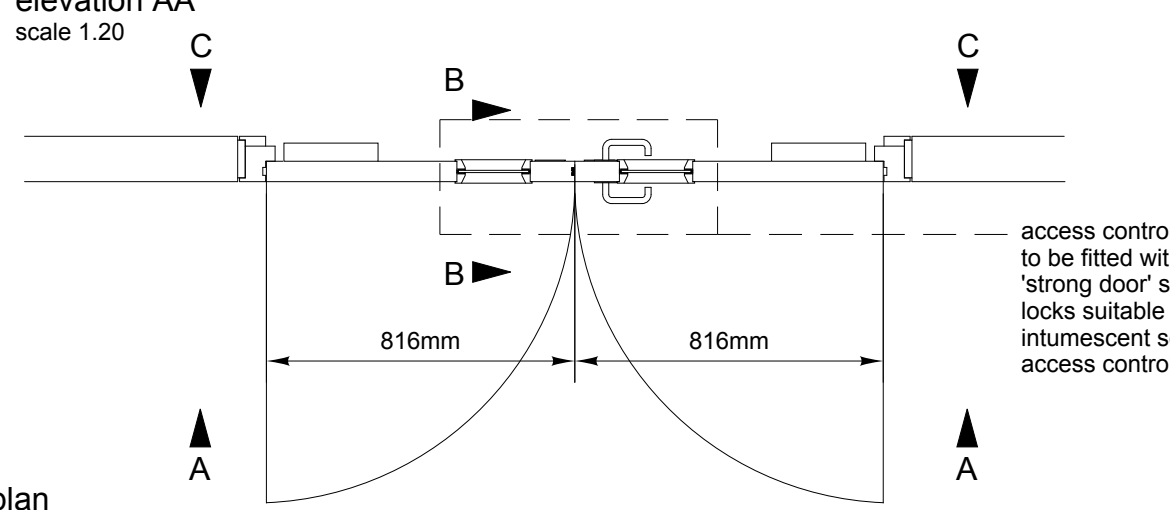
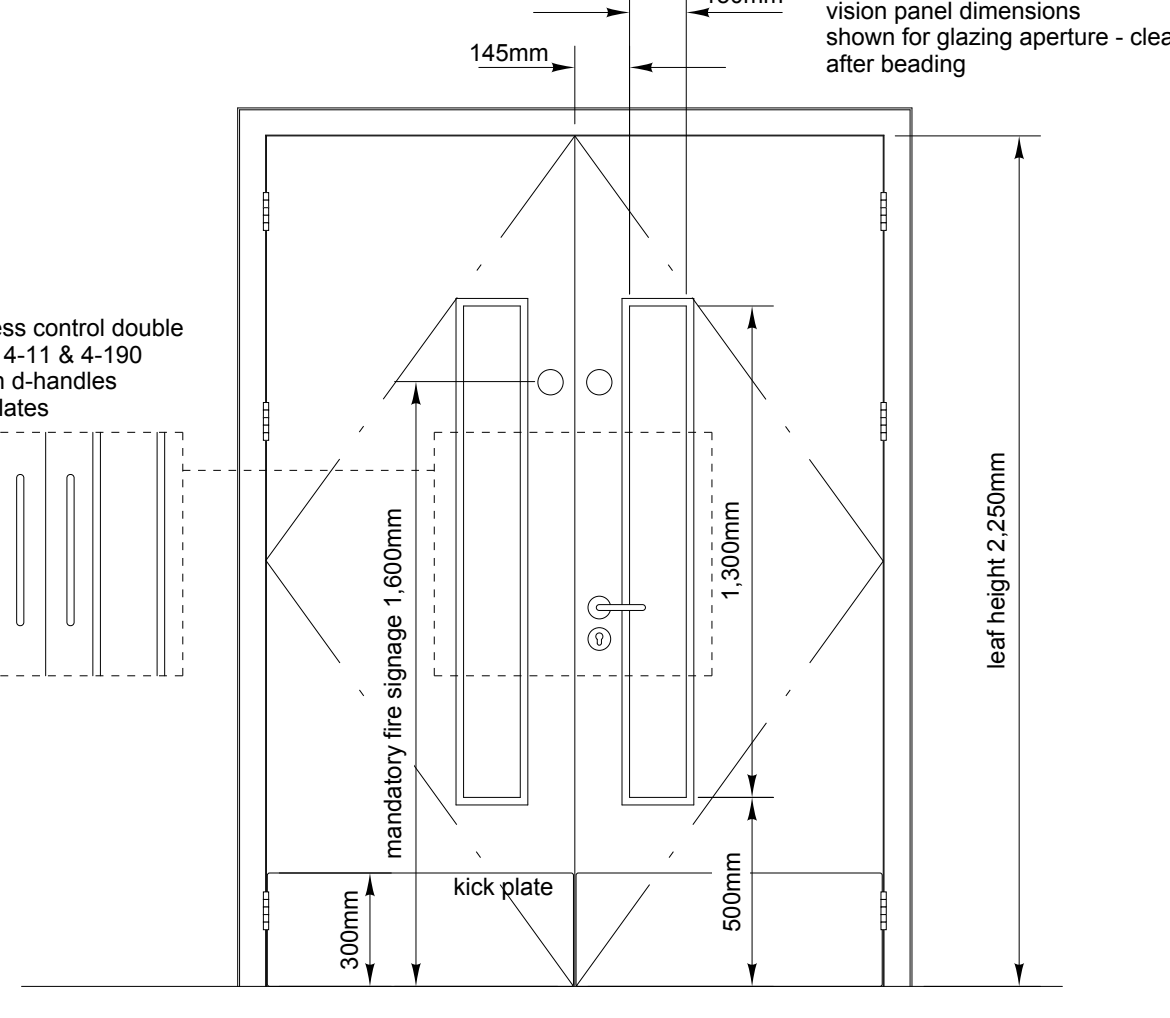

plan 1:20

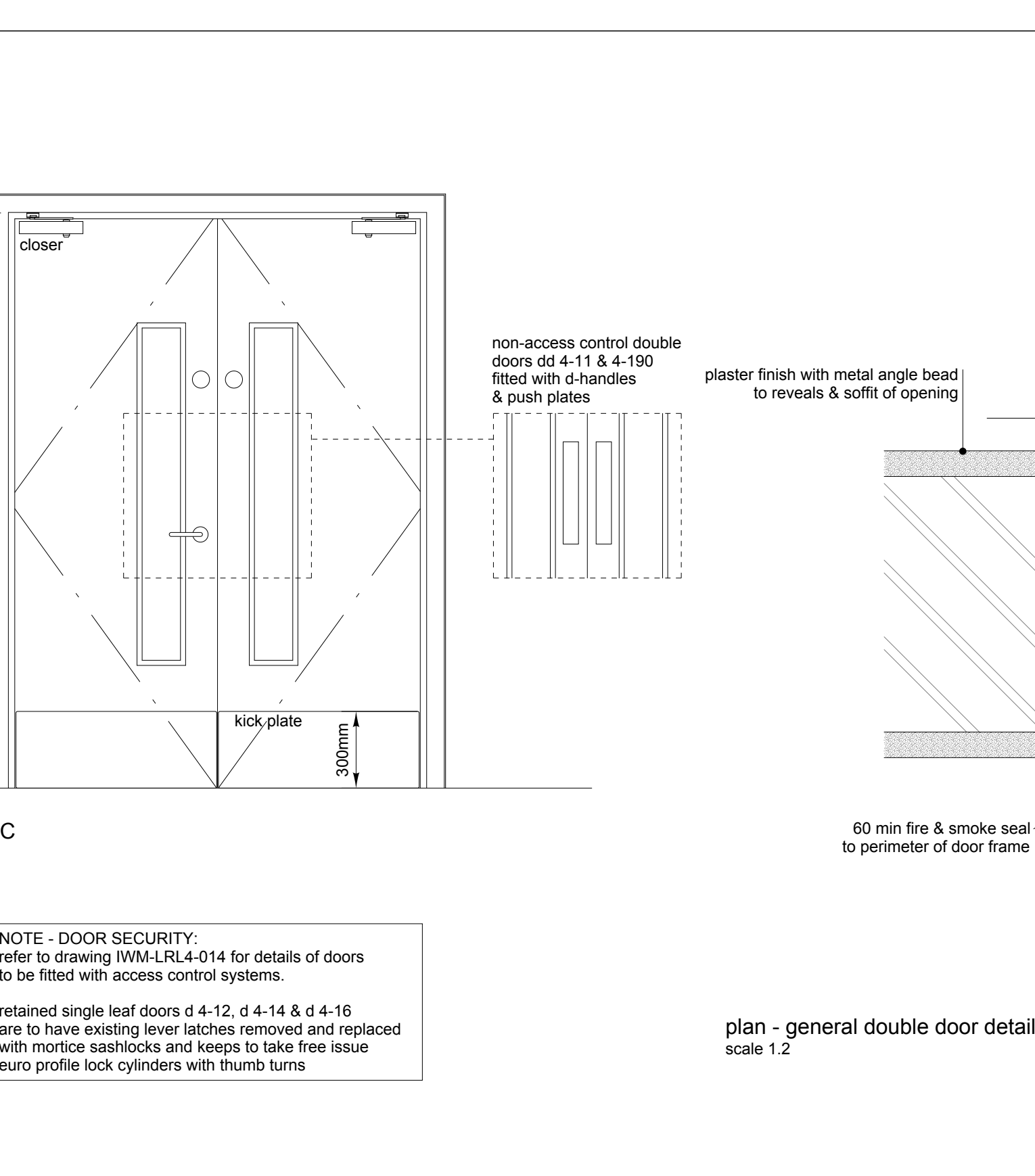
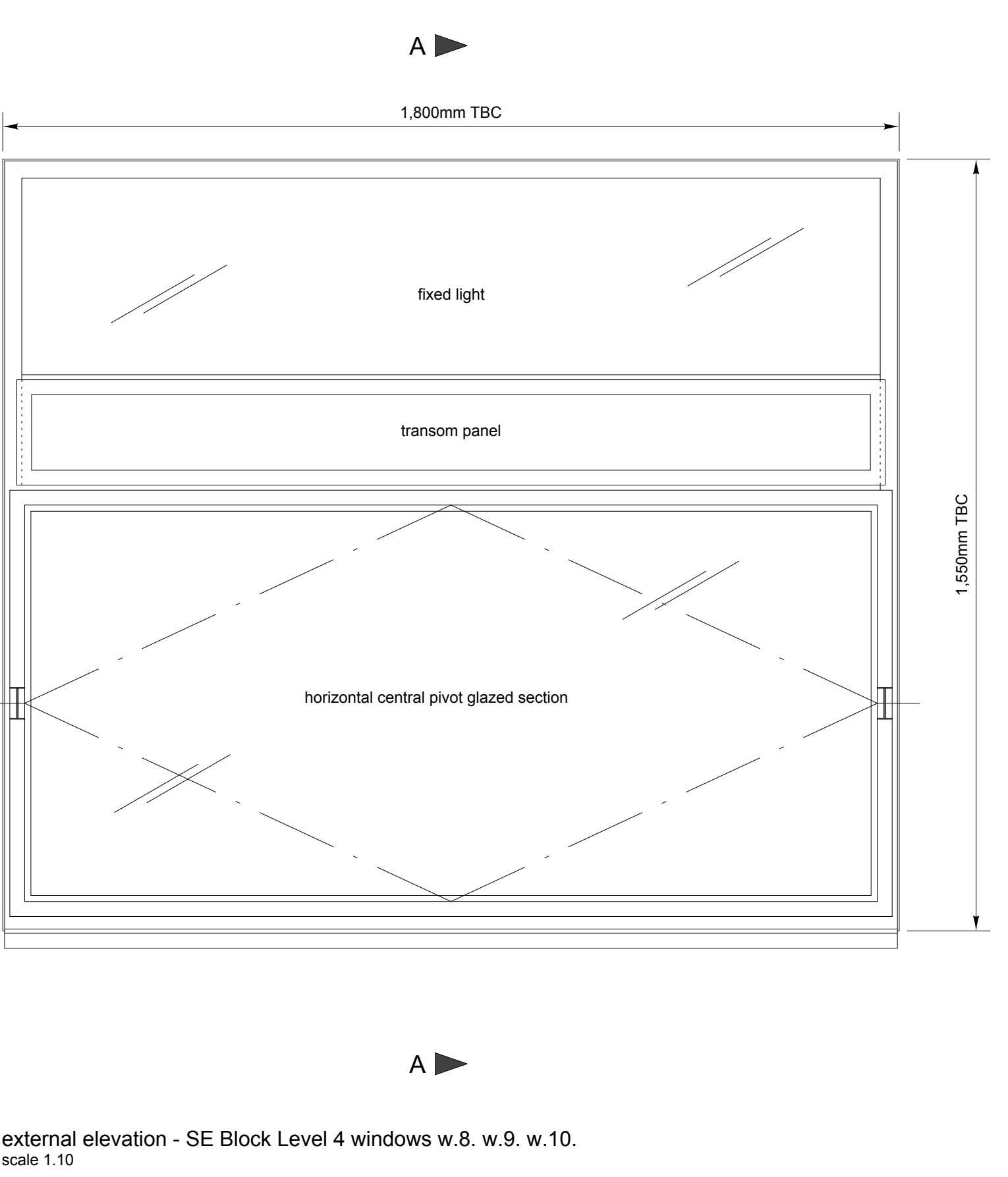

plan 1:20

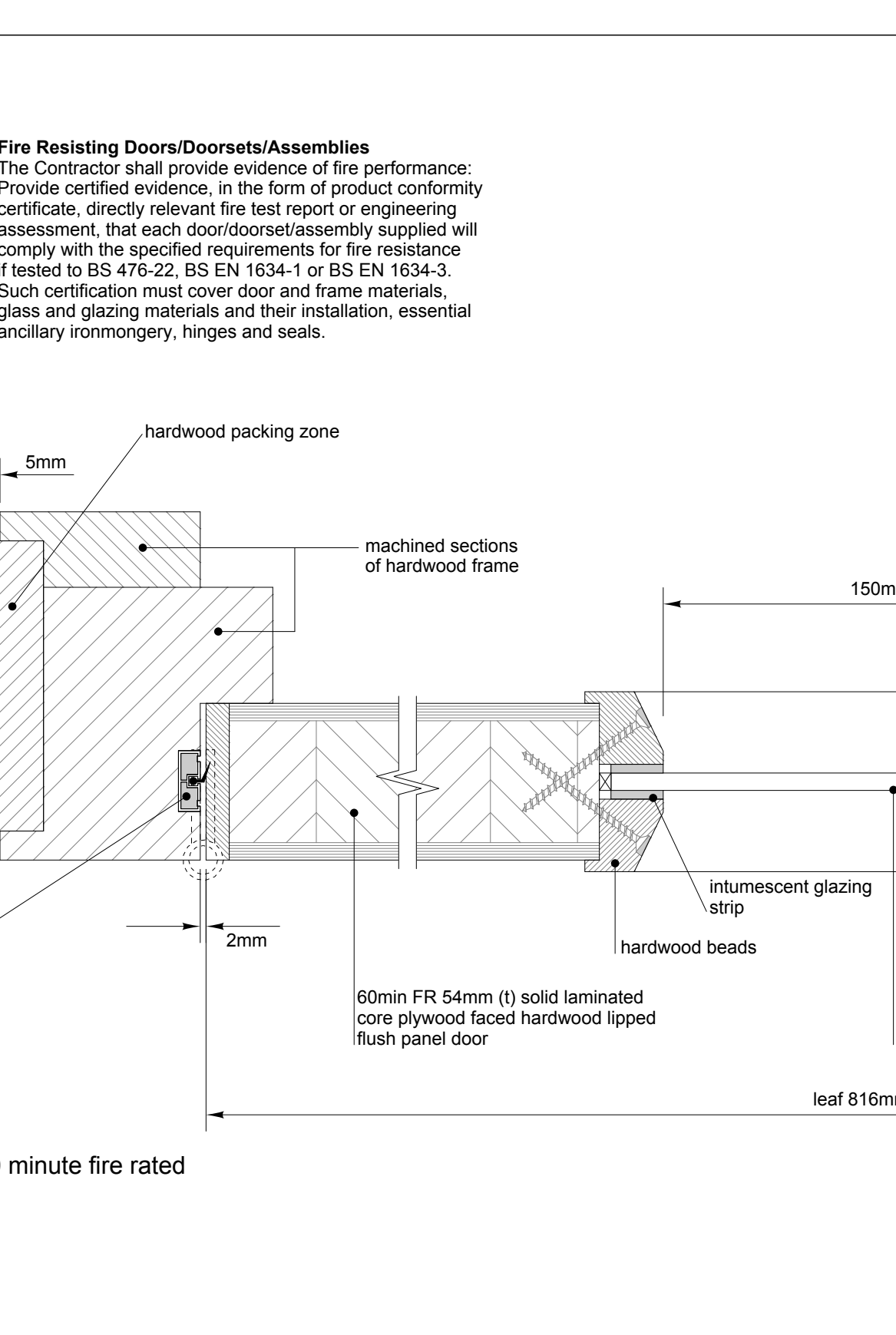
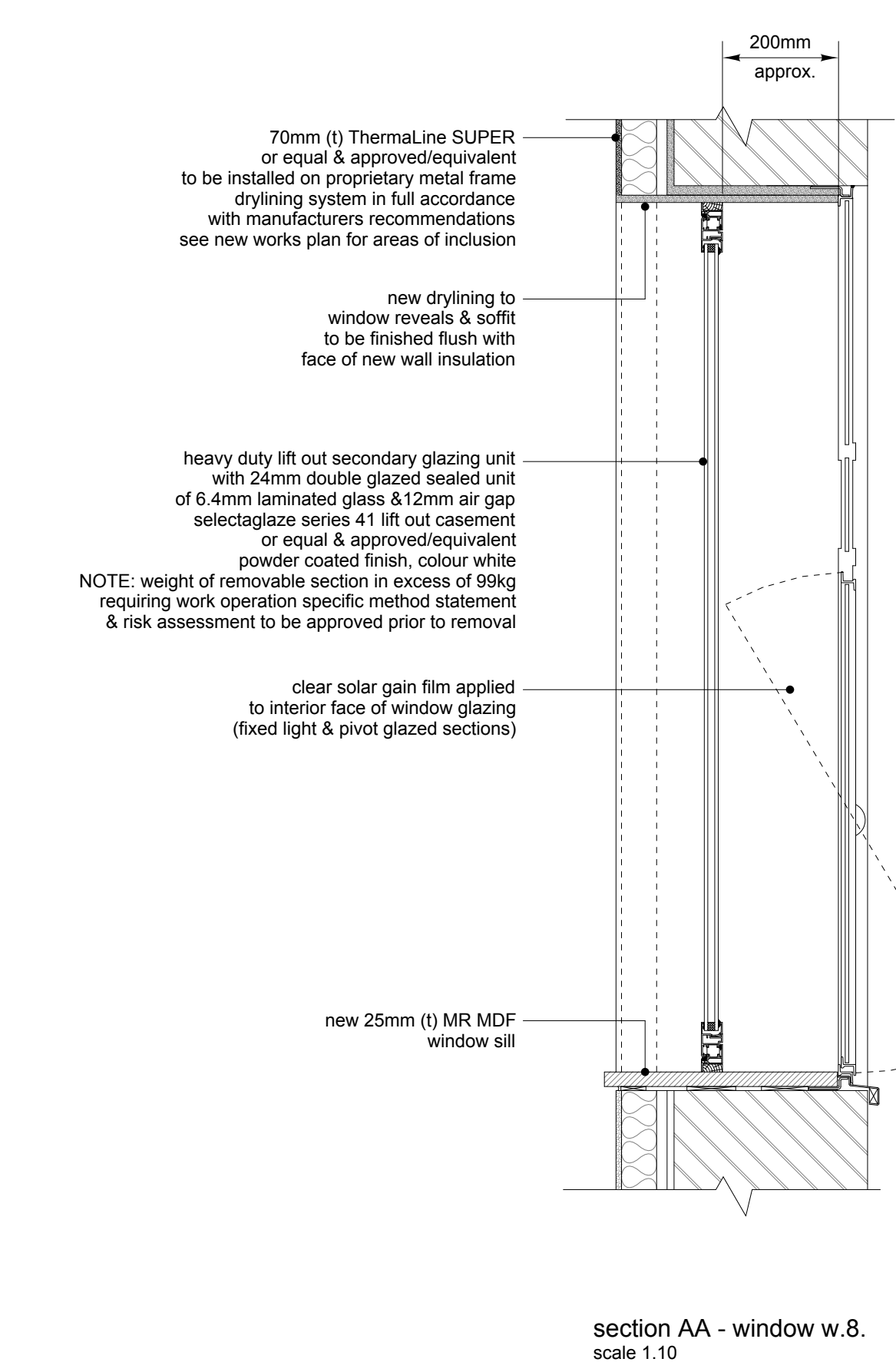

plan 1:20

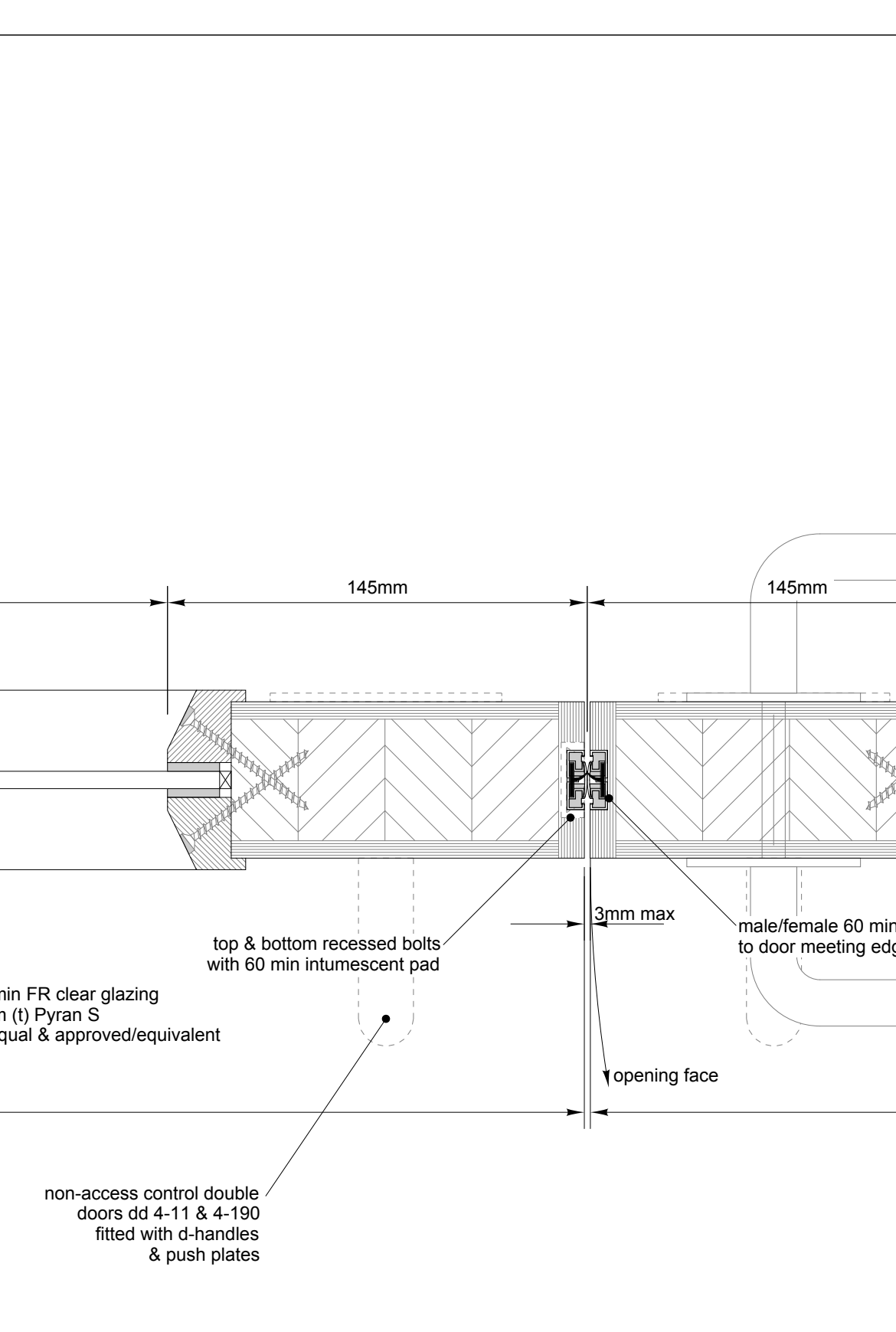
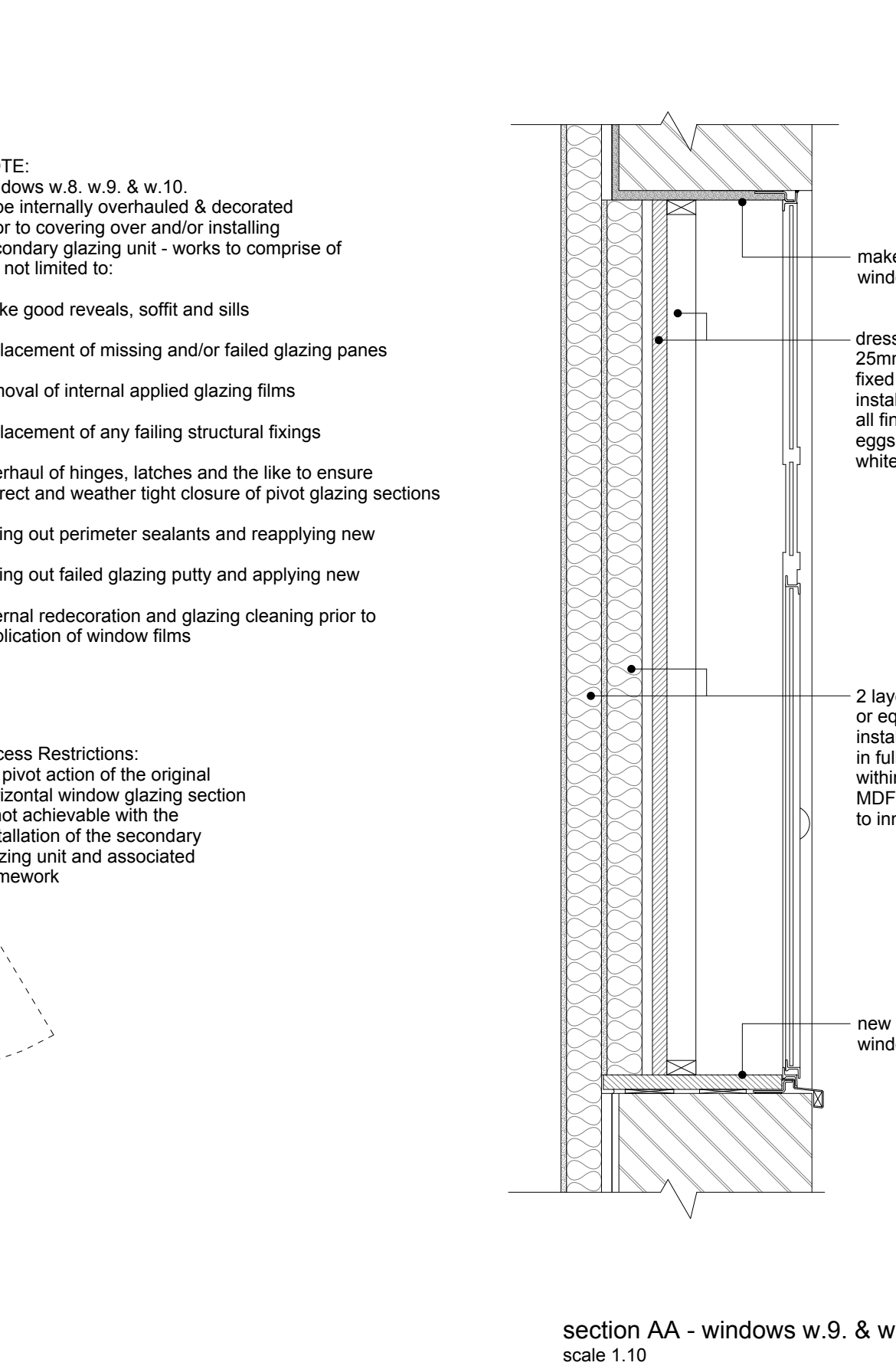

plan 1:20

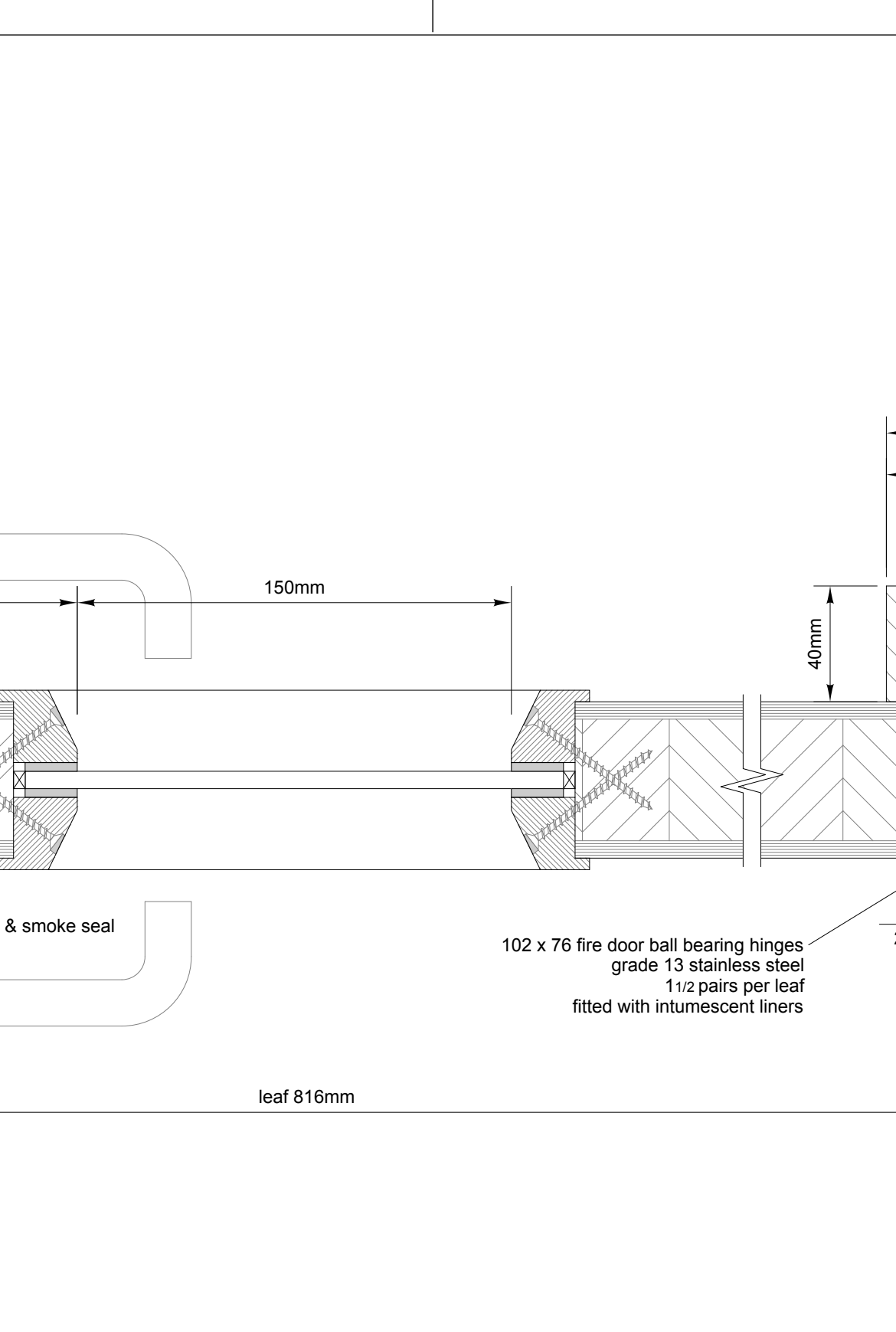
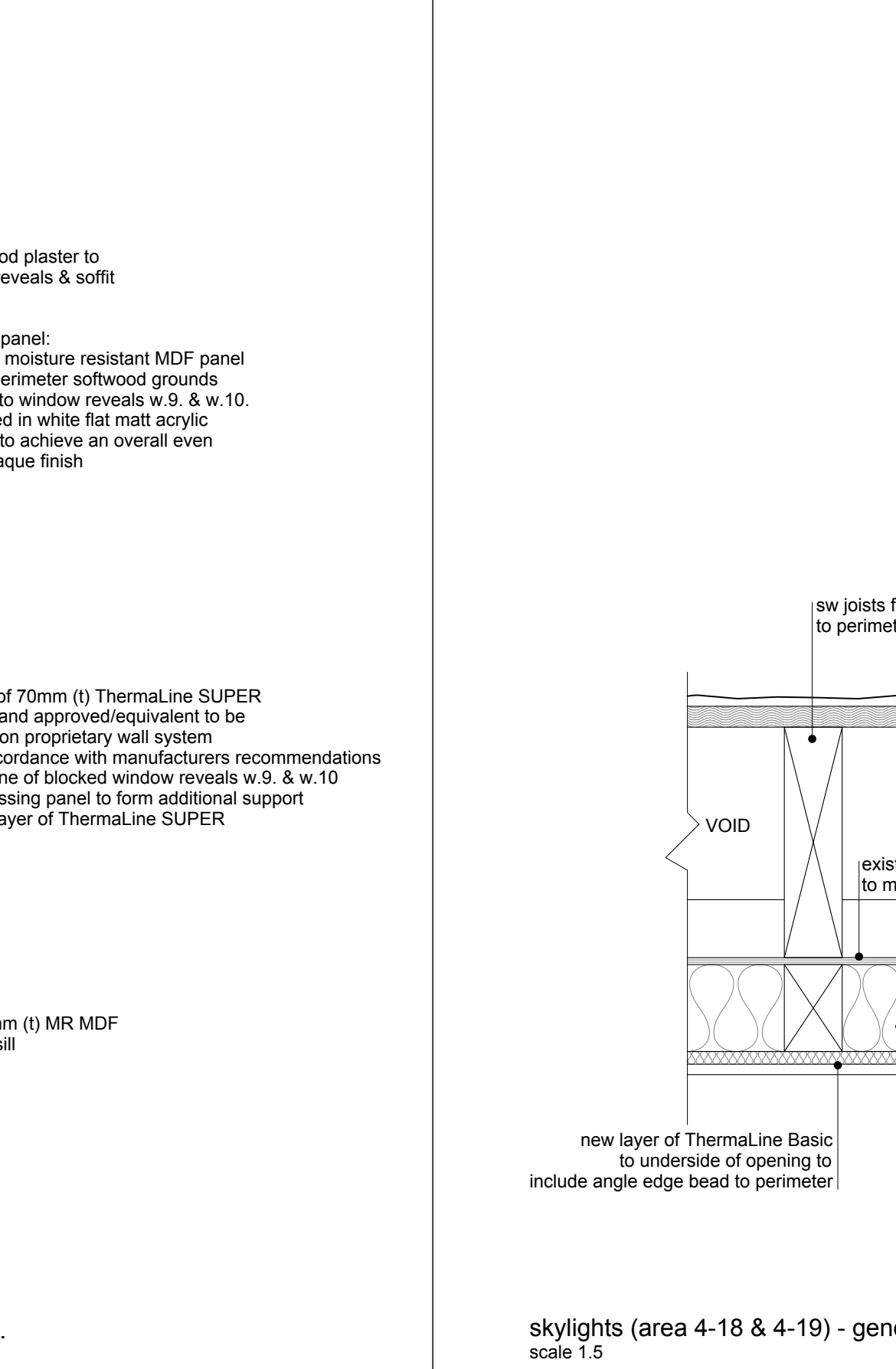

plan 1:20

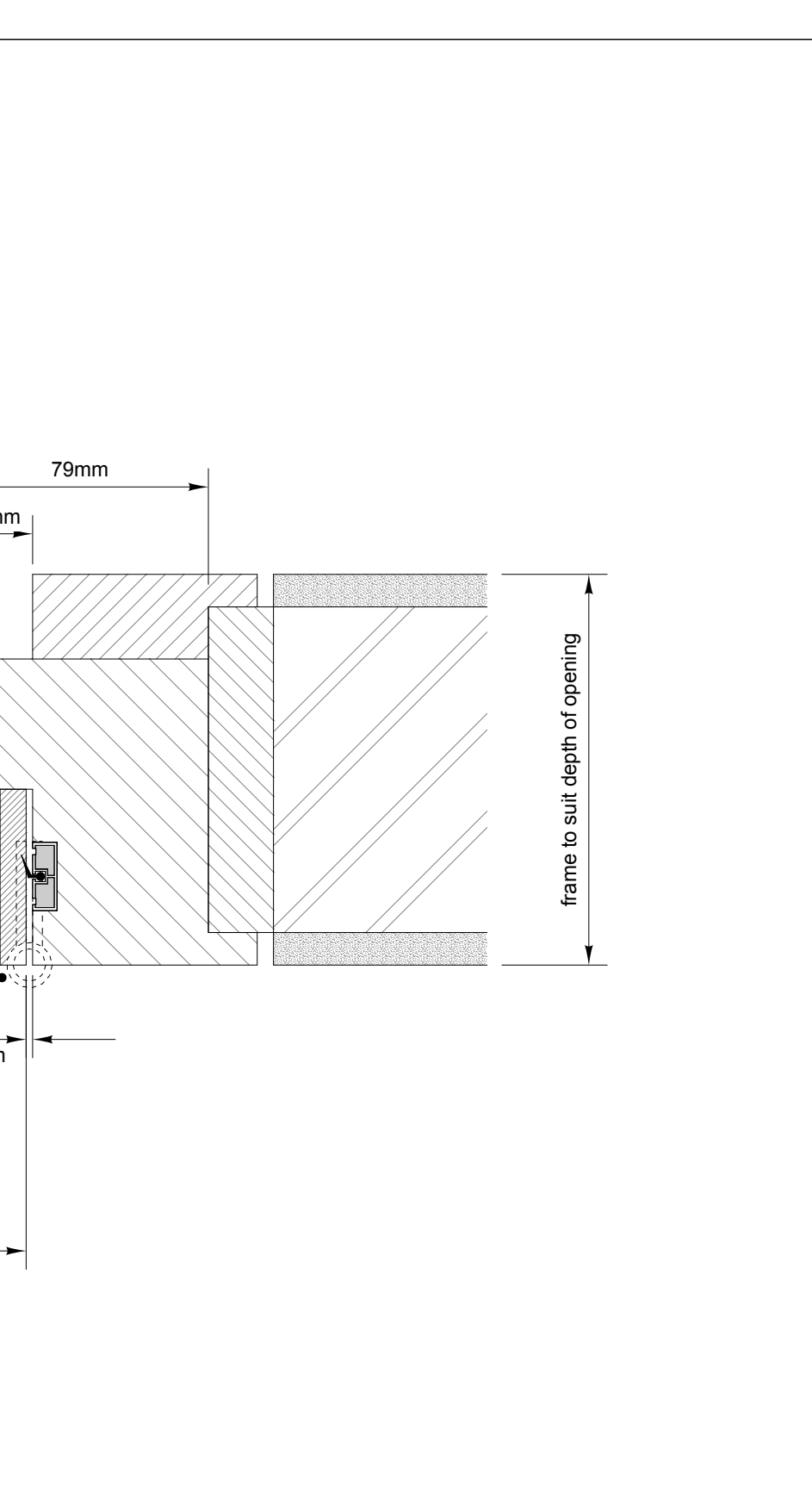
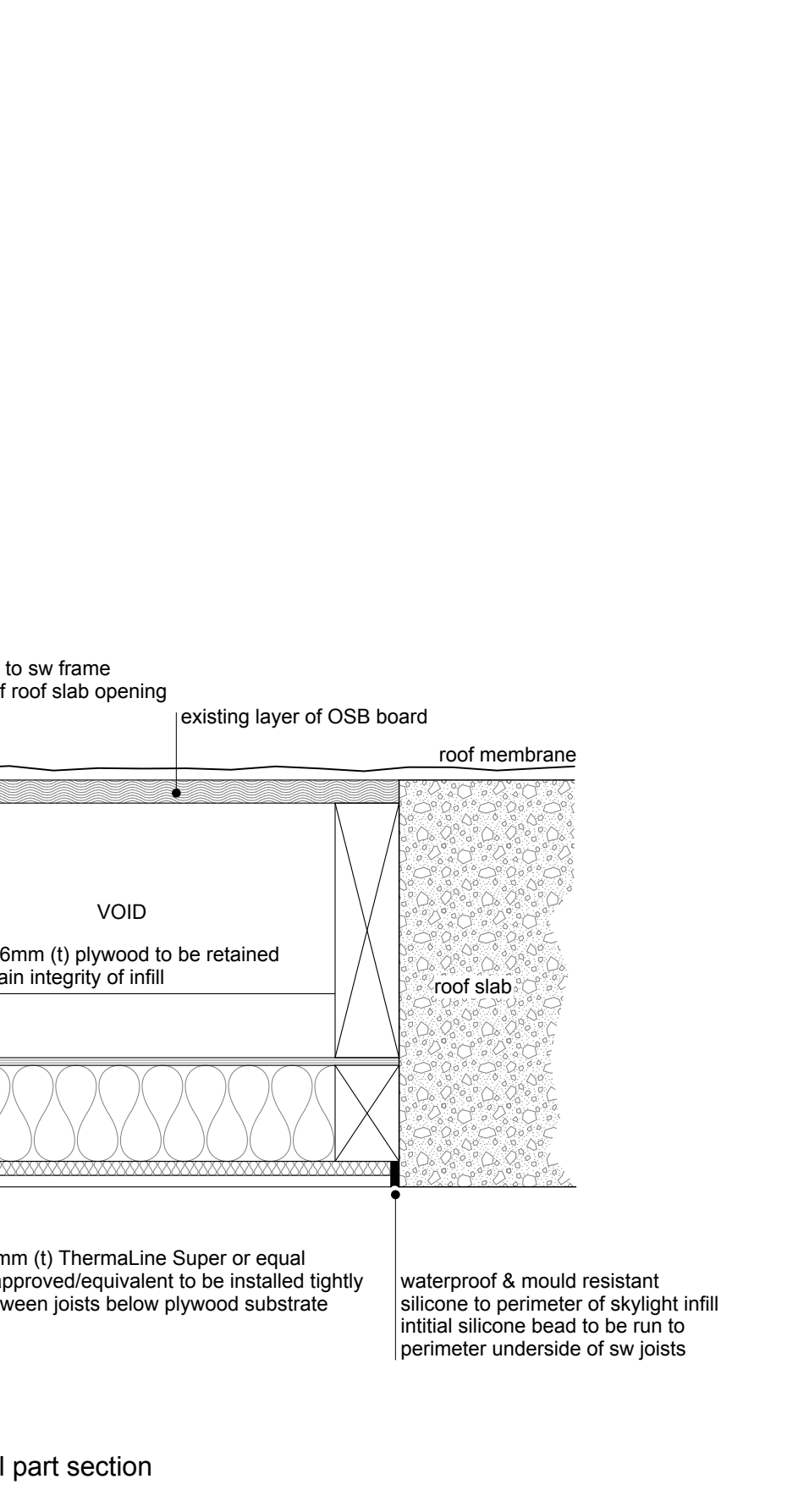

plan 1:20

08.03.2018	inclusion of 11p door set to south east emergency stair inclusion of ductwork, transfer & grille penetrations within internal walls inclusion notes regarding roof slab penetrations amendment to fire door glazing	E
19.02.2018	amendments to door openings & access control notes amendments to service boxing within area 4-15/16-17 removal of lift lobby area ceiling hatch	D
07.02.2018	new interior walls upgraded to blockwork studwork construction above lift lobby doors & corridor doors leading to area 4-11 to accommodate ceiling ductwork modifications to sink locations inclusion of skylight details window works within area 4-19 60 minutes FR double door general details	C
25.01.2018	removal of demolition plan - refer to drawing IWM-LRL4-002 (latest revision)	B
09.01.2018	west window amendments w.8, w.9, w.10, w.11 & general note additions/amendments	A
Date		Rev

Neve Bruton Design
100 Kingsway Street London E1 5LJ
Tel: (020) 7059 0412
E: info@nb-design.co.uk
www.nb-design.co.uk

Client
Trustees of the Imperial War Museum
Lambeth Road London SE1 6HZ

Project
SE Block Level 4 Conversion

Drawing title
Proposed Building Fabric Alterations

Scale 1:50, 1:10, 1:5, 1:2, 1:1 @ A0 Date 04.12.2017

DO NOT SCALE FROM THIS DRAWING.
FOR INFORMATION PURPOSES ONLY - NOT FOR CONSTRUCTION.
IN PREFERENCE TO THOSE GIVEN OR SCALED FROM THIS DRAWING

Revision letter	A	B	C	D	E
IWM-LRL4-010					