

SECTION 1-1
TYPICAL PERIMETER WALL WITH PC FLOOR PARALLEL
Scale 1:20

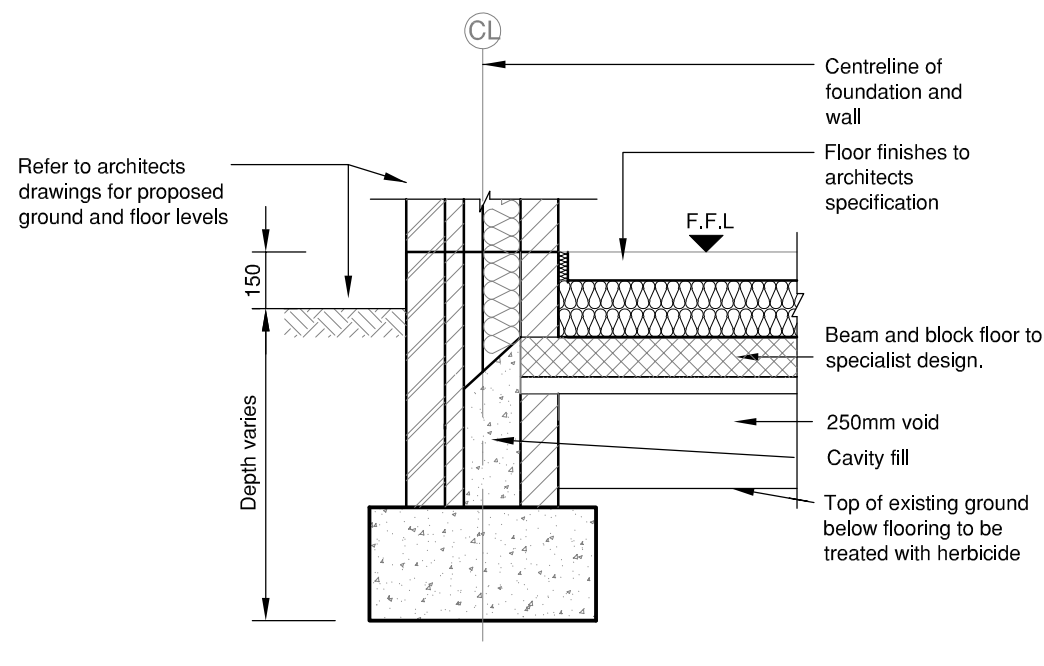

SECTION 2-2
TYPICAL PERIMETER WALL WITH PC FLOOR PERPENDICULAR
Scale 1:20

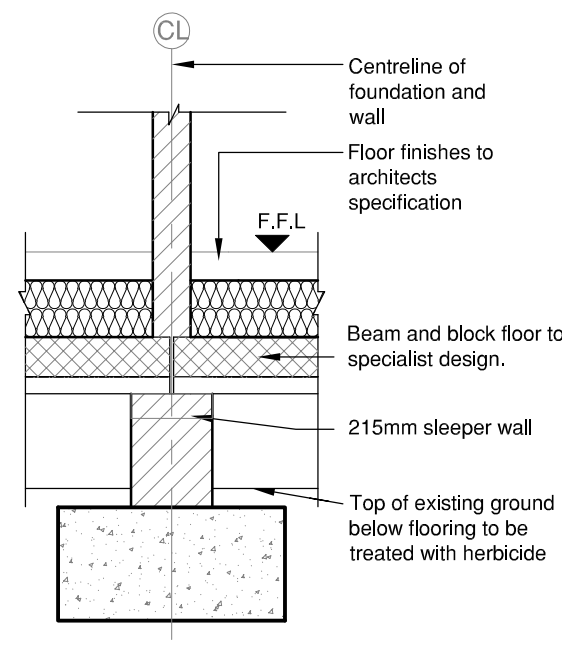

SECTION 3-3
TYPICAL INTERNAL WALL WITH PC FLOOR
SPANNING ONTO SLEEPER WALL
Scale 1:20

Notes:

GENERAL

- G1. DO NOT SCALE THIS DRAWING. USE ONLY WRITTEN DIMENSIONS. ANY DISCREPANCIES TO BE REPORTED TO THE ENGINEERS. IF IN DOUBT ASK.
- G2. SETTING OUT TO ARCHITECT'S DRAWINGS.
- G3. THIS DRAWING IS TO BE READ IN CONJUNCTION WITH ALL OTHER RELEVANT ARCHITECTS, ENGINEERS, AND SPECIALISTS DRAWINGS, AND WITH THE SPECIFICATIONS.
- G4. WORKS TO COMPLY WITH ALL RELEVANT BRITISH STANDARDS, CODES OF PRACTICES, EURO CODES AND THE BUILDING REGULATIONS.
- G5. THE CONTRACTOR SHALL BE RESPONSIBLE FOR MAINTAINING THE STRUCTURAL INTEGRITY OF THE WORKS AT ALL TIMES BY THE PROVISION OF ADEQUATE TEMPORARY WORKS.
- G6. ALL DIMENSIONS IN MILLIMETERS (mm), ALL LEVELS IN METRES (m).

GROUND FLOOR BEAM AND BLOCK

- GF1. THE BEAM & BLOCK FLOOR IS TO BE DESIGNED BY A SPECIALIST MANUFACTURER FOR THE FOLLOWING LOADS:-
LIVE LOAD : 3.0kN/m²
FINISHES : 2kN/m²
PARTITIONS : SEE NOTES BELOW
SELF WEIGHT : TO MANUFACTURERS SPECIFICATIONS.
- GF2. FOR SETTING OUT OF NON LOAD BEARING PARTITIONS REFER TO THE ARCHITECT'S DRAWINGS. FLOORS TO BE DESIGNED FOR A CHARACTERISTIC LINE LOAD OF 4.5kN/m AT THESE LOCATIONS.
- GF3. CALCULATIONS AND WORKING DETAILS OF FLOORS TO BE SUBMITTED TO CLEGG ASSOCIATES FOR COMMENT PRIOR TO CONSTRUCTION.
- GF4. WHERE BEAM & BLOCK GROUND FLOOR IS BUILT INTO WALLS. FLOOR BLOCK STRENGTH IS NOT TO BE LESS THAN BLOCK STRENGTH USED IN THE CONSTRUCTION OF THE WALL.
- GF5. CONCRETE FLOOR BEAMS PARALLEL TO WALLS TO HAVE A GALVANIZED M.S. STRAP (30mmx5mm THICK) AT 1500mm CRS. BUILT INTO WALLS AND PLUGGED AND SCREWED TO MINIMUM 3 No. FLOOR BEAMS.

BLOCKWORK BELOW GROUND

- B1. MASONRY BELOW GROUND LEVEL TO BE EITHER NON FROST SUSCEPTIBLE BLOCKWORK WITH A MINIMUM COMPRESSIVE STRENGTH OF 7N/mm², OR CLASS B ENGINEERING BRICKWORK, BOTH IN CLASS (i) MORTAR.
- B2. 215 WIDE WALL CONSTRUCTION. BELOW SLAB, TO BE EITHER:
2x100 WIDE BLOCK COLLAR JOINTED, WITH ALL JOINTS FILLED & WALL TIES AT 450 CRS.
OR
BLOCKS LAID FLAT (NO ONE BLOCK UNIT TO WEIGH MORE THAN 20kg)
- B3. ALL WALL TIES ARE TO BE STAINLESS STEEL AND COMPLY WITH BS.1243 AND MEET THE PERFORMANCE REQUIREMENTS OF STANDARD DD140. CLASS 1, AND ARE TO BE INSTALLED IN FULL ACCORDANCE WITH BS 5628 - PART 3 : 2001.

PRELIMINARY

P	1	PRELIMINARY ISSUE	MC	MC	02.10.19
STATUS	REV	DESCRIPTION	DRAWN	CHKBY	DATE

STATUS / REVISION
P = Preliminary, T = Tender, A = Approval, C = Construction, AB = As Built

CLIENT
Trowbridge Town Council

ARCHITECT
PKA Architects

PROJECT TITLE
Town Park Storage Building

DRAWING TITLE
Proposed ground floor slab plan



Clegg Associates
CIVIL AND STRUCTURAL CONSULTING ENGINEERS

Clegg Associates Ltd
Bryer Ash Business Park
Trowbridge
Wiltshire
BA14 8HE

Tel: 01225 541088
www.cleggassociates.co.uk

SCALE @ A1	DRAWN BY	CHECKED BY	DATE
1:50	MC	MC	02/10/19

DRAWING REFERENCE				
PROJECT NUMBER	TYPE	DRAWING NUMBER	STATUS	REV.
2019-134	GA	02	P	1