

Ground Floor Plan

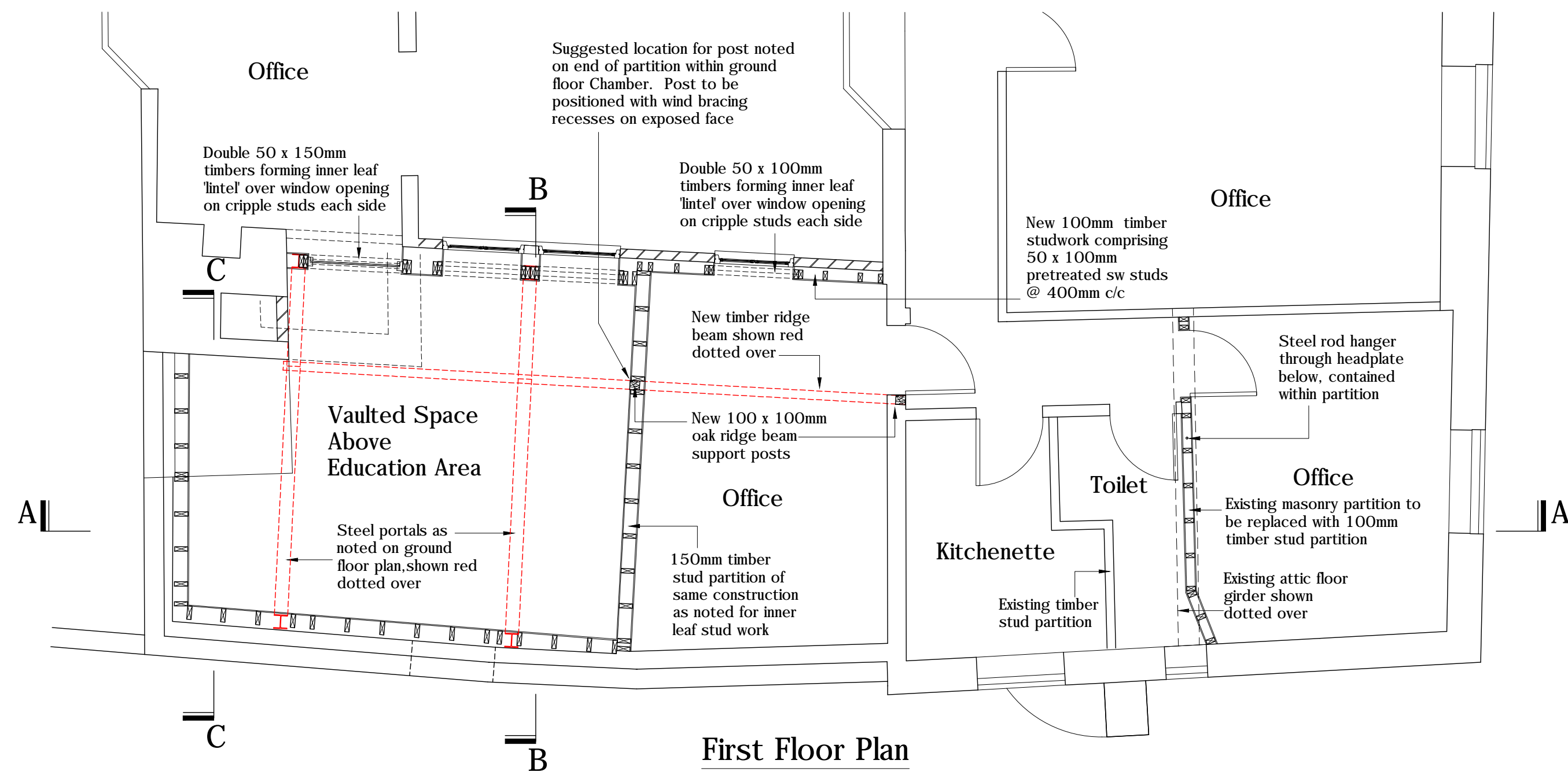

First Floor Plan

GENERAL NOTES:

Do not scale from this drawing. All setting out to be checked prior to construction and taken from the actual work wherever possible

The Contractor shall be responsible for the design, provision & maintenance of all temporary support work deemed necessary throughout the course of the works

This Drawing to be read in conjunction with Architect's relevant details, together with separate NBS Clauses and any other specialist and manufacturer details that may apply

Structural steelwork to be mild steel Grade S355 to BS5950, with any holes required for fixing timber plates/inserts pre-drilled ex works

Brickwork to new internal pier to be of 34.5N/mm² (min) crushing strength in 1 ½:4 mortar to BS5628

Structural softwood timber to be pretreated C24 (min) grade to BS5268

Structural oak to be of air dried THA Grade & D30 strength class to BS 5268

Concrete to raft foundation to be of C35/40 mix to BS8500-1:2015, with 20mm max aggregate size graded to BS882

Reinforcement to a raft foundation to be high yield deformed rods to BS4449. Reinforcement to slab to be high yield steel mesh fabric to BS4483. Minimum side laps to fabric 300mm

Assumed safe Ground bearing capacity = 50kN/m²

B
A

Updated for tender & construction purposes
External wall construction altered to suit architects details

16/12/18
19/07/17

No	Amendment	Date
----	-----------	------

STRUCTURAL DETAILS (FLOOR PLANS) ASSOCIATED WITH
PROPOSED ALTERATIONS AND EXTENSION TO
THE ALMONRY, HIGH STREET
BATTLE, EAST SUSSEX
For: Battle Town Council

Date	Scale	Drawn	Checked	Drawing No	Rev
July 2017	1:50 & 1:10 @ A1	RJB		H4154/01	B

Sheppard
CONSULTING CIVIL AND
STRUCTURAL ENGINEERS

5 Chiswick Place
EASTBOURNE
BN21 4NH
01323 410478
eastbourne@earsheppard.co.uk
www.earsheppard.co.uk