

AV Services for Cornwall & Isles of Scilly Skills Hub

RFQ Clarification Log v1.0 21/07/2022

Ref	Date Raised	Document	Section / Page	Clarification Question	Response
001	19/07/22	RFQ	5.3	If the lights need to be battery do the screens need to be as well?	Screens do not need to be battery powered. Access to mains power will be made available.
002			5.4.3	Is there a PA system on site to connect to or is this what we need to provide for? can you outline the spec of the audio if not provided? i.e. number of speakers, size of room, size and distribution of the audience.	PA system will need to be supplied. The venue is the Seaview Suite at St Austell Conference centre with approx. 50 people to be in attendance in person with this to be setup theatre style.
003			5.5	Regarding battery to wireless, it would be better if they could be plugged in as its not really possible to have battery powered lights running all day at that power rating. Is this possible?	This is possible, yes.
004				Regarding the theatre lights - is there a lighting rig in place or will we need to use stands or scaffolding for this? The lighting spec'd could be seen as excessive depending on the size of event/auditorium/stage etc. Is the authority open to lighting rig set up suggestions should scaffolding and rig set become cost inhibitive? If	Lighting rig will need to be provided and setup suggestions are welcome. To clarify height is approximately 2-3 metres but has existing lighting suspended from the ceiling – see photos on venue website . See below for room dimensions.

AV Services for Cornwall & Isles of Scilly Skills Hub

RFQ Clarification Log v1.0 21/07/2022

				scaffolding or rig is or is not place please can you specify dimensions required to ascertain the equipment needed to transport/set up and if working at height equipment is available at the venue?	
005	20/07/22	RFQ	3	Please can you confirm which space within the St Austell Conference Centre which will be used to stage the hybrid face-to-face and live streamed event on 13th September 2022?	The space at St Austell Conference Centre will be the Sea View Suite . 50 pax and setup in theatre style.
006				The St Austell Conference Centre website states that there is "superfast Wi-Fi throughout the building" Please can you confirm if we would have access to a hard-wired internet connection for use during our time on- site and what upload and download internet speeds would be available?	Venue's response: You would have access to hard-wired ethernet as there is a lease line, a tes would be needed for the exact speed but it's usually 1000mb.

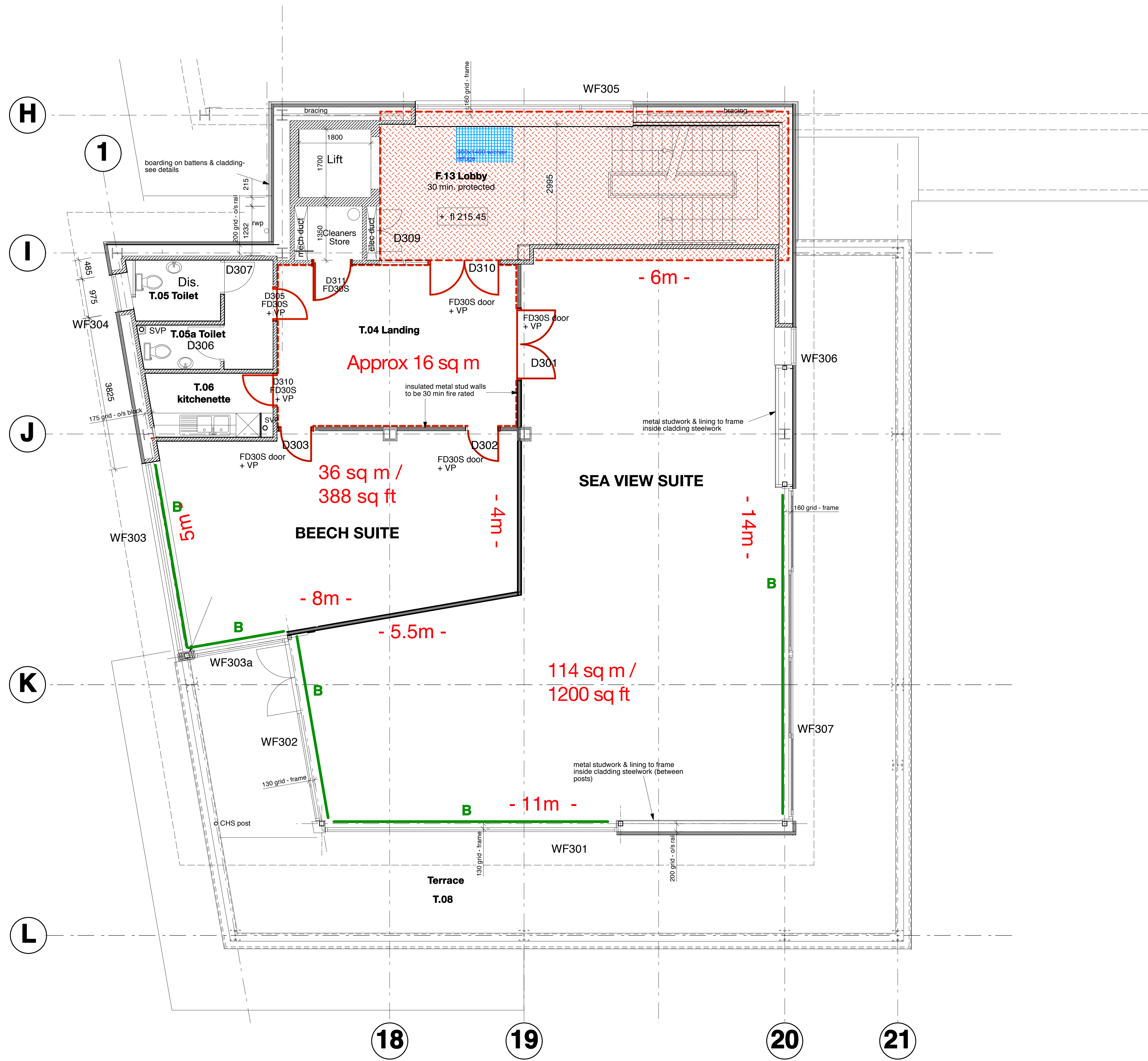

Notes:
The copyright of this drawing is retained by Alan Leather Associates Ltd.
Do not scale (electronically or by hand).
This drawing is not to be used in whole or part other than for the intended purposes.

Key:

- 30 or 60 min fire rated walls as shown on plan
- protected corridors & lobbies
- 30FD(S) fire doors
- 30FD(S) fire doors with vision panel
- FD30(S) door on electronic hold open device, linked to fire alarm. Client to include for regular maintenance of smoke & fire seals within management agreement

NOTE:
All internal door widths to be min 850mm clear opening.
All emergency lighting to BS 5266-1:2005 & exit signage to BS 5499-1:2002.
Soil & waste pipes through the floor construction below to have 1 hr fire sleeves & acoustic packing in ducts.

AS BUILT

C6 As Built Issue 17.01.13
C5 ceiling note amended
C4 May 12 Partition annotations added
C3 Feb 12 internal door refs added
C2 Feb 12 Amended to suit window manufr details
C1 Dec 11 Construction Issue

Revisions:

ala architects

Alan Leather Associates Ltd Chartered Architects
45 Charlestown Road, Charlestown
St Austell, Cornwall, PL25 3NJ

Tel: 01726 65924/67325
Fax: 01726 61480
E-Mail: ala@alanleatherassociates.co.uk

Job: New Business Premises
St Austell Enterprise Park
Treverbyn Road
Carclaze
St Austell PL25 4EJ

THIRD FLOOR PLANS - FIRE STRATEGY
Date: Nov 11 Scale: 1:50 Paper size: A1

Drawn by:
Drawing Number: 1425 - 419/2.FP C6

THIRD FLOOR PLAN