

Notes:-

1. Do not scale this drawing (printed or electronic versions).
2. This drawing indicates design intent only and shall not be used as a working drawing or installation drawing. The contractor shall be responsible for producing his own fully coordinated working drawings.
3. Contractors must check all dimensions on site prior to ordering materials or commencing work. Any discrepancies must be reported to the engineer immediately.
4. This drawing is copyright and is for use on this site only.
5. All structural & architectural elements, where indicated, have been imported from the engineers drawings and reference should be made to the individual structural / architectural drawings for exact dimensions.
6. This drawing should be read in conjunction with all relevant consultants, specialist sub-contractors, supply chain drawings and specifications for exact setting out, size and type of component.
7. Discrepancies and/or ambiguities within this drawing, between it and information given elsewhere, must be reported immediately to Ingleton Wood for clarification before proceeding.
8. All works to be carried out in accordance with the latest British Standards/Codes of Practice/Building Regulations unless specifically directed otherwise in the specification.
9. Responsibility for the reproduction of this drawing in paper form, or if issued in electronic format, lies with the recipient to check that all information has been replicated in full and is correct when compared to the original paper or electronic image.
10. Graphical representations of equipment on this drawing have been co-ordinated, but are approximations only. Please refer to specifications and / or details for actual sizes and or specific contractor construction information.
11. All builders work associated with the mechanical and electrical services installation must be included for.
12. Contractor to review site Asbestos register prior to commencing works.

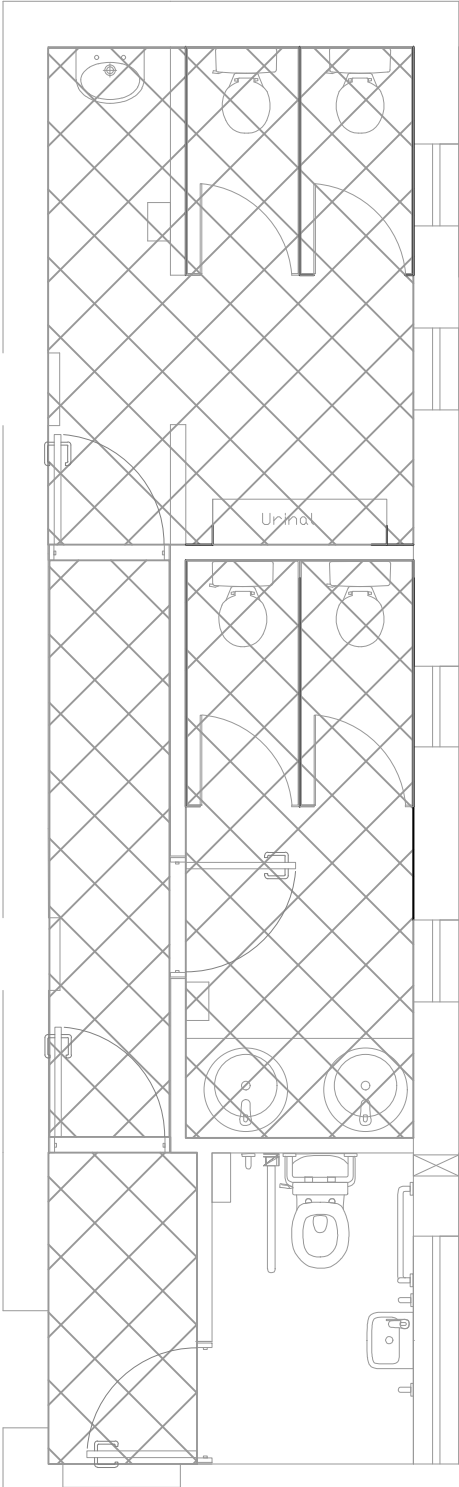

- Hatch denotes area for full Electrical Services strip out. The Electrical Service installer shall strip out all Electrical Services within the existing areas. Where they become redundant as part of the works, services shall be stripped back in their entirety to the designated boards .
- The Electrical Contractor shall allow to strip out all power accessories, radial & ring circuits shall remain to feed new outlets.
- The Electrical Contractor shall allow to strip out all light fittings & accessories, lighting circuits shall remain to feed new luminaires & controls.
- Specialist services shall be stripped out by the specialist Contractor & adapted to suit the new layout

					Project: Orpen Village Hall Solar PV & WC Works 80 Chapel Road, West Bergholt Essex, CO6 3HL		Title: Existing Electrical Services Strip Out			
							Drawing Number: OMHALL - IWD-XX-XX-DR-E-5100			
P01	Review & Comment Issue		25.05.22	CM	NH					
Rev	Description		Date	Chk	Apr	Client: West Bergholt Parish Council		Status: S3	Purpose of Issue: Review & Comment	Revision: P01
Project No: 502319		Scale @ A3: 1:50	Drawn By: KS							



Ingleton  
Wood

Property and Construction  
Consultants

Issuing office: Colchester  
T: 01206 224270  
[www.ingletonwood.co.uk](http://www.ingletonwood.co.uk)

Vision, form and function