

## Appendix 3 – Bay 4 Staircase option

### 1. Brief

- 1.1. The office stack located in Bay 4 does not currently have access to the first floor.
- 1.2. A costed option to supply and install a staircase suitable for a warehouse environment is sought by the NMRN.
- 1.3. The staircase should have as small a footprint as practicably possible.

### 2. Specification

- 2.1. The threshold of the door of the first floor is 3120mm from the floor.
- 2.2. The staircase should follow the office stack wall towards the exterior wall (see Bay 4 layout for general area).
- 2.3. The staircase should not be fixed to the exterior wall of the building.

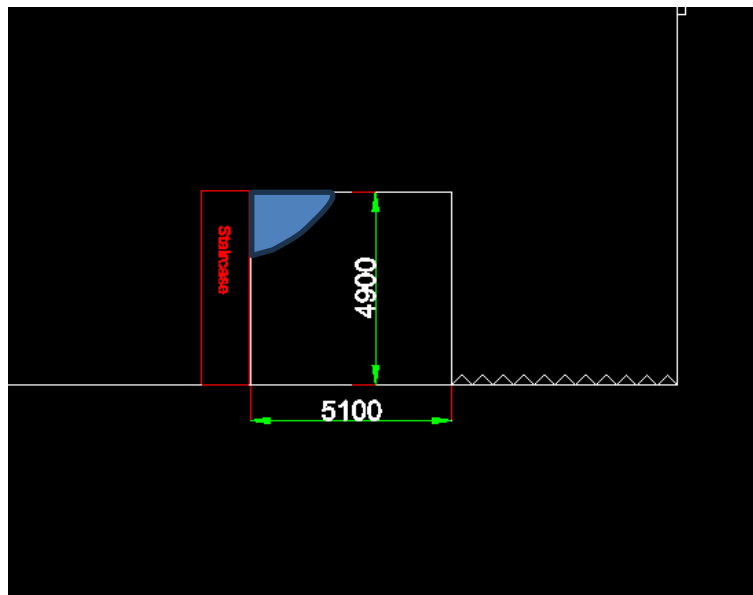

Figure 1- Area for staircase shown.