

Section F4-F4

(Scale :- 1 : 50@ A1)

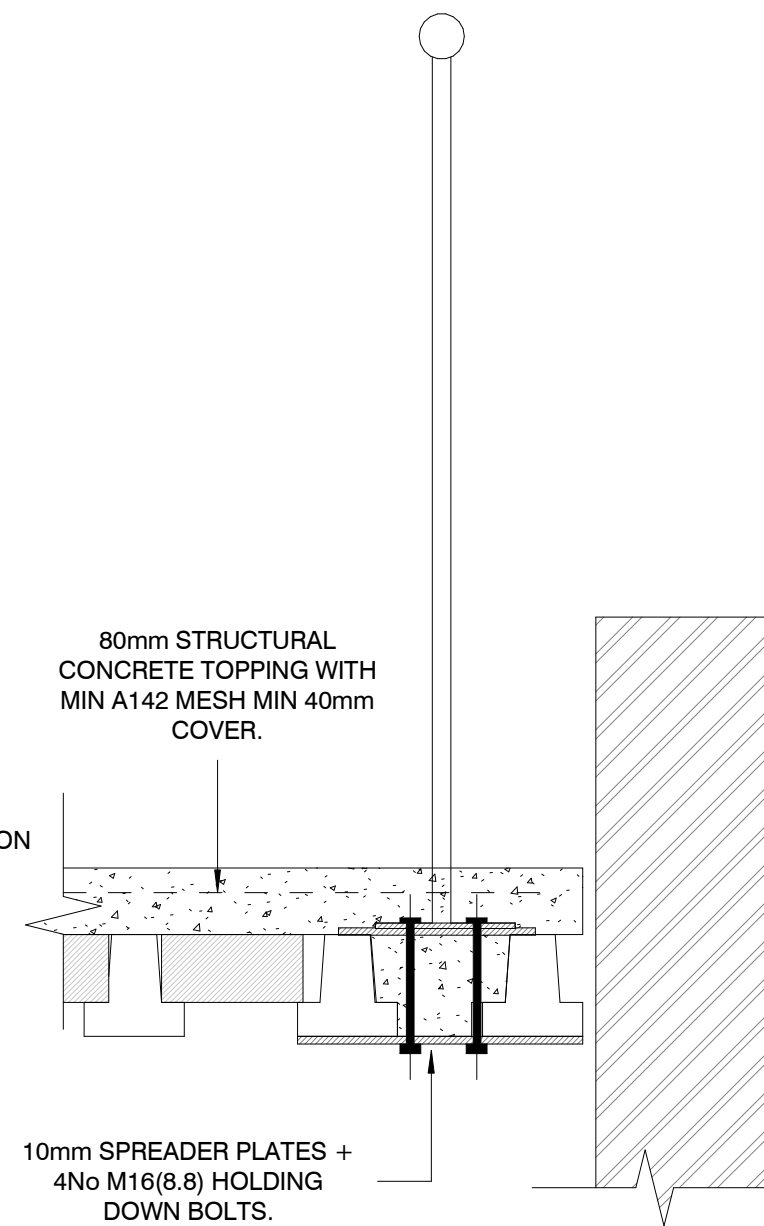

Detail B1

(Scale :- 1 : 10@ A1)

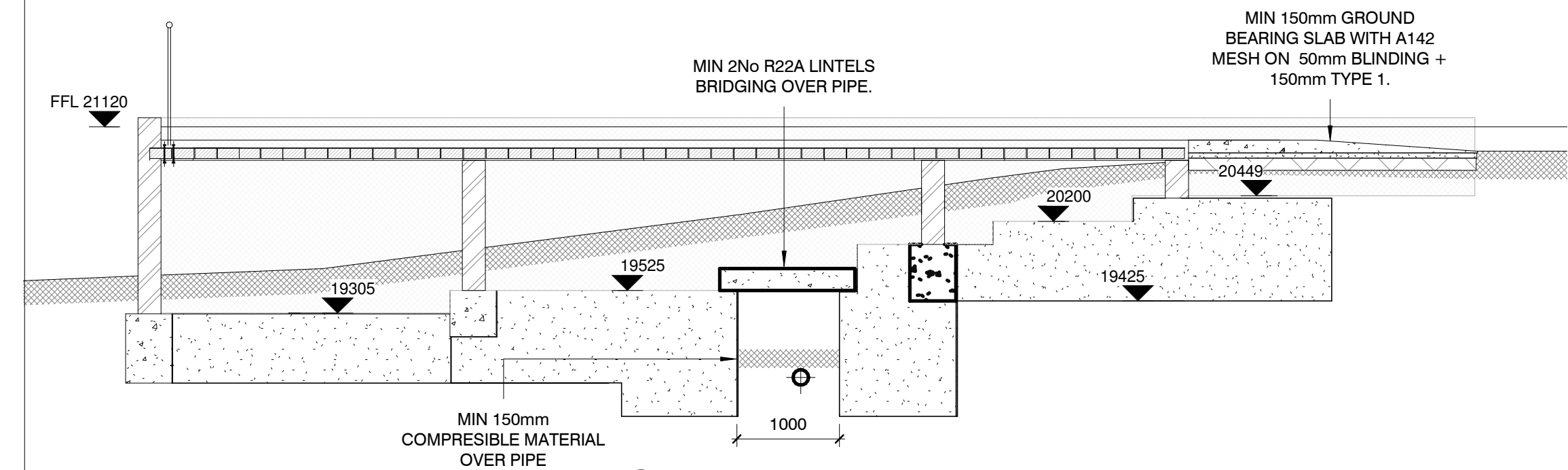

Section F5-F5

(Scale :- 1 : 50@ A1)

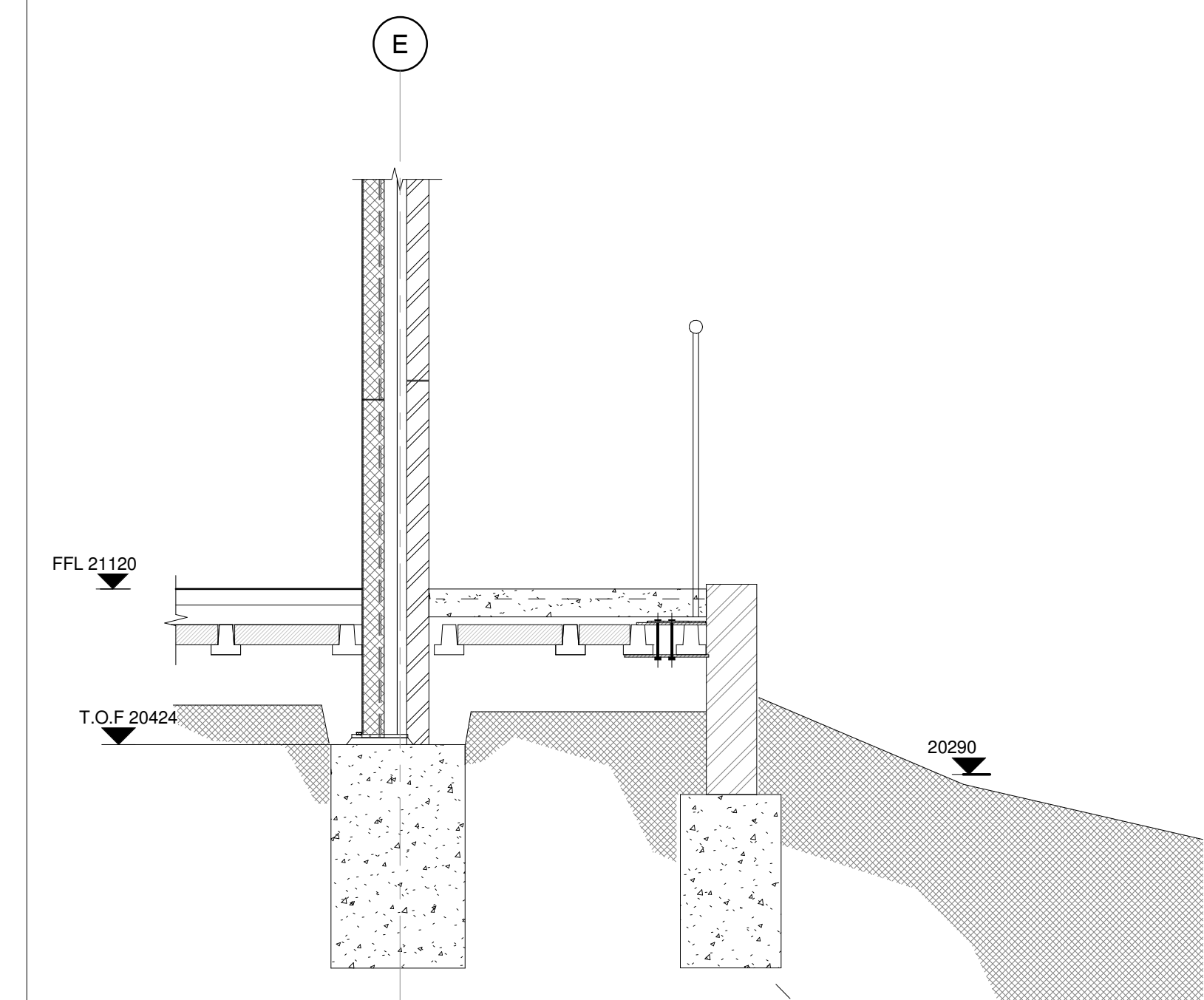

Section F6-F6

(Scale :- 1 : 25@ A1)

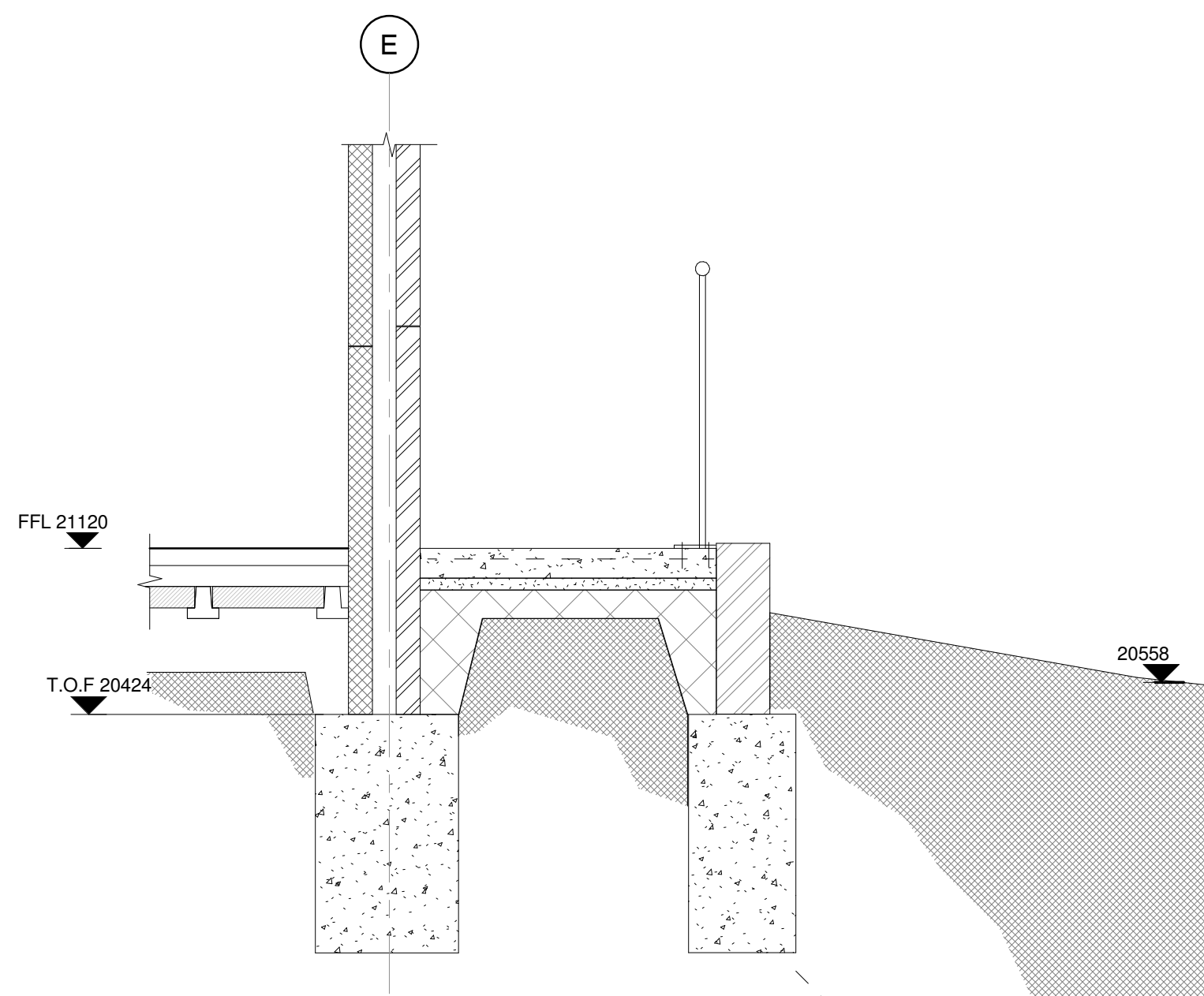

Section F7-F7

(Scale :- 1 : 25@ A1)

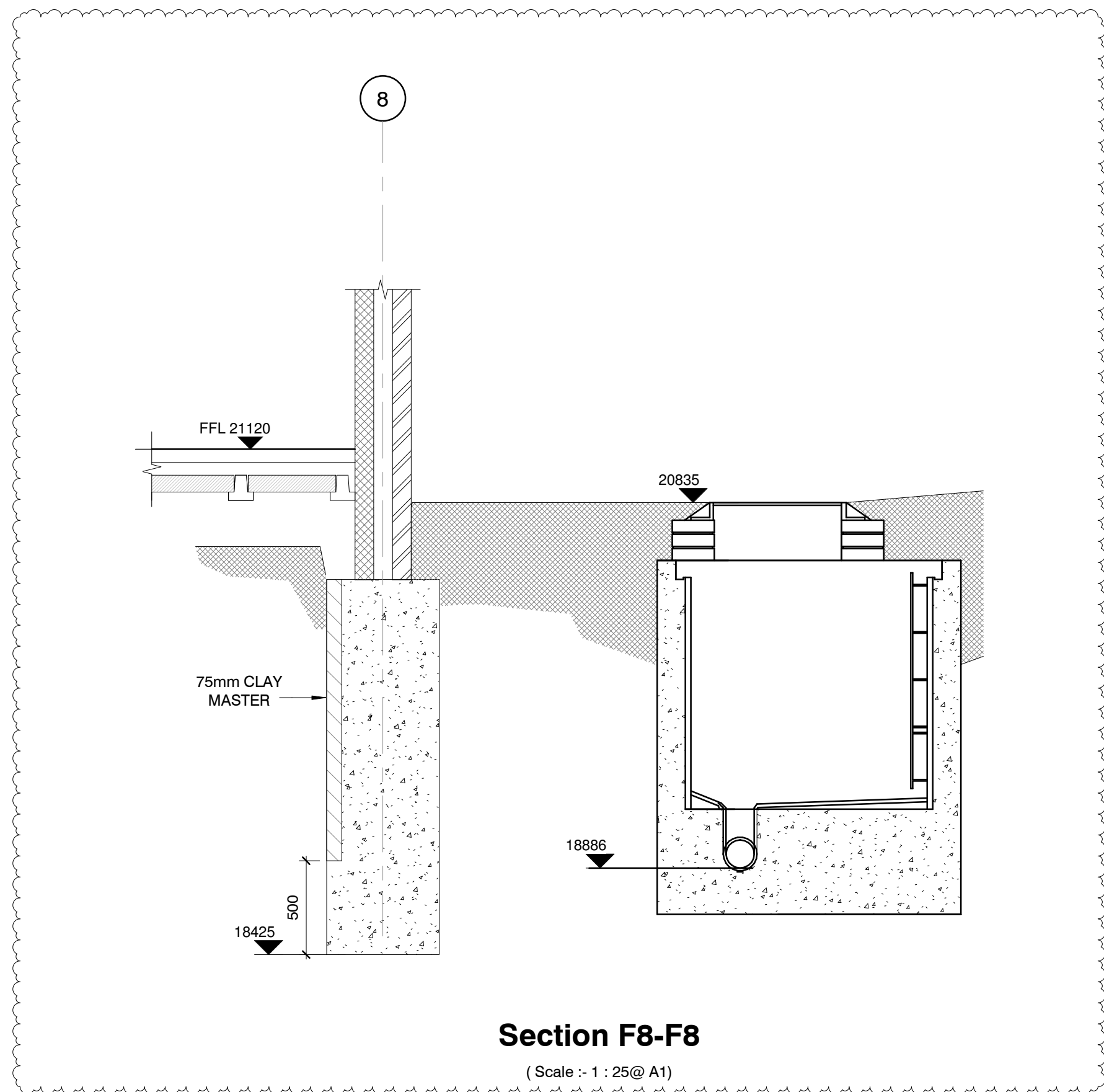

Section F8-F8

(Scale :- 1 : 25@ A1)

NOTES

©

THIS DRAWING & DESIGN IS THE COPYRIGHT OF ALAN BAXTER PARTNERSHIP AND MUST NOT BE COPIED IN PART OR WHOLE WITHOUT CONSENT.

- DO NOT SCALE OFF THIS DRAWING.
- TO BE READ IN CONJUNCTION WITH ALL ARCHITECT'S AND ENGINEERS DRAWINGS.
- ALL DIMENSIONS AND LEVELS TO BE CONFIRMED BY THE ARCHITECT AND CONTRACTOR PRIOR TO THE COMMENCEMENT OF THE WORKS.
- ALL DISCREPANCIES TO BE NOTIFIED IMMEDIATELY TO CONTRACT ADMINISTRATOR AND ENGINEERS.
- TENDER OR BILLING DRAWINGS SHALL NOT BE USED FOR CONSTRUCTION OR THE ORDERING OF MATERIALS.
- FOUNDATION FORMATION LEVELS TO BE INSPECTED AND APPROVED BY THE LOCAL AUTHORITY.

PRELIMINARY

B	GENERAL UPDATE & SECTION F8	TJM		04-02-2019
A	MOVED INSPECTION CHAMBER	TJM		17-12-2018
0	FIRST ISSUE	TJM		07-12-2018
Rev	Description	Drm	Chk	Date

ALAN BAXTER PARTNERSHIP LLP
CONSULTING STRUCTURAL ENGINEERS
THE CLOCK BUILDING
PYMPES COURT
BUSBRIDGE ROAD
LOOSE
MAIDSTONE
KENT ME15 0HZ
TELEPHONE: 01622 744263
FAX: 01622 749270
EMAIL: mail@abpengineers.co.uk

ABP

Project
**Leybourne Village Hall,
Little Market Row, West
Malling ME19 5QL**

Drawing
**Foundation Section
(2 of 2)**

Date	11/28/18	Scale	As indicated	@ A1
Ref	F437 -A1- 10			Rev B