

FILENAME : D:\DROBOX\21027 - HELLEDON PARISH COUNCIL WORKS - HELLEDON PARISH COUNCIL\2. DRAWINGS\MECHANICAL\21027 ML 50-06 HELLEDON COMMUNITY CENTRE MECHANICAL SERVICES - ENABLING WORKS - T2.DWG | PLOTTED BY : PIERRE DELHOUGNE | PLOTTED DATE : 04 AUGUST 2021 09:34:28

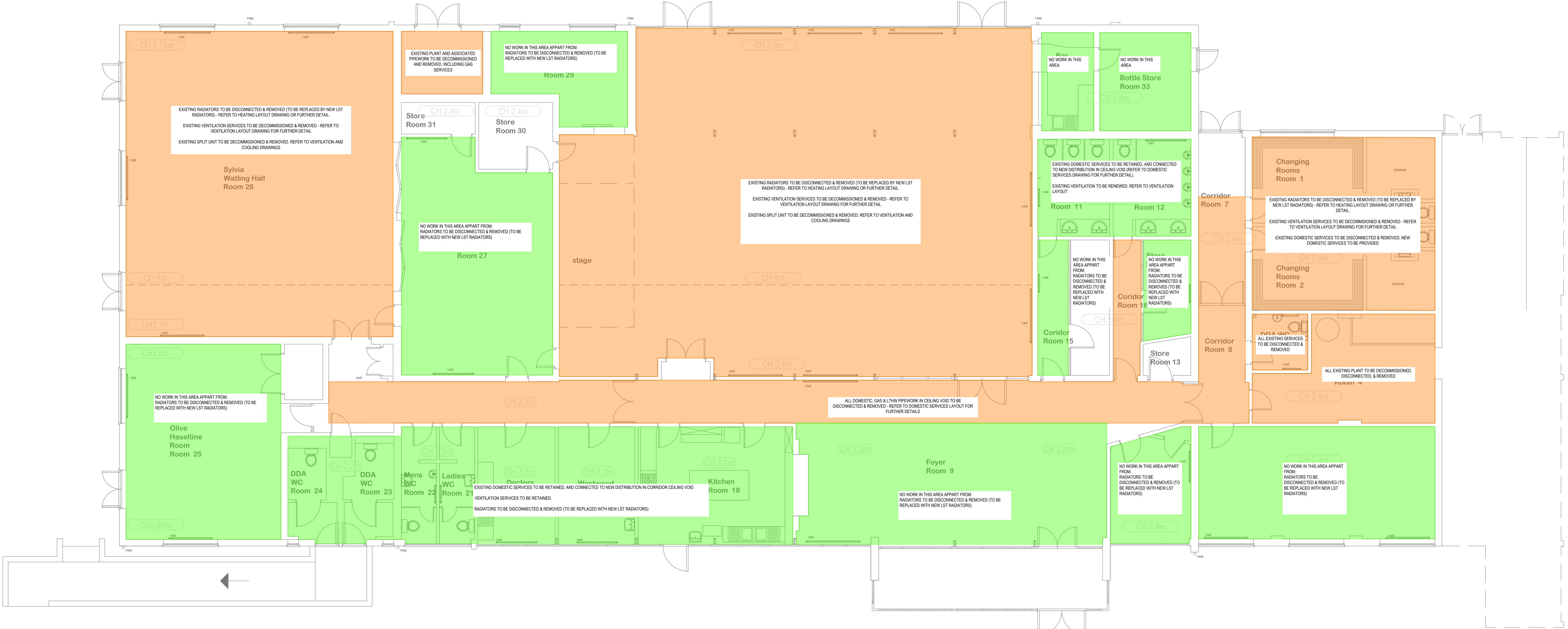

- LIGHT TOUCH REFURBISHMENT. WORK LIMITED  
REFER TO SPECIFIC LAYOUT
- REFURBISHED AREA  
REFER TO SPECIFIC LAYOUT

- NOTES:
- THIS DRAWING IS TO BE READ IN CONJUNCTION WITH ALL ASSOCIATED SPECIFICATIONS AND OTHER DESIGN TEAM MEMBERS INFORMATION.
  - ALL DETAILS REPRESENT THE PROPOSED SOLUTION AND IS SUBJECT TO FURTHER DEVELOPMENT WITH THE WIDER TEAM.
  - EXISTING AREA WHERE NO WORK HAS BEEN DESCRIBED MUST BE RETAINED WITH ALL THE SERVICES BEING RECONNECTED

TENDER ISSUE

T2	TENDER ISSUE	HF	PD	ALH	AUG 21
T1	TENDER ISSUE	HF	PD	ALH	JUL 21
P1	PRELIMINARY ISSUE	HF	PD	ALH	JUL 21
REV	DESCRIPTION	BY	CHK	APP	DATE

Client  
HELLEDON PARISH COUNCIL

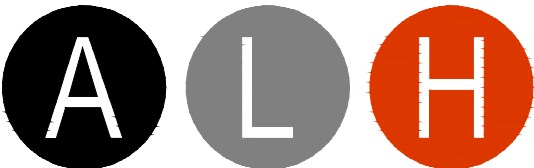

Building Services Design Ltd  
GREENRIDGE, LITTLEFIELDS, DEREHAM, NORFOLK NR19 1BQ  
Tel// Fax: 01362 652704 Mobile: 07789 815485  
email: andrew@alhdesign.co.uk

Project:  
HELLEDON COMMUNITY CENTRE  
WOODVIEW ROAD, HELLEDON  
NORFOLK, NR6 5SR

Drawing Title:  
MECHANICAL SERVICES  
ENABLING WORKS

Scale @	A1	Drawn	Date	Checked	Date	Approved	Date
	1:75	AC	JUL 21	PD	JUL 21	AJS	JUL 21
Project No.	21027	Type	ML	Drawing No.	50-06	Revision	T2