

Location Plan

Scale 1:50,000

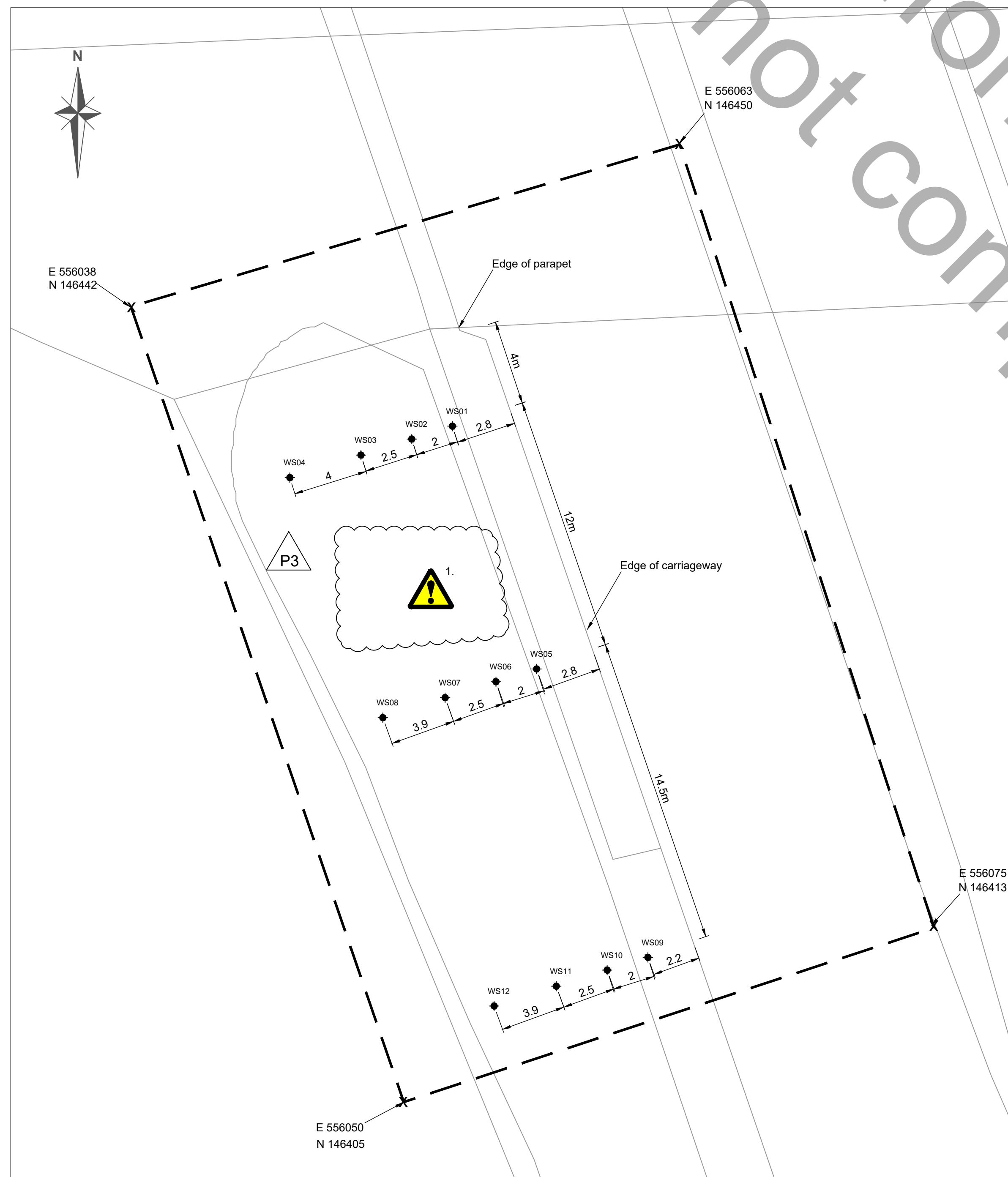
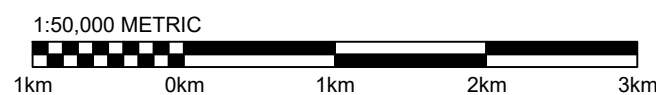

Detail A

N.T.S

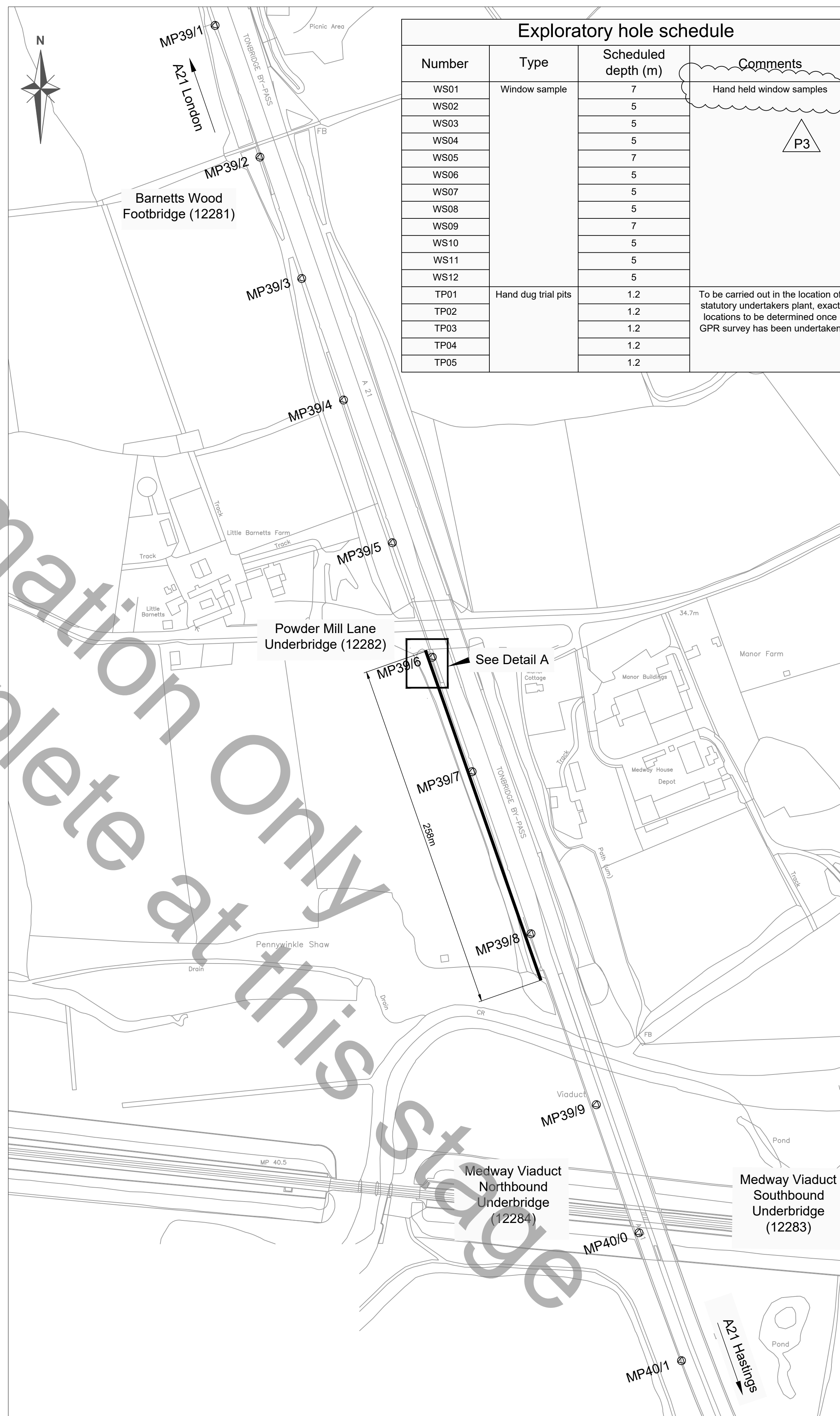

Site Plan

Scale 1:2000



Exploratory hole schedule			
Number	Type	Scheduled depth (m)	Comments
WS01	Window sample	7	Hand held window samples
WS02		5	
WS03		5	
WS04		5	
WS05		7	
WS06		5	
WS07		5	
WS08		5	
WS09		7	
WS10		5	
WS11		5	
WS12		5	
TP01	Hand dug trial pits	1.2	To be carried out in the location of statutory undertakers plant, exact locations to be determined once GPR survey has been undertaken
TP02		1.2	
TP03		1.2	
TP04		1.2	
TP05		1.2	

Notes:

- All measurements are in metres unless otherwise stated.
- Refer to accompanying specifications for details.
- Topographical survey shall be undertaken from the central white line to the bottom of the earthwork.
- Drainage survey starts at the Powder Mill Lane Underbridge to the outlet at the end of earthwork, approximately 260m in length.
- All exploratory to be hand dug for the first 1.2m to detect any buried services.
- For Statutory undertakers locations, refer to drawing HE606471-AONE-VUT-A21 PWDRMILL-DR-CE-2701.
- South East Water main to be positively identified before any exploratory holes are carried out.

Key:

Area of topographical survey

Drainage survey extents

Window samples



SAFETY, HEALTH AND ENVIRONMENTAL INFORMATION

The Contractors attention is drawn to the following Health and Safety risks associated with the following hazards

CONSTRUCTION

1. Buried Statutory Undertakers present on site

- BT
 - South East Water
 - Southern Water
 - UKPN - abandoned main
- Refer to Pre-construction Information for further information.

MAINTENANCE/CLEANING

No significant risks identified.

DECOMMISSIONING/DEMOLITION

No significant risks identified.

It is assumed that all works be carried out by a competent Contractor, working where appropriate, to an approved method statement. Further reference shall be made to the Pre-Construction Health and Safety Information.

P3	KB	MM	MT	13/10/20	SHE Box added
P2	KB	MM	MT	30/09/20	Investigation amended
P1	SH	MM	MT	07/08/20	For Information
Rev	By	Chk	App	Date	Description

INFORMATION

Client



A-one+
10 Kings Hill Avenue, Kings Hill,
Kent, ME19 4AR
Tel +44 (0)1732 446800
Email area4enquiries@aone.uk.com
Web www.aone.uk.com



Project

A21 Powder Mill Lane

Project Ref

210735

Drawing

Site Investigation Plan

Drawn : S. Haddell

Date: 05/08/2020

Designed : S. Phillips

Date: 07/08/2020

Checked : M. Mildon

Date: 07/08/2020

Approved : M. Tandy

Date: 07/08/2020

Drawing No.

HE606471

Original by

AONE

Volume

VG

Revision

P3

Location

A21 PWDRMILL - DR - CH - 0002

Drawing Scale: As Shown

Original Sheet Size A1

DO NOT SCALE FROM DRAWING