

Drainage Notes:

- All drainage within the site to be constructed in 100mm Pvcu pipework under the building, 150mm Pvcu pipework up to the boundary and outside side of the boundaries to be in 150mm clayware.
- All below ground drainage workmanship to be carried out in strict accordance with bs 8000 'workmanship of building sites, part 14: code of practice for below ground drainage'.
- All new below ground drainage works to be inspected and approved by Building Control prior to backfilling.
- Drains under buildings must be encased in 150mm of concrete.
- Drains are to pass below reinforced concrete ground beams.
- Drains running through foundations to be sleeved and wrapped with a minimum of 25mm compressible filler. Sleeve to project a minimum of 150mm either side of foundation width.
- Cover levels given to manholes are to be adjusted to suit final finished site levels.
- Covers to manholes within site boundaries are to be as follows:
 - Class D400 to heavily trafficked areas (delivery vehicles)
 - Class C250 to lightly trafficked areas (cars only)
 - Class B125 to footpath & paved areas
 - Class A15 to landscaped

Areas note that C250 and D400 covers are to be sectional covers to reduce manual handling.

- Internal manhole within Store 2 to be provided with gas-tight, double-sealed, bolted down & recessed lid.
- Minimum clear opening:
 - 600x600mm for private development
 - 675x675mm for adoptable chambers
- All pipes directly from rain water pipes (rwp), soil & vent pipes (svp) and internal trapped gullies (ig) are to be 100mm dia clayware unless stated otherwise on the plan.

MH	Invert Level	Cover Level	Depth	Pipe Size	Chamber Size	Cover Type	Notes
IC1	46.610	46.920	310mm	100mm	600X600mm	B125	Double Sealed
IC2	46.579	46.920	341mm	150mm	600X600mm	B125	Double Sealed
IC3	46.535	46.870	335mm	150mm	600X600mm	B125	
IC4	46.513	46.820	307mm	150mm	600X600mm	B125	
IC5	46.464	46.770	306mm	150mm	600X600mm	B125	
IC6	45.984	47.000	1016mm	150mm	675X675mm	D400	Brick Built Chamber
IC7	45.901	47.251	1350mm	150mm	600mm dia	Existing	Concrete Ring

DIMENSION 'A'
 MACHINE-DUG UNIFORM SOILS
 100mm OR 1/6 Bc WHICHEVER IS GREATER (UNDER BARRELS)
 ROCK OR MIXED SOILS
 200mm OR 1/4 Bc WHICHEVER IS GREATER (UNDER BARRELS)

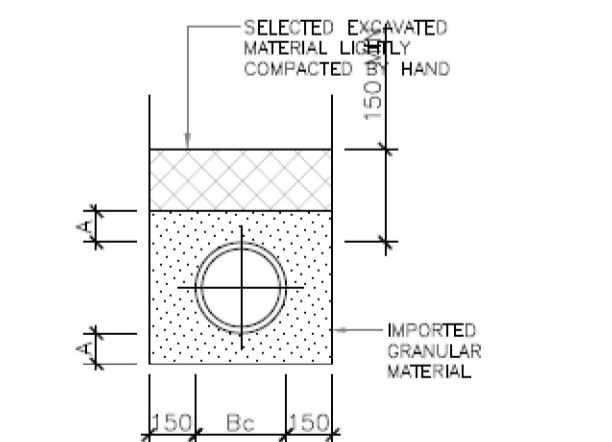
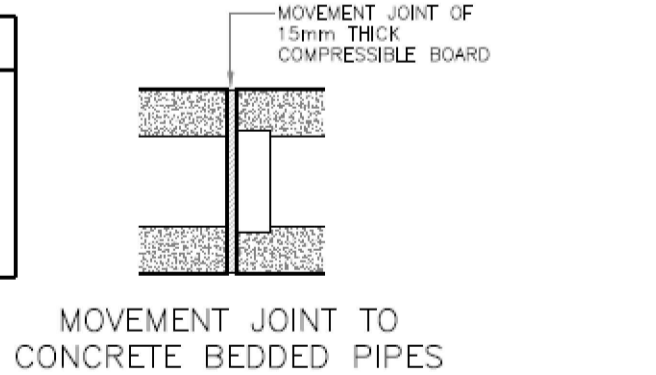

CLASS 'S' BEDDING
(BEDDING FACTOR 2.2)

CONCRETE BEDDING
(BELOW BUILDING)

NOMINAL PIPE BORE	ALTERNATIVE AGGREGATE SIZES (mm)	
	SINGLE-SIZED	GRADED
100	10	-
150	10 OR 14	14 TO 5
225 - 300	10, 14 OR 20	14 TO 5 OR 20 TO 5
375 - 525	14 OR 20	14 TO 5 OR 20 TO 5
EXC 525	14, 20 OR 40	14 TO 5, 20 TO 5 OR 40 TO 5

NOTES:
 1. PIPES TO BE SURROUNDED IN CONCRETE SHALL BE SUPPORTED ON PRECAST CONCRETE SETTING BLOCKS. THE TOP FACE OF EACH BLOCK BEING COVERED WITH TWO LAYERS OF COMPRESSIBLE PACKING.
 2. WHERE PIPES WITH FLEXIBLE JOINTS ARE USED THE CONCRETE PROTECTION SHALL BE INTERRUPTED OVER ITS FULL CROSS SECTION AT EVERY JOINT POSITION BY A SHARP FORMER OF COMPRESSIBLE FILLER.

PIPE DIA	ROCKER PIPE LENGTH
150-450	0.5-0.75
451-750	0.75-1.0

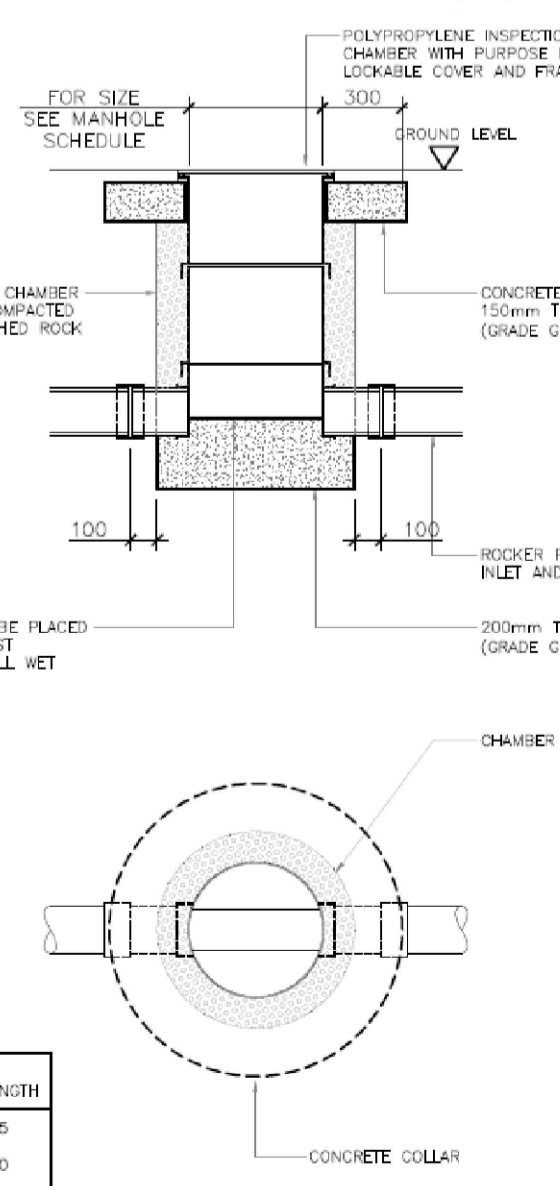

POLYPROPYLENE EXTERNAL MANHOLE DETAIL.

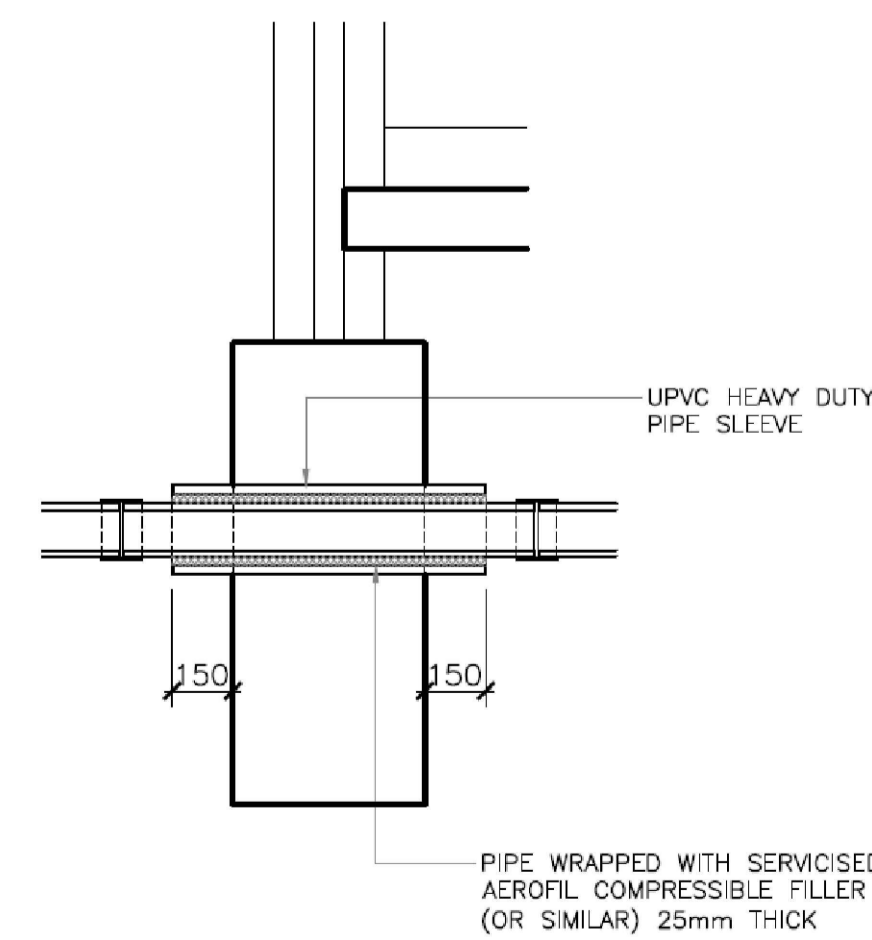

DETAIL OF PIPE CAST THROUGH FOUNDATION.

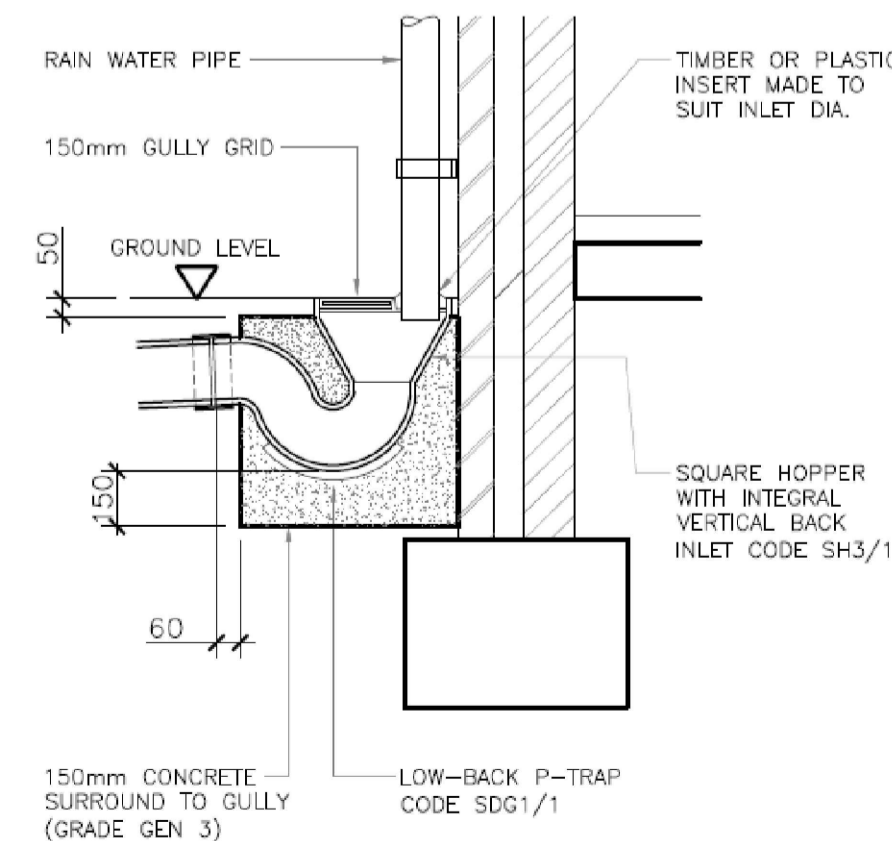

EXTERNAL RWP BACK INLET GULLY DETAIL.

Important

Any discrepancies are to be notified to the designer at once.

This drawing is subject to copyright and may not be copied or disclosed either wholly or in part without the written consent of Malvern Hills District Council.

The contractor is advised to visit site before tendering. The contractor shall be deemed to have satisfied himself before tendering, of the full nature and extent of the works involved.

REVISIONS				
Tender Issue				
Malvern Hills District Council				
Estates and Facilities				
TITLE Powick Playing Fields - Proposed Pavilion & Carpark Proposed Hardstanding to Pavilion				
© COPYRIGHT THIS DRAWING MAY NOT BE REPRODUCED OR COPIED				
CUSTOMER	Powick Parish Council	DRN	JRY	JOB No. 2034
SITE ADDRESS	Hamilton Close	DATE	Feb 20	DRG No.
Powick, WR2 4NH		SCALE	1:100	PC008 A1