

A1 SECTION A-A Viewing North 1:200

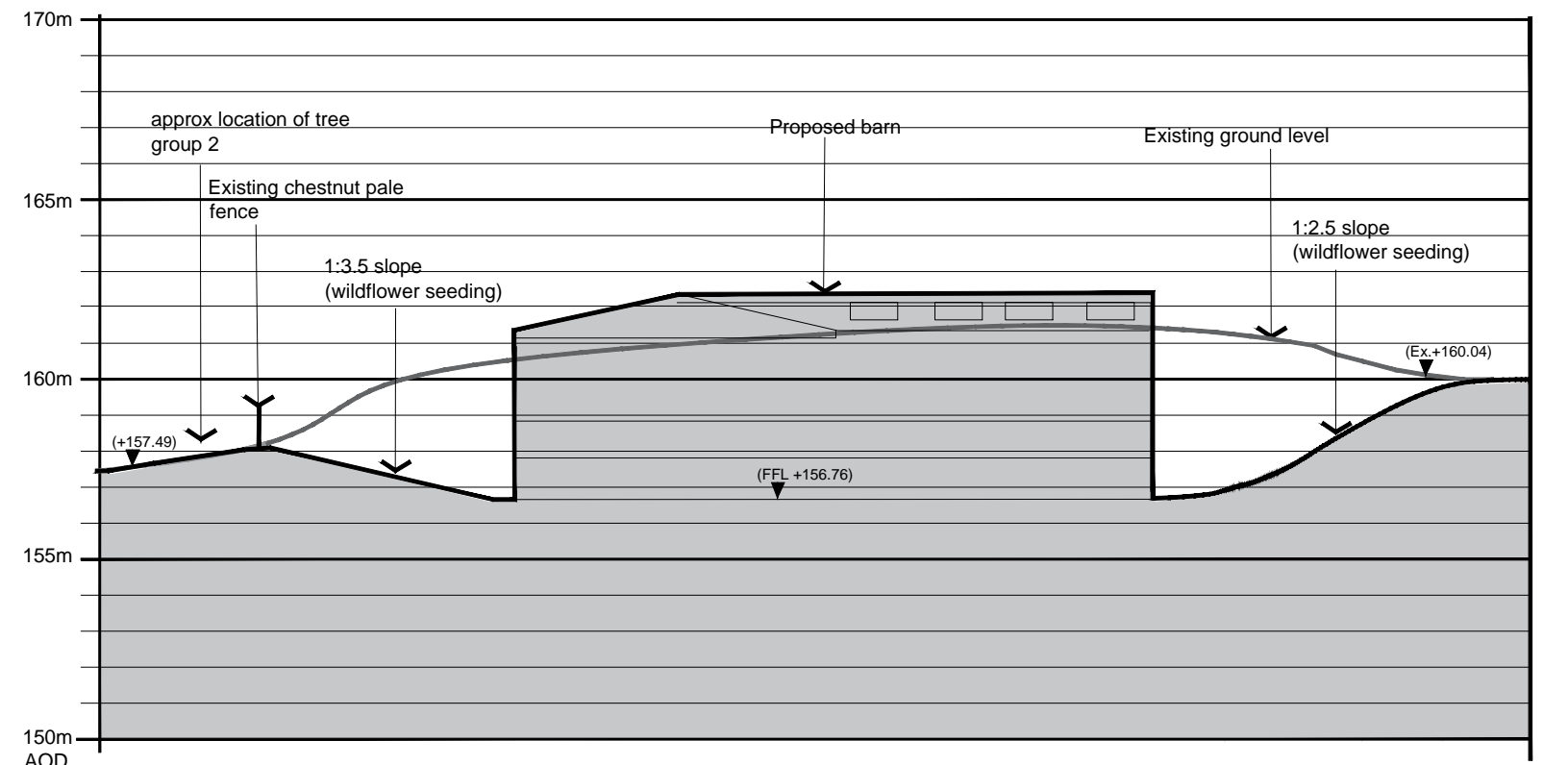

B1 SECTION B-B viewing East 1:200

**NOTES:**  
Slopes to be seeded with a wildflower seed mix such as Emorsgate EM6F (or similar suitable for chalk) and sown directly onto exposed chalk, subsoils or very thin topsoils and broadcast and managed in accordance with the suppliers recommendations. Check finished slopes on completion of earthworks and adjust seed mix accordingly if necessary subject to site conditions.

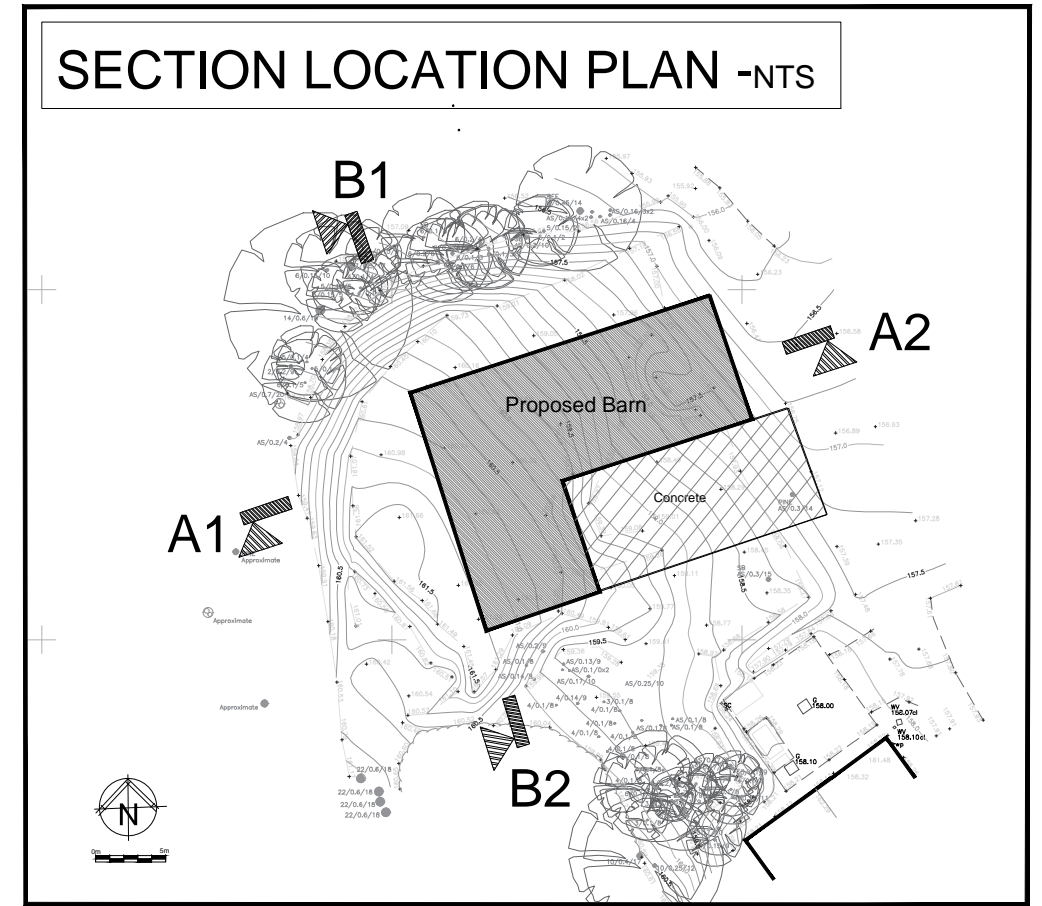

| T: 01672 810516 | E: Enquiries@acla-ltd.com | W: acla-ltd.com |

Client:  
**Marlborough Town Council**

Project:  
**Barn to the East of Marlborough Golf Club**

Dwg Title:  
**Sections**

Scale 1:200 @A3	Date 07/21	DB AC	Dwg No ACLA/BMQ 01	Rev
-----------------------	---------------	----------	-----------------------	-----