

Note : For full specification for detailing and workmanship, refer to supporting HSHAZ "Detail Specification" document.

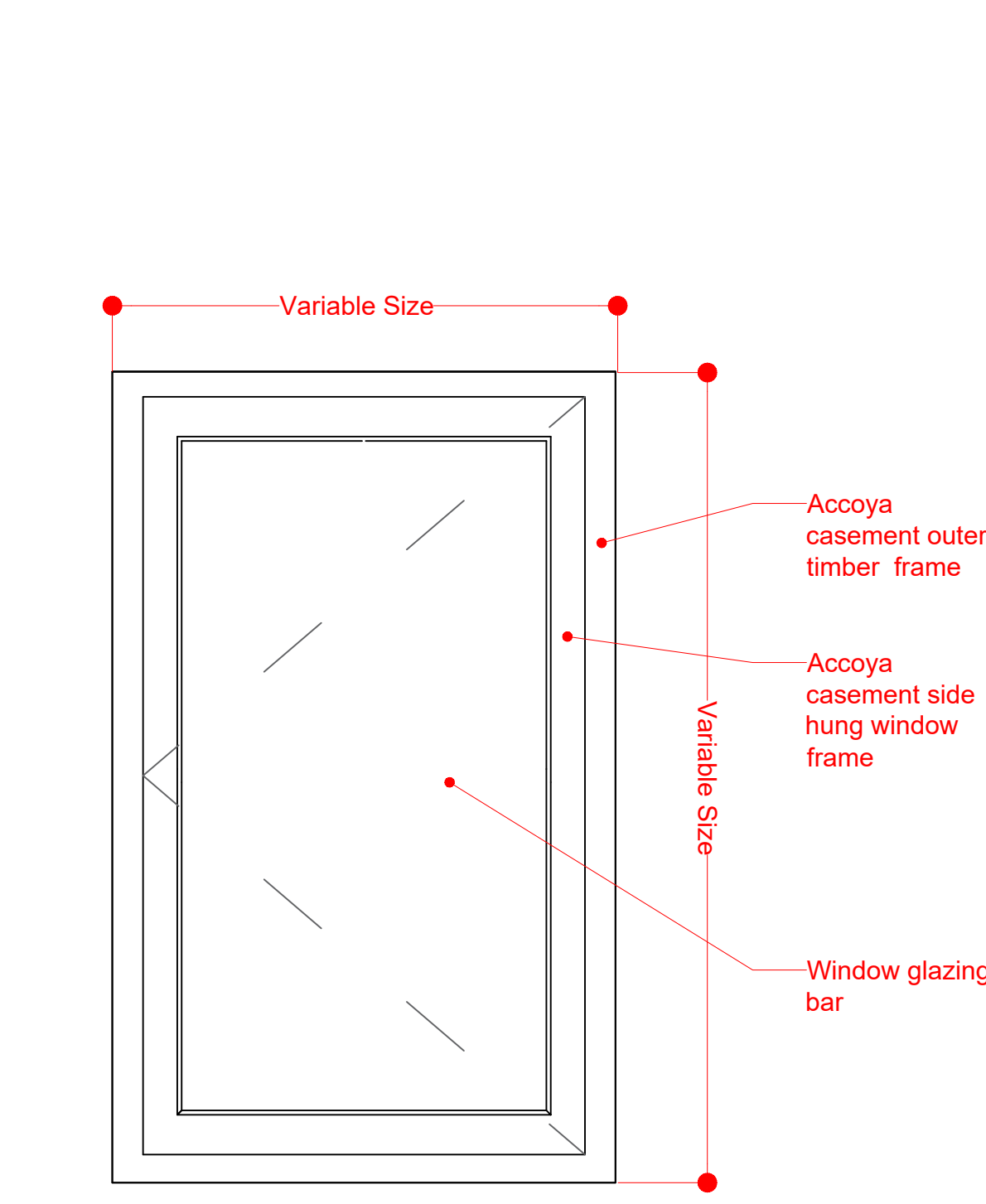

1 Casement Window Elevation
Scale 1:10 @A3

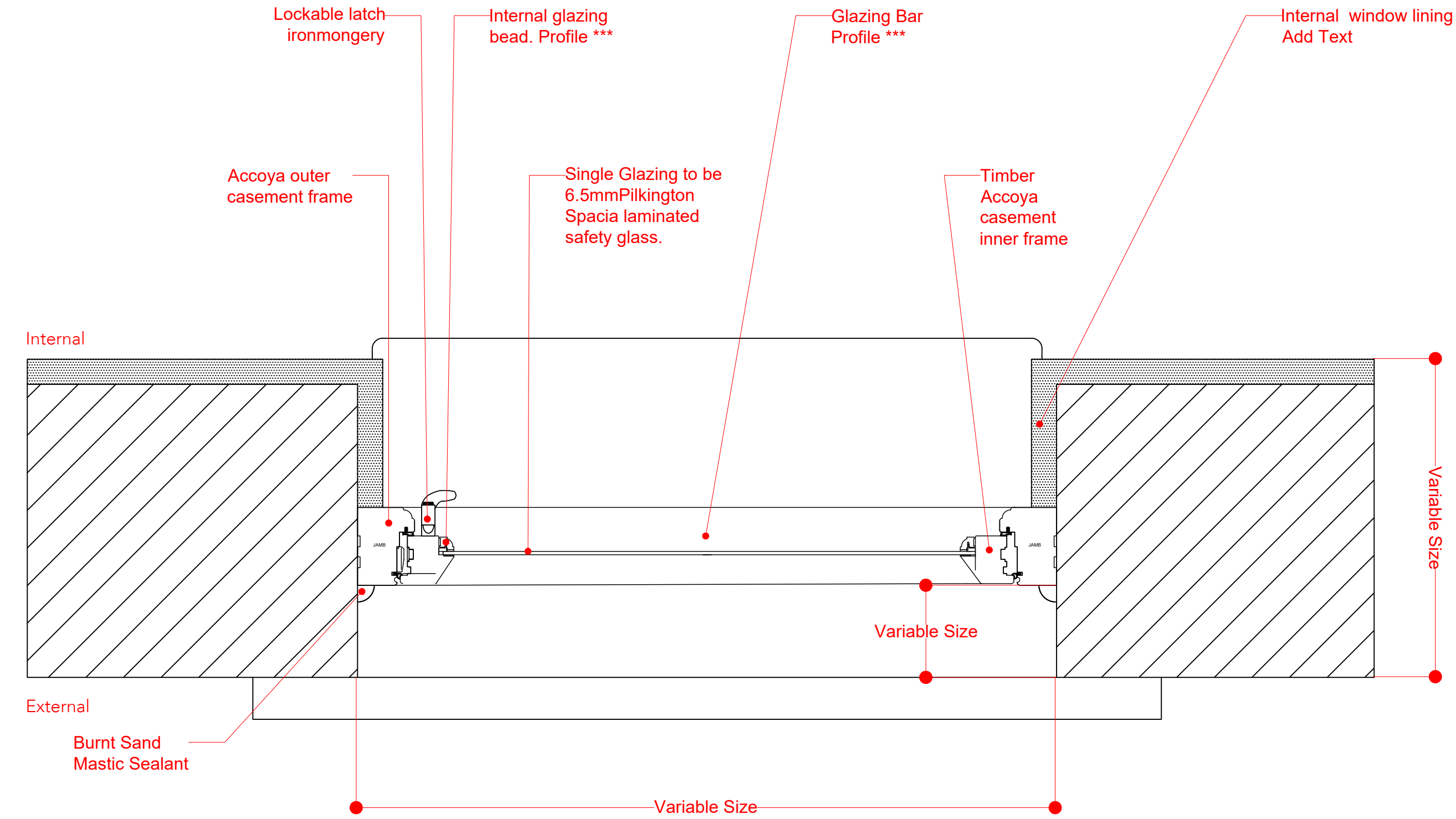

2 Casement Window Plan Detail
Scale 1:5 @A3

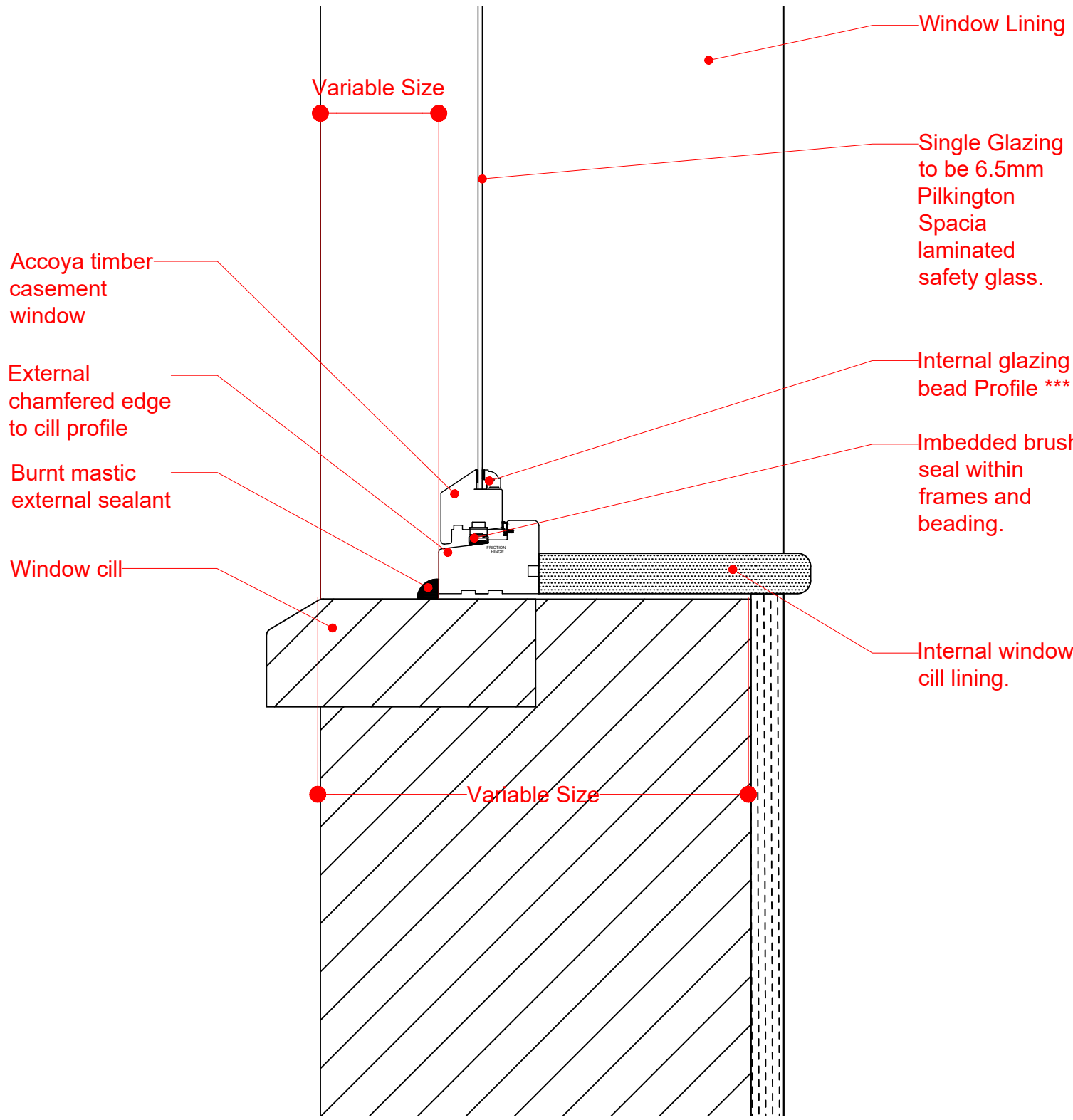

3 Casement Window Cill Detail
Scale 1:5 @A3

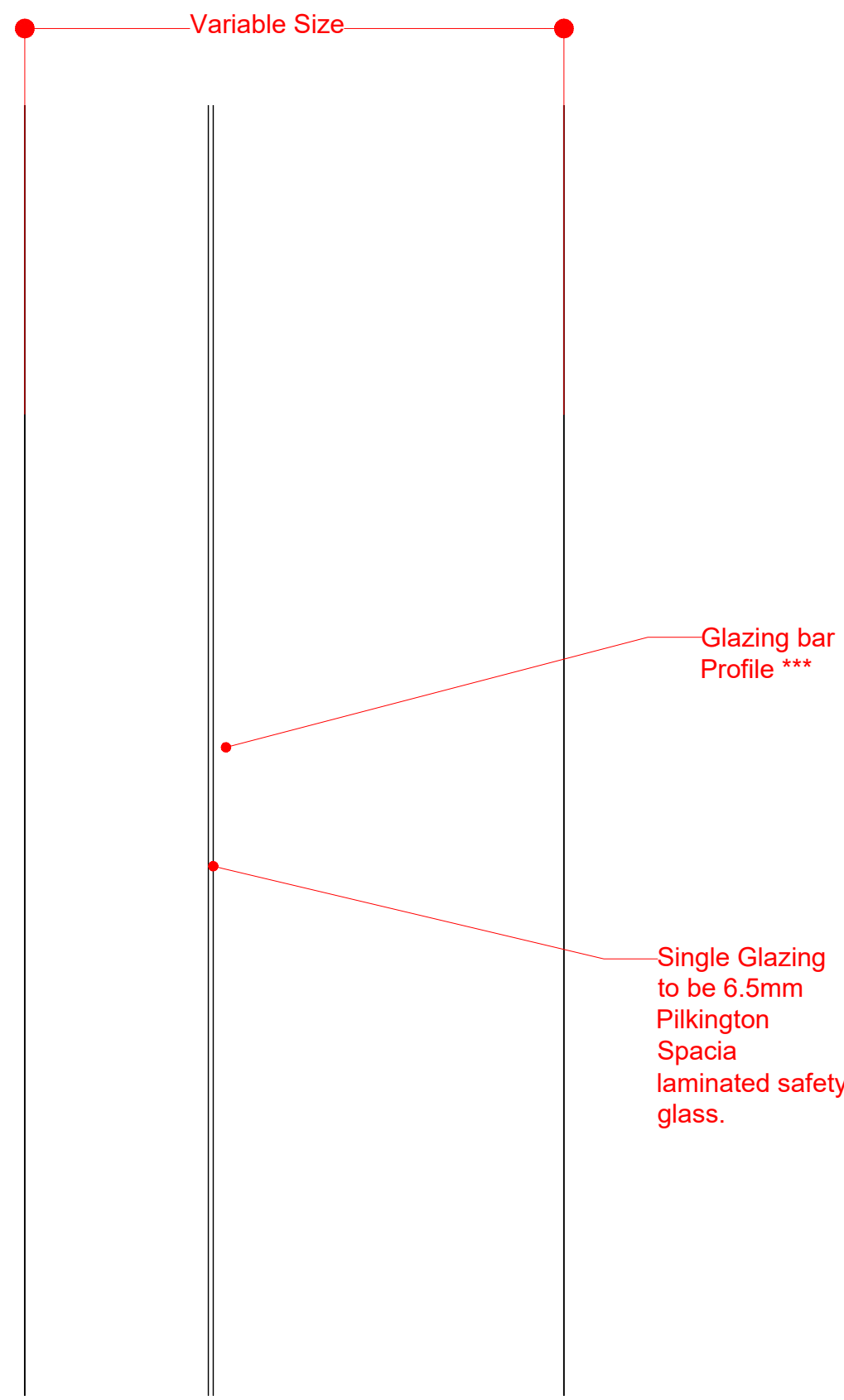

4 Casement Window Glazing Bar Detail
Scale 1:5 @A3

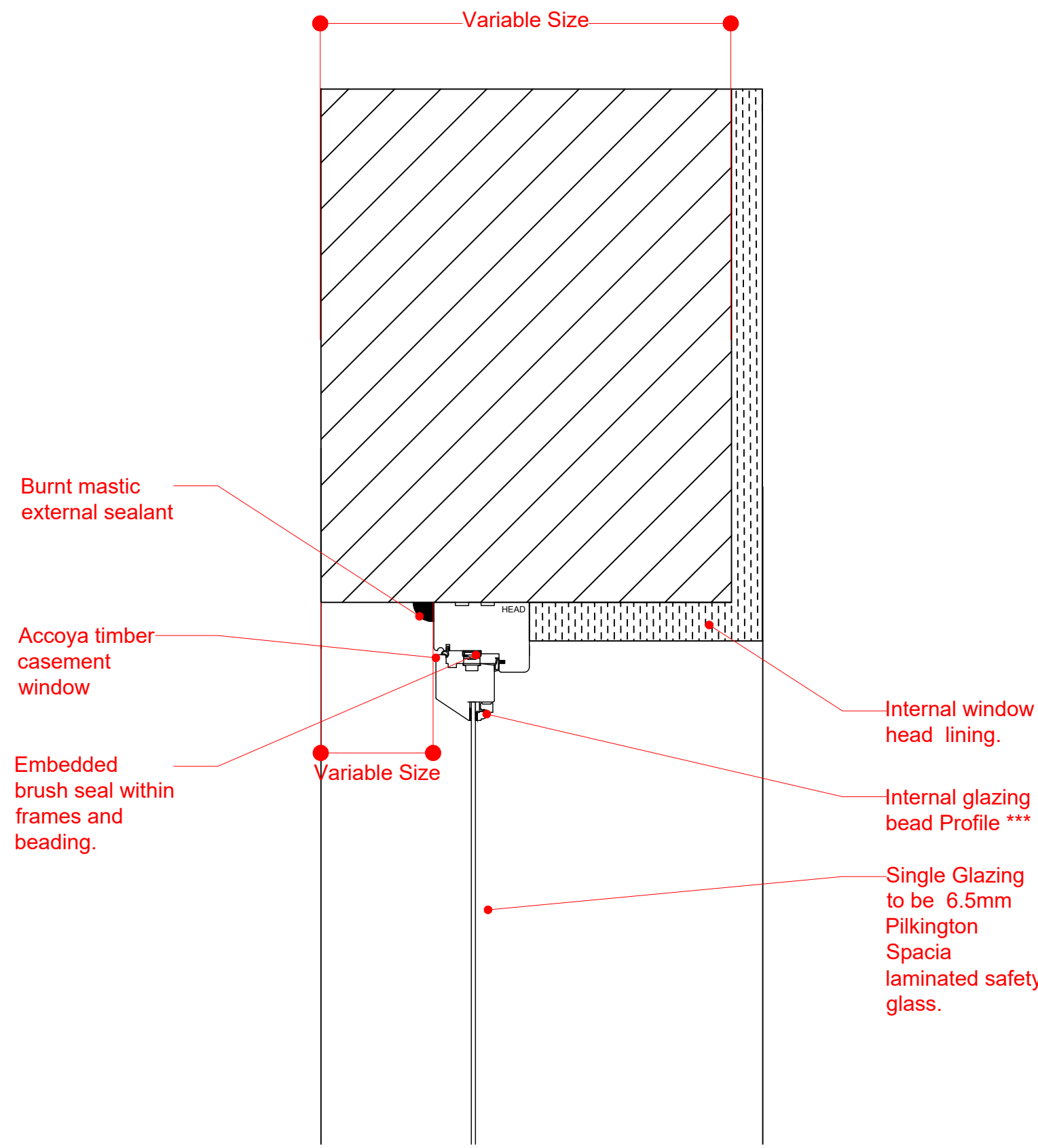

5 Casement Window Head Detail
Scale 1:5 @A3

Rev	11/12/2020	Tender Review
LB		
Rev	Date/Ints	Details
© The moral rights of the author are hereby asserted. This drawing and design is the sole property of Buttress Ltd and must not be reproduced without permission. Buttress Ltd is Registered in England and Wales: 3363173.		

<div>Buttress</div> <div>41 Bengal St Manchester M4 6AF</div> <div>T 0161 236 3303 E contact@buttress.net W www.buttress.net</div>			
Project Title	Bacup Derelict Buildings		
Client	Rossendale Borough Council		
Location	Bacup		
Drawing Title	Casement Window Type - Single Glazed Detail Drawings -		
Date	10/12/2020	Scale	1:10 & 1:5
Checked	KC	Orig Paper Size	A1
Status Tender			
Drawing ref	Job No	Drawing No	Revision
	8920	(31) 005	B