

Title number **DN619982**
Ordnance Survey map reference **SS8300NW**
Scale **1:2500**
Administrative area **Devon: Mid Devon**

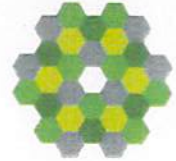

© Crown Copyright. Produced by Land Registry. Reproduction in whole or in part is prohibited without the prior written permission of Ordnance Survey. Licence Number 100026316.



This title plan shows the general position, not the exact line, of the boundaries. It may be subject to distortions in scale. Measurements scaled from this plan may not match measurements between the same points on the ground. See Land Registry Public Guide 19 - Title Plans and Boundaries.

This title is dealt with by Land Registry, Plymouth Office.

Land Registry

Current title plan

Title number **DN576944**
Ordnance Survey map reference **SS8300SW**
Scale **1:1250 enlarged from 1:2500**
Administrative area **Devon : Mid Devon**

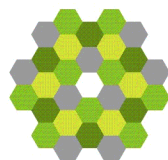

©Crown Copyright. Produced by Land Registry. Reproduction in whole or in part is prohibited without the prior written permission of Ordnance Survey. Licence Number 100026316.

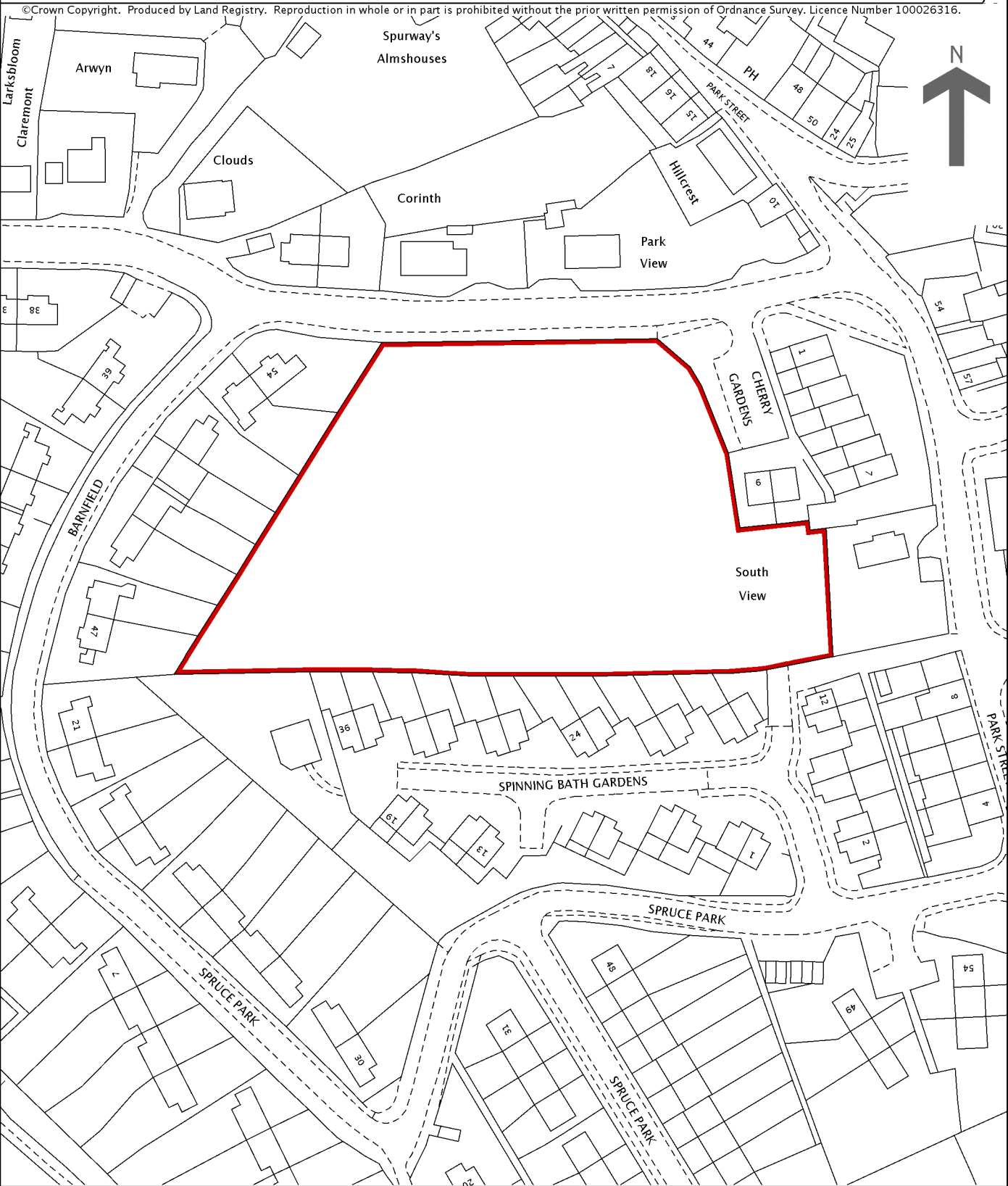

This is a copy of the title plan on 24 NOV 2016 at 09:25:03. This copy does not take account of any application made after that time even if still pending in the Land Registry when this copy was issued.

This copy is not an 'Official Copy' of the title plan. An official copy of the title plan is admissible in evidence in a court to the same extent as the original. A person is entitled to be indemnified by the registrar if he or she suffers loss by reason of a mistake in an official copy. If you want to obtain an official copy, the Land Registry web site explains how to do this.

The Land Registry endeavours to maintain high quality and scale accuracy of title plan images. The quality and accuracy of any print will depend on your printer, your computer and its print settings. This title plan shows the general position, not the exact line, of the boundaries. It may be subject to distortions in scale. Measurements scaled from this plan may not match measurements between the same points on the ground.

This title is dealt with by Land Registry, Plymouth Office.

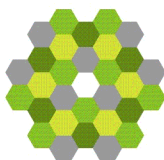

©Crown Copyright. Produced by Land Registry. Reproduction in whole or in part is prohibited without the prior written permission of Ordnance Survey. Licence Number 100026316.

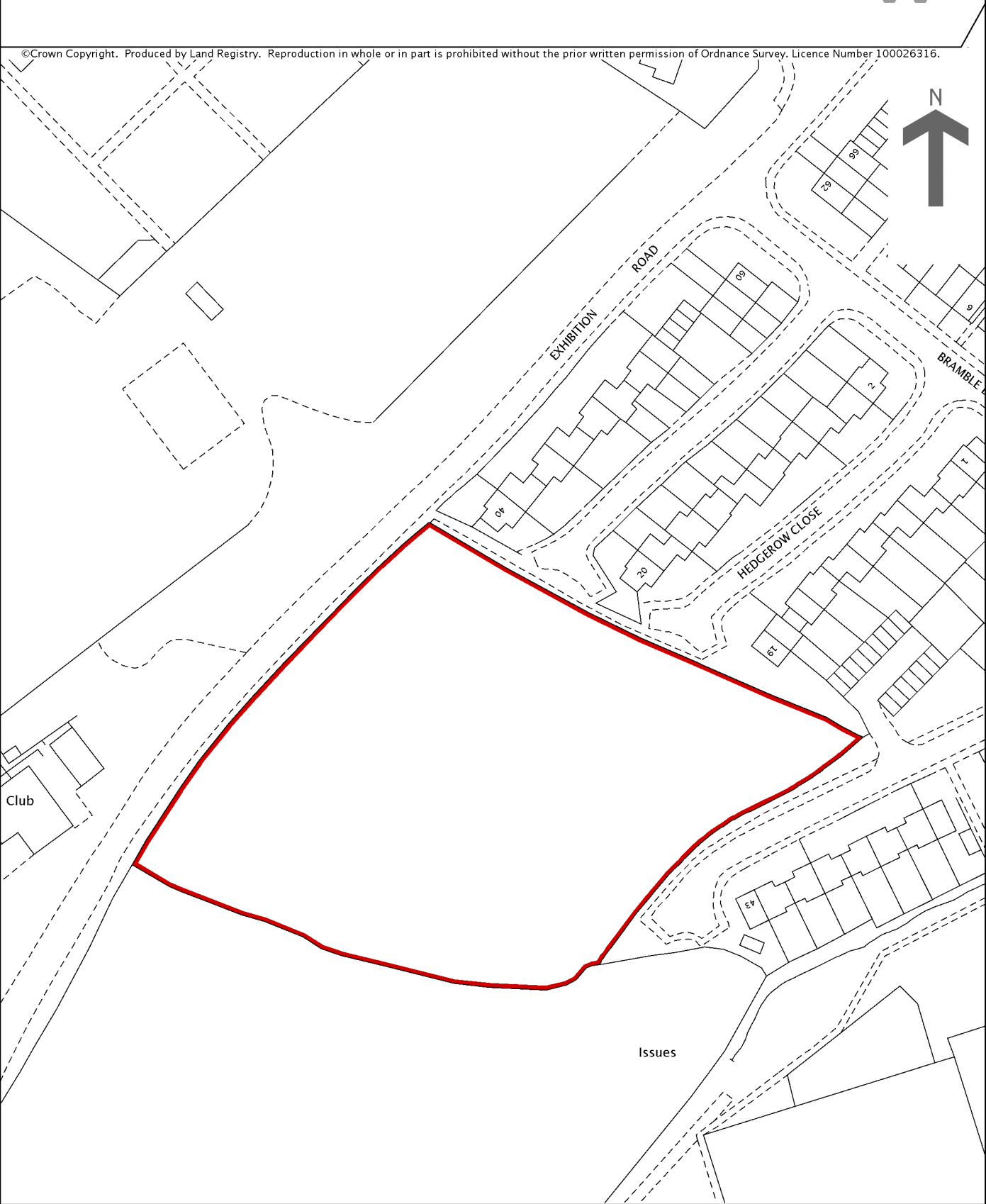

This is a copy of the title plan on 24 NOV 2016 at 09:26:57. This copy does not take account of any application made after that time even if still pending in the Land Registry when this copy was issued.

This copy is not an 'Official Copy' of the title plan. An official copy of the title plan is admissible in evidence in a court to the same extent as the original. A person is entitled to be indemnified by the registrar if he or she suffers loss by reason of a mistake in an official copy. If you want to obtain an official copy, the Land Registry web site explains how to do this.

The Land Registry endeavours to maintain high quality and scale accuracy of title plan images. The quality and accuracy of any print will depend on your printer, your computer and its print settings. This title plan shows the general position, not the exact line, of the boundaries. It may be subject to distortions in scale. Measurements scaled from this plan may not match measurements between the same points on the ground.

This title is dealt with by Land Registry, Plymouth Office.

Land Registry
Official copy of
title plan

Title number **DN606873**
Ordnance Survey map reference **SS8200NW**
Scale **1:1250** enlarged from 1:2500
Administrative area **Devon: Mid Devon**

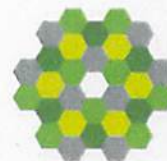

© Crown Copyright. Produced by Land Registry. Reproduction in whole or in part is prohibited without the prior written permission of Ordnance Survey. Licence Number 100026316.



This official copy issued on 7 December 2010 shows the state of this title plan on 7 December 2010 at 09:49:50. It is admissible in evidence to the same extent as the original (s.67 Land Registration Act 2002).

This title plan shows the general position, not the exact line, of the boundaries. It may be subject to distortions in scale. Measurements scaled from this plan may not match measurements between the same points on the ground. See Land Registry Public Guide 19 - Title Plans and Boundaries.

This title is dealt with by Land Registry, Plymouth Office.

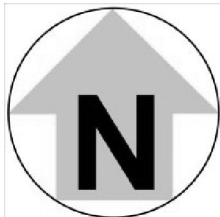

Site
Crediton

Location
Greenway Play Area

Scale: Not to scale
Drg. No: 1

Date: 8 March 2012
Produced by: Adrian Cook

Customer Services, Estates Management
Phoenix House
Phoenix Lane, Tiverton EX16 6PP

Tel: 01884 255255
Website: www.middevon.gov.uk

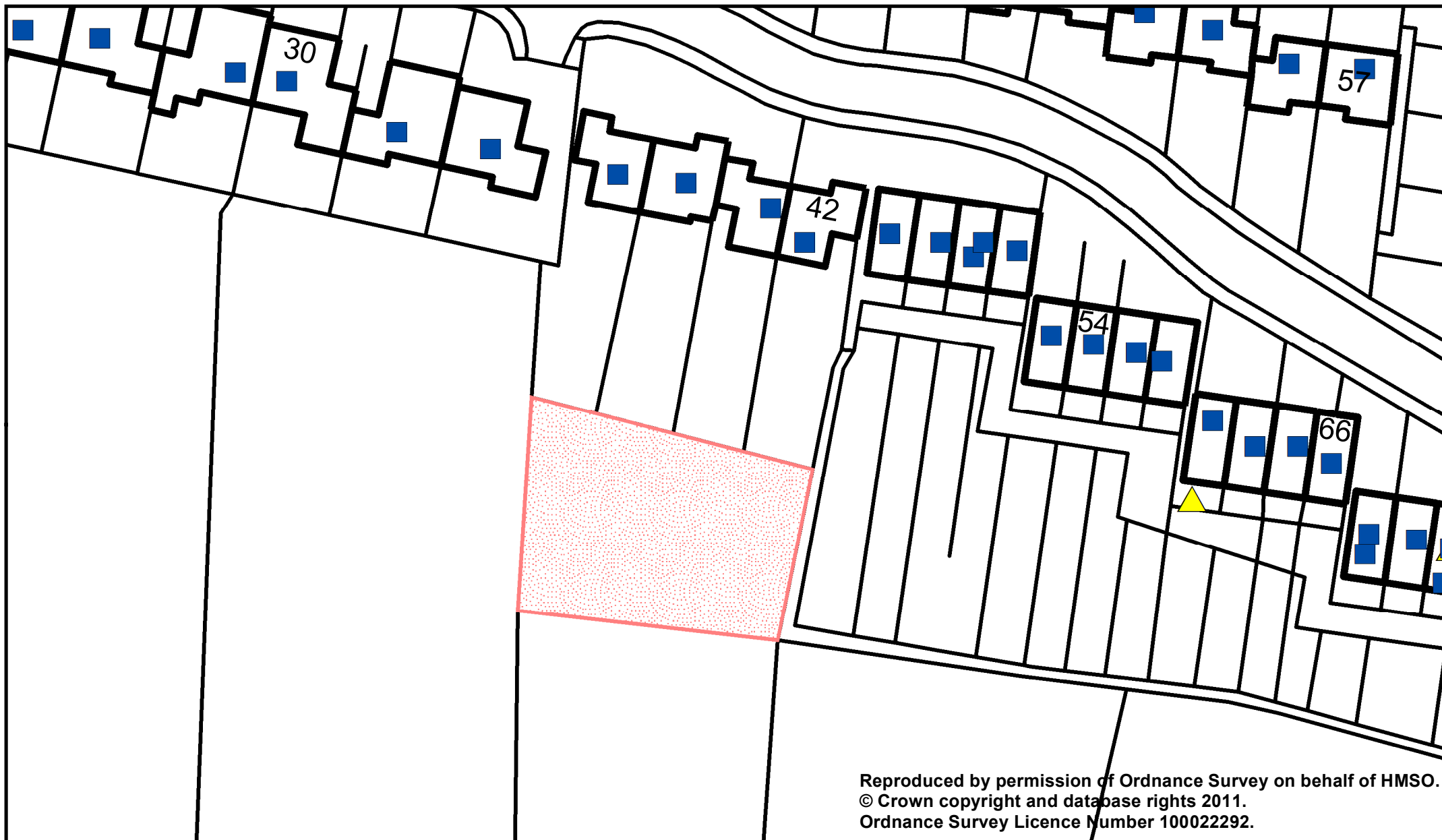

Reproduced by permission of Ordnance Survey on behalf of HMSO.
© Crown copyright and database rights 2011.
Ordnance Survey Licence Number 100022292.

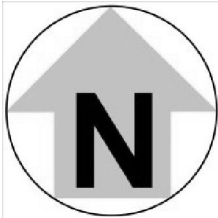

Site

Crediton

Location

**Spinning Path Gardens
Play Area**

Customer Services, Estates Management
Phoenix House
Phoenix Lane, Tiverton EX16 6PP

Tel: 01884 255255

Website: www.middevon.gov.uk



Scale: Not to scale

Date: 14 June 2016

Drg. No: 1

Produced by: Adrian Cook

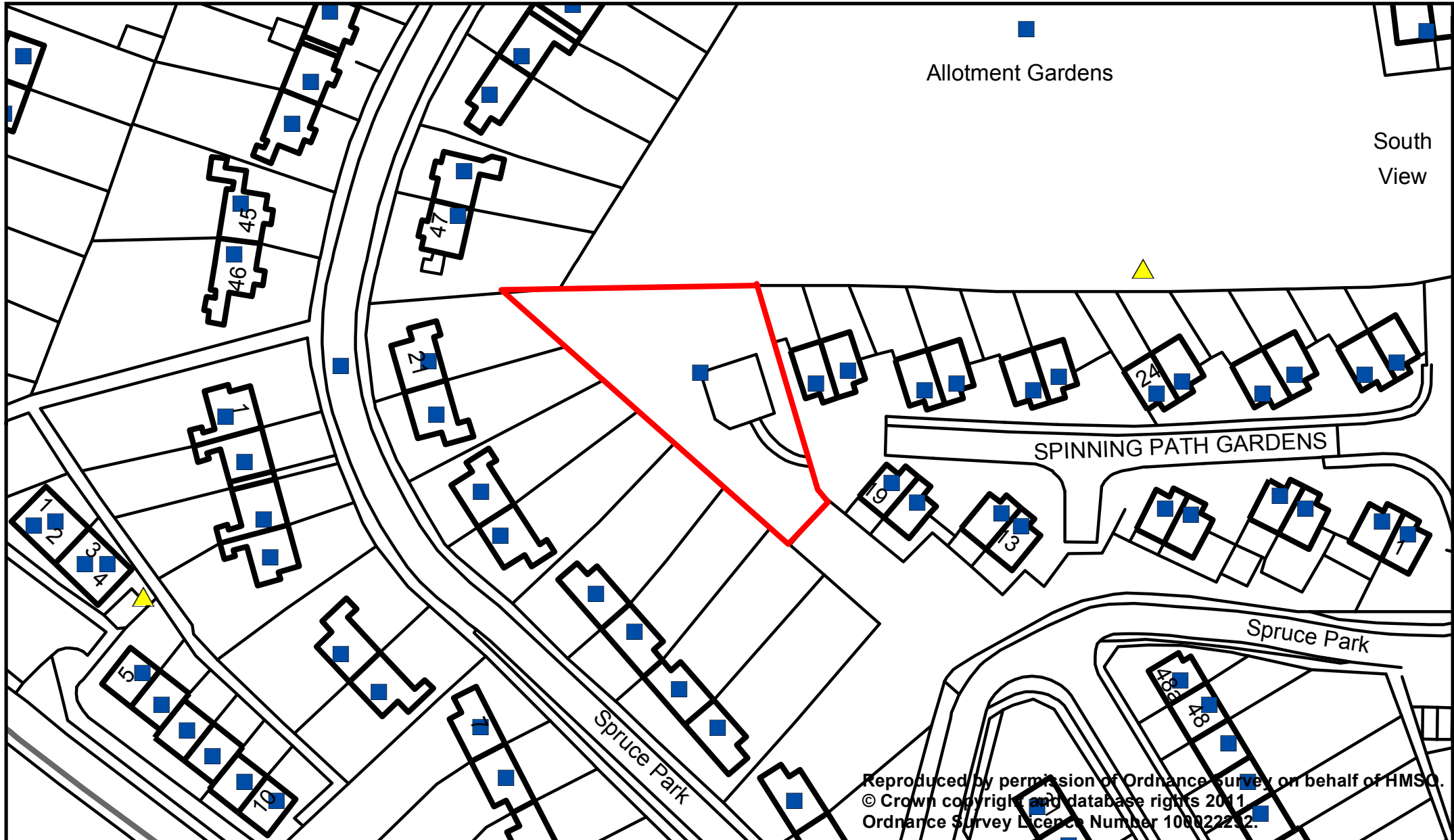

Reproduced by permission of Ordnance Survey on behalf of HMSO.
© Crown copyright and database rights 2011.
Ordnance Survey Licence Number 100022232.