

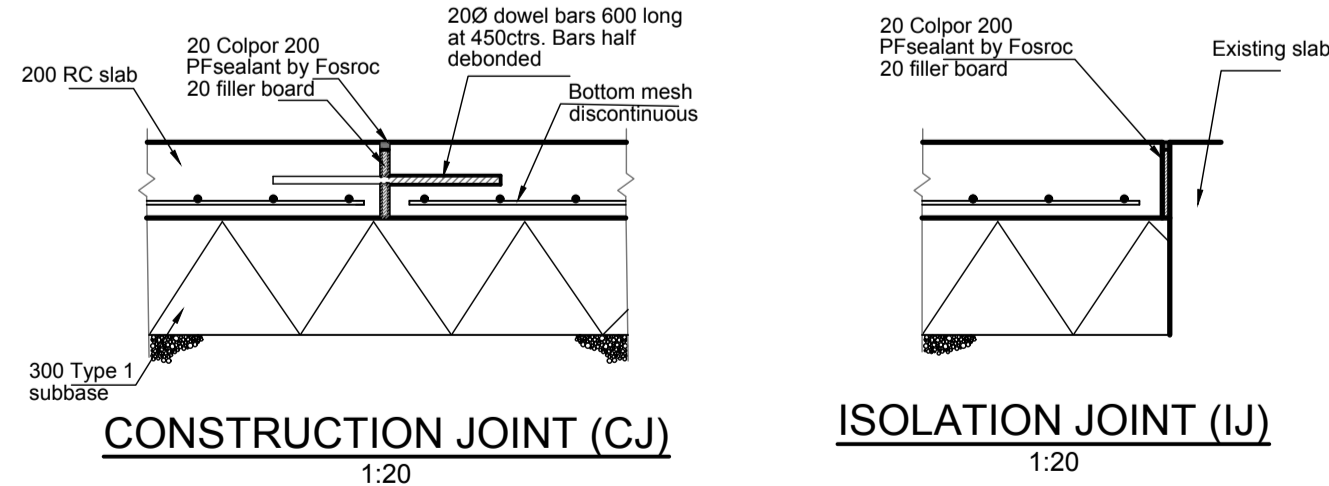

- NOTES
1. This drawing is to be read in conjunction with all other relevant Engineers, Architects, Specialists details and the Specification.
  2. Any grid lines, building lines, etc., are to be set out in accordance with the relevant Architects drawings.
  3. Dimensions marked \* are subject to confirmation by site measurement before construction commences.
  4. Any dimensional discrepancies on this drawing are to be referred to the Engineer before the affected work proceeds
  5. All works to comply with DfT Manual of Contract Documents for Highway Works, Specification for Highway Works
  6. Excavate down to formation level and proof roll prior to pavement construction, in accordance with the Specification. Any soft areas shall be excavated out and backfilled and consolidated with approved fill material to 6F2 specification laid and compacted in no greater than 250mm thick layers.
  7. All fill material and subbase shall be laid and compacted in layers.
  8. Concrete to be grade PAV2 to BS 8500.
  9. Reinforcement mesh to comply with BS 4483
  10. Finish to concrete to be brushed finish with 150 wide steel trowelled edges



WORK IN PROGRESS

Rev	By	Chk'd	Date
PRELIMINARY			
Client			
Project			
THE PIRBRIGHT INSTITUTE WOKING GU21 0NF			
Title			
VEHICLE TURNING AREA SETTING OUT			
	Job No.	Drg No.	Rev
	10068	11	-
	Drawn by	Date	
	rw	17.1.19	
Checked by	Scale		
ICD	1:100 @ A1		
© Copyright belongs to GURNEY consulting engineers Hallmark House, 10/12 St Johns Rd, Woking, Surrey. GU21 7SE tel: 01483 721721 fax: 01483 725073 e-mail: gce@gurneyce.com			