

KEY PLAN (NTS)

ELECTRIC WATER HEATER SCHEDULE											
Ref	Location	Heater									Accessories
		Manufacturer	Type	Capacity (litres)	Height (mm)	Length (mm)	Depth (mm)	Model	Rating (KW)		
EWH01	Access WC 1	Ariston	Andris Lux	10	360	360	298	10 U	3.0	Kit A Expansion Vessel, Kit B PRV Kit C Tundish	
EWH02	Treatment Room 2	Ariston	Andris Lux	15	360	360	346	15 U	3.0	Kit A Expansion Vessel, Kit B PRV Kit C Tundish	
EWH03	Kitchen	Ariston	Andris Lux	15	360	360	346	15 U	3.0	Kit A Expansion Vessel, Kit B PRV Kit C Tundish	
EWH04	Plant Room	Ariston	Andris Lux	15	360	360	346	15 U	3.0	Kit A Expansion Vessel, Kit B PRV Kit C Tundish	

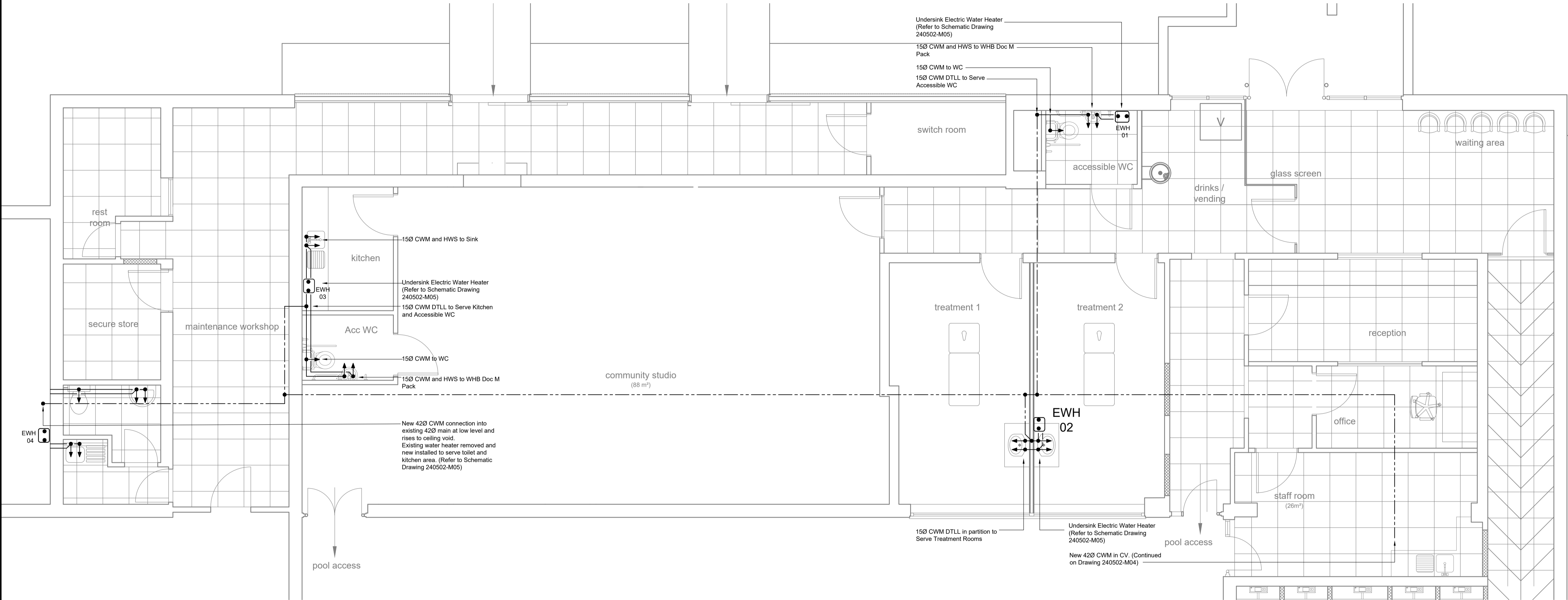

This drawing is not to be scaled. All dimensions to be checked on site and any discrepancies to be reported to PB Design and Consultancy Ltd. All material is produced on behalf of PB Design and Consultancy Ltd. All drawings to be read in conjunction with specification where applicable.

GENERAL NOTES

This drawing to be read in conjunction with the mechanical specification

Do not Scale from this drawing

DRAWING SPECIFIC NOTES

- This drawing to be read in conjunction with schematic drawing 240502-M05.
- All domestic water pipework to be installed using press fit copper except where pipework is installed within wall fabric where soldered joints shall be used and all pipework tested prior to closing up.
- All TMV's complete with strainers, check valve and isolation valves
- Drain cooks to be provided at all low points.
- Wash basins and sinks to be fitted with combined isolation/flow restriction valves.
- All pipework in ceiling voids, plant room and concealed within wall fabric to be insulated.
- Drilling location and aperture sizes through existing wooden roof beams to be agreed with the structural engineer prior to commencing works.
- All existing hot and cold water services to be stripped out with the exception of pipework in the pool plant room (refer to schematic drawing)

LEGEND

---	PIPEWORK LOW LEVEL
---	PIPEWORK HIGH LEVEL
---	PIPEWORK CEILING OR ROOF VOID
---	PIPEWORK UNDERGROUND
⋈	ISOLATING VALVE
⋈	THERMAL BALANCING VALVE
⋈	SHOWER MIXING VALVE
⋈	SHOWER PANEL
HWS	HOT WATER SERVICE
CWM	COLD WATER MAIN
BCWS	BOOSTED COLD WATER
TMV	THERMOSTATIC BLENDING VALVE
EWH	ELECTRIC WATER HEATER
F&R	FLOW AND RETURN
HL	HIGH LEVEL
LL	LOW LEVEL
CV	CEILING VOID
DTLL	DROP TO LOW LEVEL

T01	11.09.24	Tender Issue
Rev	Date	Description

PB Design and Consultancy Ltd
Woodside Cottage, Wood Lane, Renhold, Bedford MK41 0LT
Tel - 01772 263136
e-mail - peter@pbdesignltd.co.uk

CLIENT

Ware Town Council
The Priory
High Street, Ware
Hertfordshire.
SG12 9AL

PROJECT

Ware Priory Lido
Priory Street, Ware
Hertfordshire.
SG12 0DE
Proposed Extension and Refurbishment

PROJECT NUMBER 240502

DRAWING TITLE

Proposed Hot and Cold Water Services
Plan 1 of 2

DATE	October 2024	SCALE	1:50
DRAWN BY	PM	CHK	PM
DRAWING No	240502-M03	REV	T01