

LOCATION PLAN
1:250,000

RESIDUAL DESIGN HAZARDS

THE FOLLOWING HAS BEEN COLLECTED FROM THE PRE-CONSTRUCTION INFORMATION AND HIGHLIGHTS KNOWN RESIDUAL HAZARDS.

KEY  HS-# = HEALTH AND SAFETY RISK REFERENCE NUMBER
E-# = ENVIRONMENT RISK REFERENCE NUMBER

- HS-01 - OVERHEAD ELECTRICITY CABLES
HS-02 - GAS PIPELINE
HS-03 - OVERBRIDGE
HS-04 - WATERCOURSE
HS-05 - UNDERBRIDGE
HS-06 - GANTRY

NOTES

1. THIS IS A C.A.D. DRAWING AND SHOULD NOT BE AMENDED BY HAND.
2. DO NOT SCALE FROM THIS DRAWING. USE STATED DIMENSIONS ONLY. ALL DIMENSIONS ARE IN METRES UNLESS OTHERWISE STATED.
3. THIS DRAWING SHOULD BE PRINTED AND READ IN COLOUR ONLY.
4. THE UTILITIES INDICATED ON THIS DRAWING HAS BEEN PREPARED FOR INFORMATION ONLY AND IS NOT TO BE USED FOR CONSTRUCTION/SITE INVESTIGATION OR LOCATING SERVICES.
5. THE LOCATION OF ALL SERVICES MUST BE CONFIRMED WITH THE RELEVANT SERVICE PROVIDER PRIOR TO UNDERTAKING ANY WORKS.
6. KIER TAKES NO RESPONSIBILITY FOR THE ACCURACY OR COMPLETENESS OF THE INFORMATION SHOWN ON THIS DRAWING, WHICH HAS BEEN COMPILED FROM PLANS PROVIDED BY THE UTILITY COMPANIES.

STATS KEY

MOTORWAY COMMS

MARKER NODES

TRAFFIC LOOPS

THIS MAP IS REPRODUCED FROM ORDNANCE SURVEY MATERIAL WITH THE PERMISSION OF ORDNANCE SURVEY ON BEHALF OF THE CONTROLLER OF HER MAJESTY'S STATIONERY OFFICE © CROWN COPYRIGHT. UNAUTHORISED REPRODUCTION INFRINGES CROWN COPYRIGHT AND MAY LEAD TO PROSECUTION OR CIVIL PROCEEDINGS. AL 100030649 2021

P2	SCHEME SCOPE REDUCTION	GR	MRO	29/06/2021
P1	FIRST ISSUE	SC	SR	28/01/2021
REV	DETAILS	CHKD	APPD	DATE
DRAWING NUMBER				
PROJECT		ORIGINATOR	VOLUME	SCHEME REFERENCE No. 570131
HE570131		KIER	HRR	
M5_207.5_217.5 - DE - CH - 0000-06		REVISION		P2
LOCATION	TYPE	ROLE	NUMBER	



SCHEME NAME
570131D VRS GATEWAY 1A STUDY 2020-2021
SCHEME 607 M5 J25 TO J26 MP 207.5-217.5
DRAWING TITLE
STATUTORY UNDERTAKERS
(SHEET 6 OF 11)

DRAWN : SB	SCALE : 1:500	DRAWING STATUS
DESIGN : SB	DIMENSIONS : m	
CHKD : SC	ORIG DWG SIZE: A1	
APPD : SR	COPYRIGHT © KIER	
DATE : 28/01/21		
SUITABILITY: S2	FOR INFORMATION	

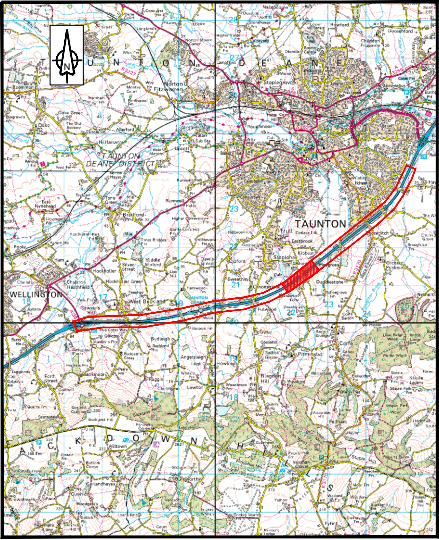
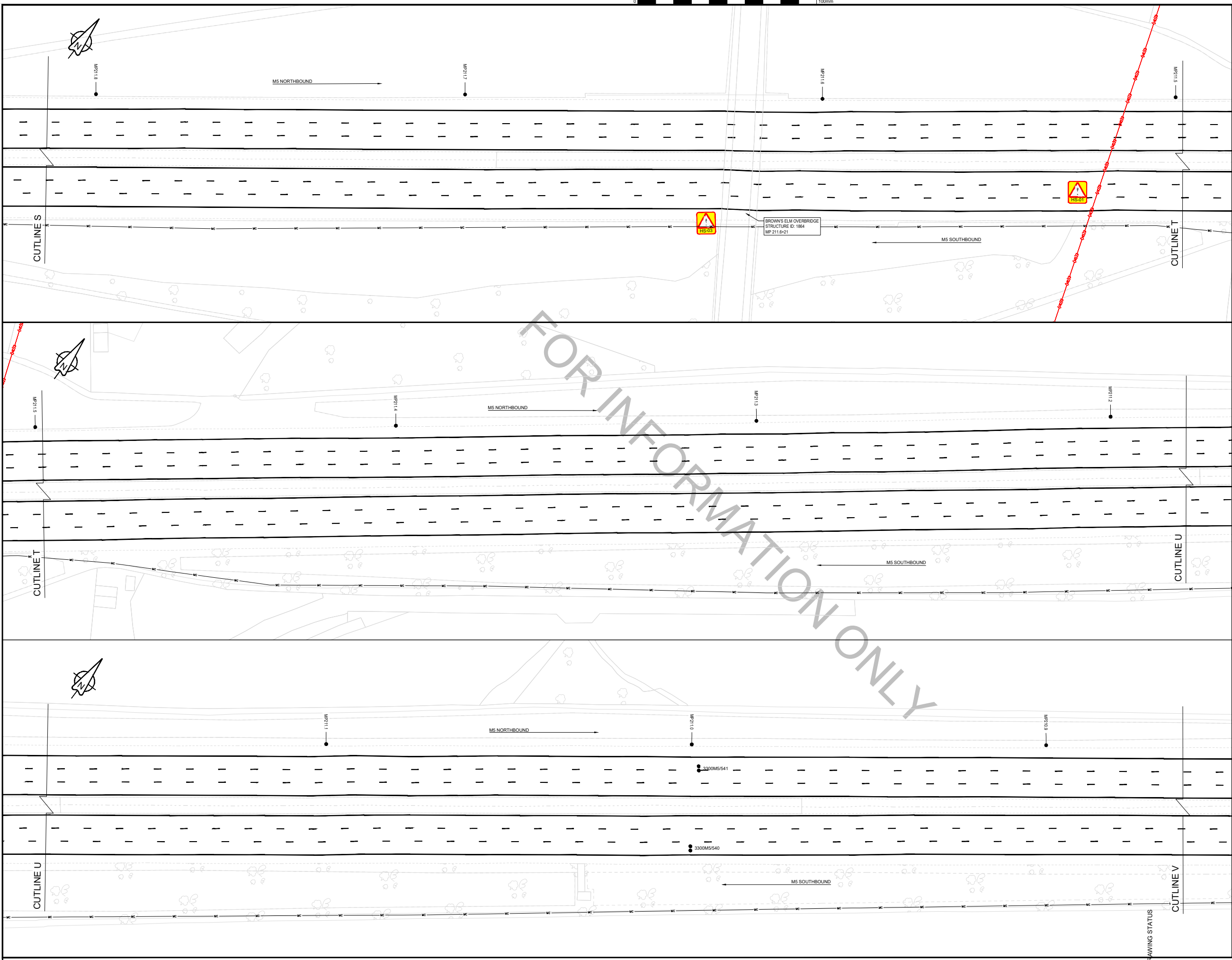

RESIDUAL DESIGN HAZARDS

THE FOLLOWING HAS BEEN COLLECTED FROM THE PRE-CONSTRUCTION INFORMATION AND HIGHLIGHTS KNOWN RESIDUAL HAZARDS.

KEY

HS-# = HEALTH AND SAFETY RISK REFERENCE NUMBER
E-# = ENVIRONMENT RISK REFERENCE NUMBER

- HS-01 - OVERHEAD ELECTRICITY CABLES**
HS-02 - GAS PIPELINE
HS-03 - OVERBRIDGE
HS-04 - WATERCOURSE
HS-05 - UNDERBRIDGE
HS-06 - GANTRY

- NOTES**
1. THIS IS A C.A.D. DRAWING AND SHOULD NOT BE AMENDED BY HAND.
 2. DO NOT SCALE FROM THIS DRAWING. USE STATED DIMENSIONS ONLY. ALL DIMENSIONS ARE IN METRES UNLESS OTHERWISE STATED.
 3. THIS DRAWING SHOULD BE PRINTED AND READ IN COLOUR ONLY.
 4. THE UTILITIES INDICATED ON THIS DRAWING HAS BEEN PREPARED FOR INFORMATION ONLY AND IS NOT TO BE USED FOR CONSTRUCTION/SITE INVESTIGATION OR LOCATING SERVICES.
 5. THE LOCATION OF ALL SERVICES MUST BE CONFIRMED WITH THE RELEVANT SERVICE PROVIDER PRIOR TO UNDERTAKING ANY WORKS.
 6. KIER TAKES NO RESPONSIBILITY FOR THE ACCURACY OR COMPLETENESS OF THE INFORMATION SHOWN ON THIS DRAWING, WHICH HAS BEEN COMPILED FROM PLANS PROVIDED BY THE UTILITY COMPANIES.

STATS KEY

ELECTRICITY OVERHEAD — ECH1 — ECH2 —

MOTORWAY COMMS — MC —

MARKER NODES ●

TRAFFIC LOOPS [Symbol]

THIS MAP IS REPRODUCED FROM ORDNANCE SURVEY MATERIAL WITH THE PERMISSION OF ORDNANCE SURVEY ON BEHALF OF THE CONTROLLER OF HER MAJESTY'S STATIONERY OFFICE © CROWN COPYRIGHT. UNAUTHORISED REPRODUCTION INFRINGES CROWN COPYRIGHT AND MAY LEAD TO PROSECUTION OR CIVIL PROCEEDINGS. AL 100030649 2021



CLIENT

SCHEME NAME
570131D VRS GATEWAY 1A STUDY 2020-2021
SCHEME 607 M5 J25 TO J26 MP 207.5-217.5
STATUTORY UNDERTAKERS
(SHEET 7 OF 11)

DRAWN : SB	SCALE : 1:500	DRAWING STATUS
DESIGN : SB	DIMENSIONS : m	WORK IN PROGRESS
CHKD : SC	ORIG DWG SIZE : A1	PRELIMINARY DRAWING ✓
APPD : SR	COPYRIGHT © KIER	EXTERNAL ISSUE
DATE : 28/01/21		AS-BUILT
SUITABILITY : S2	FOR INFORMATION	

P2	SCHEME SCOPE REDUCTION		GR	MRO	29/06/2021
P1	FIRST ISSUE		SC	SR	28/01/2021
REV	DETAILS		CHKD	APPD	DATE
DRAWING NUMBER					SCHEME REFERENCE N 570131
PROJECT ORIGINATOR		VOLUME			
HE570131 - KIER -		HRR		REVISION P2	
M5_207.5_217.5 - DE - CH - 0000-07					
LOCATION	TYPE	ROLE	NUMBER		

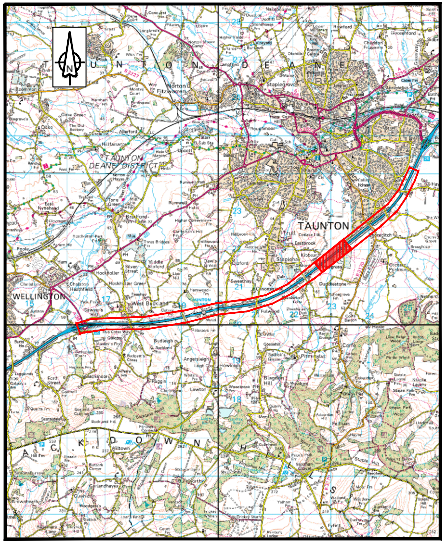
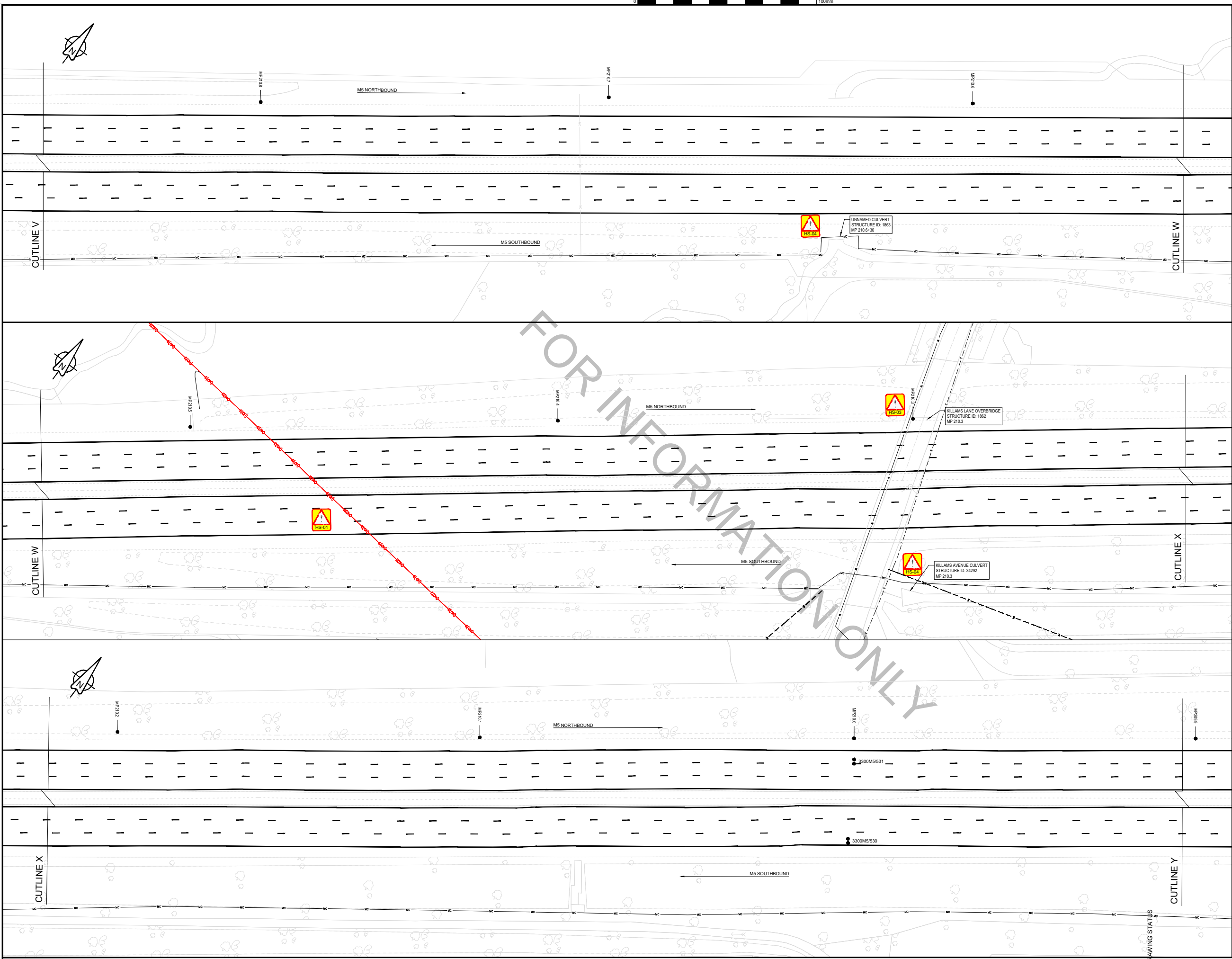

LOCATION PLAN
1:250,000

RESIDUAL DESIGN HAZARDS

THE FOLLOWING HAS BEEN COLLECTED FROM THE PRE-CONSTRUCTION INFORMATION AND HIGHLIGHTS KNOWN RESIDUAL HAZARDS.

KEY
HS-# = HEALTH AND SAFETY RISK REFERENCE NUMBER
E-# = ENVIRONMENT RISK REFERENCE NUMBER

HS-01 - OVERHEAD ELECTRICITY CABLES
HS-02 - GAS PIPELINE
HS-03 - OVERBRIDGE
HS-04 - WATERCOURSE
HS-05 - UNDERBRIDGE
HS-06 - GANTRY

NOTES

1. THIS IS A C.A.D. DRAWING AND SHOULD NOT BE AMENDED BY HAND.
2. DO NOT SCALE FROM THIS DRAWING. USE STATED DIMENSIONS ONLY. ALL DIMENSIONS ARE IN METRES UNLESS OTHERWISE STATED.
3. THIS DRAWING SHOULD BE PRINTED AND READ IN COLOUR ONLY.
4. THE UTILITIES INDICATED ON THIS DRAWING HAS BEEN PREPARED FOR INFORMATION ONLY AND IS NOT TO BE USED FOR CONSTRUCTION/SITE INVESTIGATION OR LOCATING SERVICES.
5. THE LOCATION OF ALL SERVICES MUST BE CONFIRMED WITH THE RELEVANT SERVICE PROVIDER PRIOR TO UNDERTAKING ANY WORKS.
6. KIER TAKES NO RESPONSIBILITY FOR THE ACCURACY OR COMPLETENESS OF THE INFORMATION SHOWN ON THIS DRAWING, WHICH HAS BEEN COMPILED FROM PLANS PROVIDED BY THE UTILITY COMPANIES.

STATS KEY

TELEPHONE UNDERGROUND
ELECTRICITY OVERHEAD
ELECTRICITY UNDERGROUND
WATER SUPPLIES
MOTORWAY COMMS
MARKER NODES
TRAFFIC LOOPS

THIS MAP IS REPRODUCED FROM ORDNANCE SURVEY MATERIAL WITH THE PERMISSION OF ORDNANCE SURVEY ON BEHALF OF THE CONTROLLER OF HER MAJESTY'S STATIONERY OFFICE © CROWN COPYRIGHT. UNAUTHORISED REPRODUCTION INFRINGES CROWN COPYRIGHT AND MAY LEAD TO PROSECUTION OR CIVIL PROCEEDINGS. AL 100030649 2021

P2	SCHEME SCOPE REDUCTION	GR	MRO	29/06/2021
P1	FIRST ISSUE	SC	SR	28/01/2021
REV	DETAILS	CHKD	APPD	DATE
DRAWING NUMBER				SCHEME REFERENCE No.
PROJECT ORIGINATOR VOLUME				570131
HE570131 - KIER - HRR				REVISION
M5_207.5_217.5 - DE - CH - 0000-08				P2
LOCATION	TYPE	ROLE	NUMBER	



SCHEME NAME
570131D VRS GATEWAY 1A STUDY 2020-2021
SCHEME 607 M5 J25 TO J26 MP 207.5-217.5
DRAWING TITLE
STATUTORY UNDERTAKERS
(SHEET 8 OF 11)

DRAWN : SB	SCALE : 1:500	DRAWING STATUS
DESIGN : SB	DIMENSIONS : m	WORK IN PROGRESS
CHKD : SC	ORIG DWG SIZE: A1	PRELIMINARY DRAWING ✓
APPD : SR	COPYRIGHT © KIER	EXTERNAL ISSUE
DATE : 29/01/21		AS-BUILT
SUITABILITY: S2	FOR INFORMATION	

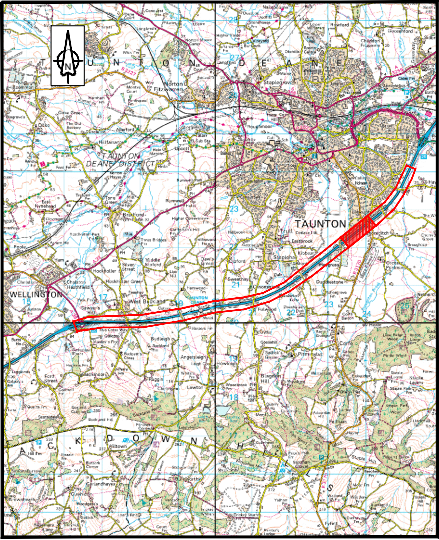
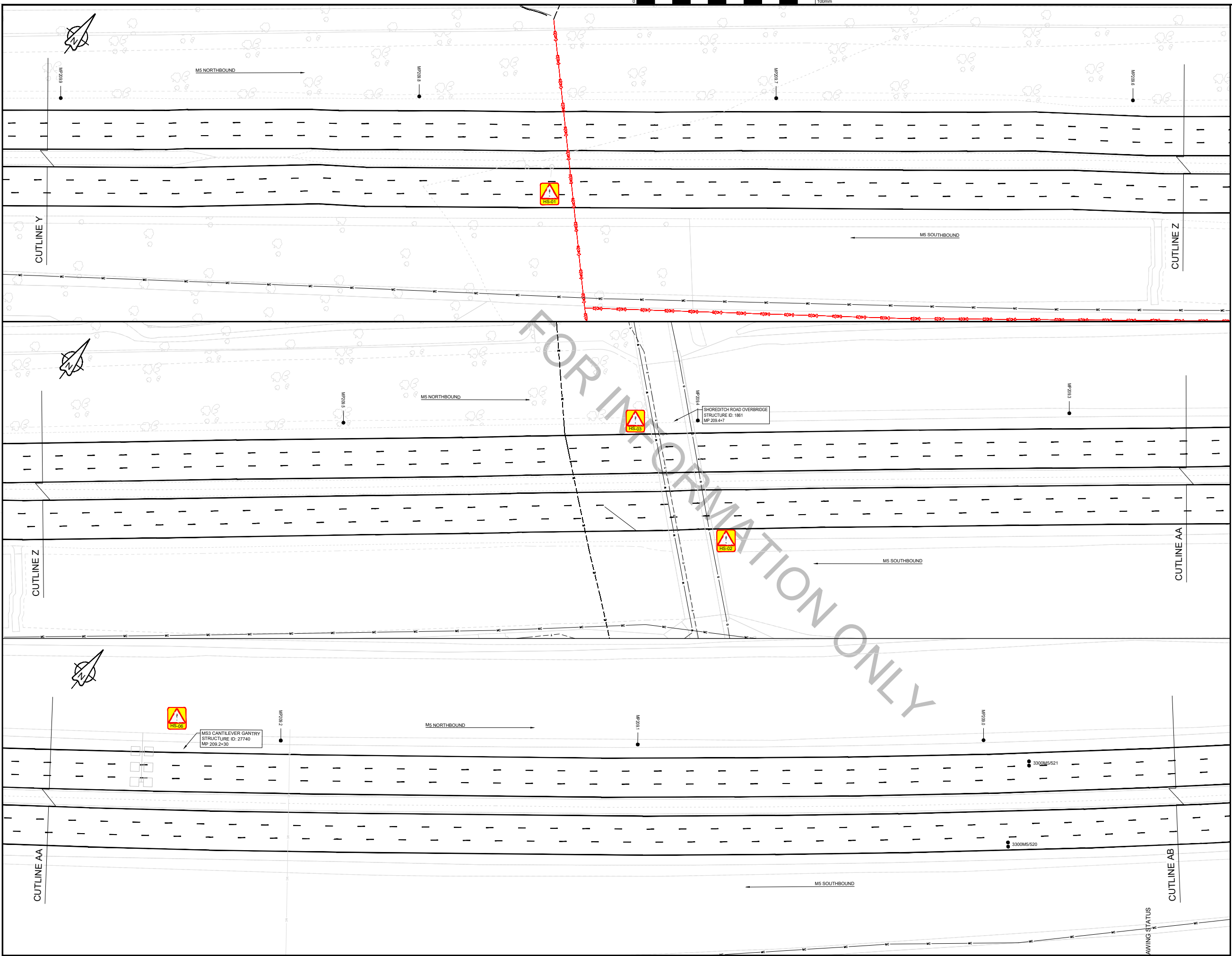

RESIDUAL DESIGN HAZARDS	
THE FOLLOWING HAS BEEN COLLECTED FROM THE PRE-CONSTRUCTION INFORMATION AND HIGHLIGHTS KNOWN RESIDUAL HAZARDS.	
KEY	HS-# = HEALTH AND SAFETY RISK REFERENCE NUMBER E-# = ENVIRONMENT RISK REFERENCE NUMBER

HS-01 - OVERHEAD ELECTRICITY CABLES
HS-02 - GAS PIPELINE
HS-03 - OVERBRIDGE
HS-04 - WATERCOURSE
HS-05 - UNDERBRIDGE
HS-06 - GANTRY

- NOTES
1. THIS IS A C.A.D. DRAWING AND SHOULD NOT BE AMENDED BY HAND.
 2. DO NOT SCALE FROM THIS DRAWING. USE STATED DIMENSIONS ONLY. ALL DIMENSIONS ARE IN METRES UNLESS OTHERWISE STATED.
 3. THIS DRAWING SHOULD BE PRINTED AND READ IN COLOUR ONLY.
 4. THE UTILITIES INDICATED ON THIS DRAWING HAS BEEN PREPARED FOR INFORMATION ONLY AND IS NOT TO BE USED FOR CONSTRUCTION SITE INVESTIGATION OR LOCATING SERVICES.
 5. THE LOCATION OF ALL SERVICES MUST BE CONFIRMED WITH THE RELEVANT SERVICE PROVIDER PRIOR TO UNDERTAKING ANY WORKS.
 6. KIER TAKES NO RESPONSIBILITY FOR THE ACCURACY OR COMPLETENESS OF THE INFORMATION SHOWN ON THIS DRAWING, WHICH HAS BEEN COMPILED FROM PLANS PROVIDED BY THE UTILITY COMPANIES.

STATS KEY	
GAS	---
TELEPHONE UNDERGROUND	---
ELECTRICITY OVERHEAD	---(CH)---
ELECTRICITY UNDERGROUND	---
WATER SUPPLIES	---
MOTORWAY COMMS	---
MARKER NODES	●
TRAFFIC LOOPS	□ □ □

THIS MAP IS REPRODUCED FROM ORDNANCE SURVEY MATERIAL WITH THE PERMISSION OF ORDNANCE SURVEY ON BEHALF OF THE CONTROLLER OF HER MAJESTY'S STATIONERY OFFICE © CROWN COPYRIGHT. UNAUTHORISED REPRODUCTION INFRINGES CROWN COPYRIGHT AND MAY LEAD TO PROSECUTION OR CIVIL PROCEEDINGS. AL 100030649 2021



SCHEME NAME	570131D VRS GATEWAY 1A STUDY 2020-2021 SCHEME 607 M5 J25 TO J26 MP 207.5-217.5
DRAWING TITLE	STATUTORY UNDERTAKERS (SHEET 9 OF 11)

DRAWN : SB	SCALE : 1:500	DRAWING STATUS
DESIGN : SB	DIMENSIONS : m	WORK IN PROGRESS
CHKD : SC	ORIG DWG SIZE : A1	PRELIMINARY DRAWING ✓
APPD : SR	COPYRIGHT © KIER	EXTERNAL ISSUE
DATE : 28/01/21		AS-BUILT
SUITABILITY : S2	FOR INFORMATION	

P2	SCHEME SCOPE REDUCTION	GR	MRO	29/06/2021
P1	FIRST ISSUE	SC	SR	28/01/2021
REV	DETAILS	CHKD	APPD	DATE
DRAWING NUMBER				
PROJECT	ORIGINATOR	VOLUME	SCHEME REFERENCE No.	
HE570131	KIER	HRR	570131	
M5_207.5_217.5	DE	CH	0000-09	REVISION
LOCATION	TYPE	ROLE	NUMBER	P2

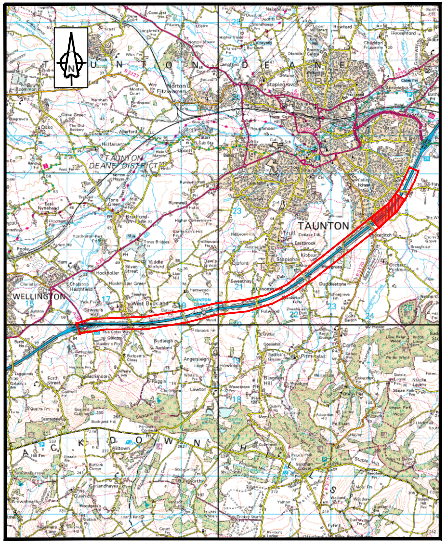
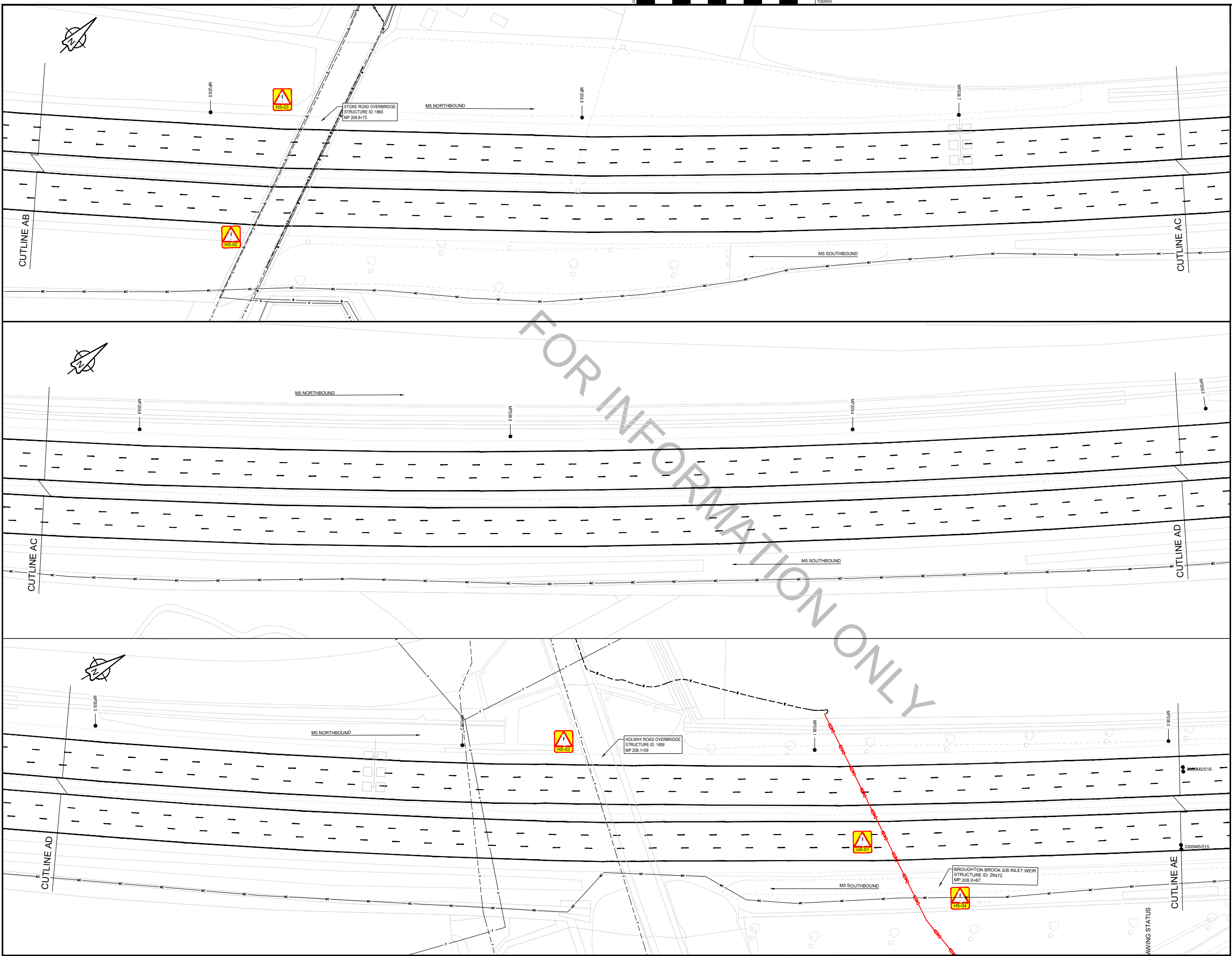

LOCATION PLAN
1:250,000

RESIDUAL DESIGN HAZARDS

THE FOLLOWING HAS BEEN COLLECTED FROM THE PRE-CONSTRUCTION INFORMATION AND HIGHLIGHTS KNOWN RESIDUAL HAZARDS.

KEY  HS-# = HEALTH AND SAFETY RISK REFERENCE NUMBER
E-# = ENVIRONMENT RISK REFERENCE NUMBER

HS-01 - OVERHEAD ELECTRICITY CABLES
HS-02 - GAS PIPELINE
HS-03 - OVERBRIDGE
HS-04 - WATERCOURSE
HS-05 - UNDERBRIDGE
HS-06 - GANTRY

NOTES

1. THIS IS A C.A.D. DRAWING AND SHOULD NOT BE AMENDED BY HAND.
2. DO NOT SCALE FROM THIS DRAWING. USE STATED DIMENSIONS ONLY. ALL DIMENSIONS ARE IN METRES UNLESS OTHERWISE STATED.
3. THIS DRAWING SHOULD BE PRINTED AND READ IN COLOUR ONLY.
4. THE UTILITIES INDICATED ON THIS DRAWING HAS BEEN PREPARED FOR INFORMATION ONLY AND IS NOT TO BE USED FOR CONSTRUCTION SITE INVESTIGATION OR LOCATING SERVICES.
5. THE LOCATION OF ALL SERVICES MUST BE CONFIRMED WITH THE RELEVANT SERVICE PROVIDER PRIOR TO UNDERTAKING ANY WORKS.
6. KIER TAKES NO RESPONSIBILITY FOR THE ACCURACY OR COMPLETENESS OF THE INFORMATION SHOWN ON THIS DRAWING, WHICH HAS BEEN COMPILED FROM PLANS PROVIDED BY THE UTILITY COMPANIES.

STATS KEY

GAS
TELEPHONE UNDERGROUND
ELECTRICITY UNDERGROUND
WATER SUPPLIES
SEWERS
MOTORWAY COMMS
ELECTRICITY OVERHEAD
MARKER NODES
TRAFFIC LOOPS

THIS MAP IS REPRODUCED FROM ORDNANCE SURVEY MATERIAL WITH THE PERMISSION OF ORDNANCE SURVEY ON BEHALF OF THE CONTROLLER OF HER MAJESTY'S STATIONERY OFFICE © CROWN COPYRIGHT. UNAUTHORISED REPRODUCTION INFRINGES CROWN COPYRIGHT AND MAY LEAD TO PROSECUTION OR CIVIL PROCEEDINGS. AL 100030649 2021



SCHEME NAME
570131D VRS GATEWAY 1A STUDY 2020-2021
SCHEME 607 M5 J25 TO J26 MP 207.5-217.5
DRAWING TITLE
STATUTORY UNDERTAKERS
(SHEET 10 OF 11)

DRAWN : SB	SCALE : 1:500	DRAWING STATUS
DESIGN : SB	DIMENSIONS : m	WORK IN PROGRESS
CHKD : SC	ORIG DWG SIZE: A1	PRELIMINARY DRAWING ✓
APPD : SR	COPYRIGHT © KIER	EXTERNAL ISSUE
DATE : 28/01/21		AS-BUILT
SUITABILITY: S2	FOR INFORMATION	

DRAWING NUMBER					SCHEME REFERENCE NO.
PROJECT	ORIGINATOR	VOLUME		570131	
HE570131	KIER	HRR			
M5_207.5_217.5 - DE - CH - 0000-10					REVISION
LOCATION	TYPE	ROLE	NUMBER	P2	

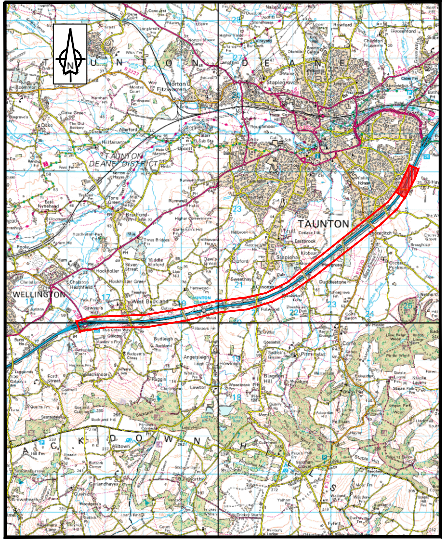
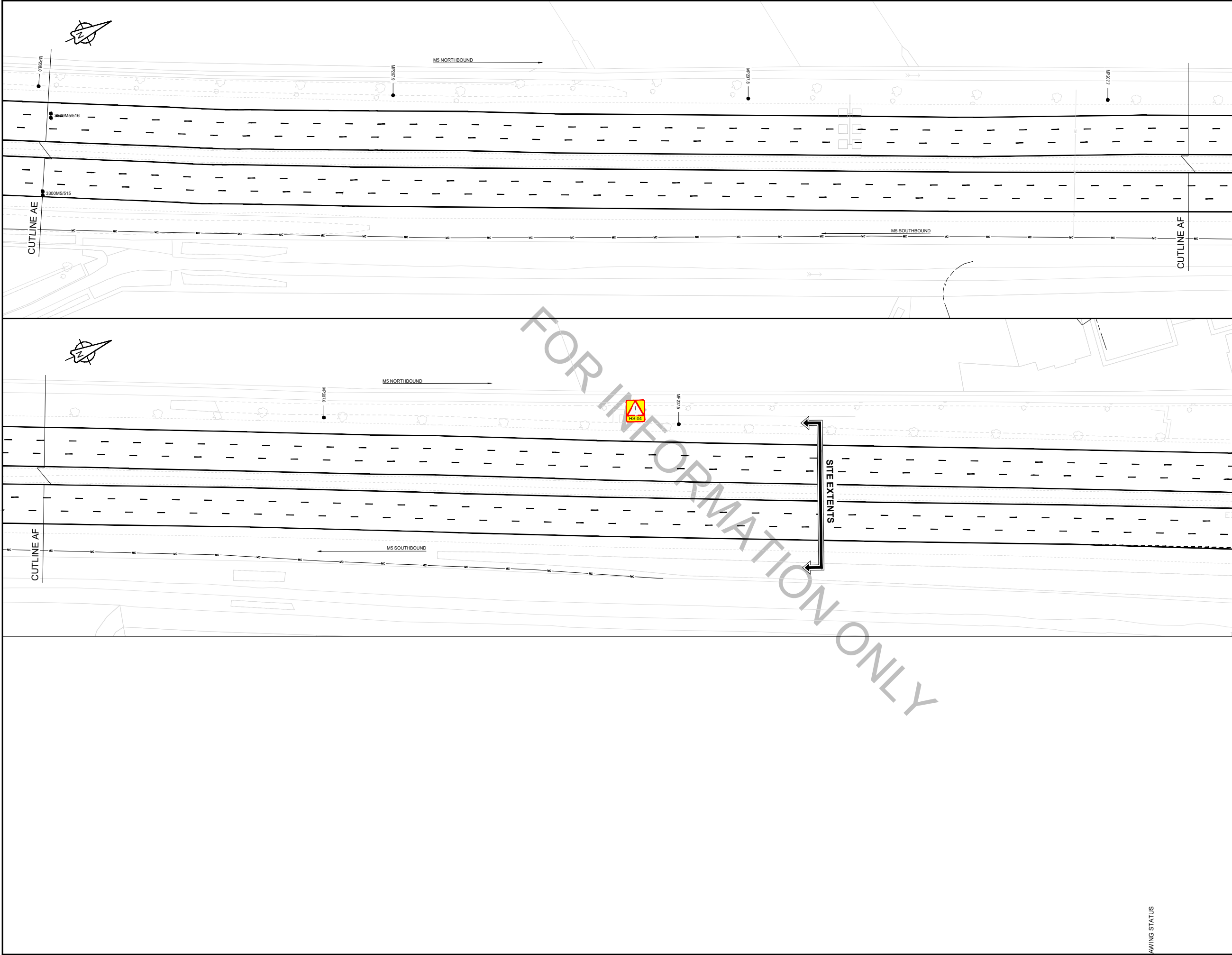

LOCATION PLAN
1:250,000

RESIDUAL DESIGN HAZARDS

THE FOLLOWING HAS BEEN COLLECTED FROM THE PRE-CONSTRUCTION INFORMATION AND HIGHLIGHTS KNOWN RESIDUAL HAZARDS.





KEY  HS-# = HEALTH AND SAFETY RISK REFERENCE NUMBER
E-# = ENVIRONMENT RISK REFERENCE NUMBER

- HS-01 - OVERHEAD ELECTRICITY CABLES
HS-02 - GAS PIPELINE
HS-03 - OVERBRIDGE
HS-04 - WATERCOURSE
HS-05 - UNDERBRIDGE
HS-06 - GANTRY

NOTES

1. THIS IS A C.A.D. DRAWING AND SHOULD NOT BE AMENDED BY HAND.
2. DO NOT SCALE FROM THIS DRAWING. USE STATED DIMENSIONS ONLY. ALL DIMENSIONS ARE IN METRES UNLESS OTHERWISE STATED.
3. THIS DRAWING SHOULD BE PRINTED AND READ IN COLOUR ONLY.
4. THE UTILITIES INDICATED ON THIS DRAWING HAS BEEN PREPARED FOR INFORMATION ONLY AND IS NOT TO BE USED FOR CONSTRUCTION SITE INVESTIGATION OR LOCATING SERVICES.
5. THE LOCATION OF ALL SERVICES MUST BE CONFIRMED WITH THE RELEVANT SERVICE PROVIDER PRIOR TO UNDERTAKING ANY WORKS.
6. KIER TAKES NO RESPONSIBILITY FOR THE ACCURACY OR COMPLETENESS OF THE INFORMATION SHOWN ON THIS DRAWING, WHICH HAS BEEN COMPILED FROM PLANS PROVIDED BY THE UTILITY COMPANIES.

STATS KEY

- ELECTRICITY UNDERGROUND 
MOTORWAY COMMS 
MARKER NODES 
TRAFFIC LOOPS 

THIS MAP IS REPRODUCED FROM ORDNANCE SURVEY MATERIAL WITH THE PERMISSION OF ORDNANCE SURVEY ON BEHALF OF THE CONTROLLER OF HER MAJESTY'S STATIONERY OFFICE © CROWN COPYRIGHT. UNAUTHORISED REPRODUCTION INFRINGES CROWN COPYRIGHT AND MAY LEAD TO PROSECUTION OR CIVIL PROCEEDINGS. AL 100030649 2021

P2	SCHEME SCOPE REDUCTION	GR	MRO	29/06/2021
P1	FIRST ISSUE	SC	SR	28/01/2021
REV	DETAILS	CHKD	APPD	DATE

DRAWING NUMBER				SCHEME REFERENCE No.	
PROJECT	ORIGINATOR	VOLUME		570131	
HE570131	KIER	HRR			
M5_207.5_217.5 - DE - CH - 0000-11				REVISION	
LOCATION	TYPE	ROLE	NUMBER	P2	



SCHEME NAME 570131D VRS GATEWAY 1A STUDY 2020-2021
SCHEME 607 M5 J25 TO J26 MP 207.5-217.5
DRAWING TITLE STATUTORY UNDERTAKERS
(SHEET 11 OF 11)

DRAWN : SB	SCALE : 1:500	DRAWING STATUS
DESIGN : SB	DIMENSIONS : m	
CHKD : SC	ORIG DWG SIZE: A1	
APPD : SR	COPYRIGHT © KIER	
DATE : 28/01/21		
SUITABILITY: S2	FOR INFORMATION	

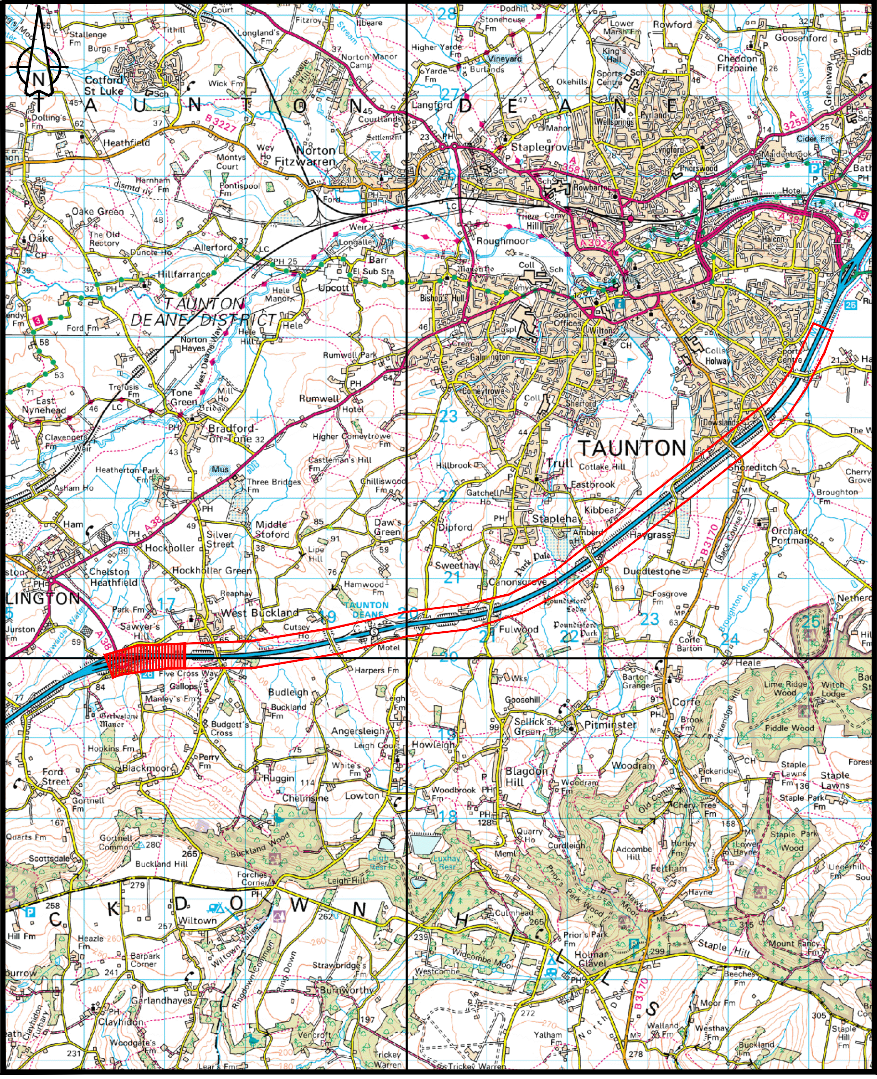
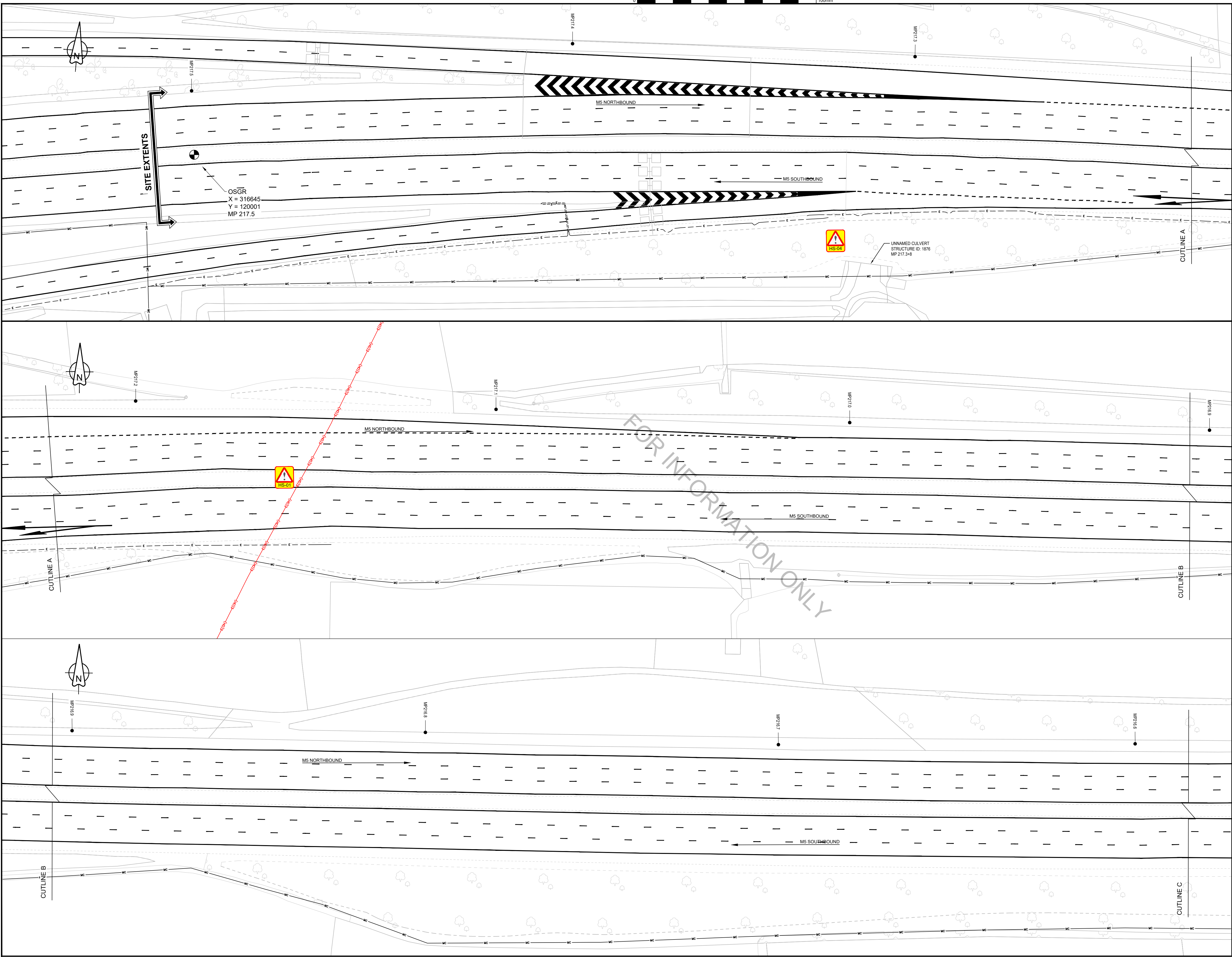

RESIDUAL DESIGN HAZARDS

THE FOLLOWING HAS BEEN COLLECTED FROM THE PRE-CONSTRUCTION INFORMATION AND HIGHLIGHTS KNOWN RESIDUAL HAZARDS.

KEY

HS-# = HEALTH AND SAFETY RISK REFERENCE NUMBER
E-# = ENVIRONMENT RISK REFERENCE NUMBER

- NOTES**
1. THIS IS A C.A.D. DRAWING AND SHOULD NOT BE AMENDED BY HAND.
 2. DO NOT SCALE FROM THIS DRAWING. USE STATED DIMENSIONS ONLY. ALL DIMENSIONS ARE IN METRES UNLESS OTHERWISE STATED.
 3. THIS DRAWING SHOULD BE PRINTED AND READ IN COLOUR ONLY.
 4. THE UTILITIES INDICATED ON THIS DRAWING HAS BEEN PREPARED FOR INFORMATION ONLY AND IS NOT TO BE USED FOR CONSTRUCTION/SITE INVESTIGATION OR LOCATING SERVICES.
 5. THE LOCATION OF ALL SERVICES MUST BE CONFIRMED WITH THE RELEVANT SERVICE PROVIDER PRIOR TO UNDERTAKING ANY WORKS. THE CONTRACTORS ATTENTION IS DRAWN TO THE POSSIBILITY OF COMMUNICATIONS CABLE BEING LOCATED WITHIN THE FILTER MEDIA MATERIAL; AN NRTS SURVEY IS REQUIRED PRIOR TO ANY EXCAVATION WORKS BEING UNDERTAKEN.
 6. KIER TAKES NO RESPONSIBILITY FOR THE ACCURACY OR COMPLETENESS OF THE INFORMATION SHOWN ON THIS DRAWING, WHICH HAS BEEN COMPILED FROM PLANS PROVIDED BY THE UTILITY COMPANIES.

STATS KEY

TELEPHONE UNDERGROUND	---
ELECTRICITY OVERHEAD	—EOP—EOP—
ELECTRICITY UNDERGROUND	---
MOTORWAY COMMS	---
MARKER NODES	●
TRAFFIC LOOPS	□ □ □
OSGR COORDINATES	⊙

THIS MAP IS REPRODUCED FROM ORDNANCE SURVEY MATERIAL WITH THE PERMISSION OF ORDNANCE SURVEY ON BEHALF OF THE CONTROLLER OF HER MAJESTY'S STATIONERY OFFICE © CROWN COPYRIGHT. UNAUTHORISED REPRODUCTION INFRINGES CROWN COPYRIGHT AND MAY LEAD TO PROSECUTION OR CIVIL PROCEEDINGS. AL 100030649 2021



CLIENT

SCHEME NAME
570131D VRS GATEWAY 1A STUDY 2020-2021
SCHEME 607 M5 J25 TO J26 MP 207.5-217.5

DRAWING TITLE
LOCATION PLAN
(SHEET 1 OF 11)

DRAWN : SB	SCALE : 1:500	DRAWING STATUS
DESIGN : SB	DIMENSIONS : m	WORK IN PROGRESS
CHKD : SC	ORIG DWG SIZE: A1	PRELIMINARY DRAWING ✓
APPD : SR	COPYRIGHT © KIER	EXTERNAL ISSUE
DATE : 28/01/21		AS-BUILT
SUITABILITY: S2	FOR INFORMATION	

DRAWING NUMBER	SCHEME REFERENCE No.
PROJECT ORIGINATOR VOLUME	HE570131D - KIER - HRR
M5_207.5_217.5 - DE - CH - 0001-01	REVISION
LOCATION TYPE ROLE NUMBER	P 2