

This document is © Bond Bryan Architects Ltd.
If in doubt ASK. Drawing measurements shall not be obtained by scaling. Verify all dimensions prior to construction.
Immediately report any discrepancies on this document to the Originator. This document shall be read in conjunction with associated models, specifications and related consultants' documents.

Key plan

North

N

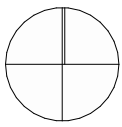

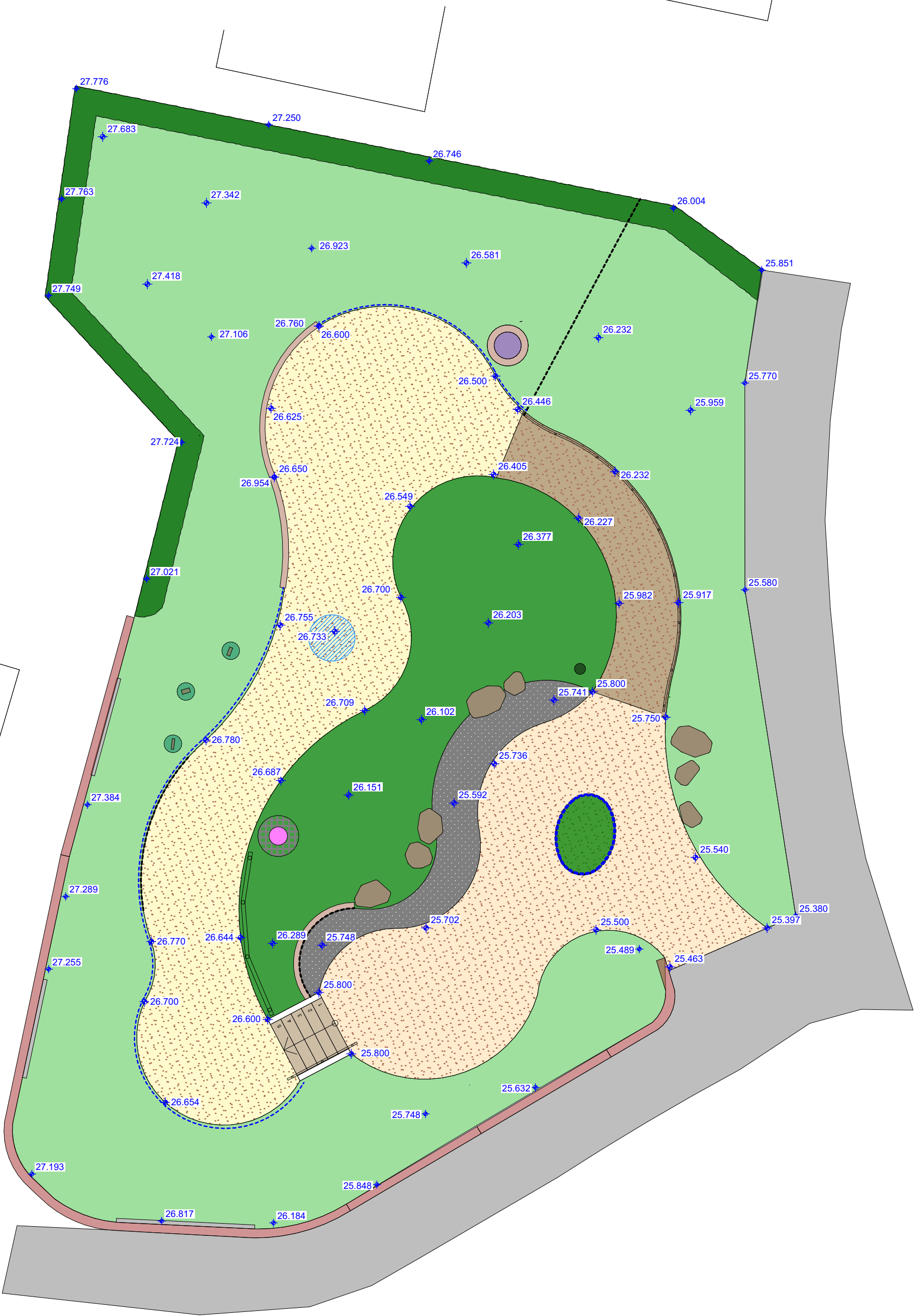

P03 - Design value engineered, LvW, 2024-09-21
P02 - Design value engineered, LvW, 2024-08-31
P01 - First issue- for information, LvW, 2024-07-14

Rev	Description	Drawn	Checked	Date
-----	-------------	-------	---------	------

Designed: Lee-Anne van Wyk
Chartered Landscape Architect
Mobile: 07341 34005

LANDSCAPE LAYOUT

1:100

Client Company

For:
Rushmere St Andrew Parish Council

Project Name

Site Name

Landscape Levels

Originator project ref KSGA	Purpose of Issue For Information
Scale(s) 1:100	
Paper size A2	Revision description P01

project	originator	volume	level	type	role	number	revision
KSGA	- LVW	- Z0	- 00	- DR	- L	- 1002	P03

Native model: KELVEDON SENSORY GARDEN NO 3.pn