

NOTES:

1. ALL DIMENSIONS ARE IN METERS UNLESS NOTED OTHERWISE.
2. ROAD RESTRAINT SYSTEMS AND SIGNAGE NOT SHOWN FOR CLARITY. SEE RELEVANT HIGHWAYS DRAWINGS FOR DETAILS.
3. FORMED SLOPES WILL BE LANDSCAPED AS CALCAREOUS GRASSLAND IN ACCORDANCE WITH THE ENVIRONMENTAL MASTERPLAN AND SECTION 2.5 OF THE SCOPE.

|       |           |                        |       |         |       |          |  |
|-------|-----------|------------------------|-------|---------|-------|----------|--|
|       |           |                        |       |         |       |          |  |
|       |           |                        |       |         |       |          |  |
|       |           |                        |       |         |       |          |  |
|       |           |                        |       |         |       |          |  |
| P01.1 | 21/06/21  | FOR QUALITY SUBMISSION |       |         |       |          |  |
| Rev   | Rev. Date | Purpose of revision    | Drawn | Checked | Rev'd | Approved |  |



Client



Project

A303  
Amesbury to Berwick Down

|               |
|---------------|
| Drawing title |
|---------------|

Drawing title

LONG SECTION ALONG  
THE EASTBOUND CARRIAGEWAY  
FACING NORTH

Drawing status

S0 - Initial Status

|               |             |              |       |
|---------------|-------------|--------------|-------|
| State Code    | Preliminary |              |       |
| Project Stage | PCF Stage 5 |              |       |
| Scale         | AS SHOWN    | DO NOT SCALE |       |
| Jacobs No.    | HE551506    | Rev          | P01.1 |
| Client no.    | HE551506    |              |       |

Client No. \_\_\_\_\_

Drawing number  
HE551506 - PIN | Originator | Volume  
BGR - STU -  
Location | Type | Role | Number  
SWSREP0Z -DR- S -0001

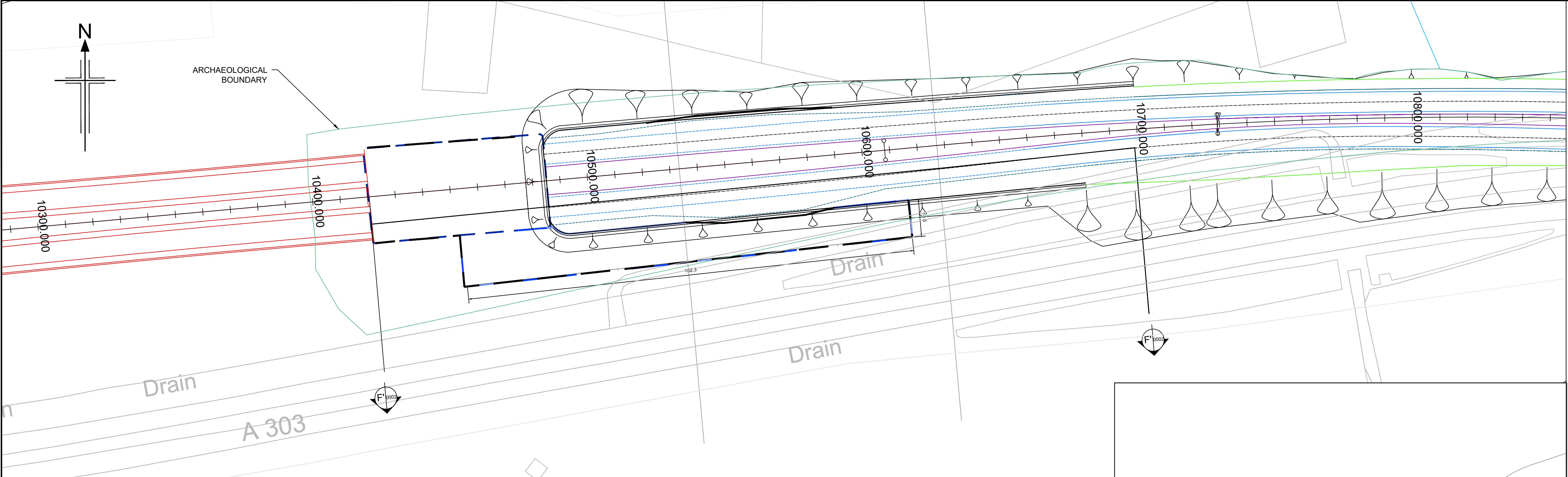

NOTES:

1. ALL DIMENSIONS ARE IN METRES UNLESS NOTED OTHERWISE.
2. ROAD RESTRAINT SYSTEMS AND SIGNAGE NOT SHOWN FOR CLARITY.SEE RELEVANT HIGHWAYS DRAWINGS FOR DETAILS.
3. THESE PROPOSALS DO NOT INCLUDE ANY LATERAL DEVIATIONS FROM THE CENTRELINES IN VOLUME 2.7 (ENGINEERING SECTION DRAWINGS (PLANS AND PROFILES) OF THE DCO.
4. FORMED SLOPES WILL BE LANDSCAPED AS CALCAREOUS GRASSLAND IN ACCORDANCE WITH THE ENVIRONMENTAL MASTERPLAN AND SECTION 2.5 OF THE SCOPE

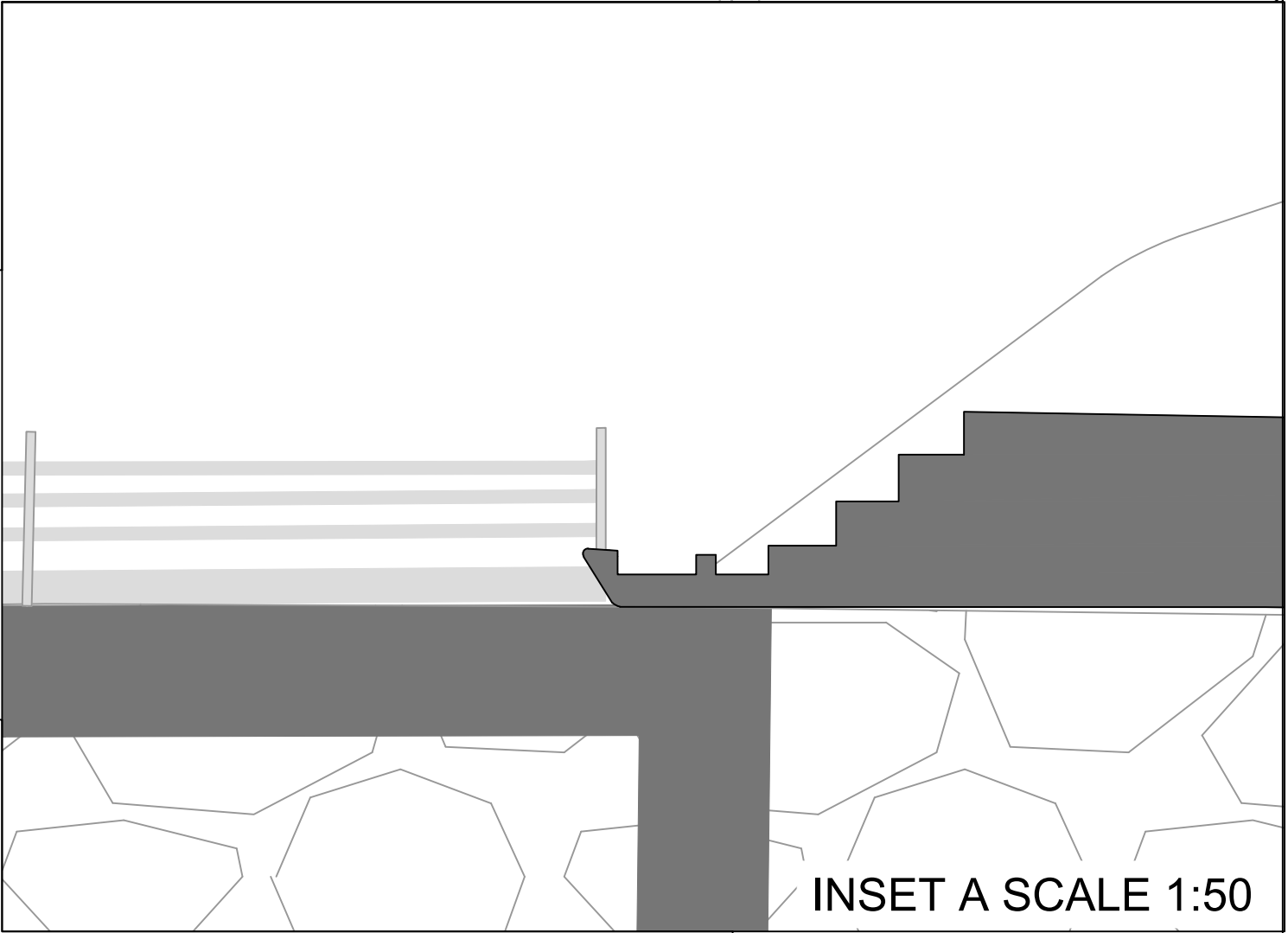

INSET A SCALE 1:50

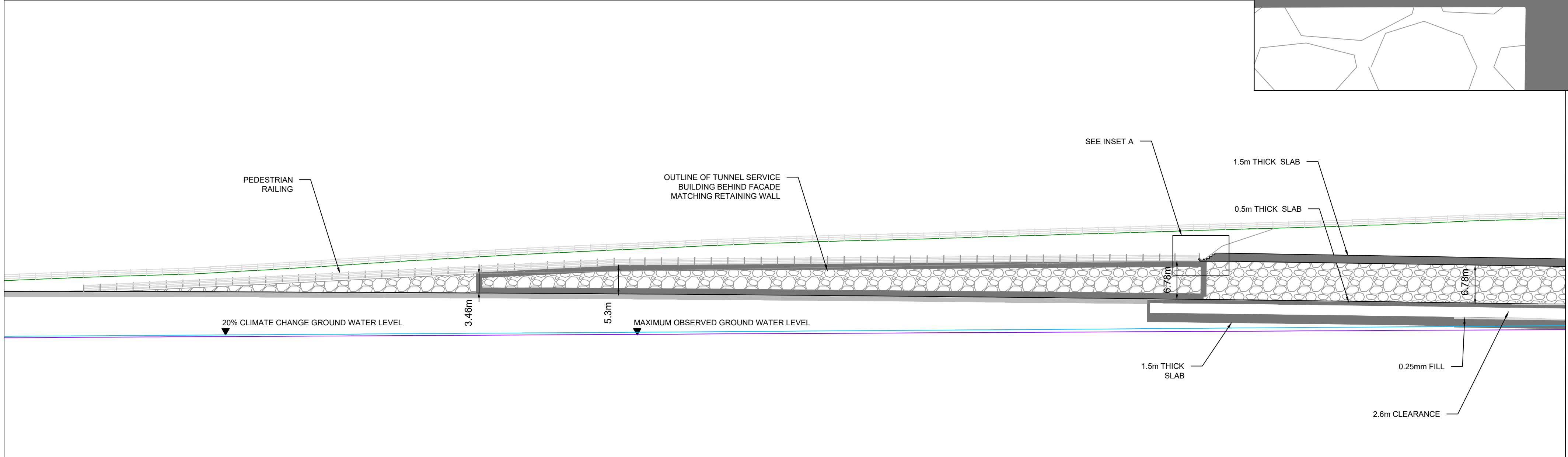

LONG SECTION AT CH. 10420 TO 10700  
SECTION F-F

| CH       | PROPOSED ROAD LEVEL AT CENTRE OF SCHEME | EXISTING GROUND LEVEL AT CENTRE OF SCHEME | CHANGE FROM DCO ALIGNMENT | LEVEL DIFFERENCE | EXISTING GROUND LEVEL AT WALL | CHAINAGE |
|----------|---|---|---------------------------|------------------|-------------------------------|----------|
| 10420.00 | 82.225                                  | 82.880                                    | -0.655                    | -0.655           | 82.880                        | 10420.00 |
| 10425.00 | 82.215                                  | 82.870                                    | -0.655                    | -0.655           | 82.870                        | 10425.00 |
| 10430.00 | 82.210                                  | 82.865                                    | -0.655                    | -0.655           | 82.865                        | 10430.00 |
| 10435.00 | 82.205                                  | 82.860                                    | -0.655                    | -0.655           | 82.860                        | 10435.00 |
| 10440.00 | 82.200                                  | 82.855                                    | -0.655                    | -0.655           | 82.855                        | 10440.00 |
| 10445.00 | 82.195                                  | 82.850                                    | -0.655                    | -0.655           | 82.850                        | 10445.00 |
| 10450.00 | 82.190                                  | 82.845                                    | -0.655                    | -0.655           | 82.845                        | 10450.00 |
| 10455.00 | 82.185                                  | 82.840                                    | -0.655                    | -0.655           | 82.840                        | 10455.00 |
| 10460.00 | 82.180                                  | 82.835                                    | -0.655                    | -0.655           | 82.835                        | 10460.00 |
| 10465.00 | 82.175                                  | 82.830                                    | -0.655                    | -0.655           | 82.830                        | 10465.00 |
| 10470.00 | 82.170                                  | 82.825                                    | -0.655                    | -0.655           | 82.825                        | 10470.00 |
| 10475.00 | 82.165                                  | 82.820                                    | -0.655                    | -0.655           | 82.820                        | 10475.00 |
| 10480.00 | 82.160                                  | 82.815                                    | -0.655                    | -0.655           | 82.815                        | 10480.00 |
| 10485.00 | 82.155                                  | 82.810                                    | -0.655                    | -0.655           | 82.810                        | 10485.00 |
| 10490.00 | 82.150                                  | 82.805                                    | -0.655                    | -0.655           | 82.805                        | 10490.00 |
| 10495.00 | 82.145                                  | 82.800                                    | -0.655                    | -0.655           | 82.800                        | 10495.00 |
| 10500.00 | 82.140                                  | 82.795                                    | -0.655                    | -0.655           | 82.795                        | 10500.00 |
| 10505.00 | 82.135                                  | 82.790                                    | -0.655                    | -0.655           | 82.790                        | 10505.00 |
| 10510.00 | 82.130                                  | 82.785                                    | -0.655                    | -0.655           | 82.785                        | 10510.00 |
| 10515.00 | 82.125                                  | 82.780                                    | -0.655                    | -0.655           | 82.780                        | 10515.00 |
| 10520.00 | 82.120                                  | 82.775                                    | -0.655                    | -0.655           | 82.775                        | 10520.00 |
| 10525.00 | 82.115                                  | 82.770                                    | -0.655                    | -0.655           | 82.770                        | 10525.00 |
| 10530.00 | 82.110                                  | 82.765                                    | -0.655                    | -0.655           | 82.765                        | 10530.00 |
| 10535.00 | 82.105                                  | 82.760                                    | -0.655                    | -0.655           | 82.760                        | 10535.00 |
| 10540.00 | 82.100                                  | 82.755                                    | -0.655                    | -0.655           | 82.755                        | 10540.00 |
| 10545.00 | 82.095                                  | 82.750                                    | -0.655                    | -0.655           | 82.750                        | 10545.00 |
| 10550.00 | 82.090                                  | 82.745                                    | -0.655                    | -0.655           | 82.745                        | 10550.00 |
| 10555.00 | 82.085                                  | 82.740                                    | -0.655                    | -0.655           | 82.740                        | 10555.00 |
| 10560.00 | 82.080                                  | 82.735                                    | -0.655                    | -0.655           | 82.735                        | 10560.00 |
| 10565.00 | 82.075                                  | 82.730                                    | -0.655                    | -0.655           | 82.730                        | 10565.00 |
| 10570.00 | 82.070                                  | 82.725                                    | -0.655                    | -0.655           | 82.725                        | 10570.00 |
| 10575.00 | 82.065                                  | 82.720                                    | -0.655                    | -0.655           | 82.720                        | 10575.00 |
| 10580.00 | 82.060                                  | 82.715                                    | -0.655                    | -0.655           | 82.715                        | 10580.00 |
| 10585.00 | 82.055                                  | 82.710                                    | -0.655                    | -0.655           | 82.710                        | 10585.00 |
| 10590.00 | 82.050                                  | 82.705                                    | -0.655                    | -0.655           | 82.705                        | 10590.00 |
| 10595.00 | 82.045                                  | 82.700                                    | -0.655                    | -0.655           | 82.700                        | 10595.00 |
| 10600.00 | 82.040                                  | 82.695                                    | -0.655                    | -0.655           | 82.695                        | 10600.00 |
| 10605.00 | 82.035                                  | 82.690                                    | -0.655                    | -0.655           | 82.690                        | 10605.00 |
| 10610.00 | 82.030                                  | 82.685                                    | -0.655                    | -0.655           | 82.685                        | 10610.00 |
| 10615.00 | 82.025                                  | 82.680                                    | -0.655                    | -0.655           | 82.680                        | 10615.00 |
| 10620.00 | 82.020                                  | 82.675                                    | -0.655                    | -0.655           | 82.675                        | 10620.00 |
| 10625.00 | 82.015                                  | 82.670                                    | -0.655                    | -0.655           | 82.670                        | 10625.00 |
| 10630.00 | 82.010                                  | 82.665                                    | -0.655                    | -0.655           | 82.665                        | 10630.00 |
| 10635.00 | 82.005                                  | 82.660                                    | -0.655                    | -0.655           | 82.660                        | 10635.00 |
| 10640.00 | 82.000                                  | 82.655                                    | -0.655                    | -0.655           | 82.655                        | 10640.00 |
| 10645.00 | 81.995                                  | 82.650                                    | -0.655                    | -0.655           | 82.650                        | 10645.00 |
| 10650.00 | 81.990                                  | 82.645                                    | -0.655                    | -0.655           | 82.645                        | 10650.00 |
| 10655.00 | 81.985                                  | 82.640                                    | -0.655                    | -0.655           | 82.640                        | 10655.00 |
| 10660.00 | 81.980                                  | 82.635                                    | -0.655                    | -0.655           | 82.635                        | 10660.00 |
| 10665.00 | 81.975                                  | 82.630                                    | -0.655                    | -0.655           | 82.630                        | 10665.00 |
| 10670.00 | 81.970                                  | 82.625                                    | -0.655                    | -0.655           | 82.625                        | 10670.00 |
| 10675.00 | 81.965                                  | 82.620                                    | -0.655                    | -0.655           | 82.620                        | 10675.00 |
| 10680.00 | 81.960                                  | 82.615                                    | -0.655                    | -0.655           | 82.615                        | 10680.00 |
| 10685.00 | 81.955                                  | 82.610                                    | -0.655                    | -0.655           | 82.610                        | 10685.00 |
| 10690.00 | 81.950                                  | 82.605                                    | -0.655                    | -0.655           | 82.605                        | 10690.00 |
| 10695.00 | 81.945                                  | 82.600                                    | -0.655                    | -0.655           | 82.600                        | 10695.00 |
| 10700.00 | 81.940                                  | 82.595                                    | -0.655                    | -0.655           | 82.595                        | 10700.00 |

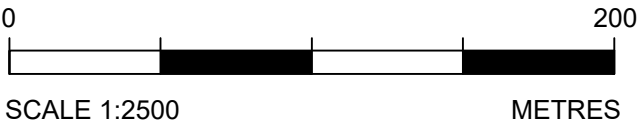

|     |           |                        |       |         |       |        |
|-----|-----------|------------------------|-------|---------|-------|--------|
| P01 | 12/02/21  | FOR QUALITY SUBMISSION | AE    | PO      | MN    | MN     |
| Rev | Rev. Date | Purpose of revision    | Drawn | Checked | Rev'd | Appr'd |



Client  
Project  
A303  
Amesbury to Berwick Down

Drawing title  
LONG SECTION ALONG  
THE WEST BOUND CARRIAGEWAY  
FACING SOUTH

Drawing status  
S4 - SUITABLE FOR STAGED APPROVAL

|               |             |              |
|---------------|-------------|--------------|
| State Code    | Preliminary | DO NOT SCALE |
| Project Stage | PCF Stage 5 |              |
| Scale         | AS SHOWN    |              |
| Jacobs No.    | HE551506    | Rev P01      |
| Client no.    | HE551506    |              |

Drawing number  
HE551506 - BGR - STU -  
SWSREP0Z  
Originator  
Volume  
Type  
Role  
Number  
-DR- S -0002



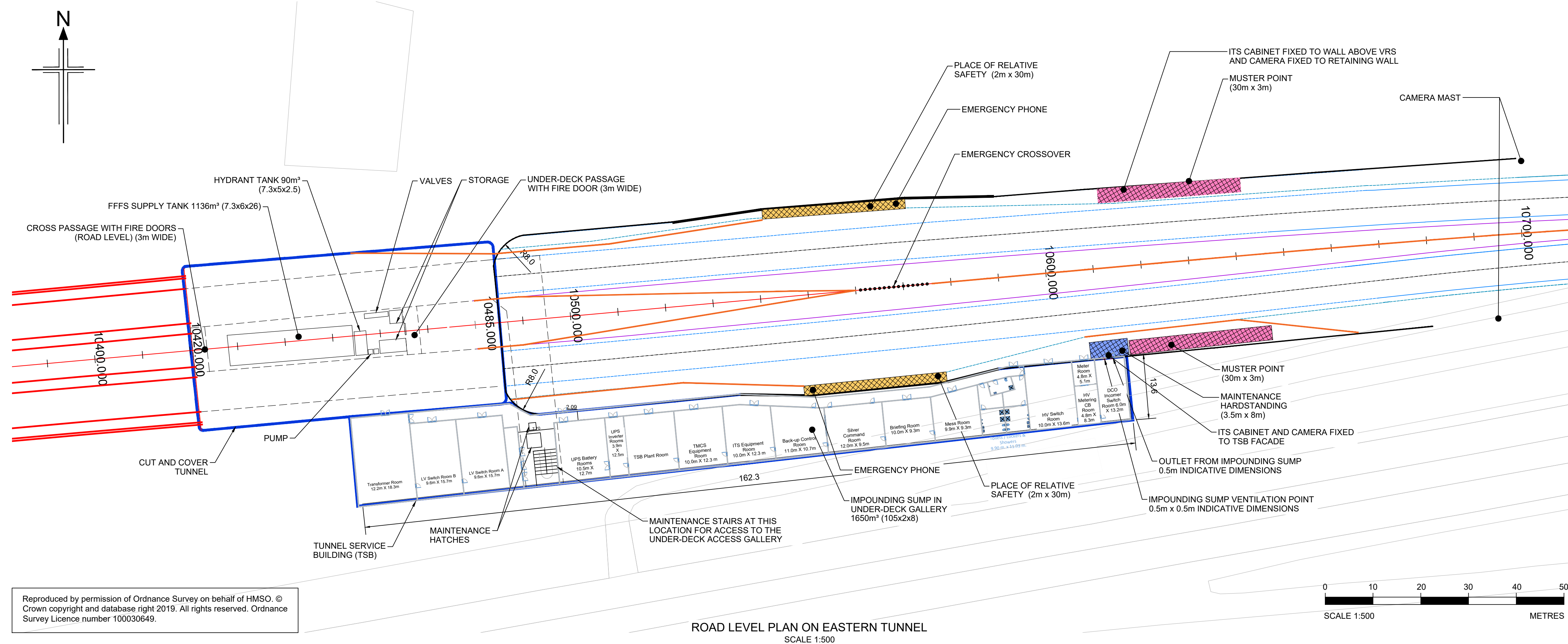
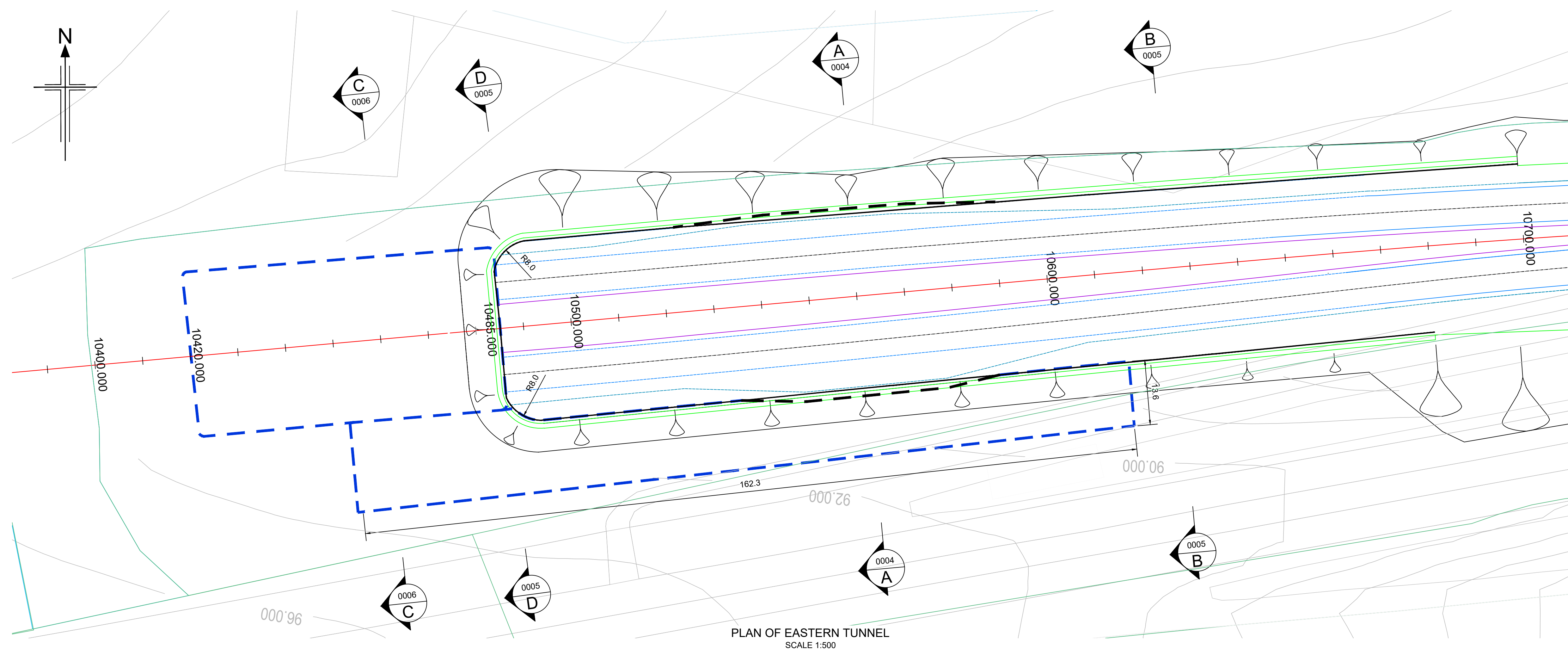











## NOTES:

1. ALL DIMENSIONS ARE IN METRES UNLESS NOTED THEREWISE.
2. FOR FORECAST TUNNEL DETAILS PLEASE REFER TO  
H5551506-BGR-STU-Z3ML000Z-DR-C-0001,  
H5551506-BGR-STU-Z3ML000Z-DR-C-0004,  
H5551506-BGR-STU-Z3ML000Z-DR-C-0005,  
H5551506-BGR-STU-Z3ML000Z-DR-C-0006,  
H5551506-BGR-STU-Z3ML000Z-DR-C-0007.
3. THE EARTHWORKS ABOVE THE NORTHERN  
RETAINING WALL WILL EXTEND BEYOND THE DAMS  
ARCHAEOLOGICAL BOUNDARY BETWEEN THE  
PORTAL AT 10485 AND APPROXIMATELY CHAINAGE  
10620. THE CREST DRAIN IN THIS AREA WILL ALSO  
EXTEND BEYOND THIS BOUNDARY.

KEY:

-  VRS - VEHICLE RESTRAINT SYSTEM
-  EDGE OF VERGE
-  EDGE OF HARDSTRIP
-  EDGE OF CARRIAGEWAY
-  CENTRE LINE OF LANE
-  EDGE OF CENTRAL RESERVE
-  CUTTING
-  EDGE OF DAMS MITIGATION AREA, NOTE SOUTHERN
-  BOUNDARY TO BE EXTENDED SOUTH IN
-  ACCORDANCE TO DQ237
-  INSIDE FACE OF STRUCTURE

|     |           |                        |       |         |       |       |  |
|-----|-----------|------------------------|-------|---------|-------|-------|--|
|     |           |                        |       |         |       |       |  |
|     |           |                        |       |         |       |       |  |
|     |           |                        |       |         |       |       |  |
|     |           |                        |       |         |       |       |  |
| P01 | 12/02/21  | FOR QUALITY SUBMISSION | DM    | PQ      | MN    | MR    |  |
| Rev | Rev. Date | Purpose of revision    | Drawn | Checked | Rev'd | App'd |  |

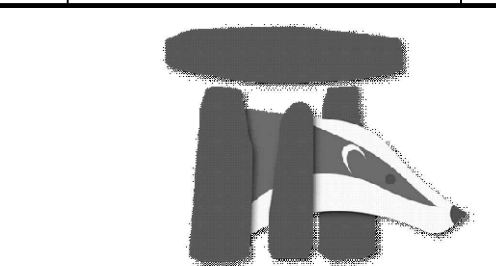

Client 

|         |                                  |
|---------|----------------------------------|
| Project | A303<br>Amesbury to Berwick Down |
|---------|----------------------------------|

Drawing title

EASTERN  
TUNNEL APPROACH  
SHEET 1 OF 4

Drawing status  
**S4 - SUITABLE FOR STAGED APPROVAL**

|               |             |              |     |
|---------------|-------------|--------------|-----|
| State Code    | Preliminary |              |     |
| Project Stage | PCF Stage 5 |              |     |
| Scale         | AS SHOWN    | DO NOT SCALE |     |
| Jacobs No.    | HE551506    | Rev          | P01 |
| Client no.    | HE551506    |              |     |

Drawing number  
 HE551506 - BGR - STU -  
 Location  
 SWSREP0Z -DR- S -0003



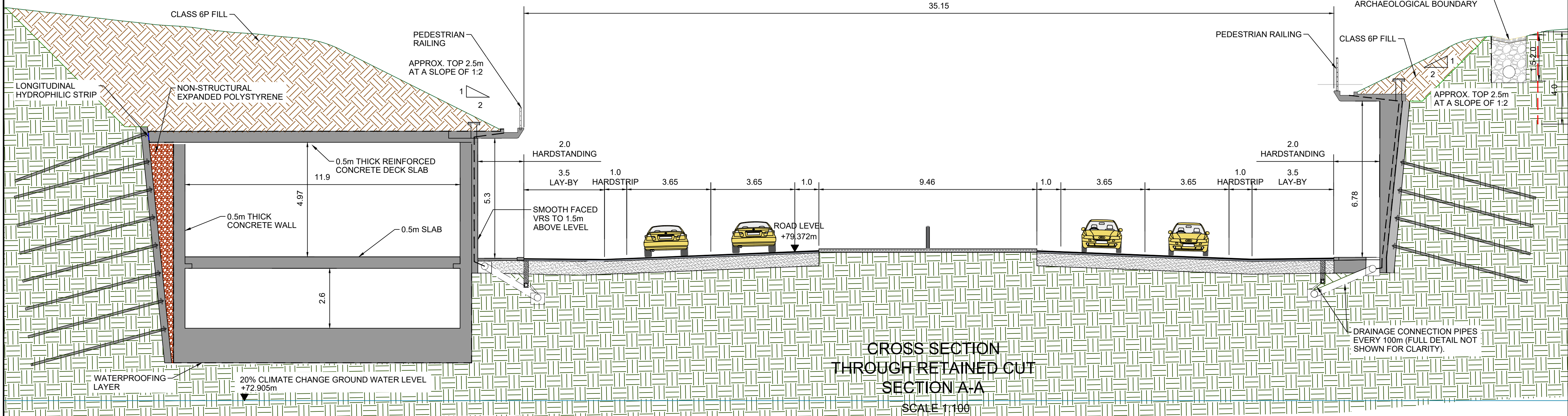

| SOIL NAIL TABLE     |            |                  |                             |             |                |              |
|---------------------|------------|------------------|-----------------------------|-------------|----------------|--------------|
| TOTAL CUTTING DEPTH | FACE DEPTH | BACK SLOPE DEPTH | NUMBER OF NAILS PER SECTION | NAIL LENGTH | NAIL SPACING   |              |
|                     |            |                  |                             |             | VERTICAL       | OUT-OF-PLANE |
| m                   | m          | m                |                             | m           | m              | m            |
| 16.0                | 13.5       | 2.5              | 12                          | 10.0        | 1.2 (0.7m Top) | 1.2          |
| 15.0                | 12.5       | 2.5              | 11                          | 9.0         | 1.2            | 1.2          |
| 14.0                | 11.5       | 2.5              | 10                          | 9.0         | 1.2            | 1.2          |
| 13.0                | 10.5       | 2.5              | 9                           | 9.0         | 1.2            | 1.2          |
| 12.0                | 9.5        | 2.5              | 8                           | 9.0         | 1.2            | 1.2          |
| 11.0                | 8.5        | 2.5              | 7                           | 8.0         | 1.2            | 1.2          |
| 10.0                | 7.5        | 2.5              | 7                           | 8.0         | 1.2 (0.7m Top) | 1.2          |
| 9.0                 | 6.5        | 2.5              | 6                           | 8.0         | 1.2            | 1.2          |
| 8.0                 | 5.5        | 2.5              | 5                           | 7.0         | 1.2            | 1.2          |
| 7.0                 | 4.5        | 2.5              | 4                           | 7.0         | 1.2            | 1.2          |
| 6.0                 | 3.5        | 2.5              | 3                           | 7.0         | 1.2            | 1.2          |
| 5.0                 | 2.5        | 2.5              | 3                           | 6.0         | 1.2 (0.7m Top) | 1.2          |
| 4.0                 | 2.5        | 2.5              | 2                           | 6.0         | 1.0            | 1.2          |

SOIL NAIL TABLE  
SCALE NTS

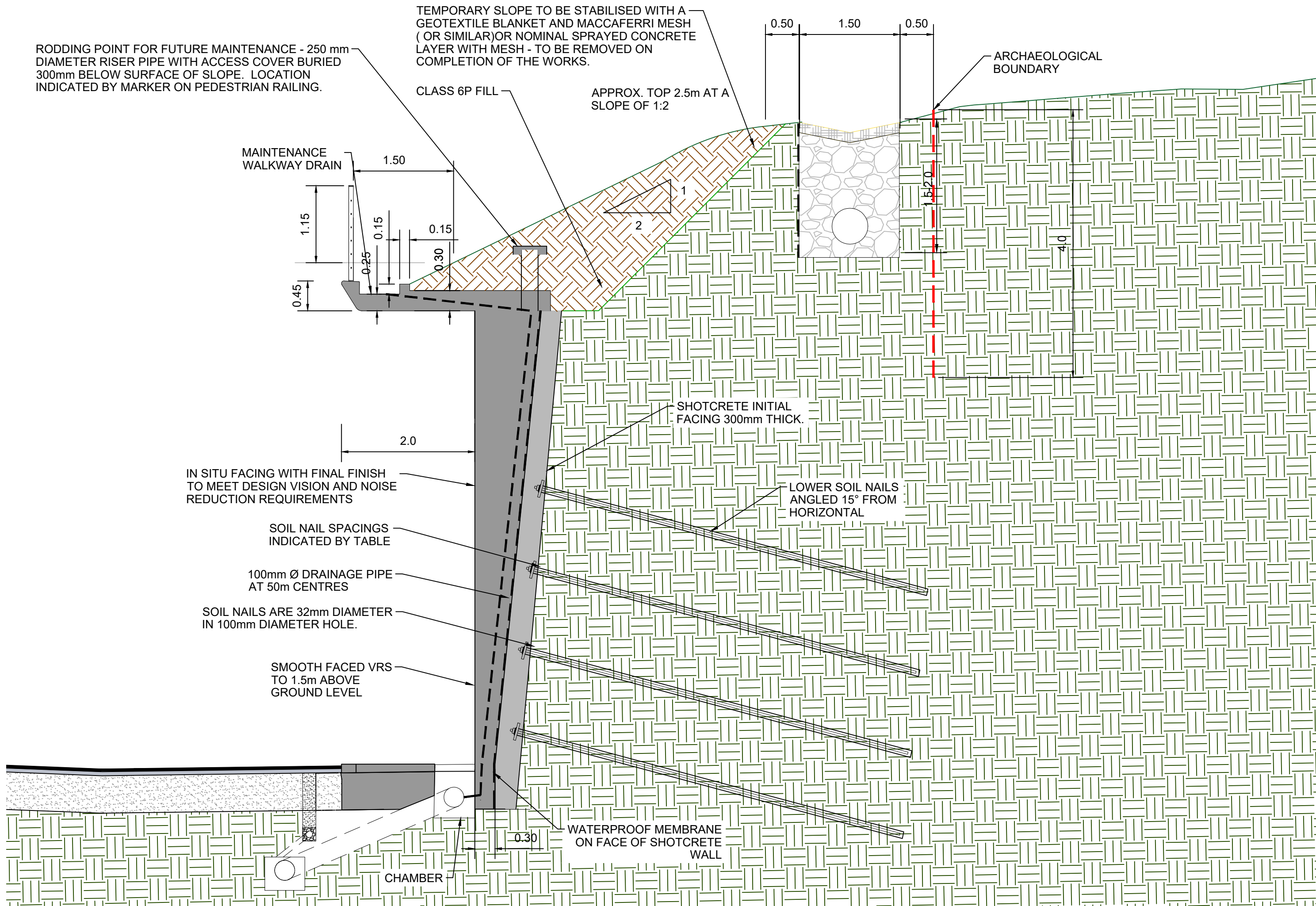

TYPICAL SOIL NAIL DETAIL  
SCALE 1:50

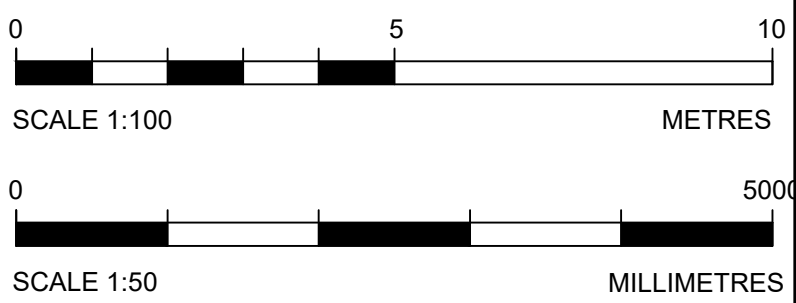

NOTES:

1. ALL DIMENSIONS ARE IN METRES UNLESS NOTED OTHERWISE.
2. STANDARD HIGHWAY INFILTRATION DRAINAGE SYSTEM PROPOSED FOR THIS SECTION, NOT SHOWN FOR CLARITY. FOR DETAILS PLEASE SEE REPORT HE551506-BGR-HDG-SWGN000Z-RP-D0002.
3. FOR SOIL NAIL DETAILS SEE DRAWING HE551506-BGR-STU-SWSREP0Z-DR-S-0005.
4. 80 MSA (MIN) ROAD PAVEMENT WITH THIN SURFACING COURSE SYSTEM (ROAD/TYRE NOISE LEVEL 3) IN ACCORDANCE WITH SCOPE 10.1.2, 10.2.3 AND TABLE 10.1
5. VRS BUILT INTO FACADE OF TSB. SEPARATE BARRIER INFRONT OF BUILDING NOT REQUIRED.

MATERIAL VISUALISATION

- EDGE TREATMENT AND VEHICLE RESTRAINT SYSTEM (VRS) CAST CONCRETE, SMOOTH FINISH, WARM COLOUR
- PEDESTRIAN FENCE BESPOKE PRE-WEATHERED GALVANISED STEEL FENCE SYSTEM
- WALL FINISH ROUGH TEXTURED FINISHED CONCRETE

|                                      |           |                        |       |         |       |        |
|--------------------------------------|-----------|------------------------|-------|---------|-------|--------|
| P01                                  | 12/02/21  | FOR QUALITY SUBMISSION | DM    | PQ      | MN    | MN     |
| Rev                                  | Rev. Date | Purpose of revision    | Drawn | Checked | Rev'd | Appr'd |
|                                      |           |                        |       |         |       |        |
| Client                               |           |                        |       |         |       |        |
| Project                              |           |                        |       |         |       |        |
| A303                                 |           |                        |       |         |       |        |
| Amesbury to Berwick Down             |           |                        |       |         |       |        |
| Drawing title                        |           |                        |       |         |       |        |
| EASTERN TUNNEL APPROACH SHEET 2 OF 4 |           |                        |       |         |       |        |
| Drawing status                       |           |                        |       |         |       |        |
| S4 - SUITABLE FOR STAGED APPROVAL    |           |                        |       |         |       |        |
| State Code                           |           |                        |       |         |       |        |
| Preliminary                          |           |                        |       |         |       |        |
| Project Stage                        |           |                        |       |         |       |        |
| PCF Stage 5                          |           |                        |       |         |       |        |
| Scale                                |           |                        |       |         |       |        |
| AS SHOWN                             |           |                        |       |         |       |        |
| DO NOT SCALE                         |           |                        |       |         |       |        |
| Jacobs No.                           |           |                        |       |         |       |        |
| HE551506                             |           |                        |       |         |       |        |
| Client no.                           |           |                        |       |         |       |        |
| HE551506                             |           |                        |       |         |       |        |
| Drawing number                       |           |                        |       |         |       |        |
| P01                                  |           |                        |       |         |       |        |
| Originator                           |           |                        |       |         |       |        |
| Volume                               |           |                        |       |         |       |        |
| HE551506 - BGR - STU -               |           |                        |       |         |       |        |
| SWSREP0Z                             |           |                        |       |         |       |        |
| Location                             |           |                        |       |         |       |        |
| Type                                 |           |                        |       |         |       |        |
| Role                                 |           |                        |       |         |       |        |
| Number                               |           |                        |       |         |       |        |
| -DR- S -0004                         |           |                        |       |         |       |        |



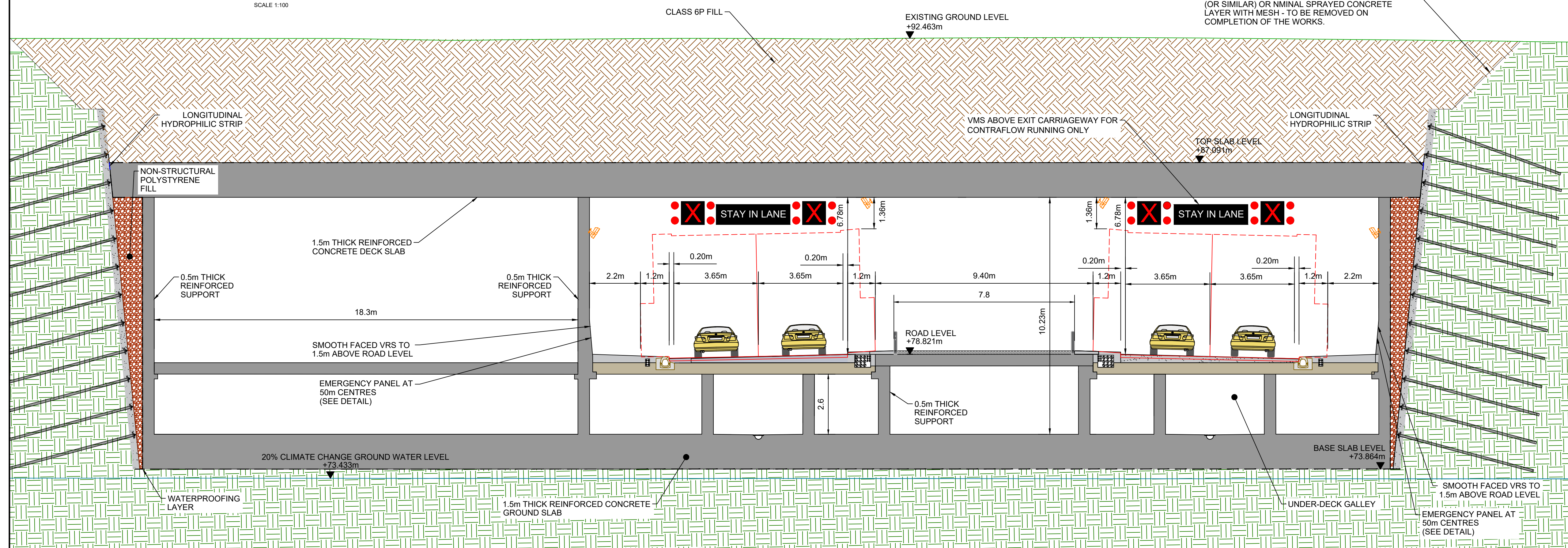
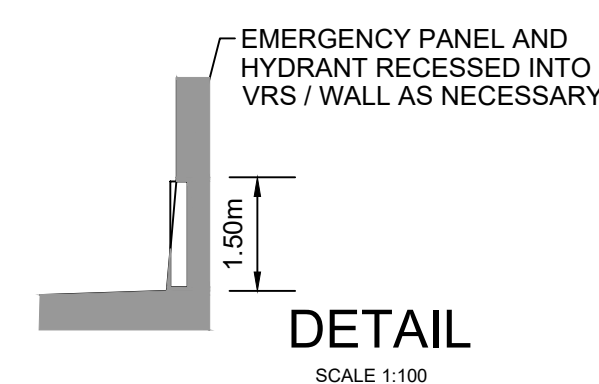
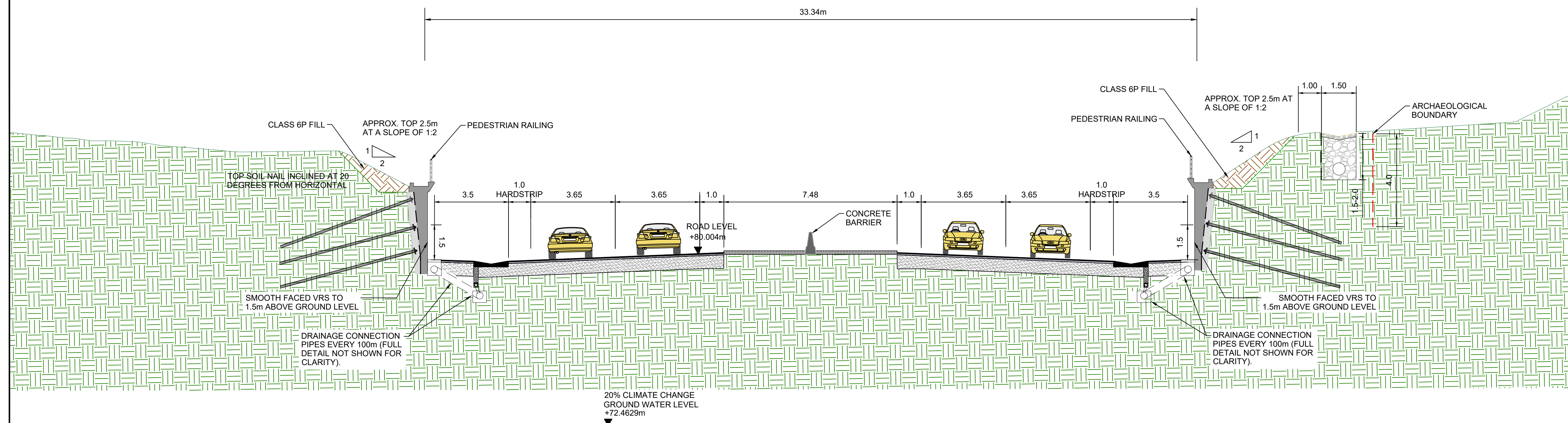

CROSS SECTION THROUGH THE  
CUT AND COVER AT CH.10485.00  
SECTION D-D

SCALE 1:100

Reproduced by permission of Ordnance Survey on behalf of HMSO. © Crown copyright and database right 2019. All rights reserved. Ordnance Survey Licence number 100030649.

NOTES:

1. ALL DIMENSIONS ARE IN METRES UNLESS NOTED OTHERWISE.
2. STANDARD HIGHWAY INFILTRATION DRAINAGE SYSTEM PROPOSED FOR THIS SECTION, NOT SHOWN FOR CLARITY. FOR DETAILS PLEASE SEE REPORT HE551506-BGR-HDG-SWGN000Z-RP-D0002.

## MATERIAL VISUALISATION

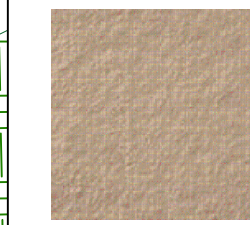

WALL FINISH  
ROUGH TEXTURED FINISHED CONCRETE

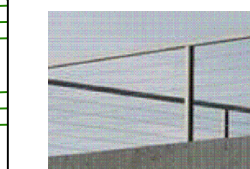

|     |           |                        |       |         |       |         |  |
|-----|-----------|------------------------|-------|---------|-------|---------|--|
|     |           |                        |       |         |       |         |  |
|     |           |                        |       |         |       |         |  |
|     |           |                        |       |         |       |         |  |
|     |           |                        |       |         |       |         |  |
| P01 | 12/02/21  | FOR QUALITY SUBMISSION | DM    | PQ      | MN    | MN      |  |
| Rev | Rev. Date | Purpose of revision    | Drawn | Checked | Rev'd | Apprv'd |  |

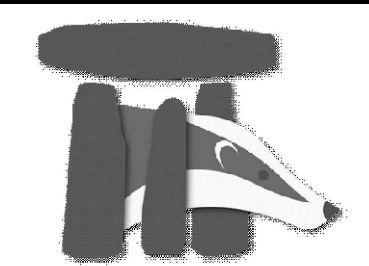

|         |   |
|---------|---|
| Client  |  |
| Project | <p>A303</p> <p>Amesbury to Berwick Down</p>   |

Drawing title

# EASTERN TUNNEL APPROACH SHEET 3 OF 4

Drawing status  
S4 - SUITABLE FOR STAGED APPROVAL

|                |                |   |            |              |        |
|----------------|----------------|---|------------|--------------|--------|
| State Code     | Preliminary    |   |            |              |        |
| Project Stage  | PCF Stage 5    |   |            |              |        |
| Scale          | AS SHOWN       |   |            | DO NOT SCALE |        |
| Jobcode No.    | HE551506       |   |            | Rev          | P01    |
| Client no.     | HE551506       |   |            |              |        |
| Drawing number | PIN            | I | Originator | Volume       |        |
|                | HE551506 - BGR |   | - STU -    |              |        |
|                | Location       |   | Type       | Role         | Number |
|                | SWSREP02       |   | - DR -     | S            | -0005  |



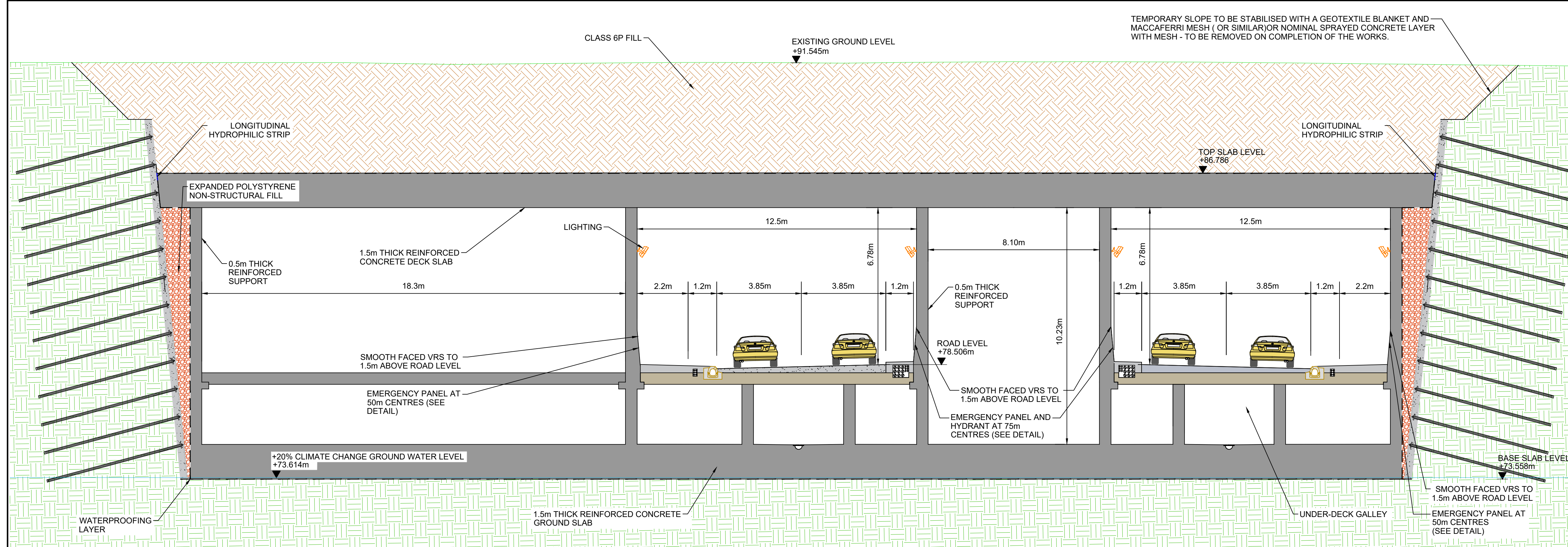

CROSS SECTION THROUGH THE CUT AND COVER AT CH.10460.00 SECTION C-C  
SCALE 1:100

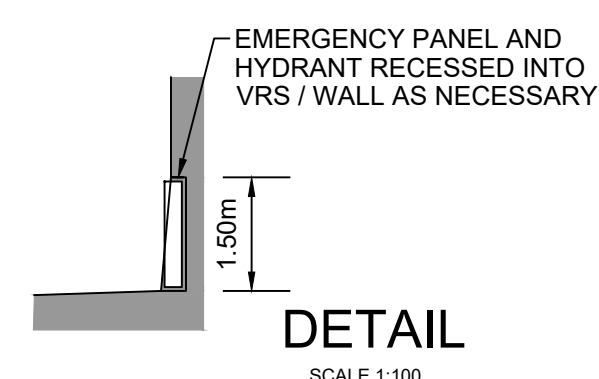

DETAIL  
SCALE 1:100

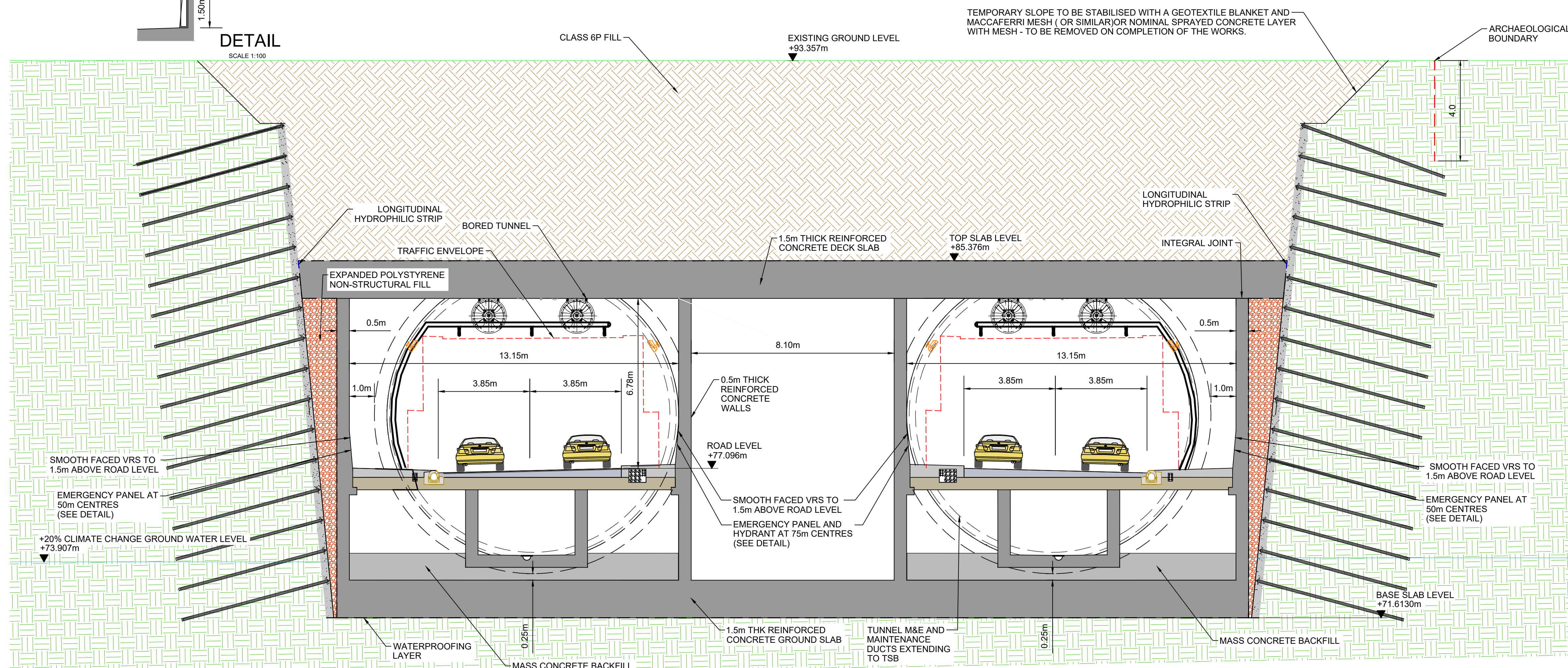

SECTION OF CUT AND COVER AT BORED TUNNEL AT CH.10420.00  
SCALE 1:100

## NOTES:

1. ALL DIMENSIONS ARE IN METRES UNLESS NOTED OTHERWISE.
2. FOR TRAFFIC ENVELOPE, ASSUMED MAINTAINED HEADROOM.
3. ROAD MATERIAL COMPOSED OF 80mm HRA AND 40mm TSCS ABOVE SLAB.

## MATERIAL VISUALISATION

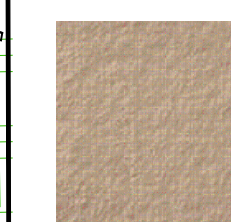

WALL FINISH  
ROUGH TEXTURED FINISHED CONCRETE

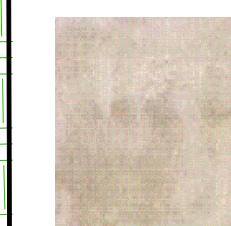

EDGE TREATMENT & VEHICLE RESTRAINT SYSTEM (VRS)  
CAST CONCRETE, SMOOTH FINISH, WARM COLOUR

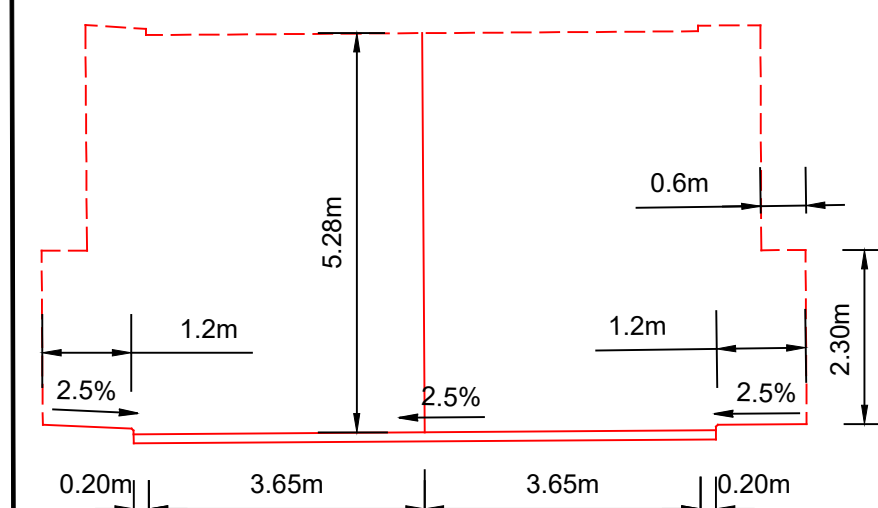

TRAFFIC ENVELOPE  
SCALE 1:100

| Rev | Rev. Date | Purpose of revision    | Drawn | Checked | Rev'd | Appr'd |
|-----|-----------|------------------------|-------|---------|-------|--------|
| P01 | 12/02/21  | FOR QUALITY SUBMISSION | DM    | PQ      | MN    | MN     |

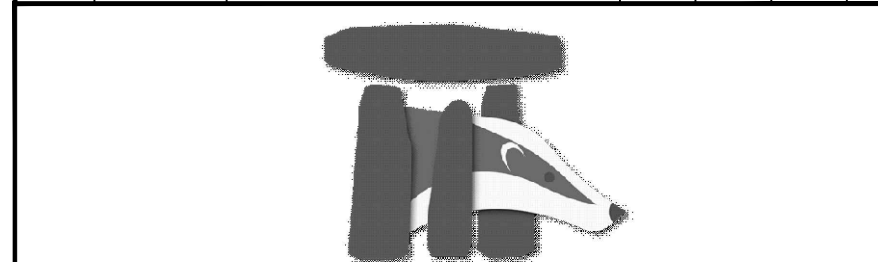

Client  
**highways  
england**

Project  
A303  
Amesbury to Berwick Down

Drawing title  
**EASTERN  
TUNNEL APPROACH  
SHEET 4 OF 4**

Drawing status  
**S4 - SUITABLE FOR STAGED APPROVAL**

|               |             |              |
|---------------|-------------|--------------|
| State Code    | Preliminary | DO NOT SCALE |
| Project Stage | PCF Stage 5 |              |
| Scale         | AS SHOWN    |              |
| Jacobs No.    | HE551506    |              |
| Client no.    | HE551506    |              |

Drawing number  
**HE551506 - BGR - STU -**  
Location  
**SWSREP0Z**  
Volume  
**-DR- S -0006**