

Floor Plan

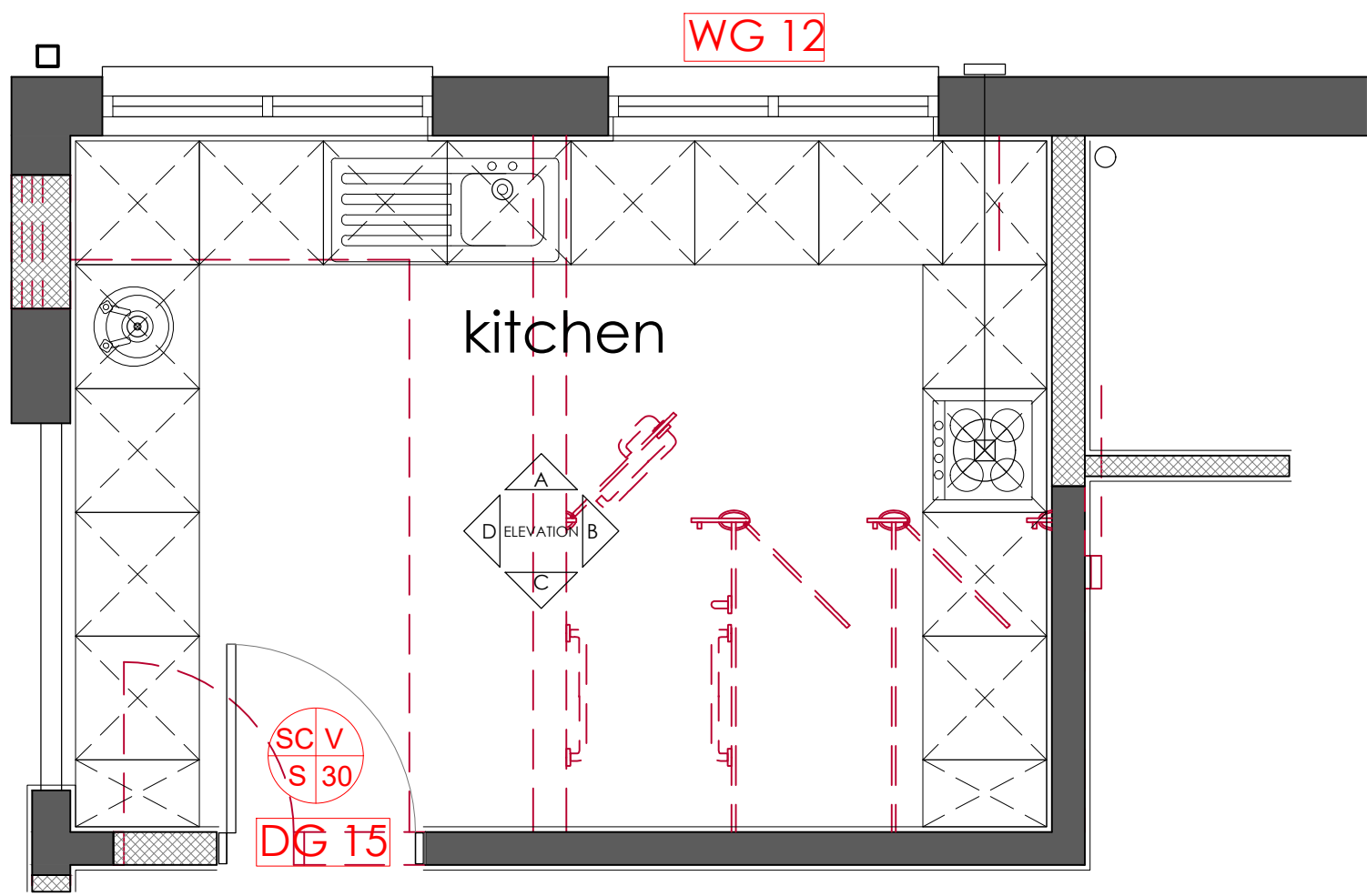

Elevations

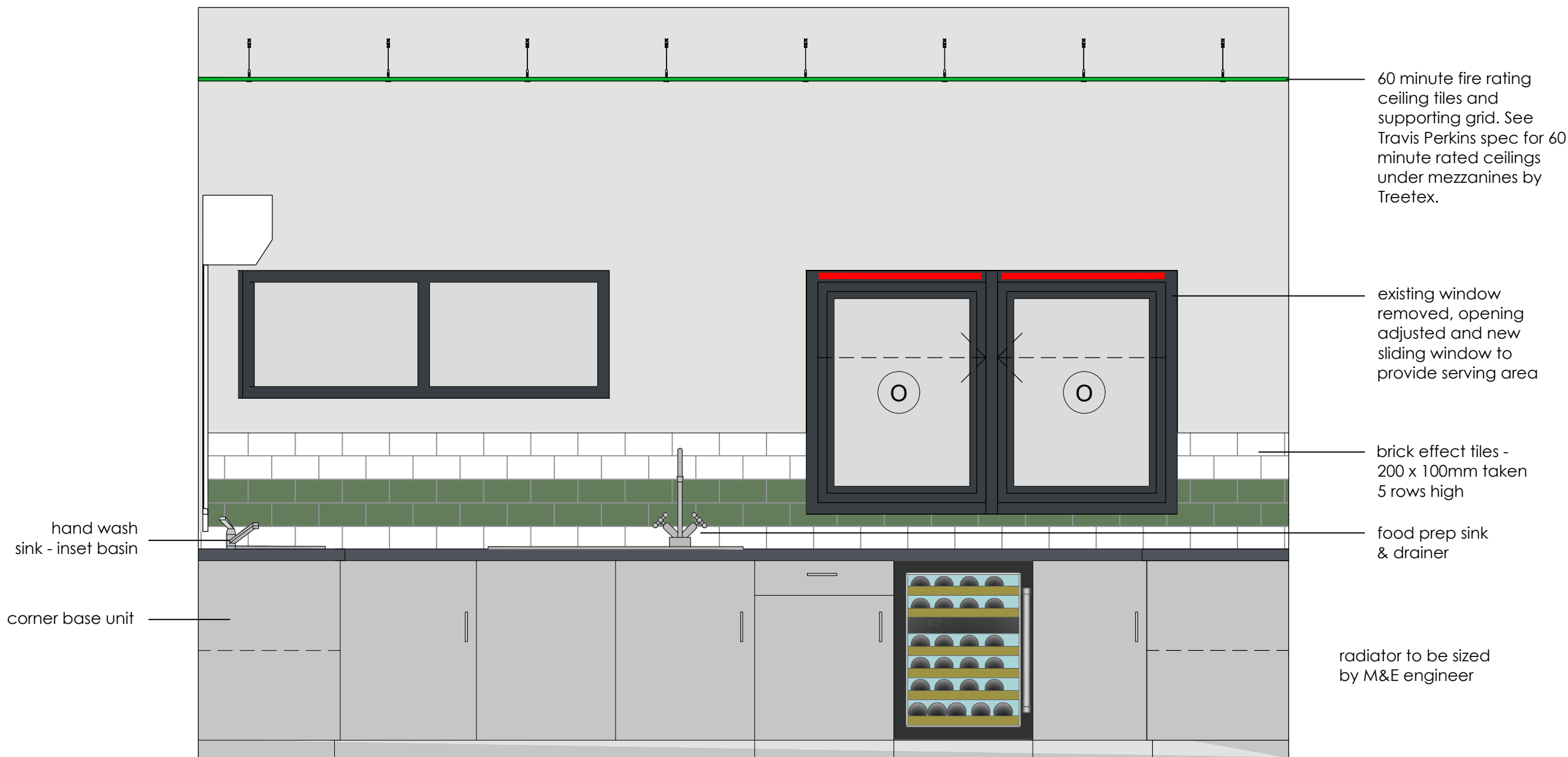

Elevation A

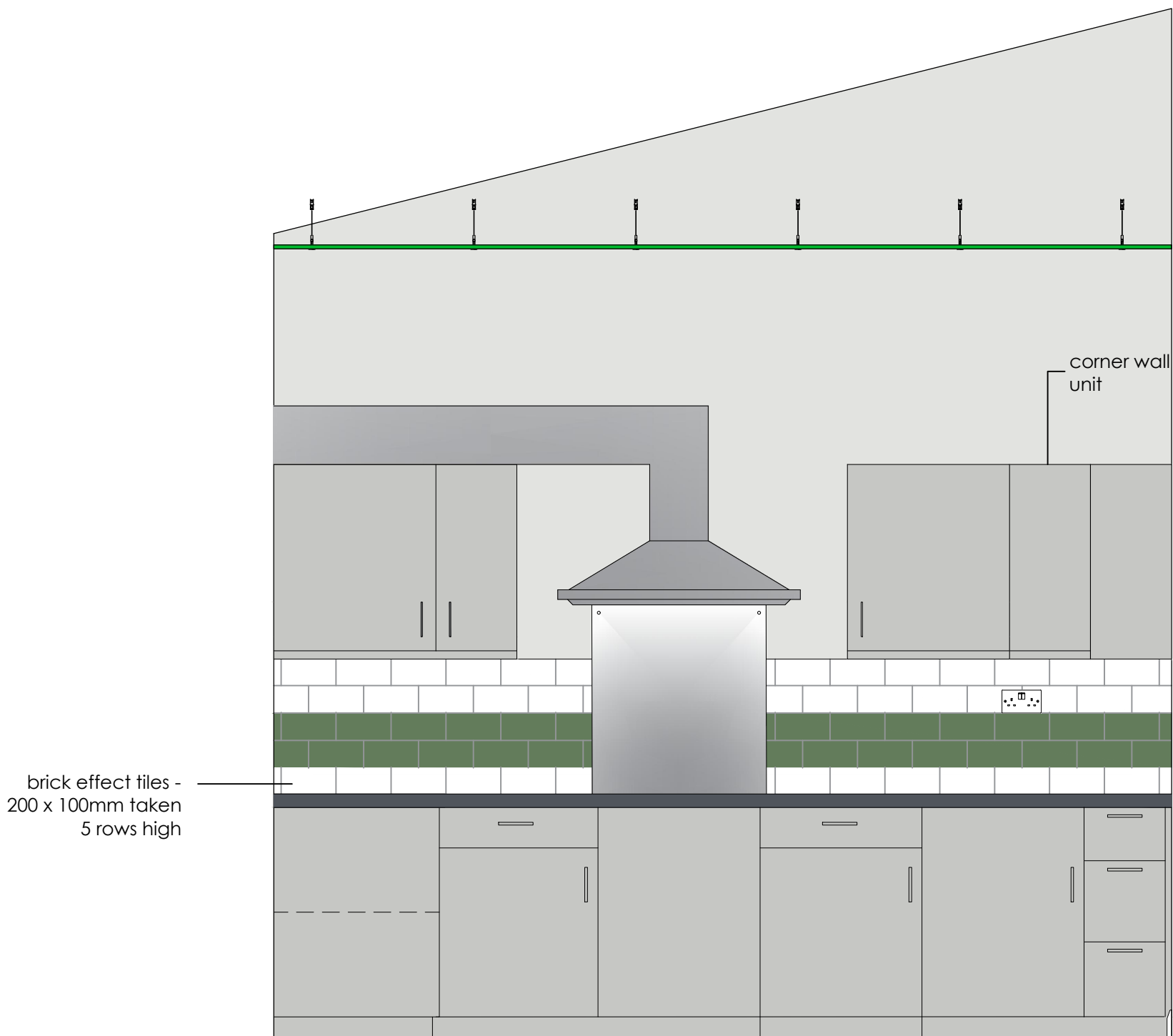

Elevation B

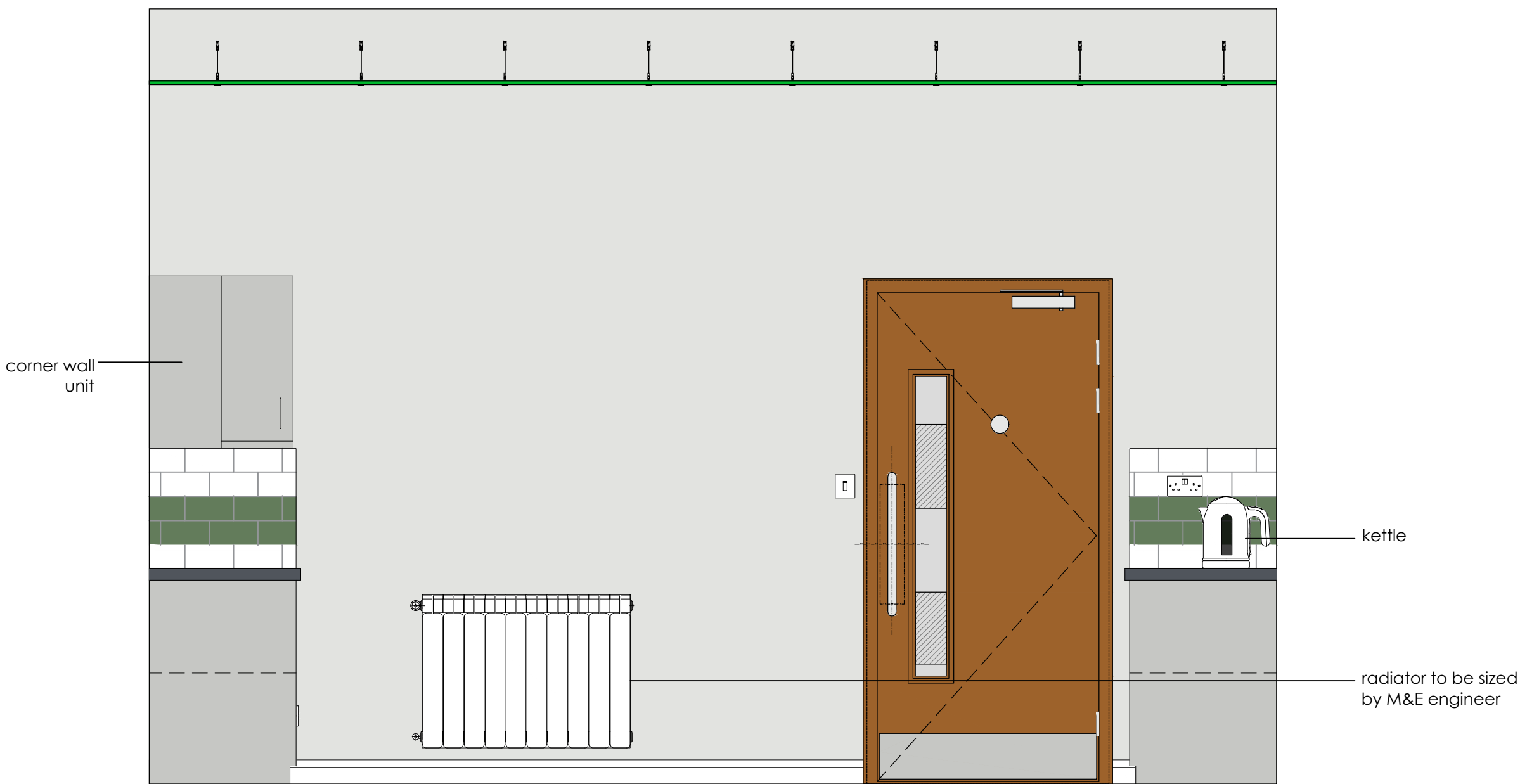

Elevation C

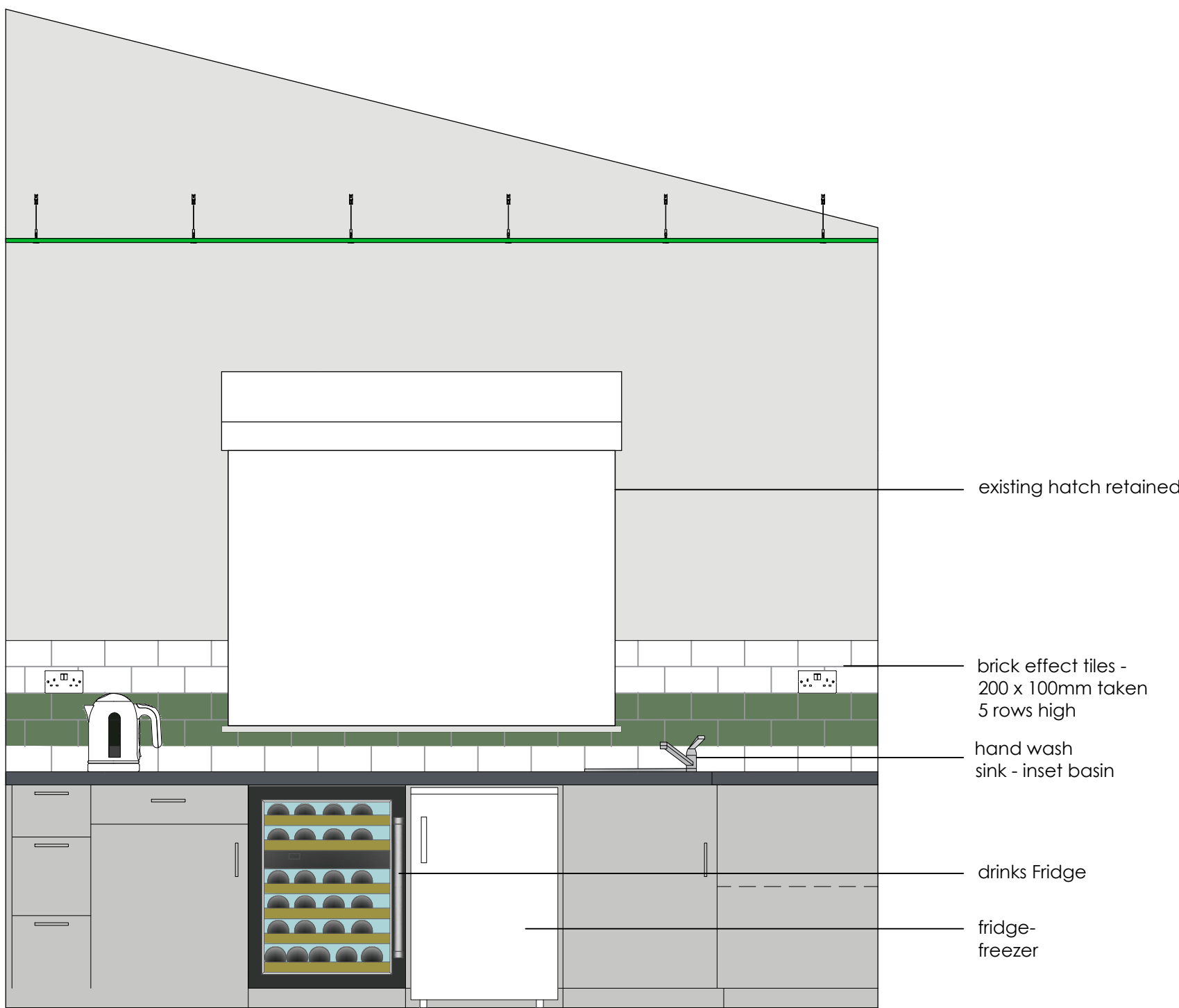

Elevation D

COPYRIGHT NOTICE:
This drawing is the copyright of the Architects and may not be reproduced or used except by written permission.

Notes
This drawing is to be used in conjunction with all relevant drawings and specifications. Do not scale from this drawing. Use figures dimensions only. All levels and dimensions to be checked on site. All level and dimensional discrepancies are to be brought to the immediate attention of HSP Architects Ltd. Responsibility cannot be accepted for alteration or deviation from the design without prior acknowledgement of HSP Architects Ltd.
Copyright reserved. This drawing may only be used for the client and location specified in this block. It may not be copied or distributed to any other third party without prior written consent from HSP Architects Ltd.
Prior to any work commencing on site, the engineer is to be contacted regarding the current status, revision or regulatory approval of the drawing.
All work to be to the entire satisfaction of the H&M or Local Authority not withstanding anything drawn or indicated on these drawings. All waterworks and repairs to be the best of their respective kind and of equal equivalent to the standards herein stated. Code of Practice. All materials and items to be obtained or checked and verified on the before specific areas of work are commenced.
This drawing is to be used in conjunction with client specifications/requirements and structural engineers design.

T1 230315 SG issued for review and comment
Revision Notes.
Drawing Status.

INFORMATION

hssp
architects

Pera Business Park, Nottingham Road
Milton Mowbray, LE13 0PB

Telephone: 01664 563 288 Fax: 01664 563 360
E-Mail: info@hssparchitects.co.uk Web: www.hssparchitects.co.uk

Project:
Proposed Extensions and Alterations to
Jubilee Hall
Stadon Rod, Anstey
For Anstey Parish Council

Title:
Indicative Room Layout - Kitchen

| | | | |
|----------------------------|-----------------|----------------|--------------------|
| Scale: N.T.S. | Drawn: SG | Checked: HC | Date: March '23 |
| Drawing No: 7728-04-014 | Revision: T1 | | |

HSSP A1