

0m 2.5m

1 Proposed Building Section A  
1:50

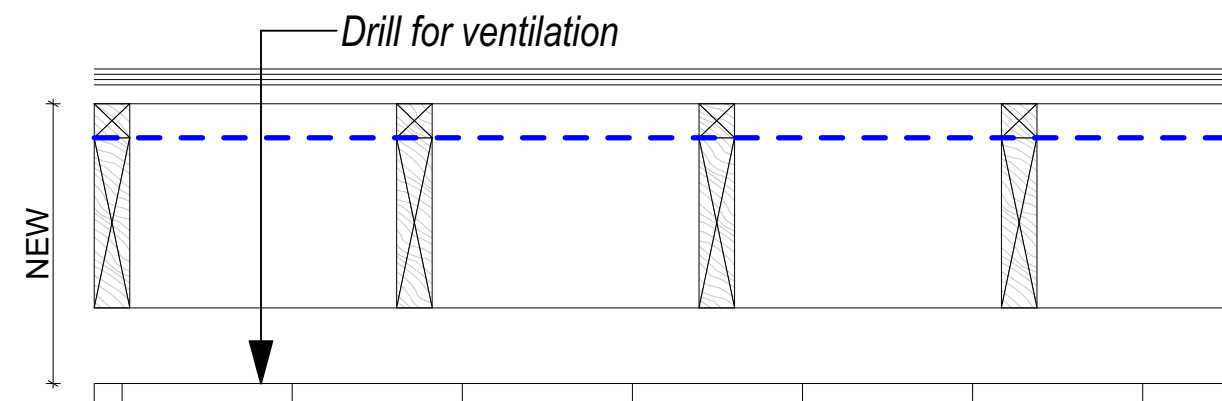

Roof C lower- membrane below counter batten

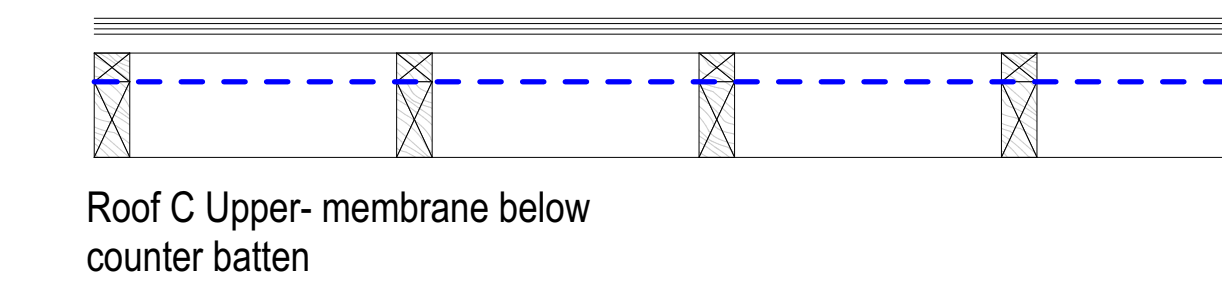
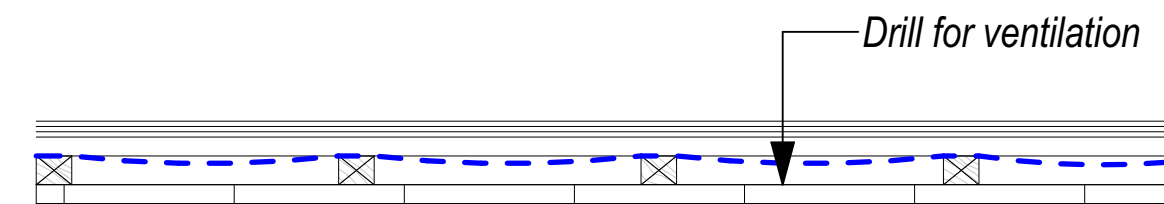
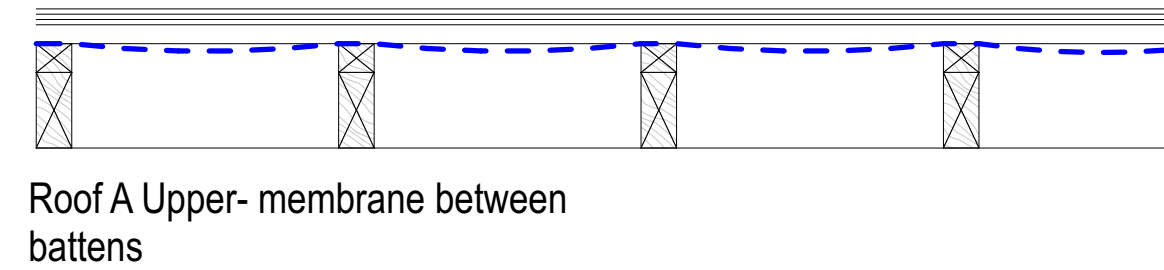

Roof A Lower- membrane between battens

Roof C Upper:

New slates H62  
50x25mm slating battens H62  
50x38mm Counter battens H62  
Breather membrane below counter battens pulled taut  
100x45 Existing rafters G20

Roof C Lower:

New slates H62  
50x25mm slating battens H62  
50x47mm Counter batten (to build up to meet A upper truss check on site) H62  
Breather membrane below counter battens pulled taut  
47x225mm New C16 Rafters @ 400 centres G20  
140mmx100mm deep, New C24 purlin secured to existing purlins over matchboarding- to  
140mmx25mm Existing match boarding (Drilled for ventilation) K20  
140mmx100mm Existing purlins @ Approx 1m centres G20

Roof A Upper:

New slates H62  
50x25mm slating battens H62  
Breather membrane 10mm drape between counter battens  
50x38mm Counter batten H62  
100x45 Existing rafter G20

Roof A Lower:

New slates H62  
50x25mm slating battens H62  
Breather membrane 10mm drape between counter battens  
50x38mm Counter batten H62  
140mmx25mm Existing match boarding (drilled for ventilation) K20  
140mmx100mm Existing purlins @ approx 1m centres G20

Warm roof non ventilated  
Bauder total roof system to achieve 0.17W/m2k

5mm K5K Capping sheet  
3mm KSA Duo Underlayer  
120mm PIR FA-TE Flatboard Insulation  
Vapour control layer

Make provision for new guard rail standards to butt to wall head

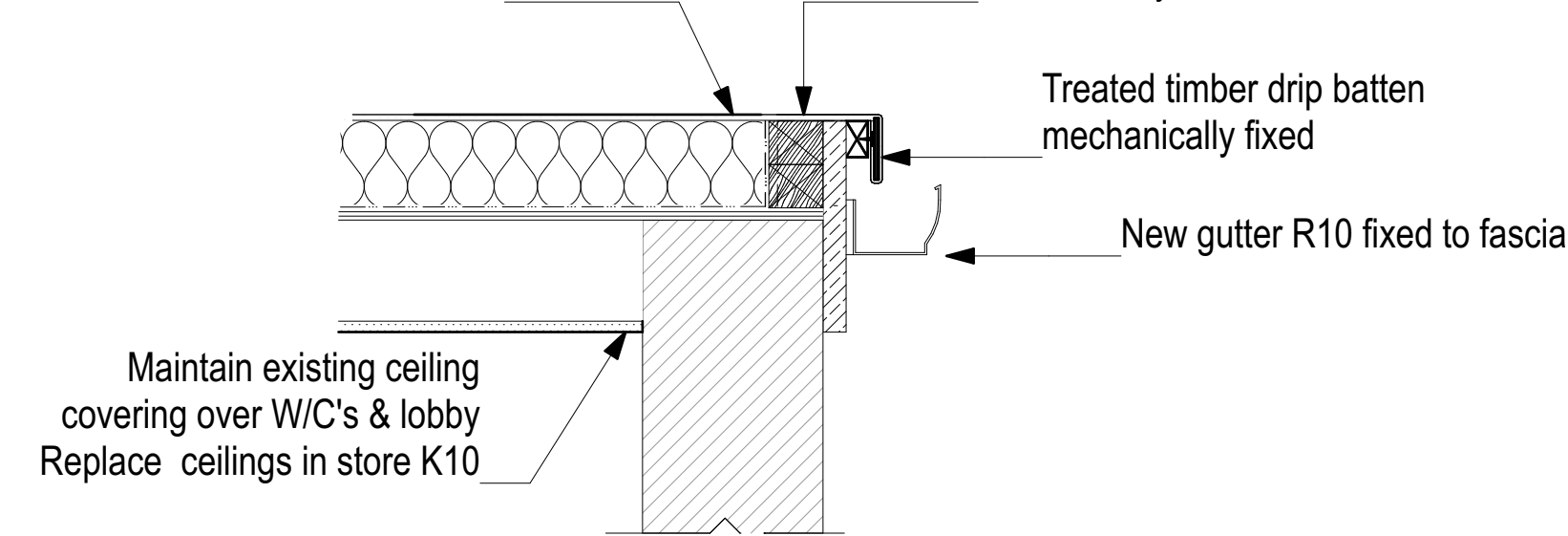

0m 0.5m

D-03 Generic Flat Roof Eaves detail  
1:10

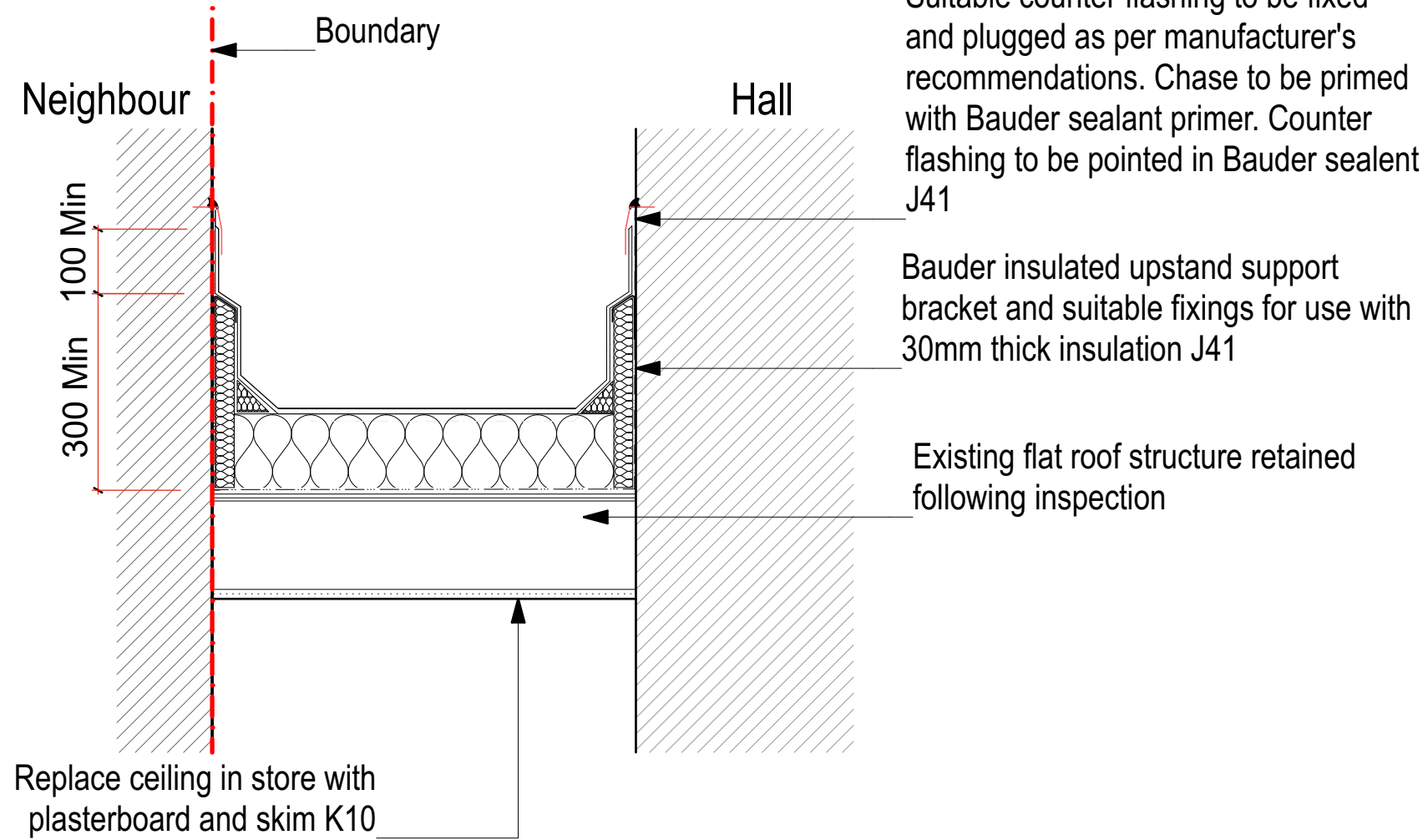

0m 0.5m

D-02 Generic Flat roof Abutment Detail  
1:10

New PVCu Gutter with min 61mm square outlet. G20

25mm Over fascia vent to provide eaves ventilation leading to ridge ventilation with underlay support tray lapped under the breather membrane. Cut tilting fillet to allow airflow. G20

New pointed natural stone wall built up to meet new eaves height F20

New 170 x 32 Douglas fir fascia paint finish G20

Ventilation

Additional insulation to U/S of existing P10

Neighbouring building

0m 0.5m

D-01 Generic pitched roof eaves detail  
1:10

Construction Risks  
In addition to the hazards normally associated with the types of work detailed on this drawing take note of the above. It is assumed that all works on this drawing will be carried out by a competent contractor working, where appropriate, to an appropriate method statement.

Maintenance/Cleaning Risks  
Safety Health and Environmental Information Box

Disclaimer  
This document and its design content is copyright ©. It shall be read in conjunction with all other associated project information including models, specifications, schedules and related consultants documents. Do not scale from documents. All dimensions to be checked on site. Immediately report any discrepancies, errors or omissions on this document to the Originator. If in doubt ASK.

01 - First issue 07/07/2022

RevID ChID Change Name Date

Project  
Okehampton Charter Hall, Devon

Client  
Okehampton Town Council

Layout Name  
Proposed Section A and details

Project Number  
020-28

Drawing Number  
203

Revision  
01

Scales at A1  
1:50, 1:10

Checked By  
MK

Purpose of Issue  
Tender

PLACE  
architects

people@placearchitects.co.uk  
01566 772035