

Notes

THIS DRAWING READ IN CONJUNCTION WITH:

- S&M Structural Design Drawings and Documentation
- SITE SET UP AND WELFARE

Contractor to note it is anticipated that as part of the contract the welfare (hot and cold water) and location for rest / lunch will be provided by the client within the adjacent building.

As such the contractor will only need to provide the H&S signage and materials required to secure site. This will include a position for a skip to be located (see adjacent). The preference is for the skip to be lockable and on a way out of the site. The skip should be sited so the client is to be advised and decisions made. The skip must be fenced in with herts fencing.

All parking to be on street.

The contractor is also to allow for any storage cabins required.

Due to the nature of the works with external grounds and mess, a portable should be brought to site by the contractor for the duration of the works.

EXTRA OVER COSTS

Should welfare not be able to be provided on site due to a change in circumstances the contractor is to provide the client with an extra over cost for providing a fully self sufficient (own drainage, water and generation) welfare cabin to provide, rest, hot and cold water, change and toilet facilities.

The location of the possible units is as noted on the plan adjacent.

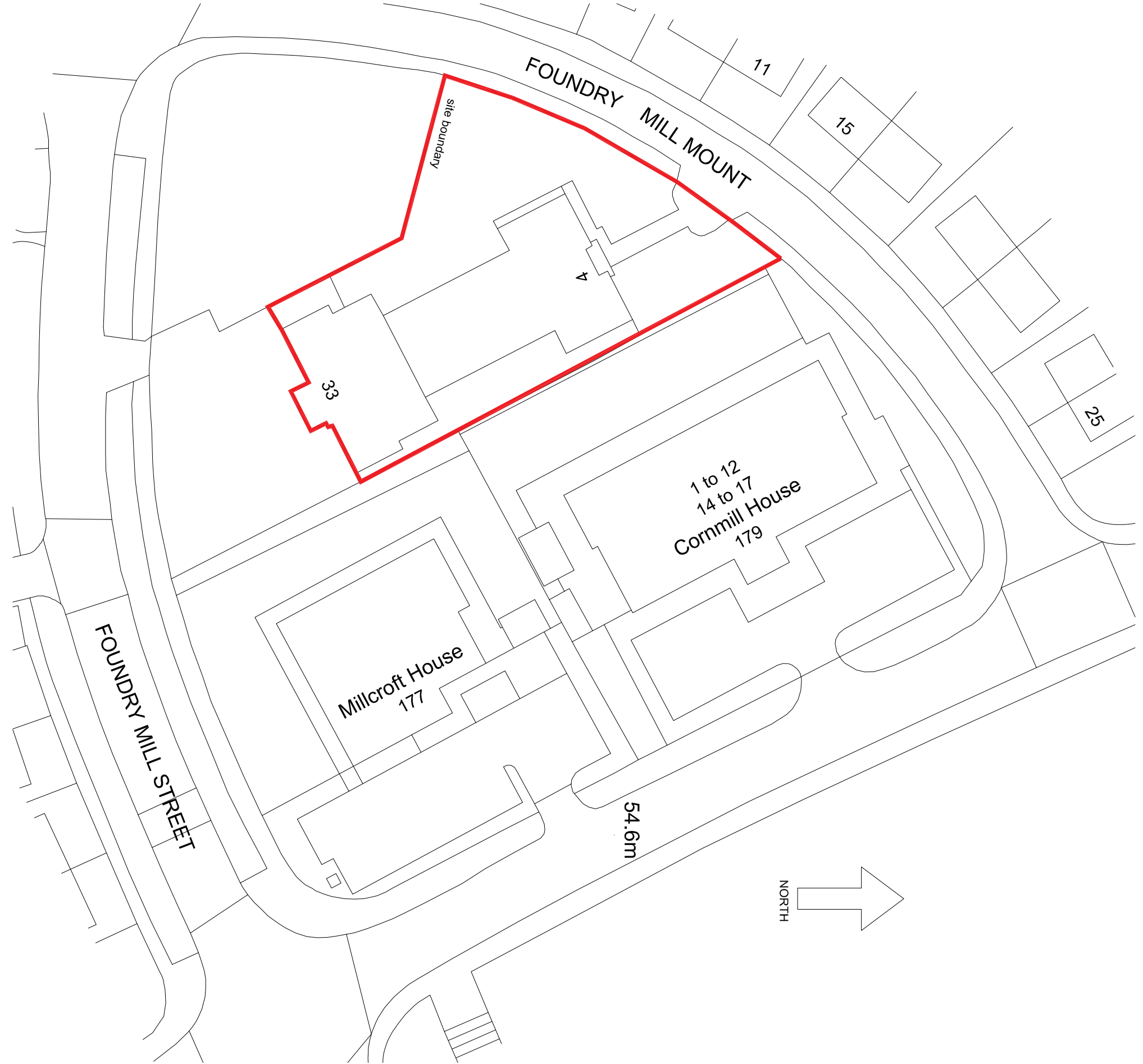

Site Location Plan  
Scale 1:500 @ A2



Plan as Existing  
Scale 1:50 @ A2

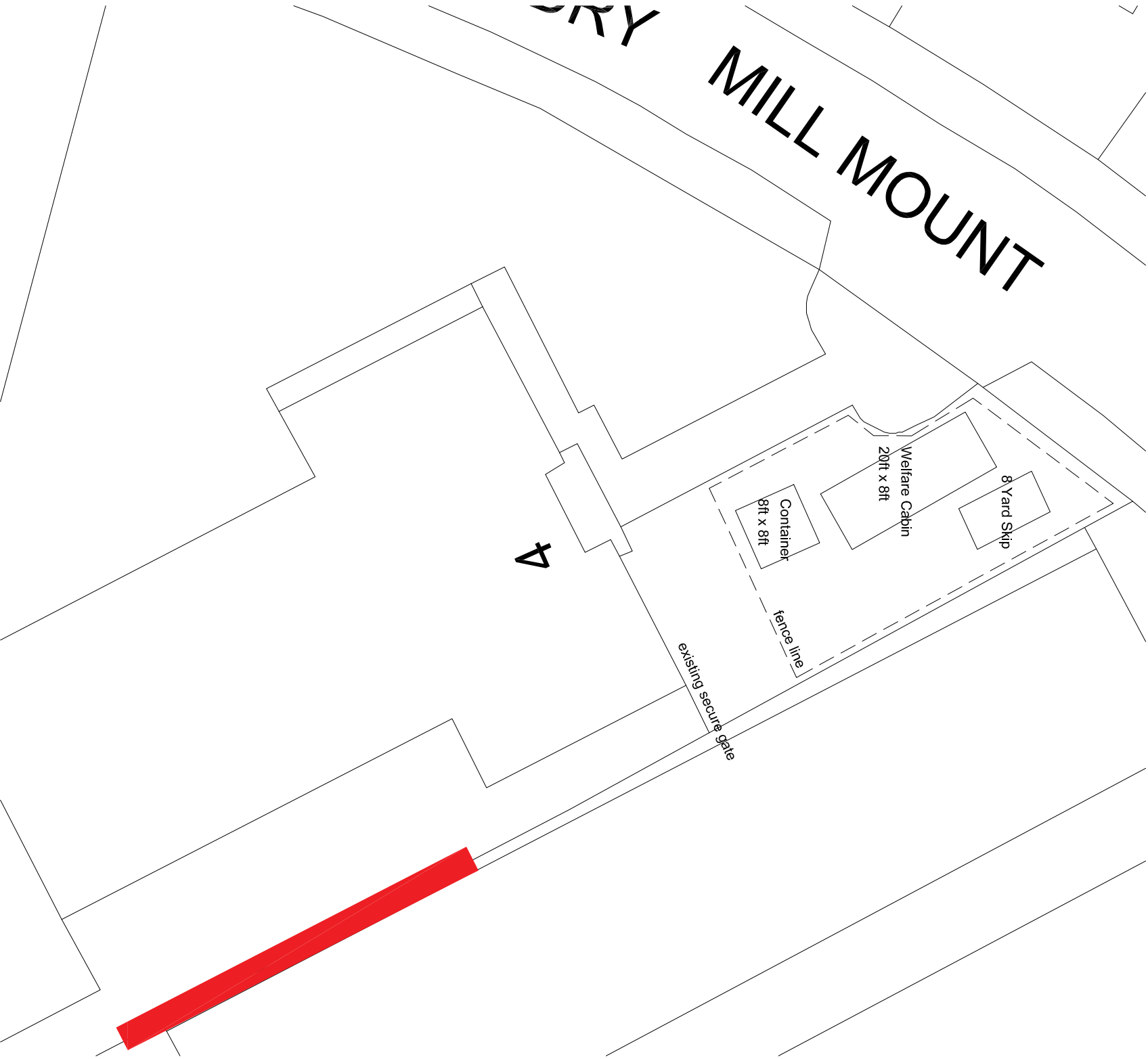

Indicative Site Set Up Options  
Scale 1:200 @ A2

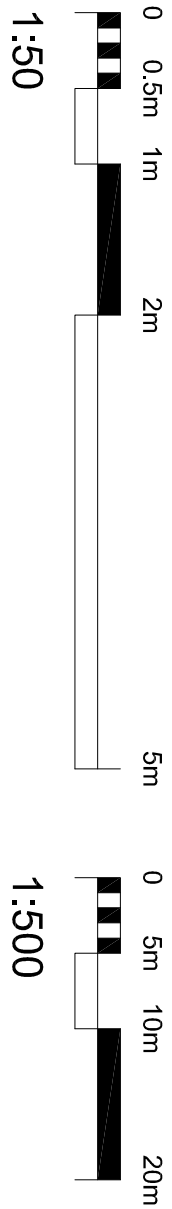

A&R Building Consultancy Ltd  
1000, 1000, 1000, 1000  
High Street  
Huddersfield  
HUT Ltd  
United Kingdom

client

Leeds Federated Housing Association

project

4 Foundry Mill Lane  
Retaining Wall

drawing

Existing Plan

project number	As Shown	As Shown	@A1
2021.0054.002	rev	status	
drawing number	A	issue date	
SK 001		tender	

This drawing is to be used in conjunction with all related drawings. All dimensions shall be checked and verified on site before commencing any work or providing shop drawings. The copyright shall be retained immediately on any discrepancy. This drawing is copyright and remains the property of A&R.