

**SHOTTON COLLIERY
COMMUNITY PARK**

PROPOSED 1500 DRAINAGE RUN AT
1:80 - ROUTED TO AVOID TREE ROOTS
SILT TRAP

EXCAVATED MATERIAL USED TO FORM
LANDSCAPE MOUNDING INCORPORATING
NEW TREE PLANTING

1000 PERFORATED PIPE - SEE SECTION
DRAWING 2015 DETAILS

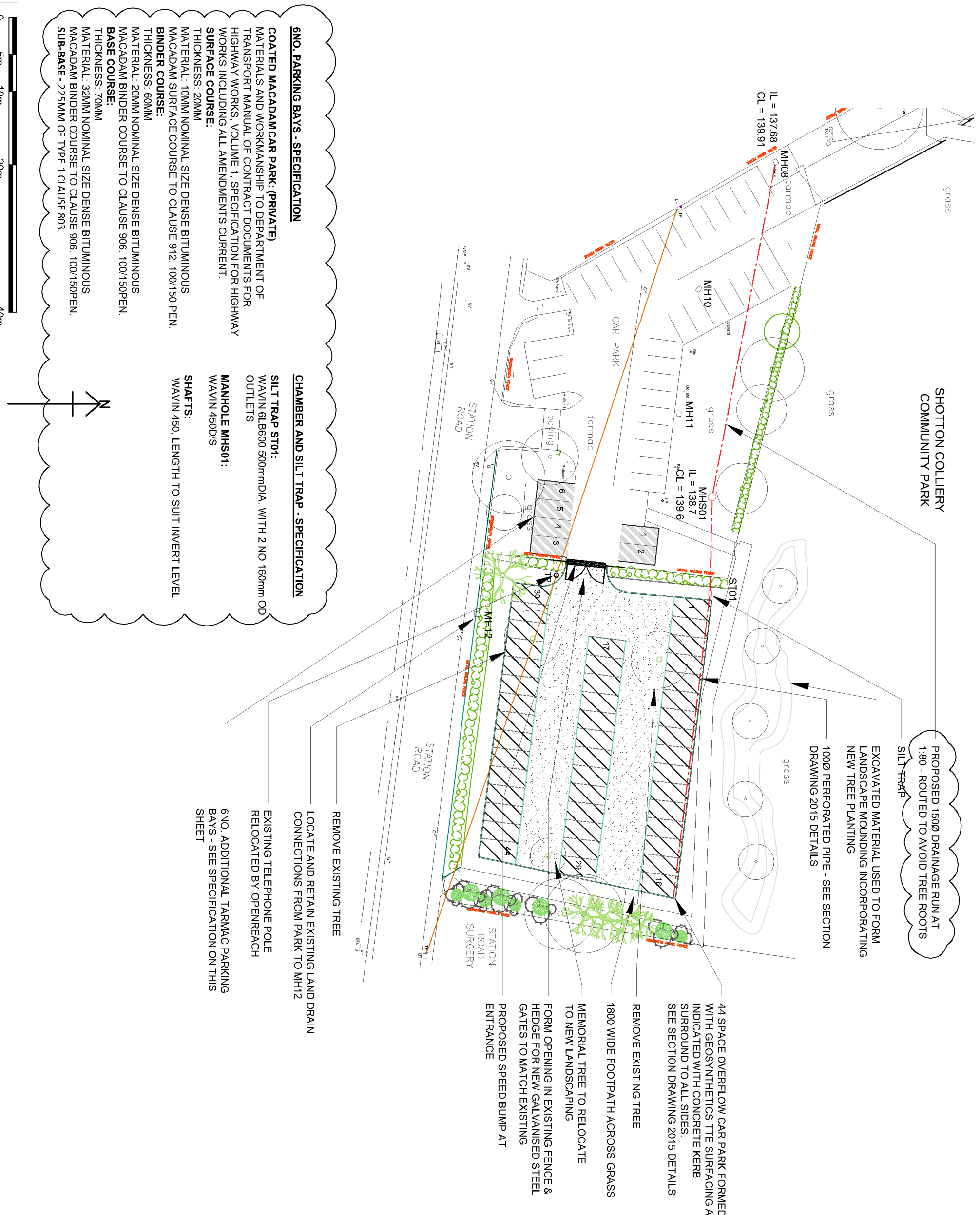

44 SPACE OVERFLOW CAR PARK FORMED
WITH GEOSYNTHETICS TTE SURFACING AS
INDICATED WITH CONCRETE KERB
SURROUND TO ALL SIDES.
SEE SECTION DRAWING 2015 DETAILS

REMOVE EXISTING TREE

1800 WIDE FOOTPATH ACROSS GRASS

MEMORIAL TREE TO RELOCATE
TO NEW LANDSCAPING

FORM OPENING IN EXISTING FENCE &
HEDGE FOR NEW GALVANISED STEEL
GATES TO MATCH EXISTING

PROPOSED SPEED BUMP AT
ENTRANCE

REMOVE EXISTING TREE
LOCATE AND RETAIN EXISTING LAND DRAIN
CONNECTIONS FROM PARK TO MH12

EXISTING TELEPHONE POLE
RELOCATED BY OPENREACH

6NO. ADDITIONAL TARMAC PARKING
BAYS - SEE SPECIFICATION ON THIS
SHEET

CHAMBER AND SILT TRAP - SPECIFICATION

SILT TRAP ST01:
WAVIN 6LB600 500mmDIA. WITH 2 NO 160mm OD
OUTLETS

MANHOLE MHS01:
WAVIN 450D/S

SHAFTS:
WAVIN 450. LENGTH TO SUIT INVERT LEVEL

6NO. PARKING BAYS - SPECIFICATION

COATED MACADAM CAR PARK: (PRIVATE)
MATERIALS AND WORKMANSHIP TO DEPARTMENT OF
TRANSPORT MANUAL OF CONTRACT DOCUMENTS FOR
HIGHWAY WORKS, VOLUME 1, SPECIFICATION FOR HIGHWAY
WORKS INCLUDING ALL AMENDMENTS CURRENT.

SURFACE COURSE:

THICKNESS: 20MM

MATERIAL: 10MM NOMINAL SIZE DENSE BITUMINOUS
MACADAM SURFACE COURSE TO CLAUSE 912, 100/150 PEN.

BINDER COURSE:

THICKNESS: 60MM

MATERIAL: 20MM NOMINAL SIZE DENSE BITUMINOUS
MACADAM BINDER COURSE TO CLAUSE 906, 100/150PEN.

BASE COURSE:

THICKNESS: 70MM

MATERIAL: 32MM NOMINAL SIZE DENSE BITUMINOUS
MACADAM BINDER COURSE TO CLAUSE 906, 100/150PEN.
SUB-BASE - 225MM OF TYPE 1 CLAUSE 803.

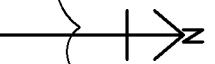

© D3-ASSOCIATES
THIS DRAWING IS THE SUBJECT OF COPYRIGHT WHICH VESTS
IN D3-ASSOCIATES. IT IS AN INFRINGEMENT OF COPYRIGHT TO
REPRODUCE THIS DRAWING, BY WHATEVER MEANS,
INCLUDING ELECTRONIC, WITHOUT THE EXPRESS WRITTEN
CONSENT OF D3-ASSOCIATES WHICH RESERVES ALL ITS
RIGHTS.

D3-ASSOCIATES ASSERTS ITS RIGHTS TO BE IDENTIFIED AS
THE AUTHOR OF THIS DESIGN. ALL DRAWINGS, IMAGES AND
MODELS ARE SUBJECT TO THE COPYRIGHT, DESIGNS &
PATENTS ACT 1988.

- DRAWING NOT TO BE SCALED
- REPORT ERRORS & OMISSIONS TO D3-ASSOCIATES
- CHECK ALL DIMENSIONS ON SITE
- TO BE READ IN CONJUNCTION WITH HEALTH AND
SAFETY PLAN AND ALL RELEVANT RISK ASSESSMENTS

GEOSYNTHETICS TTE GRAVEL
SURFACE TO BAY ACCESS

GEOSYNTHETICS TTE GRASS
SURFACE TO PARKING BAYS

Rev	Description	Iss	Chkd	Date
P07	NOTES UPDATED, LEVELS, TARMAC AND CHAMBER/SILT TRAP SPECIFICATIONS ADDED	SB	ST	08/11/2023
P06	REVISED TENDER ISSUE	SB	ST	27/10/2023
P05	Telegraph pole relocated - parking	SB	ST	26/10/2023
P04	Car parking realigned to retain telegraph pole	JA	MD	10/10/2023

Purpose of Issue

TENDER

Project Information

SHOTTON OVERFLOW CAR PARK

Drawing Information

**PROPOSED SITE OVERFLOW
CARPARK**

Drawing No.

1873-SHO-D3A-00-00-DR-A-2014

Project No.	Drawn	Scale @ A3	Status	Revision
1873	JA	1:500	D2	P07