

RAFT SLAB GENERAL ARRANGEMENT

SCALE 1:75

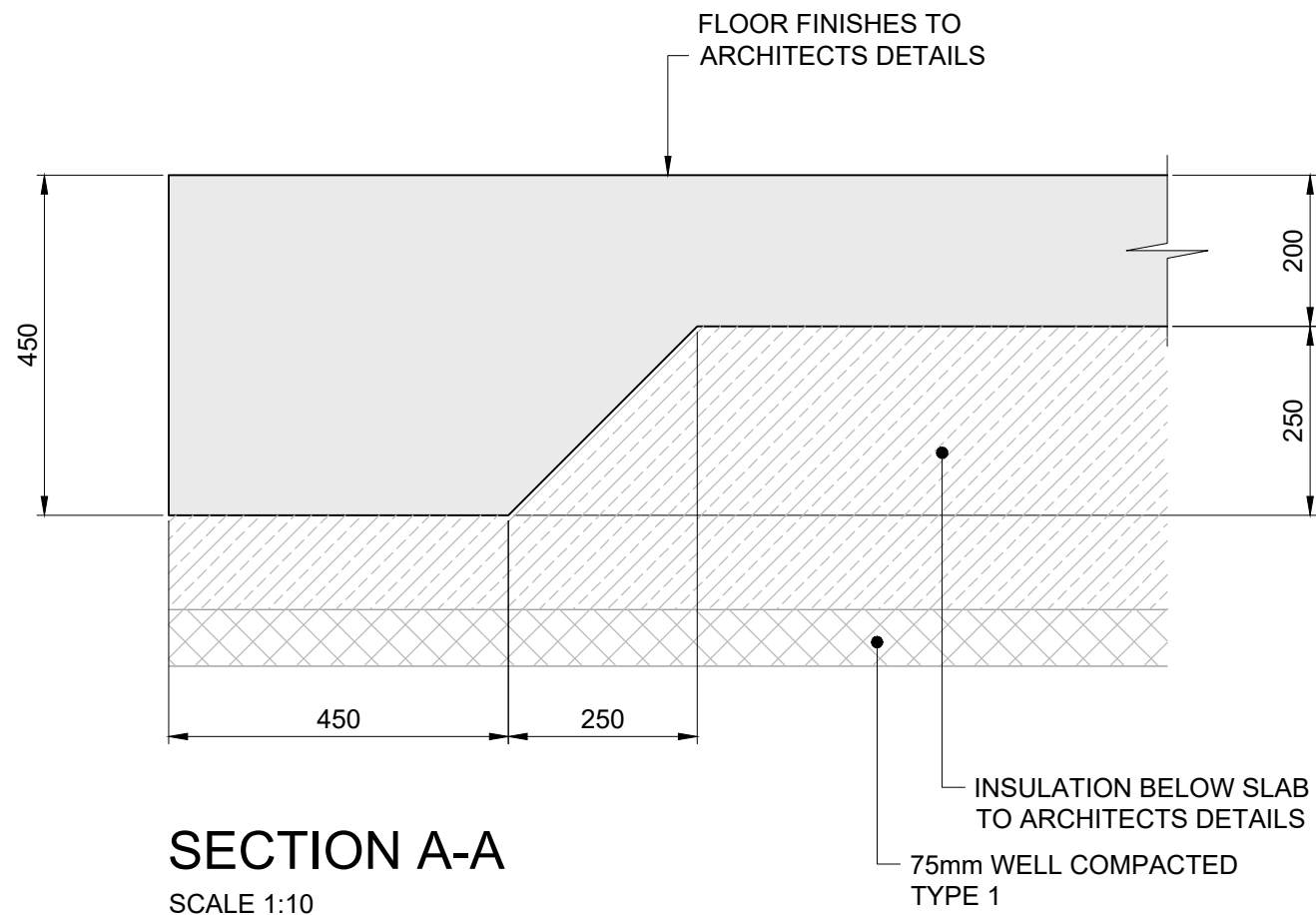

SECTION A-A

SCALE 1:10

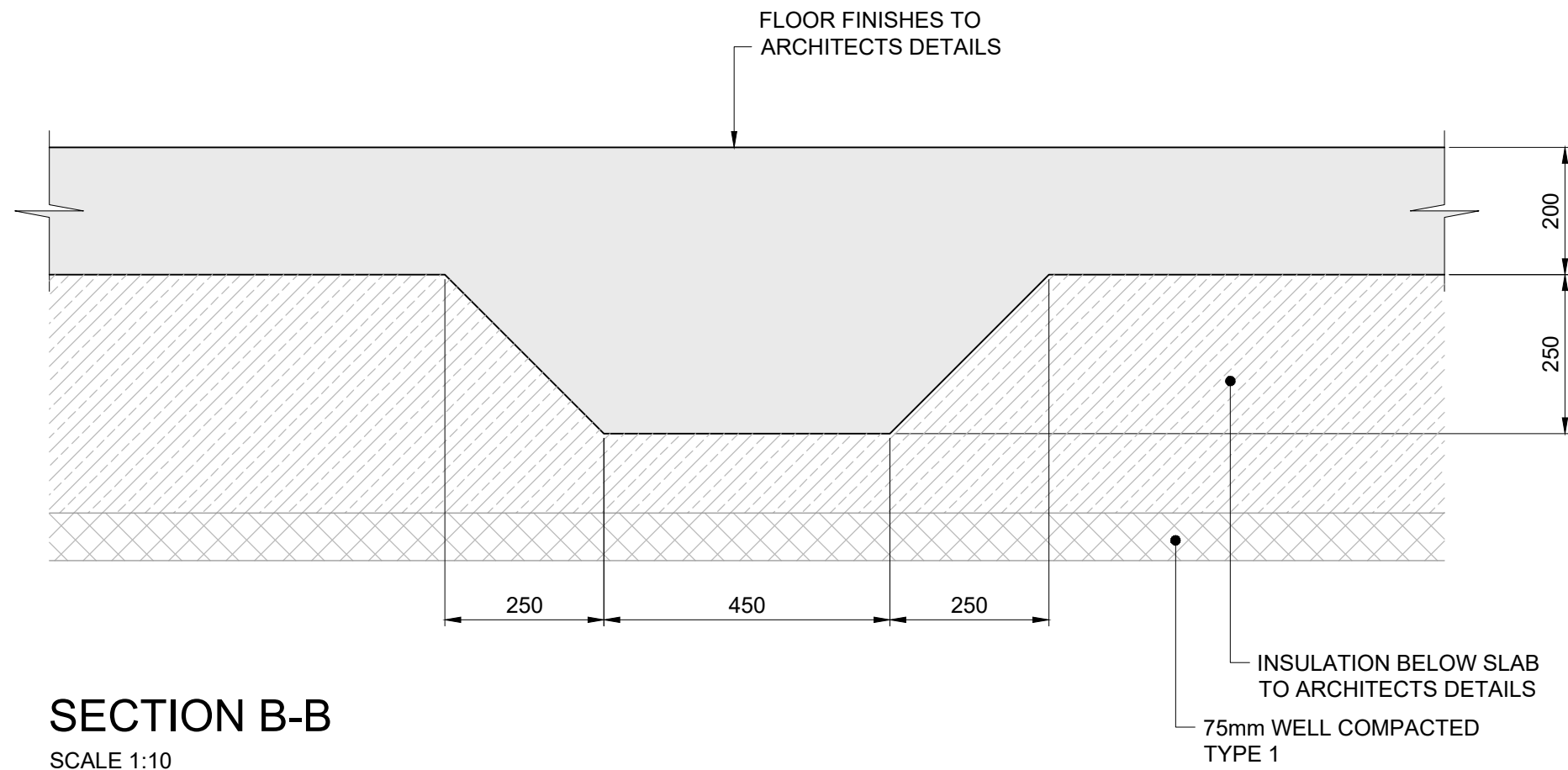

SECTION B-B

SCALE 1:10

CONCRETE NOTES:

- ALL CONCRETE WORKS, MATERIALS, WORKMANSHIP ETC., TO BE IN ACCORDANCE WITH CURRENT EDITIONS OF BS 8110 - BRITISH STANDARDS, CODES OF PRACTICE FOR THE STRUCTURAL USE OF CONCRETE.
- ALL STRUCTURAL CONCRETE TO BE CAST ON 50mm MINIMUM THICKNESS OF CONCRETE BLINDING DESIGN MIX GEN1 OR STANDARD MIX ST1/ST2.
- MINIMUM CONCRETE COVER TO SHALL BE 40mm TO ALL SIDES UNLESS INDICATED OTHERWISE.
- CONCRETE QUALITY TO BE DESIGN GRADE RC35 USING 20mm NOMINAL AGGREGATES MINIMUM CEMENT CONTENT OF 280kg/m³ W/C RATIO = 0.6
- FOR DETAILS OF REINFORCEMENT REFER TO DRAWINGS 220007-CCL-XX-XX-DR-S-0700, 0701, 0702 & 0703
- ALL STRUCTURAL CONCRETE SHALL BE ADEQUATELY COMPACTED USING POKER TYPE IMMERSION VIBRATOR WITHIN SUITABLE PURPOSE MADE SHUTTERS UNLESS OTHERWISE STATED.
- ALL REINFORCEMENT CAGES SHALL BE SECURELY WIRED TOGETHER AND LOCATED WITHIN THE SHUTTERS BY SUITABLY FIXED SPACERS, CHAIRS ETC.
- ALL CHAIRS AND SPACERS ARE TO BE SCHEDULED AND SUPPLIED BY THE CONTRACTOR.

GENERAL NOTES:

- THE DRAWINGS, DESIGN AND ALL INFORMATION CONTAINED THEREIN ARE THE SOLE COPYRIGHT OF CANHAM CONSULTING AND ANY REPRODUCTION IS FORBIDDEN UNLESS PERMISSION IS OBTAINED IN WRITING.
- DIMENSIONS MUST NOT BE SCALED FROM THE ENGINEERS DRAWINGS.
- ALL DIMENSIONS ARE IN MILLIMETRES UNLESS NOTED OTHERWISE.
- DIMENSIONS MARKED \* ARE SUBJECT TO CONFIRMATION BY SITE MEASUREMENT BEFORE CONSTRUCTION PROCEEDS.
- ALL DIMENSIONS ARE GIVEN TO STRUCTURAL SURFACES UNLESS NOTED OTHERWISE.
- ALL DIMENSIONS AND LEVELS ARE TO BE CHECKED ON SITE PRIOR TO COMMENCING ANY CONSTRUCTION OR FABRICATION.
- ANY CONSTRUCTION OR FABRICATION CARRIED OUT PRIOR TO OBTAINING ALL NECESSARY STATUTORY AND OTHER APPROVALS IS DONE AT THE RISK OF THE CONTRACTOR.
- THE CONTRACTOR IS TO PREPARE RISK ASSESSMENTS IN ACCORDANCE WITH THE REQUIREMENTS OF THE LATEST AND RELEVANT LEGISLATION AND GUIDANCE NOTES, PRIOR TO THE COMMENCEMENT OF ANY WORKS.
- THE CONTRACTOR IS TO ENSURE THE STABILITY OF EACH ELEMENT AND THE STABILITY OF THE OVERALL CONSTRUCTION UNTIL THE WORKS ARE COMPLETE.
- ALL DESIGNS, CONNECTIONS, WORKMANSHIP AND MATERIAL ARE TO COMPLY WITH THE CURRENT BUILDING REGULATIONS AND THE LATEST RELEVANT BRITISH STANDARD SPECIFICATION AND CODES OF PRACTICE OR OTHERWISE BE TO THE SPECIFIC WRITTEN APPROVAL OF THE ENGINEER.
- INSPECTIONS MADE BY THE LOCAL AUTHORITY, SHALL BE ARRANGED BY THE CONTRACTOR TO SUIT HIS PROGRAMME. ANY COST ARISING OUT OF FAILING TO CARRY OUT THE WORK TO THE SATISFACTION OF THE LOCAL AUTHORITY WILL BE THE SOLE RESPONSIBILITY OF THE CONTRACTOR.
- NON-STRUCTURAL FIXINGS ARE GENERALLY NOT SHOWN ON THE ENGINEERS DRAWINGS AND IF ANY SUCH DETAIL IS INDICATED IT MUST BE CONFIRMED BY CROSS REFERENCE TO OTHER SPECIALISTS BEFORE CONSTRUCTION.
- WHERE PROPRIETARY STRUCTURAL ELEMENTS, FIXINGS OR ADMIXTURES ARE USED, THEY ARE TO BE USED STRICTLY IN ACCORDANCE WITH THE MANUFACTURERS RECOMMENDATIONS AND THE ENGINEERS APPROVAL.
- NO STRUCTURAL MEMBERS ARE TO BE CUT, NOTCHED OR JOINED UNLESS SHOWN ON THE ENGINEERS DRAWINGS AND DETAILS.
- UNLESS NOTED OTHERWISE, ALL CONNECTIONS OF STRUCTURAL MEMBERS, INCLUDING LAPS AND ANCHORAGES OF REINFORCEMENT SHALL BE CAPABLE OF MOBILISING THE FULL STRUCTURAL CAPACITY OF THE MEMBER.
- NO HOLES, IRRESPECTIVE OF SIZE ARE TO BE FORMED IN THE PRIMARY STRUCTURAL MEMBERS (BEAMS, COLUMNS ETC.).

REFER TO ARCHITECTS DRAWINGS FOR ALL SETTING OUT, DPMS AND FINISHES

FOR RAFT SLAB REINFORCEMENT REFER TO DRAWING 220007-CCL-XX-XX-DR-S-0700

P02	17.06.24	RAFT SLAB SPLIT INTO 3 SEPARATE SLABS	AW	NTE
P01	30.05.24	PRELIMINARY ISSUE	AW	NTE
rev	date	details	drawn	check



Structural Civil Building Engineers

+44 (0)1603 430650 | clientservice@canhamconsulting.co.uk | www.canhamconsulting.co.uk

GREAT AND LITTLE PLUMSTEAD PARISH COUNCIL

DAVID BULLEN LIMITED  
RACKHEATH, NORWICH

GREAT PLUMSTEAD PAVILION, CHURCH ROAD  
GREAT PLUMSTEAD, NORWICH, NR13 5AB

RAFT SLAB GENERAL ARRANGEMENT

CCL ref:	drawn	design	checked	scale	size	date
220007	AW	JP	NTE	1:75, 1:10	A1 (L)	20.05.2024

S3 - SUITABLE FOR REVIEW & COMMENT

drawing number	revision
220007-CCL-XX-XX-DR-S-0600	P02

This drawing is copyright and is not to be reproduced without the written permission of Canham Consulting Ltd

**SITE DIMENSIONS:**  
ACCURATE ON-SITE MEASUREMENTS FOR OVERALL ELEMENT SIZES MUST BE CARRIED OUT PRIOR TO FABRICATION OF ANY STRUCTURAL ELEMENTS, BY THE CONTRACTOR OR SPECIALIST SUPPLIER. DESIGN DIMENSIONS WITHIN THE CALCULATIONS MUST NOT BE USED FOR THE PROCUREMENT OF ANY STRUCTURAL ELEMENTS. DO NOT SCALE OFF THIS DRAWING.

**MANUAL LIFTING:**  
ANY STRUCTURAL ELEMENT IN EXCESS OF 25kg REQUIRES SPECIFIC RISK ASSESSMENT AND CONSIDERATION OF ASSISTED LIFTING EQUIPMENT.