

Project:	Roof Edge Protection and Roof access systems
Project no:	RA1
Project Location:	Public Health England
	Chilton
	Didcot
	Oxfordshire OX11 0RQ
PHE Project Manager	Stuart Hosier (Engineering Officer)
Tender returns by	Friday 20 th Sept 2019 15:00
Project Competition	Thursday 31 st Oct 2019 17:00

Introduction

Public Health England (PHE) exists to protect and improve the nation's health and wellbeing and reduce health inequalities. It does this through advocacy, partnerships, world-class science, knowledge and intelligence, and the delivery of specialist public health services. PHE is an operationally autonomous executive agency of the Department of Health. This specification covers work to take place at Public Health England, Chilton, OX11 0RQ.

This project incorporates supply, delivery and installation of roof edge protection and roof access systems

Bidders should provide an intended methodology with their submission, along with all details of equipment that are proposed for supply under this tender. A detailed programme of work to be carried out should accompany the tender considering Health, Safety and Environmental requirement.

Site visits will be held on the date stated within this document. Contractors will be allocated a 2-hours to survey and will be limited to no more than 2 people. No further visits will be considered after the date indicated. Please be aware due to the requirement of this project E Block is currently inaccessible for survey.

Whilst cost is an important factor, the technical solution and evidenced performance of the product will also be a significant factor in selection of suitable supplier.

The work will be awarded to a single contractor however tender values shall be separated into the following parts to include Supply, Installation and Waste.

1. G Block Roof Access (1.0)
2. A Block Plant Room (2.0)
3. F Block Roof (3.0)
4. G Block Roof (4.0)
5. B Block Roof (5.0)
6. E Block Access ladder (6.0)
7. E Block Access Gate (7.0)
8. Recertification and commission

Specification

Map with annotated building areas

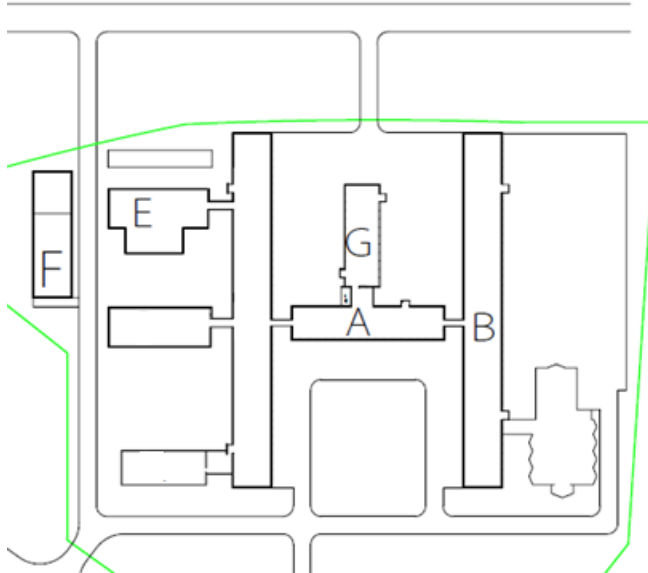

1.0 G Block Roof Access (3 storey building)

- 1.1 Allow for supply and installation 1 x ladder up safety post. Retro fitted to existing internal roof hatch ladder to provided safe access/egress from hatch on to roof.
- 1.2 Allow for supply and installation of 1 x aluminium checker plate platform step to be supported via existing ladder and additional fixed support. To provide transition platform step for safe access to and roof. Platform to be designed to withstand a Minimum loading bearing of 150kg.

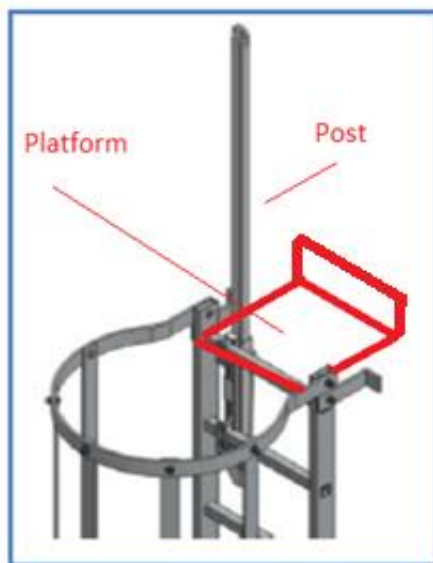

2.0 A Block Plant Room (3 storey building)

2.1 Allow for supply and installation of 1 x self-closing safety gate at top of landing space of existing ladders access

2.1. Allow for supply and installation off Kee Klamp bracing/gate stopper.



3.0 Area 3 – F Block Roof (Single storey building)

3.1 Allow for supply and installation of KEE guard free standing guardrail to be installed to roof parapet wall perimeters to provide protection against falling. Roof size 36.1m x 10.8m



4.0 Area 4 - G Block Roof (3 storey building)

4.1 Allow for supply and installation of 1 x Kee dome guardrail with self-closing swing access yellow safety gate to provided safe access/egress from roof hatch to/from roof.

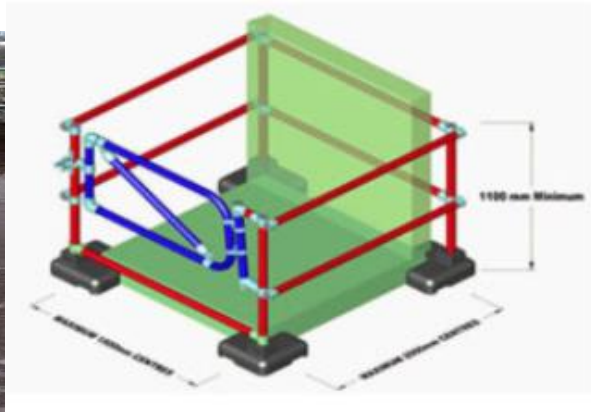

5.0 Area 5 B Block Roof (2 storey building)

5.1 Allow for supply and installation of 1 x Kee dome guardrail with self-closing swing access yellow safety gate to provided safe access/egress from roof hatch to/from roof.

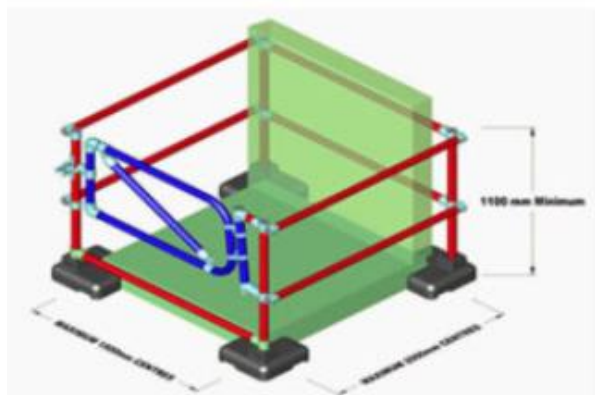

Area 6 - E Block Access ladder (Single storey building)

6.1 Allow for metre marine grade aluminium hooped ladder c/w with 800mm walkthrough section and self-closing gate.

- 1 x removable bottom ladder section to be removable
- Secured to wall with 500mm brackets to accommodate existing wall mounted pipes
- Walkthrough section on Bigfoot feet on roof side
- Platform not sitting on parapet
- Existing roof guardrail to be cut to accommodate ladder installation

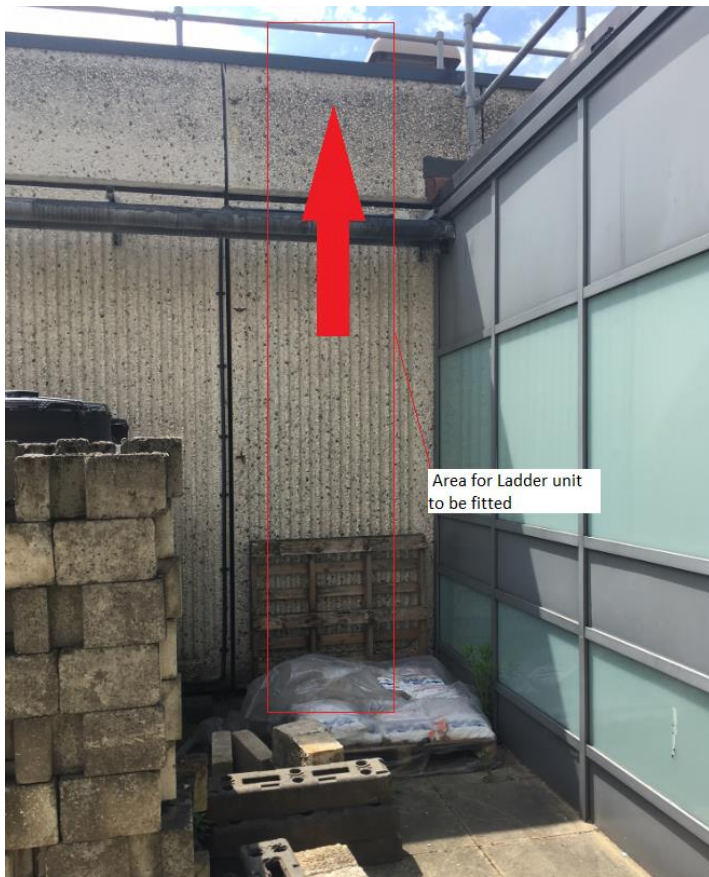
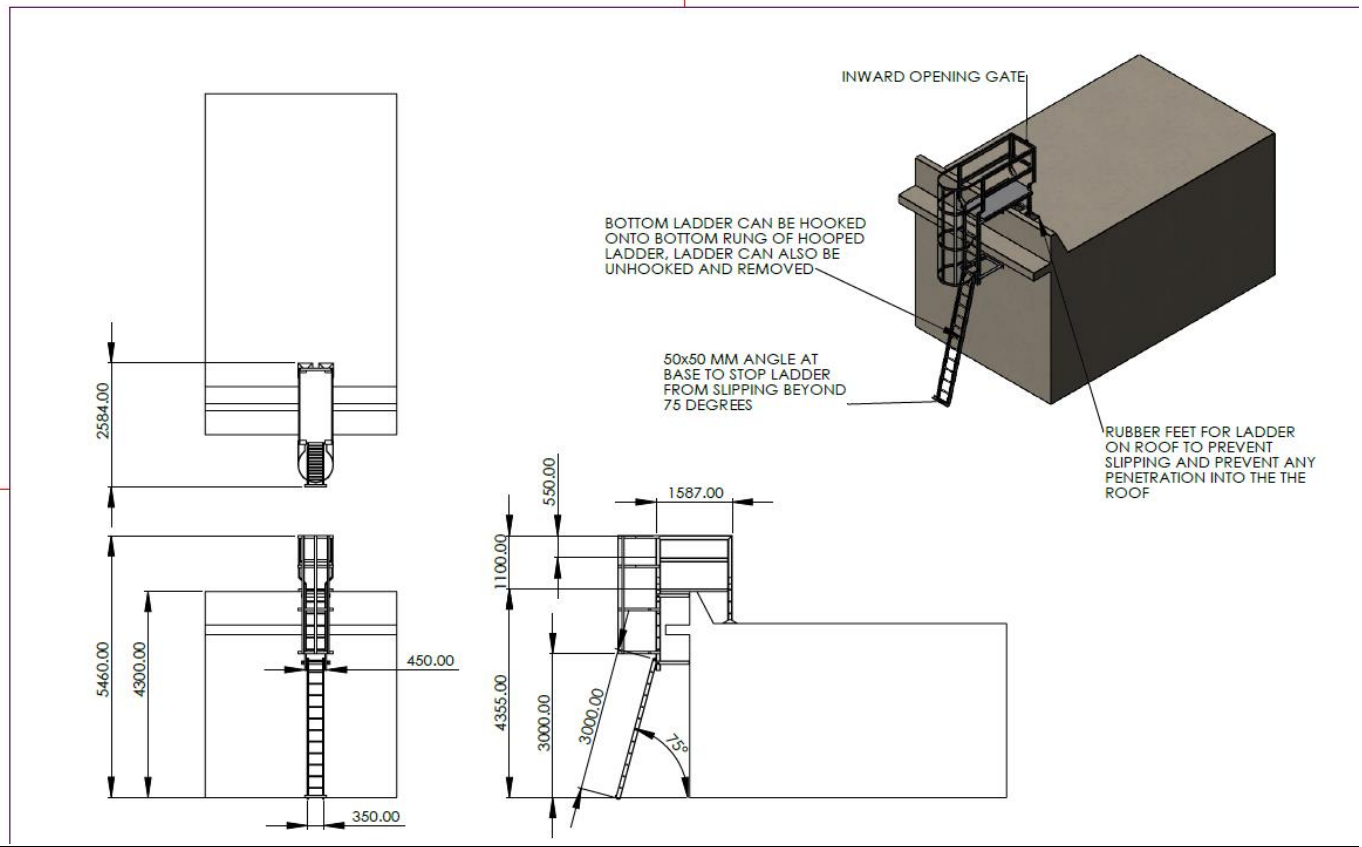

7.0 E Block Access Gate (Single storey building)

7.1 Allow for 1 x Kee standard pallet access Pallet Gate Type A – Standard Model_1.4m x 1.48m with maximum height of 1.60m. A parapet wall currently surrounds this roof - The gate and gate handrail shall be modified to close at the parapet wall height of 600mm. Plastic pallets shall be used to provide the base required to level to the new gate level above parapet wall (To be supplied by PHE). Any extra guard rails shall be included to enable compliance of the railing.

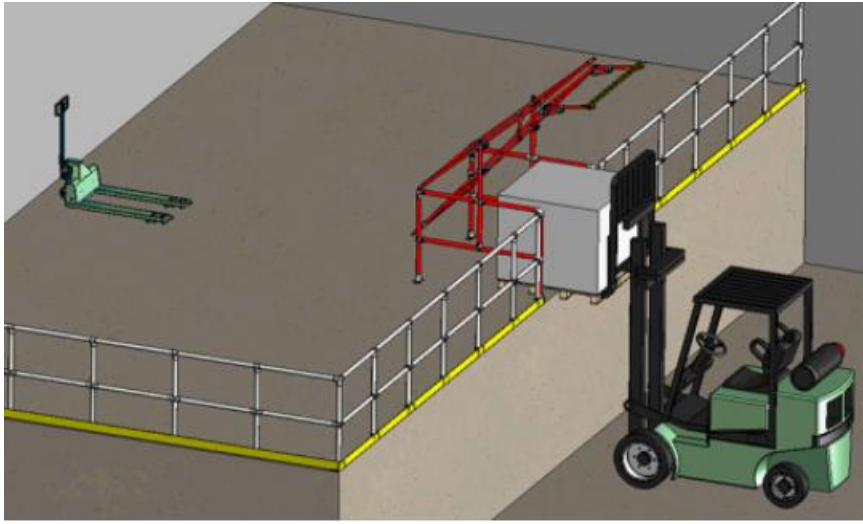

Contract Requirements

Allow for all access equipment required to transport and install goods

Allow for all recertification of existing and new handrails which are altered during the project.

Allow for all Guardrails installed to be galvanized finish KDH3/Keedome rooftop guardrail bigfoot system that does not penetrate the existing roof membrane, conforming to EN ISO 14122 Part 3 & EN 13374 Class A.

<https://keesafety.co.uk/products/kee-klamp>.

Design Loads to be to British Standard BS 8118, BS 6180, BS 6399 & BS 7818 .

Allow for all installations to conform to Work At Height Regulations 2005.

Site Attendance

The contractor is required to ensure that their employees have suitable work wear, are clean and tidy and shall conduct themselves in a polite and conscientious manner always. All contractor personnel attending site who have not done so previously will need to undertake a site induction with PHE.

All contractors attending site are required to comply with the PHE site rules and shall notify Facilities staff when leaving site for safety reasons.

There should be a designated site supervisor identified always

PHE will provide parking for a limited number of vehicles during working hours, subject to approval at the time of works.

Deliveries to the site must be scheduled directly to the contractor during normal working hours.

PHE will be able to provide onsite toilet facilities during normal working hours.

PHE can provide a limited amount of secure storage for equipment and materials on site. An outside area or garage may be used for large items.

Warranties

The guarantee period should a minimum of 12 months unreserved on workmanship and all new equipment and materials supplied by the contractor. The equipment and installation will meet the Manufacturers criteria to give an underwritten guarantee of the installation in conjunction with the completed air testing.

The defects liability period of 12 months will commence on the date of the successful handover from the contractor to PHE

.....