

Proposed Rooflight Replacement Scheme

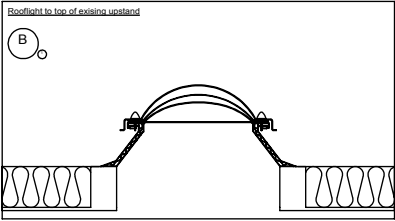
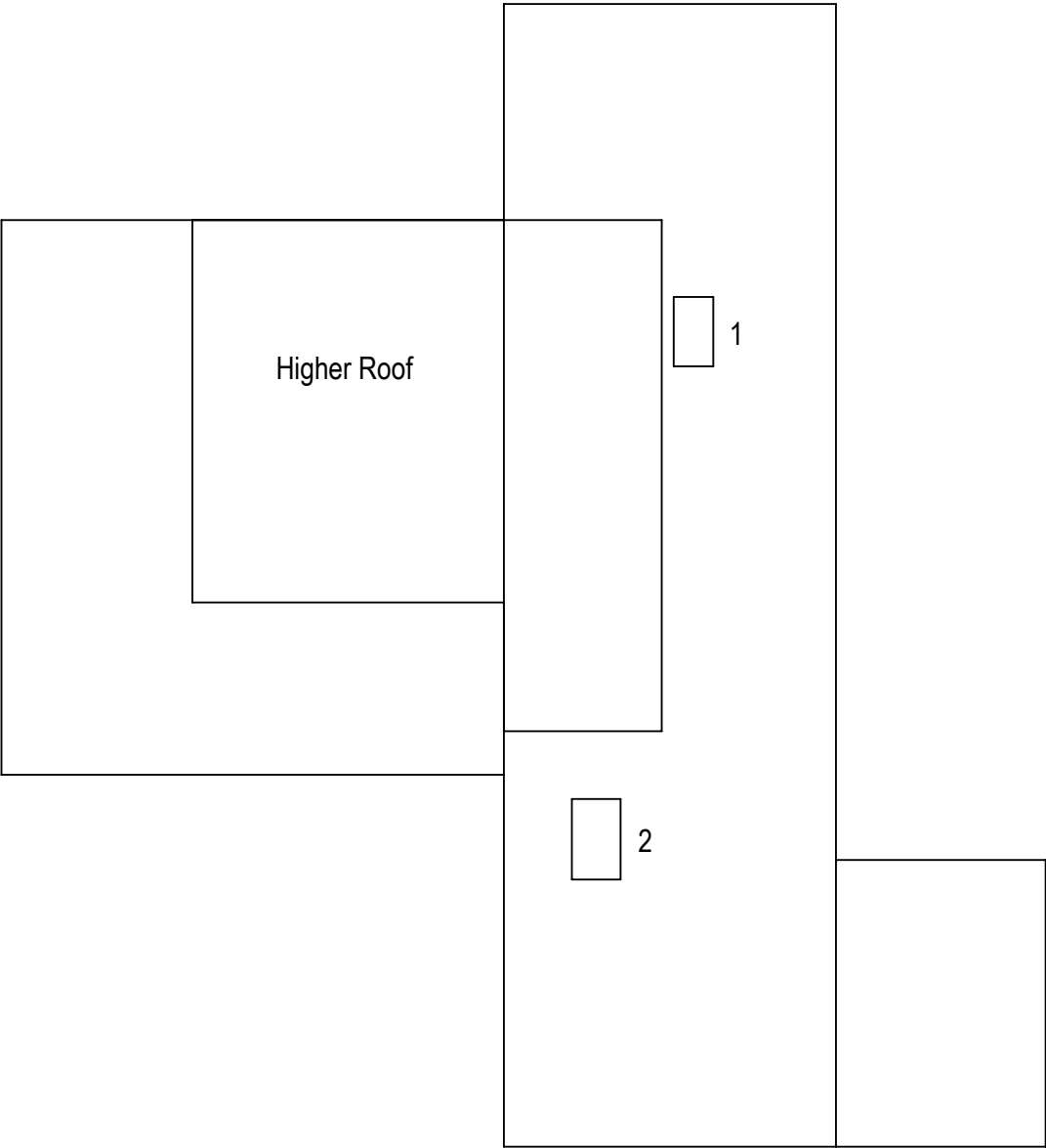

- Notes:
- Do not scale from this drawing
 - Unloading and storage of material is the responsibility of the contractor
 - All rooflights, curbs and accessories must be stored in accordance with installation instructions
 - Rooflights should be installed in accordance with installation instructions, relevant codes of practice and this drawing
 - All dimensions and rooflight replacement types must be confirmed by the contractor
 - Section drawings are indicative and may not represent the actual detail

Rooflight Schedule

RL No.	Type	Size (mm)	Accessories
1 - 2	B1	600 x 900	

KEY NOTES
Unit(s) 1-2 will fit to the top of the under-height existing curb. New unit(s) will require weathering.

Unit(s) 1-2 will accommodate 150mm of new insulation when installed as detailed above.
The above units have all been quoted as having diffused glazing. The existing units are either clear or diffused.

The above units will comply with Approved Document Part L - 2010 regulations.

Decolight units detailed above are manufactured to BBA certification (Certificate No. 09/4691), and are certified to CE EN1873.

Revision notes:

Rev:	Date:	Note:

Drawn by:
K JAMES

Client:
Sika Liquid Plastics

Project:
P00044162 Shrub End Clinic

Drawing Title:
ROOFLIGHT LAYOUT PLAN

Date:
19-09-2017

Scale@ A3:
NTS

Revision:

Project No: P00044162

