

LEGEND:

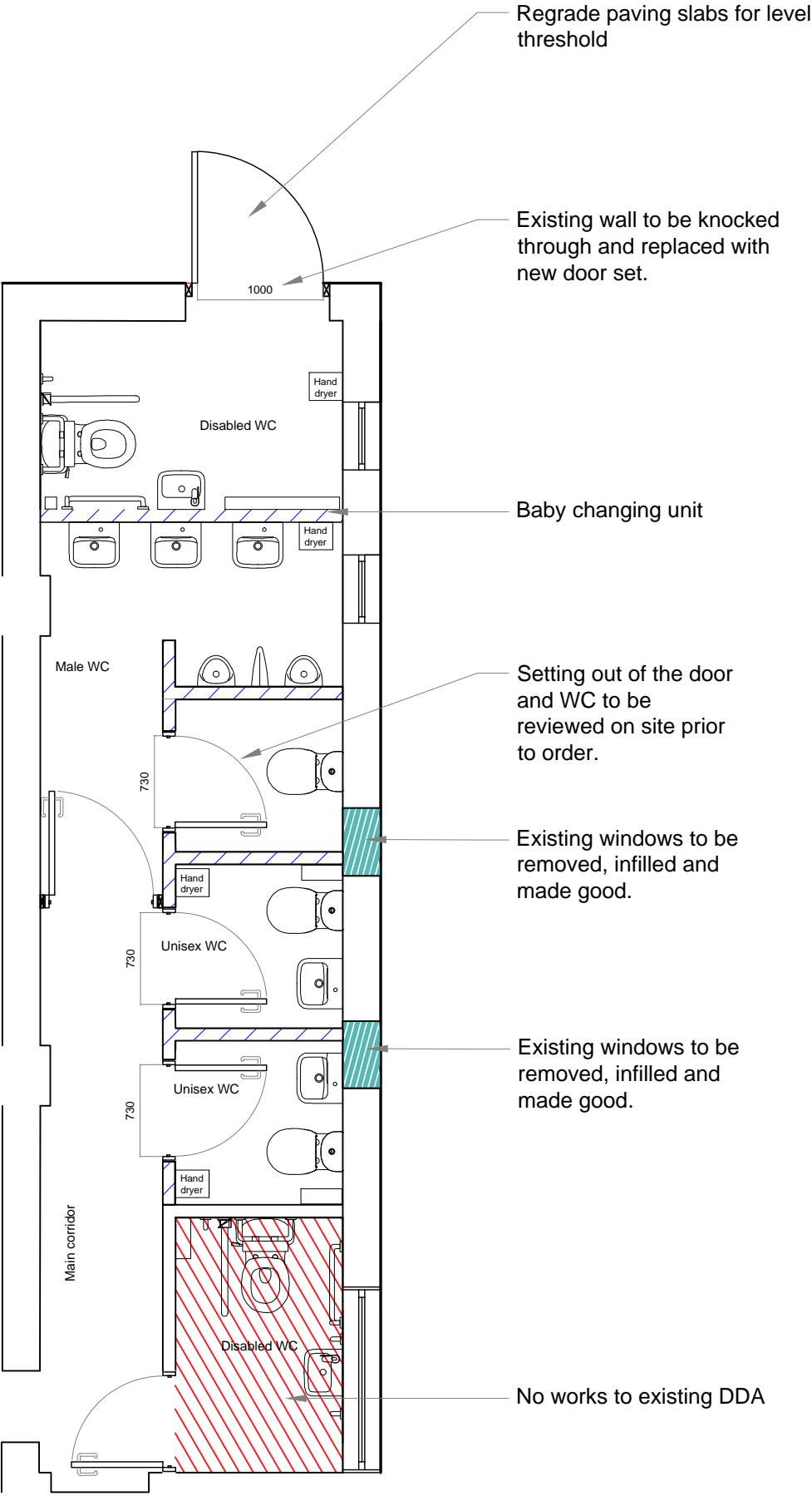

- Allow for installation of new stud work walls, comprising 75x75mm studs, 9mm ply, 12.5mm plasterboard, skimmed and decorated both sides. Position to be fixed full height to the soffit.
- Allow to remove existing windows and block up to match existing external wall. Internally plastered and decorated.

- To be read in conjunction with the Schedule of Works document.
- Allow to supply and install new drainage. Please refer to drawing number 6001 and specification for more details.
 - Allow to supply and install a latex leveling screed throughout the realm of the works and new vinyl floor covering to match existing DDA. Allow for Cap and cove upstands. Please refer to drawing number 7001.
 - Allow to supply and install ceramic tiled splash backs above each wash hand basin and hand dryer.
 - Allow to supply and install 3 no. new hand dryers as per specification.
 - Allow to supply and install mirrors above all new sinks as per specification.
 - Allow to supply and install toilet roll holders to all new WCs as per specification.
 - Allow to supply and install new sanitary ware and associated drainage to locations shown on drainage drawings. Please see specification for more details.
 - Allow to supply and install new solid door sets as per specification.
 - Allow to supply and fix new unisex, male and disabled WC door signs.
 - Allow to prepare and decorate all window boards and joinery.
 - Allow to prepare and redecorate all wall and ceiling surfaces in accordance with specification.
 - Allow to supply and install new plasterboard ceiling throughout and decorate.
 - Please refer to the Mechanical and Electrical drawings and specification for lighting.

Proposed Layout

					Project: Orpen Village Hall 80 Chapel Road West Bergholt CO6 3BG			Title: Proposed Layout			
								Drawing Number: OMHALL - IWD - XX - 00 - DR - B - 2000			
P01	-		26/5/22	XX	XX	Client: West Bergholt Parish Council			Status: D2	Purpose of Issue: Tender	Revision: P01
Rev	Description		Date	Chk	Apr						
Project No: 502319		Scale @ A3: As Indicated		Drawn By: CW							

Ingleton
Wood

Property and Construction
Consultants
Issuing office: Colchester
T: 01206 224270
www.ingletonwood.co.uk

Vision, form and function