

**Fire Strategy :**  
**Developed inline with information recieved from Environment Agency 5 December 2016 -Existing Fire and Rescue Service drawings .**  
**Information on these drawings is limited and further investigation on site will be required to determine Proposed Fire Strategy.**

- Required Fire Compartmentation 30 minutes, opening up works required to verify fire rating.
- Assumed existing Fire Compartmentation 60, opening up works required to verify fire rating.

Existing assumed fire rated construction following site walk around. Any penetrations through fire rated compartments to be appropriately fire stopped. Inspection and opening up of partition required to determine fire rating of construction and any remdlal works required to made good to ensure fire rating and integrity is maintained.

Ductwork penetrations through FR partitions - 60min compartment walls, 30min sub-compartment walls, 30min fire hazard room walls to be fire stopped with Rockwool Ablative Batts and Rockwool Acoustic Intumescent Sealant

Cast Iron/metal pipework penetrations through FR partitions (60min compartment walls, 30min sub-compartment walls, 30min fire hazard room walls) with Rockwool Insulated Fire Sleeves

Plastics pipework penetrations through FR partitions (60min compartment walls, 30min sub-compartment walls, 30min fire hazard room walls) with Rockwool Insulated Fire Sleeves (min 25 mm projection each face) Rockwool Acoustic Intumescent Sealant

Cable tray penetrations through FR partitions (60min compartment walls, 30min sub-compartment walls, 30min fire hazard room walls) with Rockwool Multi Cable Firestop,Rockwool Ablative Batts, Rockwool Acoustic Intumescent Sealant

Ceiling Voids Service zone between top surface of ceiling and soffit Rockwool 50mm Fire Barrier to provide 30min integrity and 15min insulation

Blue dash line denotes extents of work to be reviewed inline with assumed compartment line. Fire rating TBC upon site investigation.

- Denotes existing 60 minute fire resisting door with smoke seals
- Denotes existing 30 minute fire resisting door with smoke seals
- Denotes minimum 60/60 minute fire resisting door with smoke seals
- Denotes minimum 30/30 minute fire resisting door with smoke seals
- Denotes existing fire resisting door based on existing door signage. Inspection required to verify fire rating.
- Denotes final exit - Minimum clear openings as indicated (Doc M may require increased clear opening width)
- Denotes individual room exit
- Denotes exit from level
- GS

Denotes glazed screen to achieve 60 minutes fire rating
- GS

Denotes glazed screen to achieve 30 minutes fire rating
- GS

Denotes glazed screen
- Denotes wheelchair refuge with emergency call point

All aspects of existing and proposed fire strategy to be reviewed and agreed with Building Control prior to commencement of works

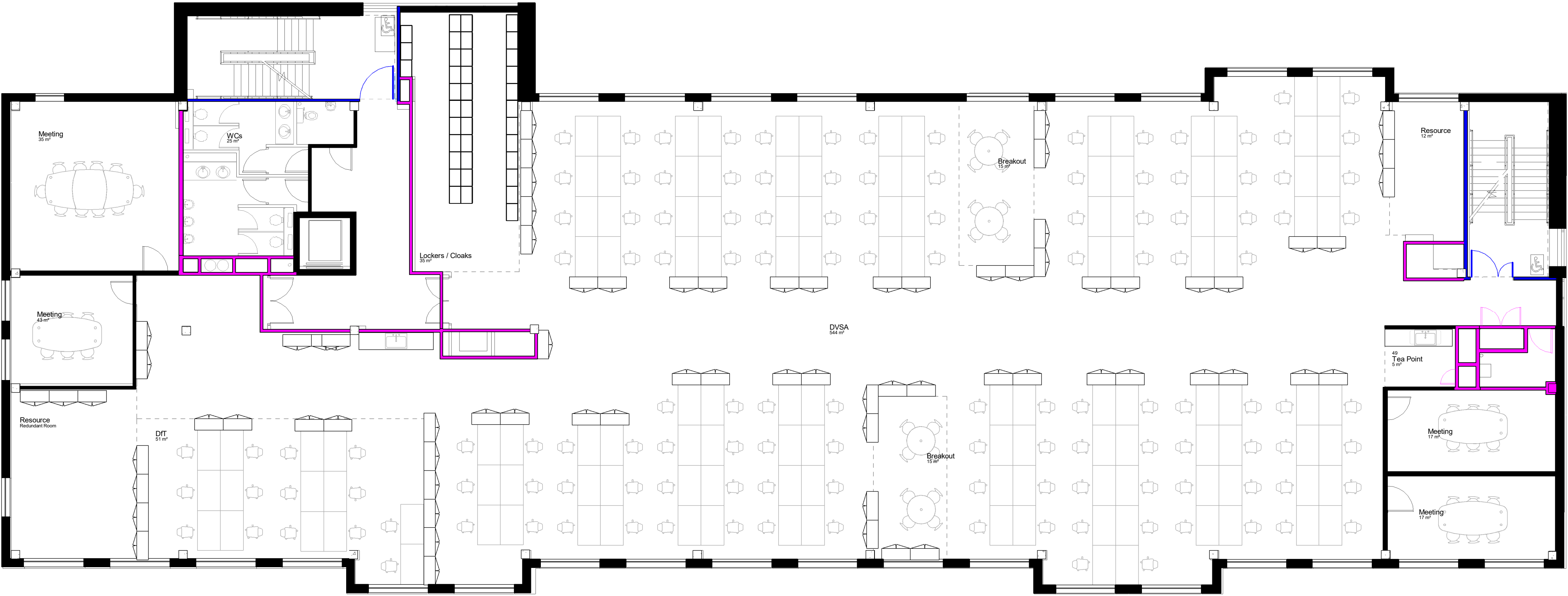

## Fire Strategy - Level 2

1 : 100

Revision	Date	Drawn by	Checked by
<b>P2</b>	20/06/17	SOC	SOC
Updated following site walk around			

Revision	Date	Drawn by	Checked by
<b>P1</b>	09/08/17	SOC	SOC
First issue			

Amendment

Purpose of Issue  
**Preliminary**

Project  
**Mace**  
**DVSA Relocation**  
**Tyneside House**

Drawing  
**Fire Strategy - Level 02**

Drawing No.	Originator	Zone	Level	Type	Role	Number
<b>DVSA</b>	<b>- RYD</b>	<b>- 00</b>	<b>- 02</b>	<b>- DR</b>	<b>- A</b>	<b>-3203</b>
Ryder Project No.	Scale at A1	Drawn By	Status	Revision		
<b>2788-01</b>	<b>1 : 100</b>	<b>SOC</b>	<b>SO</b>	<b>P2</b>		