

**EMERGENCY LIGHTING**  
 EMERGENCY LIGHTING PROVISION SHALL COMPLY WITH BS.5266-1. THE EXTERNAL ESCAPE/ EXIT POINTS ARE TO BE IN THE POSITIONS INDICATED ON THE GROUND FLOOR PLAN.  
 REGULATION 38 FIRE SAFETY INFORMATION SHOULD BE PASSED ON TO THE RESPONSIBLE PERSON UPON COMPLETION OF THE WORKS.

**FIRE DETECTION AND ALARM SYSTEM**  
 DESIGN, INSTALLATION, COMMISSIONING AND MAINTENANCE OF THE FIRE DETECTION AND ALARM SYSTEM IN NON-DOMESTIC PREMISES TO COMPLY WITH BS.5839.  
 ALLOW FOR INSTALLATION OF MAINS OPERATED SELF-CONTAINED SMOKE ALARMS/ HEAT DETECTORS WHICH CONFORM TO BS.5446:PART 1. SMOKE ALARMS TO BE INTERCONNECTED SO THAT DETECTION OF SMOKE BY ONE UNIT OPERATES THE ALARM SIGNAL IN ALL OF THEM. UNITS TO BE PERMANENTLY WIRED TO A SEPARATELY FUSED CIRCUIT AND HAVE SECONDARY POWER SUPPLY.  
 EACH UNIT TO BE AT LEAST 300MM AWAY FROM ANY LIGHT FITTING.

**WORK ON EXISTING MECHANICAL VENTILATION SYSTEM**  
 FIXED SYSTEMS FOR MECHANICAL VENTILATION AND ANY ASSOCIATED CONTROLS MUST BE COMMISSIONED BY TESTING AND ADJUSTING AS NECESSARY TO COMPLY WITH APPROVED DOC. PART F(2), REGULATION 39 AND 44.  
 ALL WORK IS TO BE DESIGNED, INSTALLED, COMMISSIONED AND MAINTAINED BY AN APPROVED MECHANICAL AND ELECTRICAL CONTRACTOR.

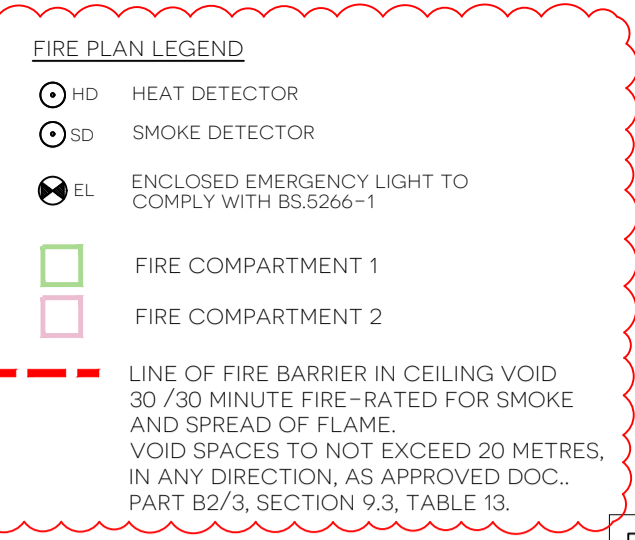

**SUSPENDED CEILING -**  
 AN EXISTING SUSPENDED TILED CEILING - SIZE 600X600MM IS INSTALLED WITHIN THE PRE-SCHOOL AREA, OFFICE, CHANGING ROOMS AND TOILETS, INSTALLED ON A SUSPENDED METAL-FRAME GRID.  
 A NEW 600X600MM WHITE TILED SUSPENDED CEILING IS TO BE INSTALLED IN THE RECEPTION, MAIN FUNCTION ROOM, KITCHENS AND NEW DISABLED WC.  
 - TO BE 30 MINUTE FIRE-RESISTING TO BS.476 - PART 23.  
 - REACTION TO FIRE / SURFACE SPREAD OF FLAME RATING : CLASS 0, EUROCLASS B-S1, D0.  
 - SUSPENDED CEILING IN GENERAL TO ACCORD WITH BS EN 13964.  
 - INSTALLATION MUST BE CARRIED OUT BY AN APPROVED INSTALLER AND ACCORD WITH MANUFACTURER'S INSTRUCTIONS AND BS.9290: 1991 - SUSPENDED CEILING PARTS 1, 2 & 3.  
 - FIXINGS MUST BE TO THE CEILING MANUFACTURER'S SPECIFICATIONS, SUITABLE FOR THE SUBSTRATE ABOVE.  
 - PULL-OUT TESTS SHOULD BE CARRIED OUT TO CEILINGS WITH AREA GREATER THAN 100 M2.  
 - WHERE THE CEILINGS ARE INSTALLED IN AREAS OF HIGH HUMIDITY IE. KITCHENS, CONFIRMATION MUST BE PROVIDED THAT THE CEILINGS ARE SUITABLE IN THESE ENVIRONMENTS BY MEANS OF THIRD PARTY CERTIFICATION.

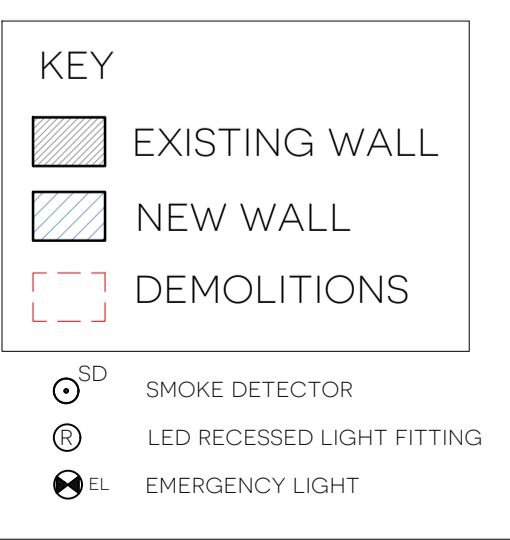
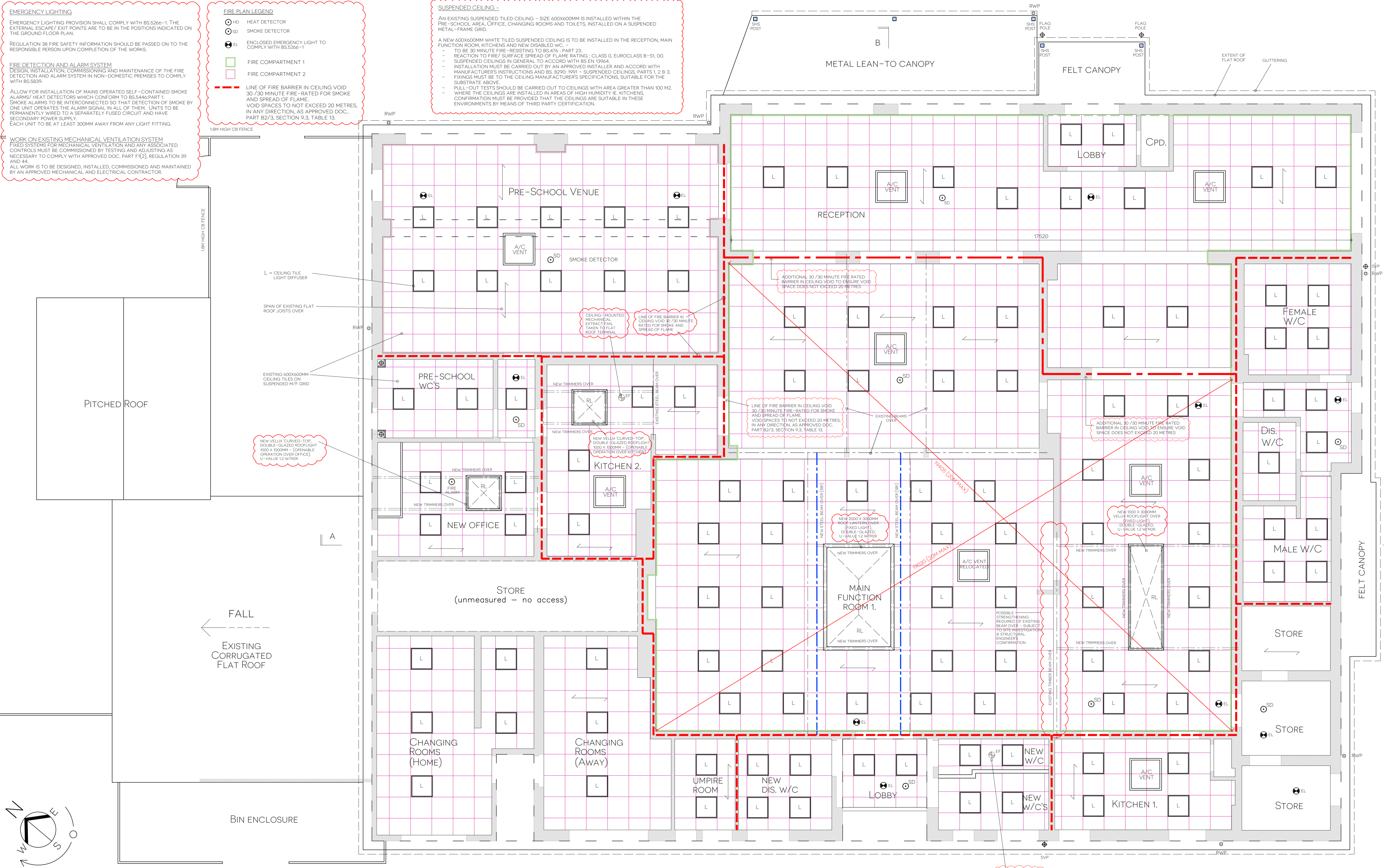

**PROPOSED REFLECTED CEILING PLAN**  
 SCALE: 1:50 @ A1

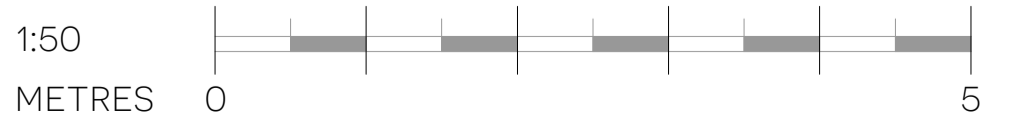

WD - 1703 - 203 B  
**WORKING DRAWING**

TITLE: PROPOSED CEILING PLAN - COMMUNITY HUB,  
 PROJECT: 275 CHRISTCHURCH ROAD, WEST PARLEY, BH22 8SQ  
 CLIENT: WEST PARLEY PARISH COUNCIL  
 SCALE: 1:50 @ A1 DATE: MAR 2024 DRAWN BY: PJR



FIRE BARRIER IN SUSPENDED CEILING VOID INDICATED BY NOTES ABOVE.  
 ROOF LIGHT NOTED AS GLAZING BY U-VALUE UPDATED BY NOTES ABOVE.  
 SINGLE LANTERN ROOF LIGHT OVER MAIN FUNCTION ROOM.  
 CO-ORDINATED WITH STRUCTURAL ENGINEER DETAILS.

REV AMENDMENT BY CHECK DATE

1	19 AUG 24
2	17 JULY 24

THIS DRAWING IS COPYRIGHT AND PROPERTY OF SPASE LTD. THIS DRAWING AND DESIGN IS FOR USE SOLELY IN CONNECTION WITH THE PROJECT DESCRIBED AND MUST NOT BE REPRODUCED, LOANED OR COPIED WITHOUT WRITTEN CONSENT. VERIFY ALL DIMENSIONS AND SETTING OUT ON SITE BEFORE COMMENCING ANY WORK OR PREPARING SHOP DRAWINGS. DO NOT SCALE FROM THE DRAWING. REPORT ALL APPARENT DISCREPANCIES, ERRORS AND OMISSIONS TO SPASE LTD. ALL MATERIALS, COMPONENTS AND WORKMANSHIP ARE TO COMPLY WITH THE RELEVANT BRITISH STANDARDS, CODES OF PRACTICE AND APPROVED MANUFACTURER'S RECOMMENDATIONS.