

Reflected Ceiling plan

Condition Survey: High Level and Ceiling

- 1. Steel Fan Trusses
- 2. Steel Gantry system
- 3. Timber sarking boards
- 4. Asbestos Ceiling boards
- 5. Timber Roof Vent - exposed sarking boards
- 6. Timber Kingpost Truss
- 7. Wallplate and valley rotten indicates evidence of roof failure above.
- 8. HL Damp resulting from item 7.
- 9. Timber Purlins

Condition Survey: General Floor Plan

- 1. Floor Boards and joist ends rotten.
- 2. Pile of hazardous waste.
- 3. Area of concrete floor.
- 4. Floor missing
- 5. Rail tracks.
- 6. Concrete Floor
- 7. Internal partition and door
- 8. EXD-01
- 9. EXD-02
- 10. EXD-03
- 11. EW-34 Frame and casement
- 12. Casement damaged - missing mullion at low level
- 13. Internally boarded over

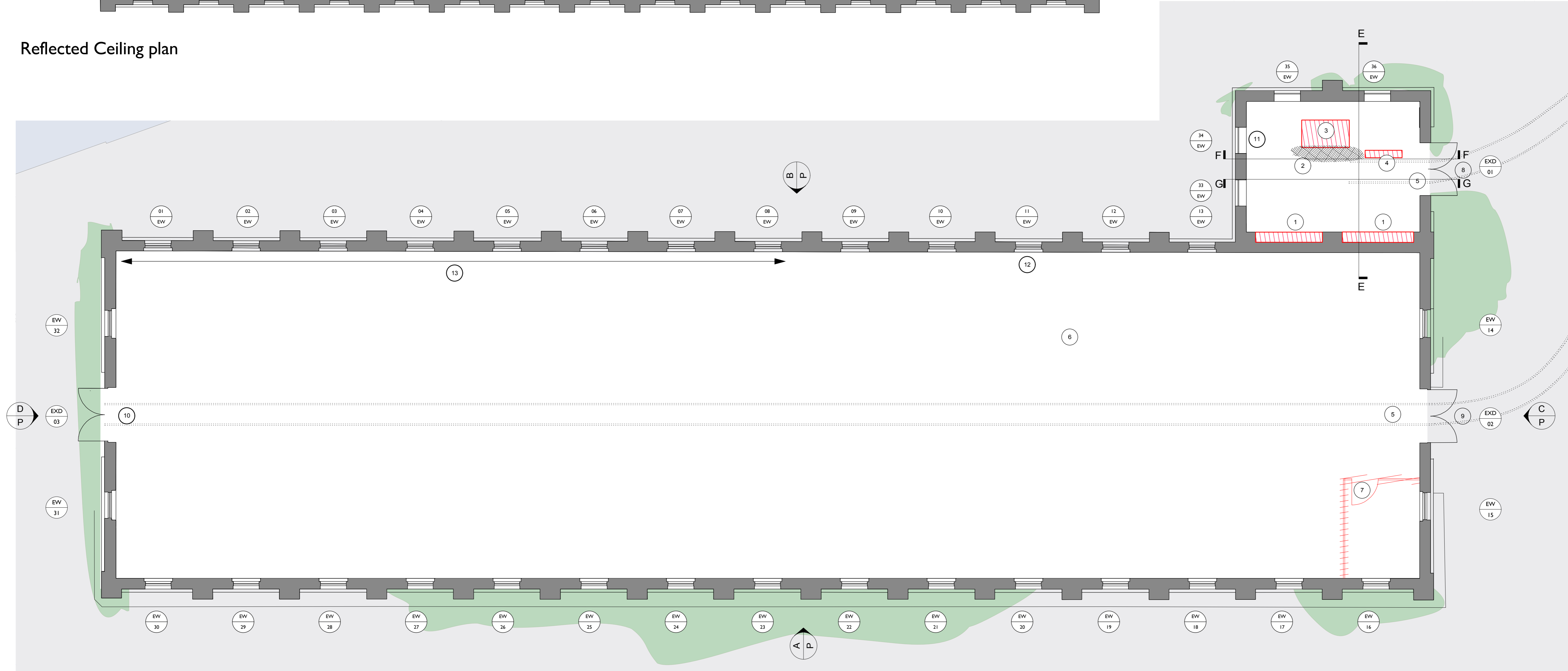

Existing Floor plan

0 2 3 4 5 M

Funding raised by
The National Lottery
and awarded by the Heritage Lottery Fund



Notes

1 This drawing is © copyright Hampshire County Council 2014. No unauthorised reproduction of any kind is permitted.

2 This map is reproduced from Ordnance Survey material with the permission of Ordnance Survey on behalf of the controller of Her Majesty's Stationary Office © Crown copyright. Unauthorised reproduction infringes Crown Copyright and may lead to prosecution or civil proceedings. (100019180), (2014)

rev	description	date	by
P1	PLANNING APPROVAL AND LISTED BUILDING CONSENT	NOV 17	MD

PLANNING AND LB CONSENT

Hampshire County Council

HCC Property Services,
Three Minsters House,
76 High Street, Winchester SO23 8UL
tel: (01962) 847801

PROJECT

Building P
Priddys Hard
Gosport

SCALE

1:75/100 @A1
1:150/200 @A3

DATE

01/17

DRAWN

MD

CHKD.

DRAWING No.

E02702 - P2401

REVISION

P1

SHEET CONTENTS

Condition & Repair Survey
As Existing
Floor & RCP Plan

FILE REF. E02702 - P3XXX